

API NUMBER: 123 23897

OKLAHOMA CORPORATION COMMISSION
OIL & GAS CONSERVATION DIVISION
P.O. BOX 52000
OKLAHOMA CITY, OK 73152-2000
(Rule 165:10-3-1)

Approval Date: 08/27/2021
Expiration Date: 02/27/2023

Straight Hole Oil & Gas

PERMIT TO DRILL

WELL LOCATION: Section: 28 Township: 5N Range: 4E County: PONTOTOC

SPOT LOCATION: ☐ SW ☐ NE ☐ NE ☐ SW FEET FROM QUARTER: FROM SOUTH FROM WEST
SECTION LINES: 2110 2110

Lease Name: KEEL Well No: 1-28 Well will be 530 feet from nearest unit or lease boundary.
Operator Name: O G P OPERATING INC Telephone: 2146962393 OTC/OCC Number: 17901 0

O G P OPERATING INC
8140 WALNUT HILL LANE STE 610
DALLAS, TX 75231-4336

ROBERT T KEEL
2400 NW 23RD STREET SUITE 208
OKLAHOMA CITY OK 73107

Formation(s) (Permit Valid for Listed Formations Only):

	Name	Code	Depth
1	CLEVELAND	405CLVD	2240
2	HUNTON	269HNTN	2460
3	VIOLA	202VIOL	2900

Spacing Orders: 716872

Location Exception Orders: 719381

Increased Density Orders: No Density

Pending CD Numbers: No Pending

Working interest owners' notified: ***

Special Orders: No Special

Total Depth: 3100 Ground Elevation: 1050

Surface Casing: 240

Depth to base of Treatable Water-Bearing FM: 150

Under Federal Jurisdiction: No
Fresh Water Supply Well Drilled: No
Surface Water used to Drill: No

Approved Method for disposal of Drilling Fluids:

A. Evaporation/dewater and backfilling of reserve pit.

H. (Other)

1B MIN. SOIL COMPACTED PIT, NOTIFY DISTRICT
PRIOR TO TESTING SOIL PIT LINER

PIT 1 INFORMATION

Type of Pit System: ON SITE

Type of Mud System: WATER BASED

Chlorides Max: 8000 Average: 5000

Is depth to top of ground water greater than 10ft below base of pit? Y

Within 1 mile of municipal water well? N

Wellhead Protection Area? N

Pit is located in a Hydrologically Sensitive Area.

Category of Pit: 1B

Liner required for Category: 1B

Pit Location is: AP/TE DEPOSIT

Pit Location Formation: TERRACE

NOTES:

This permit does not address the right of entry or settlement of surface damages. The duration of this permit is 18 MONTHS, except as otherwise provided by Rule 165: 10-3-1. Rule 165: 10-3-4 (c) (7) (e) - The Operator shall give 24 Hours notice by telephone to the appropriate District Office of the Conservation Division as to when Surface Casing will be run.

Category	Description
HYDRAULIC FRACTURING	<p>[8/25/2021 - GC2] - OCC 165:10-3-10 REQUIRES:</p> <p>1) NOTICE SHALL BE GIVEN AT LEAST 5 BUSINESS DAYS PRIOR TO COMMENCEMENT OF HYDRAULIC FRACTURING OPERATIONS ON A HORIZONTAL WELL TO OPERATORS PRODUCING WELLS WITHIN 1 MILE OF THE COMPLETION INTERVAL OF THE SUBJECT WELL. THE NOTICE TO SUCH OPERATORS SHALL CONTAIN THE INFORMATION IN FORM 6000NOO. IF THE HYDRAULIC FRACTURING OPERATIONS SCHEDULE CHANGES AFTER NOTICE HAS BEEN PROVIDED, RESULTING IN A DELAY OF OPERATIONS OF MORE THAN 5 DAYS FROM THE INITIAL NOTICE, NEW NOTICE IS REQUIRED TO BE GIVEN;</p> <p>2) NOTICE WILL BE GIVEN TO THE OCC CENTRAL OFFICE AND LOCAL DISTRICT OFFICES AT LEAST 48 HOURS PRIOR TO COMMENCEMENT OF HYDRAULIC FRACTURING OPERATIONS. FORM 6000NHF SHALL BE USED AND IS FOUND AT THIS LINK: OCCEWEB.COM/OG/OGFORMS.HTML; AND,</p> <p>3) THE CHEMICAL DISCLOSURE OF HYDRAULIC FRACTURING INGREDIENTS FOR ALL WELLS IS TO BE REPORTED TO FRACFOCUS WITHIN 60 DAYS AFTER THE CONCLUSION OF HYDRAULIC FRACTURING OPERATIONS, FOUND AT FRACFOCUS.ORG</p>
LOCATION EXCEPTION - 719381	<p>[8/26/2021 - G56] - (F.O.) SW4 28-5N-4E X716872 CLVD, HNTN, VIOL, OTHERS SHL 530' FNL, 530' FEL OGP OPERATING, INC 7/9/2021</p>
SPACING - 716872	<p>[8/26/2021 - G56] - (160) W2 28-5N-4E VAC 13201/22170 HNTN EST CLVD, HNTN, VIOL, OTHERS</p>

WELL LOCATION

KEEL #128
OGP OPERATING, INC.
SECTION 28, TOWNSHIP 5N, RANGE 4E, I.M.
PONTOTOC COUNTY, OKLAHOMA

LEGEND

SECTION LINE
QUARTER SECTION LINE
16TH LINE



SCALE: 1" = 1000'

0' 500' 1000'

ALT. SURFACE LOCATION
1980' FSL & 1980' FWL
NAD-27
X= 2333379
Y= 562647
LAT.: 34°52'27.6" N
LONG.: 96°53'18.7" W
LAT.: 34.874388° N
LONG.: 96.888528° W
ELEV.: 1050'

X= 2331392
Y= 563294

SURFACE LOCATION
2110' FSL & 2110' FWL
NAD-27
X= 2333507
Y= 562778
LAT.: 34°52'29.1" N
LONG.: 96°53'17.1" W
LAT.: 34.874745° N
LONG.: 96.888085° W
ELEV.: 1050'

X= 2331421
Y= 560648

X= 2334052
Y= 560673

KEEL #1

KEEL #1
(ALT.)

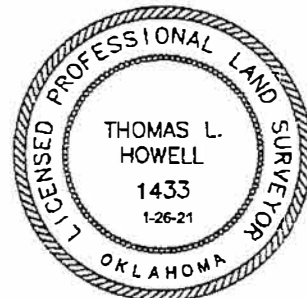

SURVEYOR'S CERTIFICATE:

I, THOMAS L. HOWELL, AN OKLAHOMA LICENSED LAND SURVEYOR AND AN AUTHORIZED AGENT OF TOPOGRAPHIC LAND SURVEYORS, DO HEREBY CERTIFY TO THE INFORMATION SHOWN HEREIN.

Thomas L. Howell

Thomas L. Howell, P.L.S. No. 1433
Authorized Agent of Topographic Land Surveyors



LEASE NAME & WELL NO.

KEEL #1

SECTION 28 TWP 5N RGE 4E MERIDIAN I.M.

COUNTY PONTOTOC STATE OKLAHOMA

DESCRIPTION 2110' FSL & 2110' FWL

KEEL #1

REVISION:

INT DATE

DATE: 01/26/2021

FILE: LO KEEL #1

DRAWN BY: KEU

SHEET: 1 OF 2

NOTES:

1. ORIGINAL DOCUMENT SIZE: 8 1/2" X 11"
2. ALL BEARINGS SHOWN HEREON ARE GRID ACCORDING TO THE RESULTS OF STATIC GPS OBSERVATIONS PROCESSED THROUGH OPUS ON THE CONTROL POINT OCCUPIED WHILE MEASURING BOUND LINES. OPUS RESULTS ARE CORRELATED TO OKLAHOMA SOUTH ZONE, NAD 27 - HORIZONTAL AND THE NATIONAL GEODETIC VERTICAL DATUM OF 1988.
3. CERTIFICATION IS MADE ONLY TO THE LOCATION OF THIS EASEMENT/LOCATION, IN RELATION TO THE EVIDENCE FOUND DURING A FIELD SURVEY, MADE ON THE GROUND, UNDER MY SUPERVISION, AND USING DOCUMENTATION PROVIDED BY OGP OPERATING, INC. ONLY UTILITIES/EASEMENTS THAT WERE VISIBLE ON THE DATE OF THIS SURVEY, WITHIN ADJOINING THIS EASEMENT/LOCATION, HAVE BEEN LOCATED AS SHOWN HEREON OF WHICH I HAVE KNOWLEDGE. THIS CERTIFICATION IS LIMITED TO THOSE PERSONS OR ENTITIES SHOWN ON THE FACE OF THIS PLAT AND IS NON-TRANSFERABLE, AND MADE FOR THIS TRANSACTION ONLY.
4. LANDING POINT, BOTTOM HOLE, AND DRILL PATH INFORMATION PROVIDED BY OPERATOR AS SHOWN AND ARE NOT SURVEYED LOCATIONS.
5. THE INFORMATION SHOWN HEREIN IS FOR CONSTRUCTION PURPOSES ONLY