

OKLAHOMA CORPORATION COMMISSION
OIL & GAS CONSERVATION DIVISION
P.O. BOX 52000
OKLAHOMA CITY, OK 73152-2000
(Rule 165:10-3-1)

API NUMBER: 003 23373

Approval Date: 04/22/2019

Expiration Date: 10/22/2020

Straight Hole

Oil & Gas

PERMIT TO DRILL

WELL LOCATION: Sec: 13 Twp: 29N Rge: 12W

County: ALFALFA

SPOT LOCATION:

FEET FROM QUARTER: FROM SOUTH FROM EAST

SECTION LINES: 2310 1750

Lease Name: KILMER A

Well No: 1-13

Well will be 1750 feet from nearest unit or lease boundary.

Operator Name: TRANS PACIFIC OIL CORPORATION

Telephone: 3162623596

OTC/OCC Number: 23435 0

TRANS PACIFIC OIL CORPORATION
100 S MAIN ST STE 200
WICHITA, KS 67202-3735

SHIRLEY M. KILMER
510 S. 10TH STREET
KIOWA KS 67070

Formation(s) (Permit Valid for Listed Formations Only):

	Name	Depth		Name	Depth
1	DOUGLAS	4050	6	MISENER	5220
2	KANSAS CITY	4320	7	SYLVAN DOLO	5230
3	OSWEGO	4625	8	HUNTON	5240
4	CHEROKEE	4730	9	VIOLA	5260
5	MISSISSIPPIAN	4835	10	SIMPSON	5355

Spacing Orders: 694326

Location Exception Orders:

Increased Density Orders:

Pending CD Numbers:

Special Orders:

Total Depth: 5750

Ground Elevation: 1279

Surface Casing: 1000

Depth to base of Treatable Water-Bearing FM: 140

Under Federal Jurisdiction: No

Fresh Water Supply Well Drilled: No

Surface Water used to Drill: No

PIT 1 INFORMATION

Type of Pit System: ON SITE

Type of Mud System: WATER BASED

Chlorides Max: 60000 Average: 5000

Is depth to top of ground water greater than 10ft below base of pit? Y

Within 1 mile of municipal water well? N

Wellhead Protection Area? N

Pit is located in a Hydrologically Sensitive Area.

Category of Pit: 1B

Liner required for Category: 1B

Pit Location is BED AQUIFER

Pit Location Formation: BISON

Approved Method for disposal of Drilling Fluids:

A. Evaporation/dewater and backfilling of reserve pit.

H. MIN. SOIL COMPACTED PIT, NOTIFY DISTRICT PRIOR TO TESTING SOIL PIT LINER

Notes:

This permit does not address the right of entry or settlement of surface damages.

The duration of this permit is SIX MONTHS, except as otherwise provided by Rule 165: 10-3-1.

Rule 165: 10-3-4 (c) (7) (e) - The Operator shall give 24 Hours notice by telephone to the appropriate District Office of the Conservation Division as to when Surface Casing will be run.

003 23373 KILMER A 1-13

Category	Description
DEEP SURFACE CASING	4/16/2019 - G71 - APPROVED; NOTIFY OCC FIELD INSPECTOR IMMEDIATELY OF ANY LOSS OF CIRCULATION OR FAILURE TO CIRCULATE CEMENT TO SURFACE ON ANY CONDUCTOR OR SURFACE CASING
HYDRAULIC FRACTURING	<p>4/16/2019 - G71 - OCC 165:10-3-10 REQUIRES:</p> <p>1) PRIOR TO COMMENCEMENT OF HYDRAULIC FRACTURING OPERATIONS FOR HORIZONTAL WELLS, NOTICE GIVEN FIVE BUSINESS DAYS IN ADVANCE TO OFFSET OPERATORS WITH WELLS COMPLETED IN THE SAME COMMON SOURCE OF SUPPLY WITHIN 1/2 MILE;</p> <p>2) WITH NOTICE ALSO GIVEN 48 HOURS IN ADVANCE OF HYDRAULIC FRACTURING ALL WELLS TO BOTH THE OCC CENTRAL OFFICE AND LOCAL DISTRICT OFFICES, USING THE "FRAC NOTICE FORM" FOUND AT THE FOLLOWING LINK: OCCWEB.COM/OG/OGFORMS.HTML; AND,</p> <p>3) THE CHEMICAL DISCLOSURE OF HYDRAULIC FRACTURING INGREDIENTS FOR ALL WELLS TO BE REPORTED TO FRACFOCUS WITHIN 60 DAYS AFTER THE CONCLUSION THE HYDRAULIC FRACTURING OPERATIONS, USING THE FOLLOWING LINK: FRACFOCUS.ORG</p>
SPACING - 694326	<p>4/22/2019 - GB1 - (640) 13-29N-12W</p> <p>EXT 148489 CHRK, MSNR, SLVND, VIOL, SMPS</p> <p>EXT 212595 KSSC</p> <p>EXT 593762 OSWG, MSSP</p> <p>EST HNTN, DGLS</p>

API 003-23373

**TRANS PACIFIC OIL CORPORATION
KILMER LEASE
SE. 1/4, SECTION 13, T29N, R12W
ALFALFA COUNTY, OKLAHOMA**

Directions:

From the intersection of Highway 2-8-14 (west) and Highway 8 (south) in Kiowa, Kansas, go 1.26 miles South on Highway 8, then go 2.96 miles East to the NE corner of Section 13, then go 0.43 miles South to a flag on the west edge of road, then go 0.33 miles West to location.

GRAVEL (STATE LINE RD.) ROAD

Notes:

1. Set (2) wood stakes at location site.
2. All flagging Red & Yellow.
3. Overhead power available at N., S. & W. lines. Sec. 13.
4. Oklahoma One Call System Inc. should be notified before excavation (1-800-522-6543).
5. CAUTION; Various pipelines in Sec. 13.
6. Contact landowner for best access and as to location of wood stakes in wheat.

Drillsite Location
Kilmer Trust "A" #1-13
2310' FSL 1750' FEL
Ground Elevation = 1279

Y = 725451 X = 1870881

State Plane-NAD 27-OKlahoma North

Latitude 36.99204

Longitude -98.44243

NAD 84-NAD 83

GRAVEL (CR 560) ROAD

GRAVEL (CR 570) ROAD

SCALE 1" = 1000'

FLAGGED ROAD
OPPOSITE LOC.

GRAVEL

(OSAGE RD.)

FLAGGED ROAD
OPPOSITE LOC.

ROAD

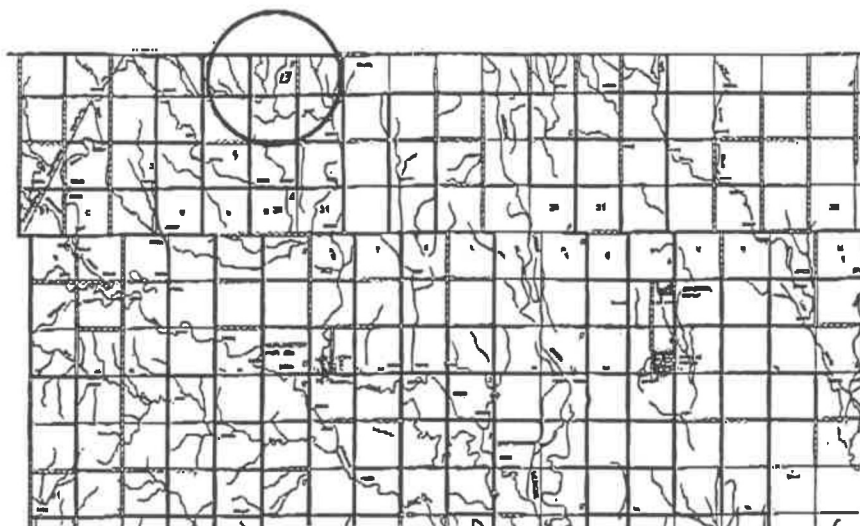

• Controlling data is based upon the best maps and photographs available to us and upon a regular section of land containing 640 acres.

• Approximate section lines were determined using the normal standard of care of oilfield surveyors practicing in the state of Oklahoma. The section corners, which establish the precise section lines, were not necessarily located, and the exact location of the drillsite location in the section is not guaranteed. Therefore, the operator assuming this service and accepting this plot and all other parties accepting this plot agree to hold Central Kansas Oilfield Services, Inc., its officers and employees harmless from all losses, costs and expenses and said entities released from any liability from incidental or consequential damages.

• Elevations derived from National Geodetic Vertical Datum.

Date April 15, 2019

CENTRAL KANSAS OILFIELD SERVICES, INC. (620)792-1977

* Ingress and egress to location as shown on this plot is for public use only and may not be legally opened for public use. Contact landowner, tenant and county road department for access.