

OKLAHOMA CORPORATION COMMISSION
OIL & GAS CONSERVATION DIVISION
P.O. BOX 52000
OKLAHOMA CITY, OK 73152-2000
(Rule 165:10-3-1)

API NUMBER: 011 24229

Approval Date: 07/02/2019

Expiration Date: 01/02/2021

Horizontal Hole
Multi Unit

Oil & Gas

PERMIT TO DRILL

WELL LOCATION: Sec: 01 Twp: 14N Rge: 13W

County: BLAINE

SPOT LOCATION: ☐ NE ☐ NE ☐ NW ☐ NW

FEET FROM QUARTER: FROM NORTH FROM WEST

SECTION LINES: 285 1000

Lease Name: SIMMONS 3-01-12

Well No: 1413MHX

Well will be 285 feet from nearest unit or lease boundary.

Operator Name: TRIUMPH ENERGY PARTNERS LLC

Telephone: 9189868266

OTC/OCC Number: 23826 0

TRIUMPH ENERGY PARTNERS LLC
8908 S YALE AVE STE 250
TULSA, OK 74137-3557

TONY SIMMONS
201 ELM DRIVE
WATONGA OK 73772

Formation(s) (Permit Valid for Listed Formations Only):

Name	Depth	Name	Depth
1 MISS'AN LM	12200	6	
2		7	
3		8	
4		9	
5		10	

Spacing Orders: 137604
582213
695588

Location Exception Orders: 690836

Increased Density Orders: 690389
690390

Pending CD Numbers:

Special Orders:

Total Depth: 23011

Ground Elevation: 1711

Surface Casing: 1500

Depth to base of Treatable Water-Bearing FM: 210

Under Federal Jurisdiction: No

Fresh Water Supply Well Drilled: No

Surface Water used to Drill: Yes

PIT 1 INFORMATION

Approved Method for disposal of Drilling Fluids:

Type of Pit System: CLOSED Closed System Means Steel Pits

Type of Mud System: WATER BASED

Chlorides Max: 8000 Average: 5000

Is depth to top of ground water greater than 10ft below base of pit? Y

Within 1 mile of municipal water well? N

Wellhead Protection Area? N

Pit is located in a Hydrologically Sensitive Area.

Category of Pit: C

Liner not required for Category: C

Pit Location is AP/TE DEPOSIT

Pit Location Formation: TERRACE

D. One time land application -- (REQUIRES PERMIT)

PERMIT NO: 19-36287

H. SEE MEMO

This permit does not address the right of entry or settlement of surface damages.

The duration of this permit is SIX MONTHS, except as otherwise provided by Rule 165: 10-3-1.

Rule 165: 10-3-4 (c) (7) (e) - The Operator shall give 24 Hours notice by telephone to the appropriate District Office of the Conservation Division as to when Surface Casing will be run.

PIT 2 INFORMATION

Type of Pit System: CLOSED Closed System Means Steel Pits

Type of Mud System: OIL BASED

Chlorides Max: 300000 Average: 200000

Is depth to top of ground water greater than 10ft below base of pit? Y

Within 1 mile of municipal water well? N

Wellhead Protection Area? N

Pit is located in a Hydrologically Sensitive Area.

Category of Pit: C

Liner not required for Category: C

Pit Location is AP/TE DEPOSIT

Pit Location Formation: TERRACE

HORIZONTAL HOLE 1

Sec 12 Twp 14N Rge 13W County BLAINE

Spot Location of End Point: S2 S2 S2 SW

Feet From: SOUTH 1/4 Section Line: 50

Feet From: WEST 1/4 Section Line: 1320

Depth of Deviation: 11791

Radius of Turn: 637

Direction: 178

Total Length: 10220

Measured Total Depth: 23011

True Vertical Depth: 12200

End Point Location from Lease,
Unit, or Property Line: 50

Notes:

Category

Description

DEEP SURFACE CASING

6/28/2019 - G71 - APPROVED; NOTIFY OCC FIELD INSPECTOR IMMEDIATELY OF ANY LOSS OF CIRCULATION OR FAILURE TO CIRCULATE CEMENT TO SURFACE ON ANY CONDUCTOR OR SURFACE CASING

HYDRAULIC FRACTURING

6/28/2019 - G71 - OCC 165:10-3-10 REQUIRES:

1) PRIOR TO COMMENCEMENT OF HYDRAULIC FRACTURING OPERATIONS FOR HORIZONTAL WELLS, NOTICE GIVEN FIVE BUSINESS DAYS IN ADVANCE TO OFFSET OPERATORS WITH WELLS COMPLETED IN THE SAME COMMON SOURCE OF SUPPLY WITHIN 1/2 MILE;

2) WITH NOTICE ALSO GIVEN 48 HOURS IN ADVANCE OF HYDRAULIC FRACTURING ALL WELLS TO BOTH THE OCC CENTRAL OFFICE AND LOCAL DISTRICT OFFICES, USING THE "FRAC NOTICE FORM" FOUND AT THE FOLLOWING LINK: OCCEWEB.COM/OG/OGFORMS.HTML; AND,

3) THE CHEMICAL DISCLOSURE OF HYDRAULIC FRACTURING INGREDIENTS FOR ALL WELLS TO BE REPORTED TO FRACFOCUS WITHIN 60 DAYS AFTER THE CONCLUSION THE HYDRAULIC FRACTURING OPERATIONS, USING THE FOLLOWING LINK: FRACFOCUS.ORG

INCREASED DENSITY - 690389

7/2/2019 - G56 - 1-14N-13W
X582213 MPLM
3 WELLS
TRIUMPH ENERGY PARTNERS, LLC
1/25/2019

INCREASED DENSITY - 690390

7/2/2019 - G56 - 12-14N-13W
X137604 MPLM
3 WELLS
TRIUMPH ENERGY PARTNERS, LLC
1/25/2019

This permit does not address the right of entry or settlement of surface damages.

011 24229 SIMMONS 3-01-12 1413MHX

The duration of this permit is SIX MONTHS, except as otherwise provided by Rule 165: 10-3-1.

Rule 165: 10-3-4 (c) (7) (e) - The Operator shall give 24 Hours notice by telephone to the appropriate District Office of the Conservation Division as to when Surface Casing will be run.

Category	Description
INTERMEDIATE CASING	6/28/2019 - G71 - DUE TO THE KNOWN POTENTIAL RISK OF ENCOUNTERING AN OVER-PRESSURED ZONE IN THE MORROW SERIES IN THIS AREA, THE TECHNICAL MANAGER RECOMMENDS SETTING AN INTERMEDIATE STRING OF CASING IMMEDIATELY ABOVE THE MORROW SERIES
LOCATION EXCEPTION - 690836	7/2/2019 - G56 - (I.O.) 1 & 12-14N-13W X582213 MPLM 1-14N-13W X137604 MPLM 12-14N-13W COMPL INT (1-14N-13W) NCT 165' FNL, NCT 0' FSL, NCT 1000' FWL COMPL INT (12-14N-13W) NCT 0' FNL ,NCT 165' FSL, NCT 1000' FWL TRIUMPH ENERGY PARTNERS, LLC 2/4/2019
MEMO	6/28/2019 - G71 - PITS 1 & 2 - CLOSED SYSTEM=STEEL PITS PER OPERATOR REQUEST, PIT 2 - OBM RETURNED TO VENDOR, CUTTINGS PERMITTED PER DISTRICT
SPACING - 137604	7/2/2019 - G56 - (640) 12-14N-13W EXT OTHERS EXT 102663/117120 MPLM, OTHERS
SPACING - 582213	7/2/2019 - G56 - (640) 1-14N-13W EST OTHERS EXT OTHERS EXT 137604 MPLM, OTHERS
SPACING - 695588	7/2/2019 - G56 - (I.O.) 1 & 12-14N-13W ESTABLISH MULTIUNIT HORIZONTAL WELL X582213 MPLM 1-14N-13W X137604 MPLM 12-14N-13W 50% 1-14N-13W 50% 12-14N-13W TRIUMPH ENERGY PARTNERS, LLC 5/3/2019

LEGEND:

- - PROPOSED WELLHEAD.
- ◊ - LANDING/LAST TAKE POINT
- - TARGET BOTTOM HOLE.
- ▲ - SECTION CORNERS LOCATED.

NOTE:

- Distances referenced on plat to section lines are perpendicular.

T14N, R13W, I.M.

LINE TABLE

LINE	DIRECTION	LENGTH
L1	N69°41'18"E	341.74'
L2	S00°10'03"W	115.00'

NAD 83 (SURFACE LOCATION)	NAD 83 (END OF LATERAL)
LATITUDE = 35°43'27.88" (35.724410)	LATITUDE = 35°41'47.10" (35.696417)
LONGITUDE = 98°32'24.02" (98.540004)	LONGITUDE = 98°32'20.26" (98.538961)
NAD 27 (SURFACE LOCATION)	NAD 27 (END OF LATERAL)
LATITUDE = 35°43'27.71" (35.724363)	LATITUDE = 35°41'46.93" (35.696369)
LONGITUDE = 98°32'22.75" (98.539652)	LONGITUDE = 98°32'18.99" (98.538610)
STATE PLANE NAD 83 (OK. NORTH)	STATE PLANE NAD 83 (OK. NORTH)
N: 264143.78 E: 1808211.13	N: 253952.45 E: 1808464.19
STATE PLANE NAD 27 (OK. NORTH)	STATE PLANE NAD 27 (OK. NORTH)
N: 264118.97 E: 1839811.88	N: 253927.69 E: 1840064.70

BASIS OF BEARINGS

BASIS OF BEARINGS IS A GPS OBSERVATION

BASIS OF ELEVATION

BASED ON NGS CONTROL STATION FK0642 WITH A PUBLISHED ELEVATION OF 1475.33' (NAVD88) AND A PUBLISHED POSITION OF LAT: N35°39'21.49179" LONG: W98°19'42.80094" (NAVD83(2011)).



UELS, LLC
Corporate Office • 85 South 200 East
Vernal, UT 84078 • (435) 789-1017



REV: 2 04-23-19 T.A. (WELL NAME CHANGE & SL CHANGE)

TRIUMPH ENERGY PARTNERS, LLC

SIMMONS 03-01-12#413MHX

285' FNL 1000' FWL

LOT 4 SECTION 1, T14N, R13W, I.M.

BLAINE COUNTY, OKLAHOMA

SURVEYED BY	J.P.	11-07-18	SCALE
DRAWN BY	K.M.R.	11-15-18	1" = 1000'

WELL LOCATION PLAT

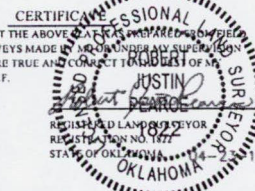

THIS IS TO CERTIFY THAT THE ABOVE SURVEY WAS MADE IN ACCORDANCE WITH THE NOTES OF ACTUAL SURVEYS MADE BY ME OR UNDER MY SUPERVISION AND THAT THE SAME ARE TRUE AND CORRECT TO THE BEST OF MY KNOWLEDGE AND BELIEF.

