

OKLAHOMA CORPORATION COMMISSION  
OIL & GAS CONSERVATION DIVISION  
P.O. BOX 52000  
OKLAHOMA CITY, OK 73152-2000  
(Rule 165:10-3-1)

API NUMBER: 073 26512

Approval Date: 03/21/2019

Expiration Date: 09/21/2020

Horizontal Hole  
Multi Unit

Oil & Gas

PERMIT TO DRILL

WELL LOCATION: Sec: 05 Twp: 15N Rge: 8W County: KINGFISHER

SPOT LOCATION: ☐ NW ☐ NE ☐ NE ☐ NW FEET FROM QUARTER: FROM NORTH FROM WEST

SECTION LINES: 240 2230

Lease Name: BREDEL FIU 1508 Well No: 7H-5X Well will be 240 feet from nearest unit or lease boundary.

Operator Name: NEWFIELD EXPLORATION MID-CON INC

Telephone: 2812105100; 9188781

OTC/OCC Number: 20944 0

NEWFIELD EXPLORATION MID-CON INC  
4 WATERWAY SQUARE PL STE 100  
THE WOODLANDS, TX 77380-2764

MICHAEL A. HIMES  
25885 NORTH 2760 ROAD  
KINGFISHER OK 73750

Formation(s) (Permit Valid for Listed Formations Only):

Name	Depth	Name	Depth
1 MISSISSIPPIAN	8826	6	
2		7	
3		8	
4		9	
5		10	

Spacing Orders: 608292  
692667

Location Exception Orders: 691325  
691326

Increased Density Orders: 689315  
689316

Pending CD Numbers: 201901844

Special Orders:

Total Depth: 19276 Ground Elevation: 1164

**Surface Casing: 1500**

Depth to base of Treatable Water-Bearing FM: 70

Under Federal Jurisdiction: Yes

Fresh Water Supply Well Drilled: No

Surface Water used to Drill: No

PIT 1 INFORMATION

Approved Method for disposal of Drilling Fluids:

Type of Pit System: CLOSED Closed System Means Steel Pits

Type of Mud System: WATER BASED

Chlorides Max: 5000 Average: 3000

E. Haul to Commercial pit facility: Sec. 31 Twn. 12N Rng. 8W Cnty. 17 Order No: 587498

Is depth to top of ground water greater than 10ft below base of pit? Y

H. SEE MEMO

Within 1 mile of municipal water well? N

Wellhead Protection Area? N

Pit is not located in a Hydrologically Sensitive Area.

Category of Pit: C

Liner not required for Category: C

Pit Location is NON HSA

Pit Location Formation: CHICKASHA

This permit does not address the right of entry or settlement of surface damages.

The duration of this permit is SIX MONTHS, except as otherwise provided by Rule 165: 10-3-1.

Rule 165: 10-3-4 (c) (7) (e) - The Operator shall give 24 Hours notice by telephone to the appropriate District Office of the Conservation Division as to when Surface Casing will be run.

## PIT 2 INFORMATION

Type of Pit System: CLOSED Closed System Means Steel Pits

Type of Mud System: OIL BASED

Chlorides Max: 300000 Average: 200000

Is depth to top of ground water greater than 10ft below base of pit? Y

Within 1 mile of municipal water well? N

Wellhead Protection Area? N

Pit is not located in a Hydrologically Sensitive Area.

Category of Pit: C

Liner not required for Category: C

Pit Location is NON HSA

Pit Location Formation: CHICKASHA

## HORIZONTAL HOLE 1

Sec 08 Twp 15N Rge 8W County KINGFISHER

Spot Location of End Point: SE SW SW SW

Feet From: SOUTH 1/4 Section Line: 85

Feet From: WEST 1/4 Section Line: 380

Depth of Deviation: 8189

Radius of Turn: 573

Direction: 195

Total Length: 10187

Measured Total Depth: 19276

True Vertical Depth: 9197

End Point Location from Lease,  
Unit, or Property Line: 85

Additional Surface Owner	Address	City, State, Zip
JANET C. HIMES	25885 N. 2760 ROAD	KINGFISHER, OK 73750

### Notes:

#### Category

#### Description

DEEP SURFACE CASING

1/16/2019 - G71 - APPROVED; NOTIFY OCC FIELD INSPECTOR IMMEDIATELY FOR ANY LOSS OF CIRCULATION OR FAILURE TO CIRCULATE CEMENT TO SURFACE ON CONDUCTOR OR SURFACE CASING

EXCEPTION TO RULE - 691326

2/25/2019 - G75 - (I.O.) 5 & 8-15N-8W  
X165:10-3-28(C)(2)(B) MSSP (BREDEL FIU 1508 7H-5X)  
MAY BE CLOSER THAN 600' TO EXISTING/PROPOSED WELLS  
NEWFIELD EXPLOR. MID-CONT. INC.  
2-13-2019

HYDRAULIC FRACTURING

1/16/2019 - G71 - OCC 165:10-3-10 REQUIRES:

1) PRIOR TO COMMENCEMENT OF HYDRAULIC FRACTURING OPERATIONS FOR HORIZONTAL WELLS, NOTICE GIVEN FIVE BUSINESS DAYS IN ADVANCE TO OFFSET OPERATORS WITH WELLS COMPLETED IN THE SAME COMMON SOURCE OF SUPPLY WITHIN 1/2 MILE;

2) WITH NOTICE ALSO GIVEN 48 HOURS IN ADVANCE OF HYDRAULIC FRACTURING ALL WELLS TO BOTH THE OCC CENTRAL OFFICE AND LOCAL DISTRICT OFFICES, USING THE "FRAC NOTICE FORM" FOUND AT THE FOLLOWING LINK:  
[OCCWEB.COM/OG/OGFORMS.HTML](http://OCCWEB.COM/OG/OGFORMS.HTML); AND,

3) THE CHEMICAL DISCLOSURE OF HYDRAULIC FRACTURING INGREDIENTS FOR ALL WELLS TO BE REPORTED TO FRACFOCUS WITHIN 60 DAYS AFTER THE CONCLUSION THE HYDRAULIC FRACTURING OPERATIONS, USING THE FOLLOWING LINK: [FRACFOCUS.ORG](http://FRACFOCUS.ORG)

This permit does not address the right of entry or settlement of surface damages.

073 26512 BREDEL FIU 1508 7H-5X

The duration of this permit is SIX MONTHS, except as otherwise provided by Rule 165: 10-3-1.

Rule 165: 10-3-4 (c) (7) (e) - The Operator shall give 24 Hours notice by telephone to the appropriate District Office of the Conservation Division as to when Surface Casing will be run.

Category	Description
INCREASED DENSITY - 689315	2/25/2019 - G75 - 5-15N-8W X608292 MSSP 6 WELLS NEWFIELD EXPLOR. MID-CONT. INC. 1-7-2019
INCREASED DENSITY - 689316	2/25/2019 - G75 - 8-15N-8W X608292 MSSP 6 WELLS NEWFIELD EXPLOR. MID-CONT. INC. 1-7-2019
INTERMEDIATE CASING	1/16/2019 - G71 - DUE TO THE KNOWN POTENTIAL RISK OF ENCOUNTERING AN OVER-PRESSURED ZONE IN THE MORROW SERIES IN THIS AREA, THE TECHNICAL MANAGER RECOMMENDS SETTING AN INTERMEDIATE STRING OF CASING IMMEDIATELY ABOVE THE MORROW SERIES
LOCATION EXCEPTION - 691325	2/25/2019 - G75 - (I.O.) 5 & 8-15N-8W X608292 MSSP COMPL. INT. (5-15N-8W) NCT 165' FNL, NCT 0' FSL, NCT 330' FWL COMPL. INT. (8-15N-8W) NCT 0' FNL, NCT 165' FSL, NCT 330' FWL NEWFIELD EXPLOR. MID-CONT. INC. 2-13-2019
MEMO	1/16/2019 - G71 - PIT 1 & 2 - CLOSED SYSTEM = STEEL PITS PER OPERATOR REQUEST; WBM, WBM & OBM CUTTINGS CAPTURED IN STEEL HALF PITS & TRANSFERRED TO R360 (ORDER #587498); PIT 2 - OBM TO VENDOR
PENDING CD - 201901844	3/20/2019 - G75 - MODIFY 608292 TO COEXIST SP. ORDER # 91355 MISS E2 NW4 5-15N-8W HEARING 4-9-2019 (OK'D PER MCCOY)
SPACING - 608292	2/25/2019 - G75 - (640)(HOR) 5 & 8-15N-8W VAC 91355 MNNG, MISS W2 NW4, SW4, E2 5-15N-8W VAC 91355 MISS E2 NW4 5-15N-8W ** VAC 91355 MNNG, MISS E2 W2, E2 8-15N-8W EST MSSP, OTHER POE TO BHL NCT 660' FB (COEXIST SP. ORDER # 91355 MNNG E2 NW4 5-15N-8W; ORDER # 91355 MNNG, MISS W2 W2 8-15N-8W)
SPACING - 692667	** S/B COEXIST 91355 MISS E2 NW4 5-15N-8W; CORRECTED BY CD # 201901844 3/21/2019 - G75 - (I.O.) 5 & 8-15N-8W EST MULTIUNIT HORIZONTAL WELL X608292 MSSP 50% 5-15N-8W 50% 8-15N-8W NEWFIELD EXPLOR. MID-CONT. INC. 3-11-2019

# TOPOGRAPHIC LAND SURVEYS OF OKLAHOMA

13800 WIRELESS WAY, OKLA. CITY, OKLA. 73134 \* LOCAL (405) 843-4847 \* OUT OF STATE (800) 654-3219  
Certificate of Authorization No. 1293 LS

KINGFISHER

County, Oklahoma

API 073-26512

240'FNL-2230'FWL Section 5 Township 15N Range 8W I.M.

## PERMIT PLAT

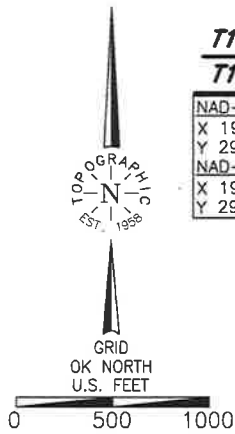

### NOTES:

- The information shown herein is for construction purposes ONLY.
- Section 5 is not within a flood zone.
- All bearings shown are Grid, NAD-27, Oklahoma North.
- Landing Point, Last Take Point, Bottom Hole and Drill Path information provided by client listed, not surveyed.

### SURFACE LOCATION

DATUM: NAD-27  
LAT: 35°48'42.0" N  
LONG: 98°04'32.7" W  
LAT: 35.811671° N  
LONG: 98.075739° W  
STATE PLANE  
COORDINATES: (US Feet)  
ZONE: OK NORTH  
X: 1977543  
Y: 295464

DATUM: NAD-83  
LAT: 35°48'42.2" N  
LONG: 98°04'33.9" W  
LAT: 35.811717° N  
LONG: 98.076072° W  
STATE PLANE  
COORDINATES: (US Feet)  
ZONE: OK NORTH  
X: 1945944  
Y: 295488

This information was gathered with a GPS receiver with ±1 foot Horiz./Vert. accuracy.

### CERTIFICATE:

I, Thomas L. Howell an Oklahoma Licensed Land Surveyor and an authorized agent of Topographic Land Surveys of Oklahoma, do hereby certify to the information shown herein.

*Thomas L. Howell*

Oklahoma Lic. No. 1433



Operator: NEWFIELD EXPLORATION

Lease Name: BREDEL FIU 1508

Topography & Vegetation Location fell in wheat field.

Good Drill Site? Yes

Best Accessibility to Location From North off county road

Distance & Direction

from Hwy Jct or Town From Okarche, Oklahoma, go ±5 miles West, then ±6 miles North to the Northeast Corner of Section 5, T15N-R8W.

Reference Stakes or Alternate Location  
Stakes Set None

Invoice # 300574B

Well No.: 7H-5X

Date of Drawing: October 25, 2018

Date Staked: October 3, 2018

NB

### ELEVATION:

1164' Gr. at Stake (NGVD 29)

