

OKLAHOMA CORPORATION COMMISSION
OIL & GAS CONSERVATION DIVISION
P.O. BOX 52000
OKLAHOMA CITY, OK 73152-2000
(Rule 165:10-3-1)

API NUMBER: 045 23782

Approval Date: 02/05/2019

Expiration Date: 08/05/2020

Horizontal Hole
Multi Unit
Oil & Gas

PERMIT TO DRILL

WELL LOCATION: Sec: 13 Twp: 18N Rge: 24W County: ELLIS

SPOT LOCATION: FEET FROM QUARTER: FROM NORTH FROM EAST

SECTION LINES: 300 660

Lease Name: TIGER MUSKIE 12X1-18-24

Well No: 3HC

Well will be 300 feet from nearest unit or lease boundary.

Operator
Name: FOURPOINT ENERGY LLC

Telephone: 3032900990

OTC/OCC Number: 23429 0

FOURPOINT ENERGY LLC
100 SAINT PAUL ST STE 400
DENVER, CO 80206-5140

LAURA CORSE
12224 EAST PALAMINO ROAD
SCOTTSDALE AZ 85259

Formation(s) (Permit Valid for Listed Formations Only):

Name	Depth	Name	Depth
1 CLEVELAND	9020	6	
2		7	
3		8	
4		9	
5		10	

Spacing Orders: 68593

Location Exception Orders:

Increased Density Orders:

Pending CD Numbers: 201810689
201810690

Special Orders:

Total Depth: 19860

Ground Elevation: 2482

Surface Casing: 820

Depth to base of Treatable Water-Bearing FM: 770

Under Federal Jurisdiction: No

Fresh Water Supply Well Drilled: No

Surface Water used to Drill: Yes

PIT 1 INFORMATION

Approved Method for disposal of Drilling Fluids:

Type of Pit System: CLOSED Closed System Means Steel Pits

Type of Mud System: WATER BASED

Chlorides Max: 40000 Average: 5000

Is depth to top of ground water greater than 10ft below base of pit? Y

Within 1 mile of municipal water well? N

Wellhead Protection Area? N

Pit is located in a Hydrologically Sensitive Area.

Category of Pit: C

Liner not required for Category: C

Pit Location is BED AQUIFER

Pit Location Formation: OGALLALA

D. One time land application -- (REQUIRES PERMIT)

PERMIT NO: 19-36174

H. CLOSED SYSTEM=STEEL PITS PER OPERATOR REQUEST

This permit does not address the right of entry or settlement of surface damages.

The duration of this permit is SIX MONTHS, except as otherwise provided by Rule 165: 10-3-1.

Rule 165: 10-3-4 (c) (7) (e) - The Operator shall give 24 Hours notice by telephone to the appropriate District Office of the Conservation Division as to when Surface Casing will be run.

HORIZONTAL HOLE 1

Sec 01 Twp 18N Rge 24W County ELLIS

Spot Location of End Point: N2 N2 NE NE

Feet From: NORTH 1/4 Section Line: 50

Feet From: EAST 1/4 Section Line: 660

Depth of Deviation: 8732

Radius of Turn: 573

Direction: 360

Total Length: 10228

Measured Total Depth: 19860

True Vertical Depth: 9317

End Point Location from Lease,
Unit, or Property Line: 50

Notes:

Category

Description

HYDRAULIC FRACTURING

1/31/2019 - G71 - OCC 165:10-3-10 REQUIRES:

1) PRIOR TO COMMENCEMENT OF HYDRAULIC FRACTURING OPERATIONS FOR HORIZONTAL WELLS, NOTICE GIVEN FIVE BUSINESS DAYS IN ADVANCE TO OFFSET OPERATORS WITH WELLS COMPLETED IN THE SAME COMMON SOURCE OF SUPPLY WITHIN 1/2 MILE;

2) WITH NOTICE ALSO GIVEN 48 HOURS IN ADVANCE OF HYDRAULIC FRACTURING ALL WELLS TO BOTH THE OCC CENTRAL OFFICE AND LOCAL DISTRICT OFFICES, USING THE "FRAC NOTICE FORM" FOUND AT THE FOLLOWING LINK: OCCWEB.COM/OG/OGFORMS.HTML; AND,

3) THE CHEMICAL DISCLOSURE OF HYDRAULIC FRACTURING INGREDIENTS FOR ALL WELLS TO BE REPORTED TO FRACFOCUS WITHIN 60 DAYS AFTER THE CONCLUSION THE HYDRAULIC FRACTURING OPERATIONS, USING THE FOLLOWING LINK: FRACFOCUS.ORG

PENDING CD - 201810689

2/5/2019 - G56 - (I.O.) 12 & 1-18N-24W
ESTABLISH MULTIUNIT HORIZONTAL WELL
X68593 12 & 1-18N-24W
50% 12-18N-24W
50% 1-18N-24W
NO OP NAMED
REC 1/14/2019 (JOHNSON)

PENDING CD - 201810690

2/5/2019 - G56 - (I.O.) 12 & 1-18N-24W
X68593 12 & 1-18N-24W
COMPL INT (12-18N-24W) NCT 165' FSL, NCT 0' FNL, NCT 550' FEL
COMPL INT (1-18N-24W) NCT 0' FSL, NCT 165' FNL, NCT 550' FEL
NO OP NAMED
REC 1/14/2019 (JOHNSON)

SPACING - 68593

2/5/2019 - G56 - (640) 12-18N-24W
EST CLVD, OTHERS

This permit does not address the right of entry or settlement of surface damages.

045 23782 TIGER MUSKIE 12X1-18-24 3HC

The duration of this permit is SIX MONTHS, except as otherwise provided by Rule 165: 10-3-1.

Rule 165: 10-3-4 (c) (7) (e) - The Operator shall give 24 Hours notice by telephone to the appropriate District Office of the Conservation Division as to when Surface Casing will be run.

PROPOSED NEW WELL LOCATION PLAT

COMPANY FOURPOINT ENERGY, LLC LEASE TIGER MUSKIE 12X1-18-24 WELL NO. 3HC
 SECTION 13 TOWNSHIP 18-N RANGE 24-WM LOCATION 300' FNL 660' FEL
 COUNTY ELLIS STATE OKLAHOMA TOPOGRAPHY AND VEGETATION ROLLING SANDHILLS
 LATITUDE 36°02'30.82" LONGITUDE -99°42'16.01" NAD27 ELEVATION 2482' NGVD29 DATE STAKED 5/16/18
 DIRECTION FROM NEAREST TOWN APPROXIMATELY 7.5 MILES SOUTHEAST OF ARNETT, OKLAHOMA

35-045-23782

OKLA. COORDINATE SYSTEM
 NAD-27
 OKLAHOMA NORTH ZONE
 U.S. FEET

WELL NAME	DISTANCE TO HORIZ.
BERRYMAN UNIT "B" #1	653'

WELL LEGEND
 ○ PERMITTED
 ⊕ DRY HOLE
 ● OIL
 ☆ GAS
 ★ OIL/GAS
 ⊕ PLUGGED OIL
 ☆ PLUGGED GAS
 ★ PLUGGED OIL/GAS

NOTE:

- This plat is intended for Oklahoma Corporation Commission Permit purposes only and is NOT to be relied upon as a boundary survey and is NOT to be used to convey or establish real property interests.
- Bearings and distances shown are based on Grid Azimuth and Grid distance. All X,Y coordinates are based on NAD27, Oklahoma North Zone, U.S. Feet.
- X,Y Coordinates were derived from GPS static survey observations and/or RTK survey methods.

Scale 1" = 1000'



LAND SURVEYING • GIS
 BEYONDMAPPING.COM
 105 HACKBERRY TRAIL • CANADIAN, TX 73014
 (800) 323-9773 • TEXAS PERM NO. 10010100
 CERT. OF AUTH. NO. 7796 EXP. JUNE 30, 2028

FOURPOINT
 ENERGY

TIGER MUSKIE 12X1-18-24 3HC
 FIELD: KB,CMC,OPS
 DRAWN: CM
 DATE: 10/15/18
 CHECKED: MLS
 SHEET: 1 OF 4
 REVISION:

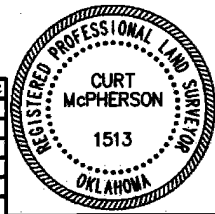

JOB NO. C218-182-1

BOTTOM HOLE LOCATION

50' FNL & 660' FEL OF SECTION 1

NAD27:
 X = 1,496,176
 Y = 394,627
 36°04'19.07"
 -99°42'17.56"
 36.0719639
 -99.7048778
 NAD83:
 X = 1,464,573
 Y = 394,655
 36°04'19.23"
 -99°42'18.96"
 36.0720083
 -99.7052667

LAST TAKE POINT

165' FNL & 660' FEL OF SECTION 1

NAD27:
 X = 1,496,176
 Y = 394,512
 36°04'17.93"
 -99°42'17.53"
 36.0716472
 -99.7048694
 NAD83:
 X = 1,464,573
 Y = 394,540
 36°04'18.09"
 -99°42'18.94"
 36.0716917
 -99.7052611

FIRST TAKE POINT

165' FNL & 660' FEL OF SECTION 12

NAD27:
 X = 1,496,117
 Y = 384,146
 36°02'35.42"
 -99°42'16.04"
 36.0431722
 -99.7044556
 NAD83:
 X = 1,464,514
 Y = 384,174
 36°02'35.58"
 -99°42'17.44"
 36.0432167
 -99.7048444

SURFACE LOCATION

300' FNL & 660' FEL OF SECTION 13

NAD27:
 X = 1,496,111
 Y = 383,681
 36°02'30.82"
 -99°42'16.01"
 36.0418944
 -99.7044472
 NAD83:
 X = 1,464,508
 Y = 383,709
 36°02'30.96"
 -99°42'17.41"
 36.0419389
 -99.7048361

THIS IS TO CERTIFY THAT THE ABOVE PLAT WAS PREPARED FROM FIELD NOTES OF ACTUAL SURVEYS MADE BY MYSELF OR OTHERS UNDER MY SUPERVISION AND THAT THE SAME ARE TRUE AND CORRECT TO THE BEST OF MY KNOWLEDGE AND BELIEF.

SIGNED:

DATED: 10/15/18