

API NUMBER: 017 25666 A

OKLAHOMA CORPORATION COMMISSION
OIL & GAS CONSERVATION DIVISION
P.O. BOX 52000
OKLAHOMA CITY, OK 73152-2000
(Rule 165:10-3-1)

Approval Date: 04/13/2021
Expiration Date: 10/13/2022

Multi Unit Oil & Gas

Amend reason: AMEND BHL

AMEND PERMIT TO DRILL

WELL LOCATION: Section: 11 Township: 14N Range: 7W County: CANADIAN

SPOT LOCATION: SE NE SW SE FEET FROM QUARTER: FROM SOUTH FROM EAST
SECTION LINES: 878 1583

Lease Name: ROCK ISLAND Well No: 1407 3H-14XX Well will be 878 feet from nearest unit or lease boundary.
Operator Name: OVINTIV MID-CONTINENT INC. Telephone: 2812105100; 9188781290; OTC/OCC Number: 20944 0

OVINTIV MID-CONTINENT INC.
4 WATERWAY AVE STE 100
THE WOODLANDS, TX 77380-2764

CYNTHIA K. SCHROEDER
15438 W 149TH TERRACE
OLATHE KS 66062

Formation(s) (Permit Valid for Listed Formations Only):

	Name	Code	Depth
1	MISSISSIPPIAN	359MSSP	8027
2	MISSISSIPPI SOLID	351MSSSD	8242
3	WOODFORD	319WDFD	8692

Spacing Orders: 587241	Location Exception Orders: 698580	Increased Density Orders: 702206
637734	710991	702207
632037		692431
698579		692432
710990		692433
		692434
		710977
		710985
		713906
		713907
		713908
		713853

Pending CD Numbers: No Pending

Working interest owners' notified: ***

Special Orders: No Special Orders

Total Depth: 21434 Ground Elevation: 1142

Surface Casing: 1500

Depth to base of Treatable Water-Bearing FM: 210

Deep surface casing has been approved

Under Federal Jurisdiction: No
Fresh Water Supply Well Drilled: No
Surface Water used to Drill: No

Approved Method for disposal of Drilling Fluids:

D. One time land application -- (REQUIRES PERMIT)	PERMIT NO: 21-37573
E. Haul to Commercial pit facility	Sec. 31 Twn. 12N Rng. 8W Cnty. 17 Order No: 587498
H. (Other)	SEE MEMO

PIT 1 INFORMATION

Type of Pit System: CLOSED Closed System Means Steel Pits
Type of Mud System: WATER BASED
Chlorides Max: 5000 Average: 3000
Is depth to top of ground water greater than 10ft below base of pit? Y
Within 1 mile of municipal water well? N
Wellhead Protection Area? N
Pit is not located in a Hydrologically Sensitive Area.

Category of Pit: C
Liner not required for Category: C
Pit Location is: NON HSA
Pit Location Formation: BISON

This permit does not address the right of entry or settlement of surface damages. The duration of this permit is 18 MONTHS, except as otherwise provided by Rule 165: 10-3-1. Rule 165: 10-3-4 (c) (7) (e) - The Operator shall give 24 Hours notice by telephone to the appropriate District Office of the Conservation Division as to when Surface Casing will be run.

PIT 2 INFORMATION**Type of Pit System:** CLOSED Closed System Means Steel Pits**Type of Mud System:** OIL BASED

Chlorides Max: 300000 Average: 200000

Is depth to top of ground water greater than 10ft below base of pit? Y

Within 1 mile of municipal water well? N

Wellhead Protection Area? N

Pit **is not** located in a Hydrologically Sensitive Area.**Category of Pit:** C**Liner not required for Category:** C**Pit Location is:** NON HSA**Pit Location Formation:** BISON**MULTI UNIT HOLE 1**

Section: 26 Township: 14N Range: 7W Meridian: 1M

Total Length: 12921

County: CANADIAN

Measured Total Depth: 21434

Spot Location of End Point: SE SE SE NW

True Vertical Depth: 8800

Feet From: **NORTH** 1/4 Section Line: 2505

End Point Location from

Feet From: **WEST** 1/4 Section Line: 2637

Lease, Unit, or Property Line: 2505

NOTES:

Category	Description
DEEP SURFACE CASING	[4/7/2021 - GC2] - APPROVED; NOTIFY OCC FIELD INSPECTOR IMMEDIATELY OF ANY LOSS OF CIRCULATION OR FAILURE TO CIRCULATE CEMENT TO SURFACE ON ANY CONDUCTOR OR SURFACE CASING
HYDRAULIC FRACTURING	[4/7/2021 - GC2] - OCC 165:10-3-10 REQUIRES: 1) NOTICE SHALL BE GIVEN AT LEAST 5 BUSINESS DAYS PRIOR TO COMMENCEMENT OF HYDRAULIC FRACTURING OPERATIONS ON A HORIZONTAL WELL TO OPERATORS PRODUCING WELLS WITHIN 1 MILE OF THE COMPLETION INTERVAL OF THE SUBJECT WELL. THE NOTICE TO SUCH OPERATORS SHALL CONTAIN THE INFORMATION IN FORM 6000NOO. IF THE HYDRAULIC FRACTURING OPERATIONS SCHEDULE CHANGES AFTER NOTICE HAS BEEN PROVIDED, RESULTING IN A DELAY OF OPERATIONS OF MORE THAN 5 DAYS FROM THE INITIAL NOTICE, NEW NOTICE IS REQUIRED TO BE GIVEN; 2) NOTICE WILL BE GIVEN TO THE OCC CENTRAL OFFICE AND LOCAL DISTRICT OFFICES AT LEAST 48 HOURS PRIOR TO COMMENCEMENT OF HYDRAULIC FRACTURING OPERATIONS. FORM 6000NHF SHALL BE USED AND IS FOUND AT THIS LINK: OCCEWEB.COM/OG/OGFORMS.HTML ; AND, 3) THE CHEMICAL DISCLOSURE OF HYDRAULIC FRACTURING INGREDIENTS FOR ALL WELLS IS TO BE REPORTED TO FRACFOCUS WITHIN 60 DAYS AFTER THE CONCLUSION OF HYDRAULIC FRACTURING OPERATIONS, FOUND AT FRACFOCUS.ORG
INCREASED DENSITY - 692431	[4/12/2021 - G56] - 23-14N-7W X637734 MSSP 6 WELLS NEWFIELD EXPLORATION MID-CON INC (BOUGHT IN IT'S ENTIRETY BY OVINTIV MID-CON INC) 3/5/2019
INCREASED DENSITY - 692432	[4/12/2021 - G56] - 23-14N-7W X637734 WDFD 7 WELLS NEWFIELD EXPLORATION MID-CON INC (BOUGHT IN IT'S ENTIRETY BY OVINTIV MID-CON INC) 3/5/2019
INCREASED DENSITY - 692433	[4/12/2021 - G56] - 26-14N-7W X632037 MSSSD 6 WELLS NEWFIELD EXPLORATION MID-CON INC (BOUGHT IN IT'S ENTIRETY BY OVINTIV MID-CON INC) 3/5/2019
INCREASED DENSITY - 692434	[4/12/2021 - G56] - 26-14N-7W X632037 WDFD 7 WELLS NEWFIELD EXPLORATION MID-CON INC (BOUGHT IN IT'S ENTIRETY BY OVINTIV MID-CON INC) 3/5/2019
INCREASED DENSITY - 702206	[4/12/2021 - G56] - 14-14N-7W X587241 MSSP 6 WELLS NEWFIELD EXPLORATION MID-CON INC (BOUGHT IN IT'S ENTIRETY BY OVINTIV MID-CON INC) 9/13/2019

This permit does not address the right of entry or settlement of surface damages. The duration of this permit is 18 MONTHS, except as otherwise provided by Rule 165: 10-3-1. Rule 165: 10-3-4 (c) (7) (e) - The Operator shall give 24 Hours notice by telephone to the appropriate District Office of the Conservation Division as to when Surface Casing will be run.

INCREASED DENSITY - 702207	[4/12/2021 - G56] - 14-14N-7W X587241 WDFD 7 WELLS NEWFIELD EXPLORATION MID-CON INC (BOUGHT IN IT'S ENTIRETY BY OVINTIV MID-CON INC) 9/13/2019
INCREASED DENSITY - 710977	[4/12/2021 - G56] - EXTENSION OF TIME FOR ORDER # 702206
INCREASED DENSITY - 710985	[4/12/2021 - G56] - EXTENSION OF TIME FOR ORDER # 702207
INCREASED DENSITY - 713853	[4/12/2021 - G56] - EXTENSION OF TIME FOR ORDER # 692434
INCREASED DENSITY - 713906	[4/12/2021 - G56] - EXTENSION OF TIME FOR ORDER # 692431
INCREASED DENSITY - 713907	[4/12/2021 - G56] - EXTENSION OF TIME FOR ORDER # 692432
INCREASED DENSITY - 713908	[4/12/2021 - G56] - EXTENSION OF TIME FOR ORDER # 692433
LOCATION EXCEPTION - 698580	[4/12/2021 - G56] - (I.O.) 14, 23 & 26-14N-7W X587241 MSSP, WDFD, OTHER 14-14N-7W X637734 MSSP, WDFD, OTHER 23-14N-7W X632037 MSSSD, WDFD, OTHER 26-14N-7W COMPL INT (14-14N7W) NCT 165' FNL, NCT 0' FSL, NCT 1980' FWL COMPL INT (23-14N-7W) NCT 0' FNL, NCT 0' FSL, NCT 1980' FWL COMPL INT (26-14N-7W) NCT 0' FNL, NCT 2640' FSL, NCT 1980' FWL NEWFIELD EXPLORATION MID-CON INC (BOUGHT IN IT'S ENTIRETY BY OVINTIV MID CON INC) 7/1/2019
LOCATION EXCEPTION - 710991	[4/12/2021 - G56] - EXTENSION OF TIME FOR ORDER # 698580
MEMO	[4/7/2021 - GC2] - CLOSED SYSTEM=STEEL PITS (REQUIRED - UNCLE JOHN CREEK AND OKNNAME 30065), OBM RETURNED TO VENDOR, CUTTINGS PERMITTED PER DISTRICT
SPACING - 587241	[4/12/2021 - G56] - (640)(HOR) 14-14N-7W VAC 122201 MISS, OTHERS VAC 164357 WDFD, OTHERS EST MSSP, WDFD, OTHERS COMPL INT (MSSP) NCT 660' FB COMPL INT (WDFD) NCT 165' FNL & FSL, NCT 330' FEL & FWL (COEXIST WITH PRODUCING NON HORIZONTAL SP UNITS, SUPERSEDE NON DEVELOPED NON HORIZONTAL SP UNITS)
SPACING - 632037	[4/12/2021 - G56] - (640)(HOR) 26-14N-7W EXT 621416 WDFD, OTHER EST MSSSD (COEXIST WITH SP # 137094 MISS)
SPACING - 637734	[4/12/2021 - G56] - (640)(HOR) 23-14N-7W VAC 122201 MISS, OTHERS VAC 142864 CSTR, WDFD EXT 632037 WDFD, OTHER EST MSSP COMPL INT (MSSP) NLT 660' FB COMPL INT (WDFD) NLT 165' FNL/FSL, NLT 330' FEL/FWL (COEXIST WITH SP # 122201 MISS, SP # 142864 CSTR, WDFD)
SPACING - 698579	[4/12/2021 - G56] - (I.O.) 14, 23 & 26-14N-7W EST MULTIUNIT HORIZONTAL WELL X587241 MSSP, WDFD, OTHER 14-14N-7W X637734 MSSP, WDFD, OTHER 23-14N-7W X632037 MSSSD, WDFD, OTHER 26-14N-7W 40% 14-14N-7W 41% 23-14N-7W 19% 26-14N-7W NEWFIELD EXPLORATION MID-CON INC (BOUGHT IN IT'S ENTIRETY BY OVINTIV MID CON INC) 7/1/2019
SPACING - 710990	[4/12/2021 - G56] - EXTENSION OF TIME FOR ORDER # 698579

WELL LOCATION
ROCK ISLAND 1407 3H-14XX
OVINTIV MID-CONTINENT INC.
SECTION 11, TOWNSHIP 14N, RANGE 7W, I.M.
CANADIAN COUNTY, OKLAHOMA

LEGEND

SECTION LINE
QUARTER SECTION LINE
16TH LINE
PROPOSED WELL BORE



SCALE: 1" = 2000'
0' 1000' 2000'

LANDING POINT
165' FNL & 2653' FWL
NAD-27
X= 2025456
Y= 253454
LAT.: 35°41'46.5" N
LONG.: 97°54'51.4" W
LAT.: 35.696257° N
LONG.: 97.914273° W
NAD-83
X= 1993858
Y= 253478
LAT.: 35°41'46.7" N
LONG.: 97°54'52.6" W
LAT.: 35.696305° N
LONG.: 97.914601° W

BOTTOM HOLE
2505' FNL & 2653' FWL
NAD-27
X= 2025458
Y= 240533
LAT.: 35°39'38.7" N
LONG.: 97°54'51.5" W
LAT.: 35.660758° N
LONG.: 97.914306° W
NAD-83
X= 1993860
Y= 240557
LAT.: 35°39'38.9" N
LONG.: 97°54'52.7" W
LAT.: 35.660807° N
LONG.: 97.914633° W

SURVEYOR'S CERTIFICATE:
I, THOMAS L. HOWELL, AN OKLAHOMA
LICENSED LAND SURVEYOR AND AN
AUTHORIZED AGENT OF TOPOGRAPHIC
LAND SURVEYORS, DO HEREBY CERTIFY
TO THE INFORMATION SHOWN HEREIN.



TOPOGRAPHIC
LOYALTY INNOVATION LEGACY
13800 WIRELESS WAY • OKLAHOMA CITY, OKLAHOMA 73134
TELEPHONE: (405) 843-4847 OR (800) 654-3219
CERTIFICATE OF AUTHORIZATION NO. 1292 LS
WWW.TOPOGRAPHIC.COM

SURFACE LOCATION
878' FSL & 1583' FEL

LANDING POINT
NAD-27
X= 2025466.12
Y= 253619.45
NAD-83
X= 1993868.06
Y= 253643.42

SURFACE LOCATION
878' FSL & 1583' FEL
NAD-27
X= 2026546
Y= 254502
LAT.: 35°41'56.9" N
LONG.: 97°54'38.2" W
LAT.: 35.699133° N
LONG.: 97.910600° W
ELEV.: 1141' (NGVD29)
NAD-83
X= 1994948
Y= 254526
LAT.: 35°41'57.1" N
LONG.: 97°54'39.3" W
LAT.: 35.699181° N
LONG.: 97.910928° W
ELEV.: 1142' (NAVD88)

LAST TAKE POINT
2425' FNL & 2653' FWL
NAD-27
X= 2025457
Y= 240613
LAT.: 35°39'39.5" N
LONG.: 97°54'51.5" W
LAT.: 35.660978° N
LONG.: 97.914307° W
NAD-83
X= 1993859
Y= 240637
LAT.: 35°39'39.7" N
LONG.: 97°54'52.7" W
LAT.: 35.661027° N
LONG.: 97.914635° W

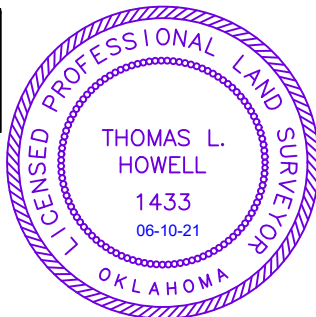

Thomas L. Howell, P.L.S. No. 1433
Authorized Agent of Topographic Land Surveyors

LEASE NAME & WELL NO. ROCK ISLAND 1407 3H-14XX

SECTION 11 TWP 14N RGE 7W MERIDIAN I.M.
COUNTY CANADIAN STATE OKLAHOMA
DESCRIPTION 878' FSL & 1583' FEL

ROCK ISLAND
1407 3H-14XX

REVISION:

INT	DATE
KEU	06/10/2021

DATE: 03/16/2021

FILE:LO_ROCK_ISLAND_1407_3H-14XX_REV1

DRAWN BY: KEU

SHEET: 1 OF 1

NOTES:

1. ORIGINAL DOCUMENT SIZE: 8.5" X 14"
2. ALL BEARINGS SHOWN HEREON ARE GRID OKLAHOMA COORDINATE SYSTEM OF 1983 NORTH ZONE ACCORDING TO THE RESULT OF STATIC GPS OBSERVATION PROCESSED THROUGH OPUS ON THE CONTROL POINT OCCUPIED WHILE MEASURING SAID LINES. OPUS RESULTS ARE CORRELATED TO OKLAHOMA COORDINATE SYSTEM THROUGH NORTH ZONE AND THE NORTH AMERICAN VERTICAL DATUM OF 1988.
3. OKLAHOMA COORDINATE SYSTEM OF 1927 AND NATIONAL GEOGRAPHIC VERTICAL DATUM OF 1929 INFORMATION CONVERTED FROM OKLAHOMA COORDINATE SYSTEM OF 1983 AND NORTH AMERICAN VERTICAL DATUM OF 1988.
4. CERTIFICATION IS MADE ONLY TO THE LOCATION OF THIS EASEMENT/LOCATION, IN RELATION TO THE EVIDENCE FOUND DURING A FIELD SURVEY, MADE ON THE GROUND, UNDER MY SUPERVISION, AND USING DOCUMENTATION PROVIDED BY OVINTIV MID-CONTINENT INC. ONLY UTILITIES/EASEMENTS THAT WERE VISIBLE ON THE DATE OF THIS SURVEY, WITHIN/ADJOINING THIS EASEMENT/LOCATION, HAVE BEEN LOCATED AS SHOWN HEREON OF WHICH I HAVE KNOWLEDGE. THIS CERTIFICATION IS LIMITED TO THOSE PERSONS OR ENTITIES SHOWN ON THE FACE OF THIS PLAT AND IS NON-TRANSFERABLE, AND MADE FOR THIS TRANSACTION ONLY.
5. LANDING POINT, BOTTOM HOLE, AND DRILL PATH INFORMATION PROVIDED BY OPERATOR AS SHOWN AND ARE NOT SURVEYED LOCATIONS.
6. THE INFORMATION SHOWN HEREIN IS FOR CONSTRUCTION PURPOSES ONLY