

API NUMBER: 037 29485

OKLAHOMA CORPORATION COMMISSION  
OIL & GAS CONSERVATION DIVISION  
P.O. BOX 52000  
OKLAHOMA CITY, OK 73152-2000  
(Rule 165:10-3-1)

Approval Date: 02/04/2022  
Expiration Date: 08/04/2023

Straight Hole Oil & Gas

**PERMIT TO DRILL**

WELL LOCATION: Section: 04 Township: 16N Range: 10E County: CREEK

SPOT LOCATION: ☐ NE ☐ SW ☐ SE ☐ NW FEET FROM QUARTER: FROM SOUTH FROM WEST  
SECTION LINES: 590 1700

Lease Name: VANESSA RAE Well No: 2 Well will be 590 feet from nearest unit or lease boundary.  
Operator Name: WEINS HORTON L Telephone: 9186940016 OTC/OCC Number: 21286 0

WEINS HORTON L  
PO BOX 571117  
TULSA, OK 74157-1117

CORNELIUS RANCH LLC  
PO BOX 459  
KELLYVILLE OK 74039

Formation(s) (Permit Valid for Listed Formations Only):

Name	Code	Depth	Name	Code	Depth
1 LAYTON	405LYTN	947	6 DUTCHER	403DTCR	2787
2 SKINNER	404SKNR	1860	7 BURGESS	404BRGS	2870
3 RED FORK	404RDFK	2100	8 MISENER	319MSNR	3147
4 BARTLESVILLE	404BRVL	2411	9 WILCOX	202WLCX	3190
5 TANEHA	404TNEH	2530	10 ARBUCKLE	169ABCK	3320

Spacing Orders: No Spacing Location Exception Orders: No Exceptions Increased Density Orders: No Density

Pending CD Numbers: No Pending Working interest owners' notified: \*\*\* Special Orders: No Special

Total Depth: 3650 Ground Elevation: 887 Surface Casing: 460 Depth to base of Treatable Water-Bearing FM: 410

Under Federal Jurisdiction: No  
Fresh Water Supply Well Drilled: No  
Surface Water used to Drill: No

Approved Method for disposal of Drilling Fluids:  
A. Evaporation/dewater and backfilling of reserve pit.

**PIT 1 INFORMATION**

Type of Pit System: ON SITE  
Type of Mud System: AIR

Is depth to top of ground water greater than 10ft below base of pit? Y

Within 1 mile of municipal water well? N  
Wellhead Protection Area? N

Pit is not located in a Hydrologically Sensitive Area.

Category of Pit: 4

Liner not required for Category: 4

Pit Location is: NON HSA

Pit Location Formation: NELLIE BLY

Mud System Change to Water-Based or Oil-Based Mud Requires an Amended Intent (Form 1000).

**NOTES:**

This permit does not address the right of entry or settlement of surface damages. The duration of this permit is 18 MONTHS, except as otherwise provided by Rule 165: 10-3-1. Rule 165: 10-3-4 (c) (7) (e) - The Operator shall give 24 Hours notice by telephone to the appropriate District Office of the Conservation Division as to when Surface Casing will be run.

Category	Description
HYDRAULIC FRACTURING	<p>[2/2/2022 - GC2] - OCC 165:10-3-10 REQUIRES:</p> <p>1) NOTICE SHALL BE GIVEN AT LEAST 5 BUSINESS DAYS PRIOR TO COMMENCEMENT OF HYDRAULIC FRACTURING OPERATIONS ON A HORIZONTAL WELL TO OPERATORS PRODUCING WELLS WITHIN 1 MILE OF THE COMPLETION INTERVAL OF THE SUBJECT WELL. THE NOTICE TO SUCH OPERATORS SHALL CONTAIN THE INFORMATION IN FORM 6000NOO. IF THE HYDRAULIC FRACTURING OPERATIONS SCHEDULE CHANGES AFTER NOTICE HAS BEEN PROVIDED, RESULTING IN A DELAY OF OPERATIONS OF MORE THAN 5 DAYS FROM THE INITIAL NOTICE, NEW NOTICE IS REQUIRED TO BE GIVEN;</p> <p>2) NOTICE WILL BE GIVEN TO THE OCC CENTRAL OFFICE AND LOCAL DISTRICT OFFICES AT LEAST 48 HOURS PRIOR TO COMMENCEMENT OF HYDRAULIC FRACTURING OPERATIONS. FORM 6000NHF SHALL BE USED AND IS FOUND AT THIS LINK: <a href="http://OCCEWEB.COM/OG/OGFORMS.HTML">OCCEWEB.COM/OG/OGFORMS.HTML</a>; AND,</p> <p>3) THE CHEMICAL DISCLOSURE OF HYDRAULIC FRACTURING INGREDIENTS FOR ALL WELLS IS TO BE REPORTED TO FRACFOCUS WITHIN 60 DAYS AFTER THE CONCLUSION OF HYDRAULIC FRACTURING OPERATIONS, FOUND AT <a href="http://FRACFOCUS.ORG">FRACFOCUS.ORG</a></p>
SPACING	[2/3/2022 - G56] - FORMATIONS UNSPACED; 160-ACRE LEASE (NW4)

WELL LOCATION FOR: Precise Discovery Exploration LLC

R-10-E

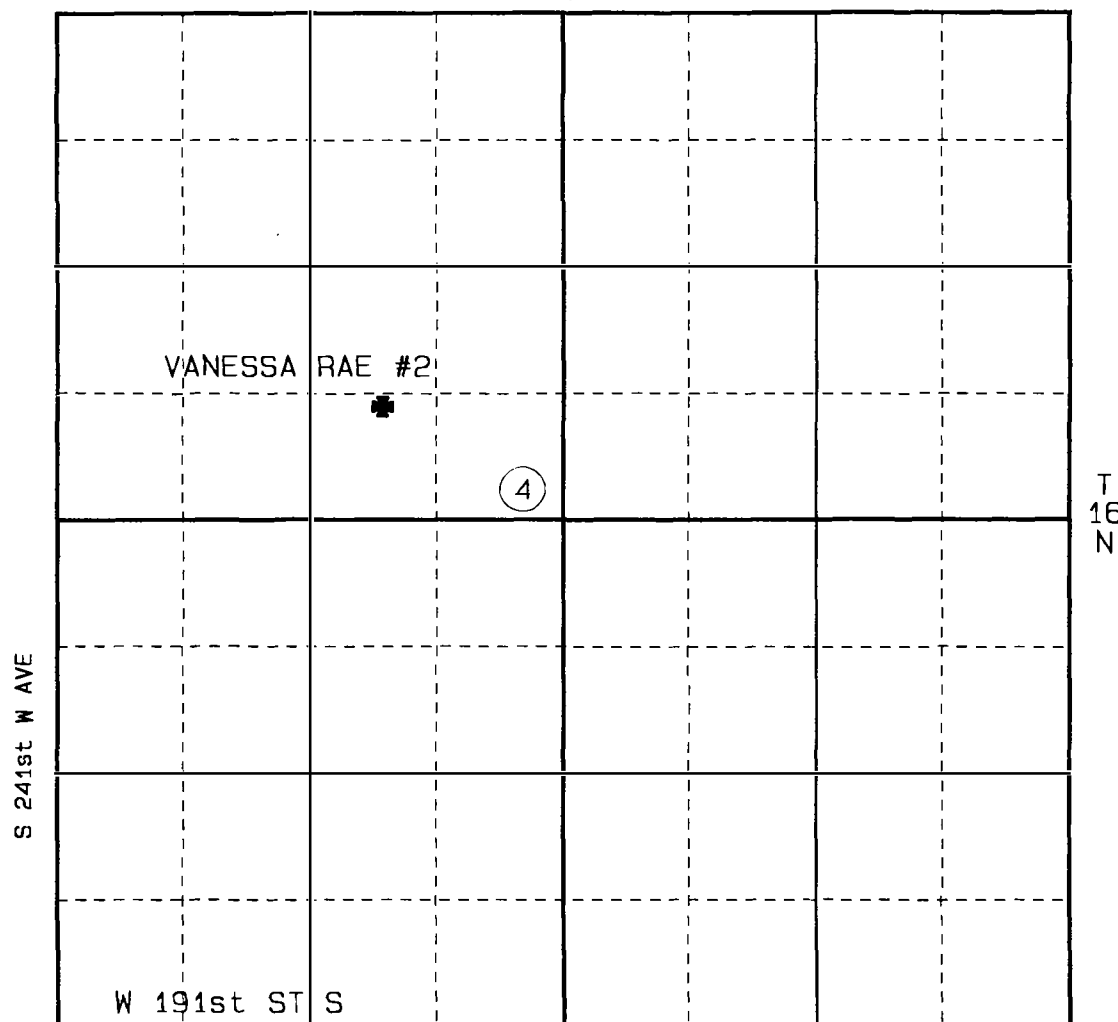

VANESSA RAE #2  
590' F.S.L. &  
1700' F.W.L. NW/4  
SEC 4-T16N-R10E  
ELEVATION 887'  
35°53'41.64"N  
96°15'28.03"W

DUE CARE AND DILIGENCE HAVE BEEN EXERCISED IN THE  
STAKING OF THIS WELL LOCATION ON THE GROUND  
ACCORDING TO THE BEST OFFICIAL RECORDS AND MAPS  
AVAILABLE TO US.  
PLEASE REVIEW THIS PLAT AND NOTIFY US IMMEDIATELY  
OF ANY DISCREPANCY

PENICO LAND SURVEYING  
P.O. BOX 52, SAPULPA, OK. 74067  
(918) -367-2942; penicosurveying@yahoo.com  
CA# 2074

DATE OF LAST SITE VISIT: 1-27-22  
DATE OF REVISIONS: