

API NUMBER: 037 29453

OKLAHOMA CORPORATION COMMISSION
OIL & GAS CONSERVATION DIVISION
P.O. BOX 52000
OKLAHOMA CITY, OK 73152-2000
(Rule 165:10-3-1)

Approval Date: 06/16/2020

Expiration Date: 12/16/2021

Straight Hole

Oil & Gas

PERMIT TO DRILL

WELL LOCATION: Section: 14 Township: 16N Range: 8E County: CREEK

SPOT LOCATION: ☐ SW ☐ SE ☐ SE ☐ SE FEET FROM QUARTER: FROM SOUTH FROM EAST
SECTION LINES: 165 545

Lease Name: CANADY

Well No: 3 A

Well will be 165 feet from nearest unit or lease boundary.

Operator Name: LUKE OIL COMPANY

Telephone: 9187606026

OTC/OCC Number: 18170 0

LUKE OIL COMPANY

PO BOX 1257

BRISTOW, OK 74010-1257

DON GARISON

37495 W 221 STREET SOUTH

BRISTOW OK 74010

Formation(s) (Permit Valid for Listed Formations Only):

Name	Code	Depth	Name	Code	Depth
1 JONES /SD/	405JONS	1750	6 BARTLESVILLE	404BRVL	2790
2 OSWEGO	404OSWG	2150	7 DUTCHER	403DTCR	3145
3 PRUE	404PRUE	2300	8 MISSISSIPPIAN	359MSSP	3360
4 SKINNER	404SKNR	2450	9 WILCOX	202WLCX	3690
5 RED FORK	404RDFK	2600	10 ARBUCKLE	169ABCK	3785

Spacing Orders: 663657

Location Exception Orders: No Exceptions

Increased Density Orders: No Density Orders

Pending CD Numbers: 202001187

Special Orders: No Special Orders

Total Depth: 3850

Ground Elevation: 850

Surface Casing: 630

Depth to base of Treatable Water-Bearing FM: 580

Under Federal Jurisdiction: No

Fresh Water Supply Well Drilled: No

Surface Water used to Drill: Yes

Approved Method for disposal of Drilling Fluids:

A. Evaporation/dewater and backfilling of reserve pit.

PIT 1 INFORMATION

Type of Pit System: ON SITE

Type of Mud System: WATER BASED

Chlorides Max: 5000 Average: 3000

Is depth to top of ground water greater than 10ft below base of pit? Y

Within 1 mile of municipal water well? N

Wellhead Protection Area? N

Pit is located in a Hydrologically Sensitive Area.

Category of Pit: 2

Liner not required for Category: 2

Pit Location is: BED AQUIFER

Pit Location Formation: VAMOOSA

NOTES:

This permit does not address the right of entry or settlement of surface damages.
The duration of this permit is 18 MONTHS, except as otherwise provided by Rule 165: 10-3-1.
Rule 165: 10-3-4 (c) (7) (e) - The Operator shall give 24 Hours notice by telephone to the appropriate District
Office of the Conservation Division as to when Surface Casing will be run.

Category	Description
HYDRAULIC FRACTURING	<p>6/16/2020 - G71 - OCC 165:10-3-10 REQUIRES:</p> <p>1) PRIOR TO COMMENCEMENT OF HYDRAULIC FRACTURING OPERATIONS FOR HORIZONTAL WELLS, NOTICE GIVEN FIVE BUSINESS DAYS IN ADVANCE TO OFFSET OPERATORS WITH WELLS COMPLETED IN THE SAME COMMON SOURCE OF SUPPLY WITHIN 1/2 MILE;</p> <p>2) WITH NOTICE ALSO GIVEN 48 HOURS IN ADVANCE OF HYDRAULIC FRACTURING ALL WELLS TO BOTH THE OCC CENTRAL OFFICE AND LOCAL DISTRICT OFFICES, USING THE "FRAC NOTICE FORM" FOUND AT THE FOLLOWING LINK: OCCWEB.COM/OG/OGFORMS.HTML; AND,</p> <p>3) THE CHEMICAL DISCLOSURE OF HYDRAULIC FRACTURING INGREDIENTS FOR ALL WELLS TO BE REPORTED TO FRACFOCUS WITHIN 60 DAYS AFTER THE CONCLUSION THE HYDRAULIC FRACTURING OPERATIONS, USING THE FOLLOWING LINK: FRACFOCUS.ORG</p>
PENDING CD - 202001187	<p>6/16/2020 - GC2 - (E.O.) S2 SE4 14-16N-8E X663657 JONS, OSWG, PRUE, SKNR, RDFK, BRVL, DTCR, WLCX 165' FSL, 545' FEL LUKE OIL COMPANY REC. 6-8-2020 (NORRIS)</p>
SPACING	<p>6/16/2020 - GC2 - FORMATIONS UNSPACED 80-ACRE LD NE/SW LEASE S2 SE4</p>
SPACING - 663657	<p>6/16/2020 - GC2 - (80) S2 SE4 14-16N-8E LD NE/SW EST JONS, OSWG, PRUE, SKNR, RDFK, BRVL, DTCR, WLCX, OTHERS</p>

This permit does not address the right of entry or settlement of surface damages.

The duration of this permit is 18 MONTHS, except as otherwise provided by Rule 165: 10-3-1.

Rule 165: 10-3-4 (c) (7) (e) - The Operator shall give 24 Hours notice by telephone to the appropriate District Office of the Conservation Division as to when Surface Casing will be run.

037 29453 CANADY 3 A

WELL LOCATION FOR: Luke Oil

R-8-E

API:037-29453

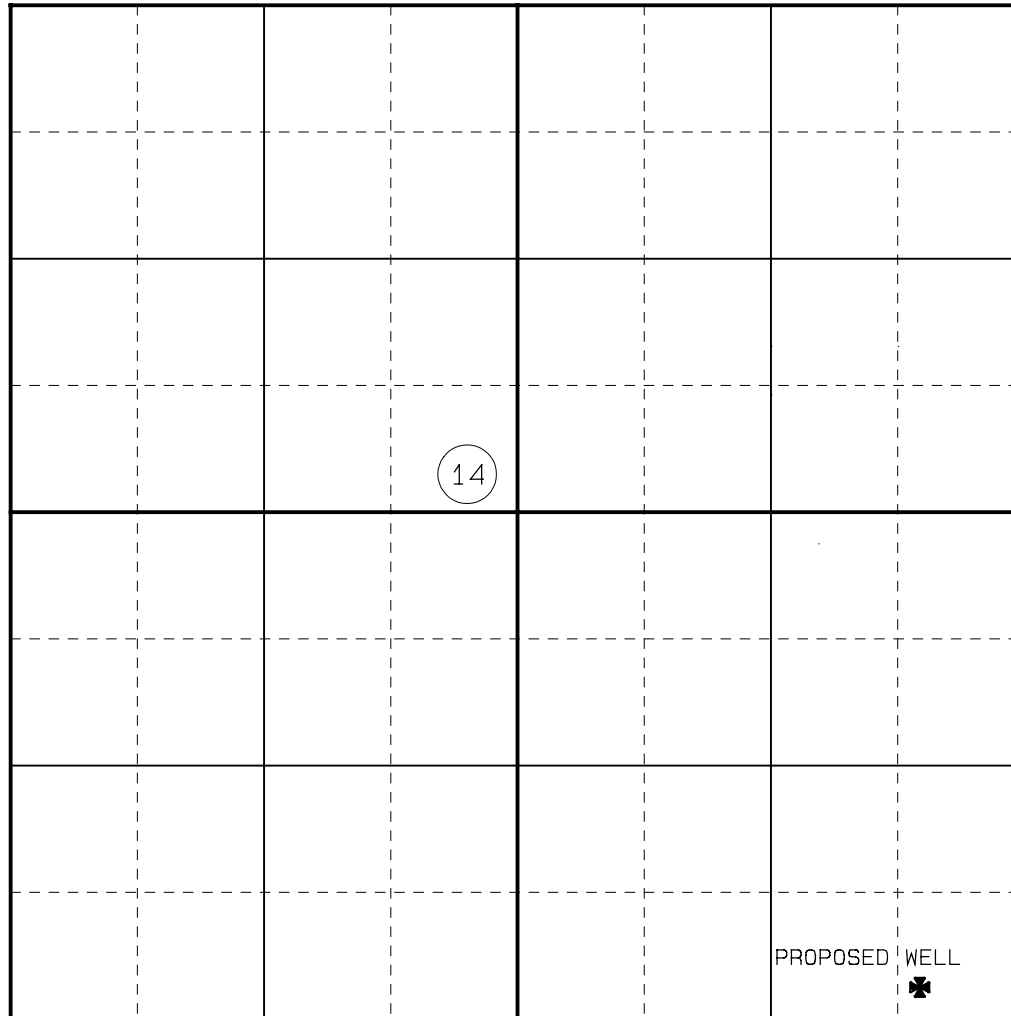

T
16
N

CANADY #3A
545' F.E.L. & 165' F.S.L.
SE/4 SEC 14-T16N-R8E
ELEV 850'

DUE CARE AND DILIGENCE HAVE BEEN EXERCISED IN THE
STAKING OF THIS WELL LOCATION ON THE GROUND
ACCORDING TO THE BEST OFFICIAL RECORDS AND MAPS
AVAILABLE TO US.

PLEASE REVIEW THIS PLAT AND NOTIFY US IMMEDIATELY
OF ANY DISCREPANCY

PENNCO LAND SURVEYING

P.O. BOX 52, SAPULPA, OK, 74067
(918) -367-2942; (918) -724-2468
CA# 2074

DATE OF LAST SITE VISIT: 5-26-20
DATE OF REVISIONS: