

API NUMBER: 111 27547

OKLAHOMA CORPORATION COMMISSION  
OIL & GAS CONSERVATION DIVISION  
P.O. BOX 52000  
OKLAHOMA CITY, OK 73152-2000  
(Rule 165:10-3-1)

Approval Date: 03/31/2022  
Expiration Date: 09/30/2023

Straight Hole Oil & Gas

**PERMIT TO DRILL**

WELL LOCATION: Section: 19 Township: 14N Range: 11E County: OKMULGEE

SPOT LOCATION: ☐ NW ☐ SE ☐ NE ☐ NW FEET FROM QUARTER: FROM NORTH FROM EAST  
SECTION LINES: 825 495

Lease Name: SASSY SUE Well No: 5 Well will be 495 feet from nearest unit or lease boundary.  
Operator Name: WFD OIL CORPORATION Telephone: 4057153130 OTC/OCC Number: 17501 0

WFD OIL CORPORATION  
16800 CONIFER LN  
EDMOND, OK 73012-0619

MCBRIDE RANCH LLC  
720 WEST 108TH PLACE SOUTH  
JENKS OK 74037

Formation(s) (Permit Valid for Listed Formations Only):

	Name	Code	Depth
1	SENORA	404SNOR	1400
2	PINK LIME	404PKLM	1700
3	RED FORK	404RDFK	1750
4	BARTLESVILLE	404BRVL	2000
5	TANEHA	404TNEH	2300

	Name	Code	Depth
6	DUTCHER UP	403DTCRU	2475
7	DUTCHER LOW	403DTCRL	2600
8	UNION VALLEY LIMESTONE	402UVLM	2650

Spacing Orders: 583816

Location Exception Orders: No Exceptions

Increased Density Orders: No Density

Pending CD Numbers: 202200862

Working interest owners' notified: \*\*\*

Special Orders: No Special

Total Depth: 2700 Ground Elevation: 702

Surface Casing: 120

Depth to base of Treatable Water-Bearing FM: 70

Under Federal Jurisdiction: No  
Fresh Water Supply Well Drilled: No  
Surface Water used to Drill: No

**Approved Method for disposal of Drilling Fluids:**

A. Evaporation/dewater and backfilling of reserve pit.

**PIT 1 INFORMATION**

Type of Pit System: ON SITE  
Type of Mud System: AIR

Is depth to top of ground water greater than 10ft below base of pit? Y

Within 1 mile of municipal water well? N

Wellhead Protection Area? N

Pit **is not** located in a Hydrologically Sensitive Area.

Category of Pit: 4

Liner not required for Category: 4

Pit Location is: NON HSA

Pit Location Formation: COFFEYVILLE AND CCKB

Mud System Change to Water-Based or Oil-Based Mud Requires an Amended Intent (Form 1000).

**NOTES:**

This permit does not address the right of entry or settlement of surface damages. The duration of this permit is 18 MONTHS, except as otherwise provided by Rule 165: 10-3-1. Rule 165: 10-3-4 (c) (7) (e) - The Operator shall give 24 Hours notice by telephone to the appropriate District Office of the Conservation Division as to when Surface Casing will be run.

Category	Description
HYDRAULIC FRACTURING	<p>[3/28/2022 - GC2] - OCC 165:10-3-10 REQUIRES:</p> <p>1) NOTICE SHALL BE GIVEN AT LEAST 5 BUSINESS DAYS PRIOR TO COMMENCEMENT OF HYDRAULIC FRACTURING OPERATIONS ON A HORIZONTAL WELL TO OPERATORS PRODUCING WELLS WITHIN 1 MILE OF THE COMPLETION INTERVAL OF THE SUBJECT WELL. THE NOTICE TO SUCH OPERATORS SHALL CONTAIN THE INFORMATION IN FORM 6000NOO. IF THE HYDRAULIC FRACTURING OPERATIONS SCHEDULE CHANGES AFTER NOTICE HAS BEEN PROVIDED, RESULTING IN A DELAY OF OPERATIONS OF MORE THAN 5 DAYS FROM THE INITIAL NOTICE, NEW NOTICE IS REQUIRED TO BE GIVEN;</p> <p>2) NOTICE WILL BE GIVEN TO THE OCC CENTRAL OFFICE AND LOCAL DISTRICT OFFICES AT LEAST 48 HOURS PRIOR TO COMMENCEMENT OF HYDRAULIC FRACTURING OPERATIONS. FORM 6000NHF SHALL BE USED AND IS FOUND AT THIS LINK: <a href="http://OCCEWEB.COM/OG/OGFORMS.HTML">OCCEWEB.COM/OG/OGFORMS.HTML</a>; AND,</p> <p>3) THE CHEMICAL DISCLOSURE OF HYDRAULIC FRACTURING INGREDIENTS FOR ALL WELLS IS TO BE REPORTED TO FRACFOCUS WITHIN 60 DAYS AFTER THE CONCLUSION OF HYDRAULIC FRACTURING OPERATIONS, FOUND AT <a href="http://FRACFOCUS.ORG">FRACFOCUS.ORG</a></p>
PENDING CD - 202200862	<p>[3/31/2022 - G56] - NE4 NW4 19-14N-11E  X583816 RDFK  1 WELL  NO OP NAMED  REC 3/29/2022 (MYLES)</p>
SPACING - 583816	<p>[3/31/2022 - G56] - (40) NW4 19-14N-11E  EXT 130221 RDFK, BRVL, DTCRU, DTCRL  EST SNOR, PKLM, TNEH, UVLM</p>

SASSY SUE #5  
W F D OIL CORPORATION  
SECTION 19, TOWNSHIP 14N, RANGE 11E, I.M.  
OKMULGEE COUNTY, OKLAHOMA

SECTION LINE  
COUNTY LINE  
RANGE LINE  
QUARTER SECTION LINE  
16TH LINE



SCALE: 1" = 1000'



0 500' 1000'

X= 2536835  
Y= 253488

X= 2539330  
Y= 253525

X= 2541985  
Y= 253564

**SURFACE LOCATION**  
825' FNL & 495' FEL-NW/4  
NAD-27  
X= 2538850  
Y= 252693  
LAT.: 35°40'49.3" N  
LONG.: 96°11'08.2" W  
LAT.: 35.680362° N  
LONG.: 96.185602° W  
ELEV.: 702'

**SURFACE LOCATION**  
825' FNL & 495' FEL-NW/4

E/2-NW/4

LOT 2

LOT 3

E/2-SW/4

LOT 4

X= 2536936  
Y= 248195

X= 2539421  
Y= 248238

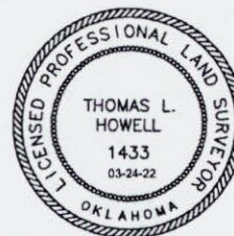

I, THOMAS L. HOWELL, AN OKLAHOMA LICENSED LAND SURVEYOR AND AN AUTHORIZED AGENT OF TOPOGRAPHIC, CO., DO HEREBY CERTIFY TO THE INFORMATION SHOWN HEREIN.

Thomas L. Howell

Thomas L. Howell, P.L.S. No. 1433  
Authorized Agent of Topographic, Co.

LEASE NAME & WELL NO. SASSY SUE #5

SECTION 19 TWP 14N RGE 11E MERIDIAN 1M.  
COUNTY OKMULGEE STATE OKLAHOMA  
DESCRIPTION 825' FNL & 495' FEL-NW/4

**TOPOGRAPHIC**  
LOYALTY INNOVATION LEGACY  
13806 WIRELESS WAY - OKLAHOMA CITY, OKLAHOMA 73134  
TELEPHONE: (405) 843-4847 OR (800) 654-3219  
FAX: (405) 843-0975  
CERTIFICATE OF AUTHORIZATION NO. 1292 LS  
WWW.TOPOGRAPHIC.COM

13800 WIRELESS WAY - OKLAHOMA CITY, OKLAHOMA 73134  
TELEPHONE: (405) 843-4847 OR (800) 654-3219  
FAX: (405) 843-0975  
CERTIFICATE OF AUTHORIZATION NO. 1292 LS  
WWW.TOPOGRAPHIC.COM

NOTES:

1. ORIGINAL DOCUMENT SIZE: 8.5" X 14"
2. ALL BEARINGS SHOWN HEREIN ARE GRID ACCORDING TO THE RESULTS OF STATIC GPS OBSERVATIONS PROCESSED THROUGH OPUS ON THE CONTROL POINT OCCUPIED WHILE MEASURING SAID LINES. OPUS RESULTS ARE CORRELATED TO THE NORTH AMERICAN DATUM OF 1983 AND THE NATIONAL GEODETIC DATUM OF 1983.
3. CERTIFICATION IS MADE ONLY TO THE LOCATION OF THIS EASEMENT/LOCATION, IN RELATION TO THE EVIDENCE FOUND DURING A FIELD SURVEY, MADE ON THE GROUND, UNDER MY SUPERVISION, AND USING DOCUMENTATION PROVIDED BY W F D COMPANY. ONLY UTILITY MEASUREMENTS THAT WERE VISIBLE ON THE DATE OF THIS SURVEY, WITHIN ADJOINING THIS ADJACENT LOCATION HAVE BEEN LOCATED AS SHOWN HEREON OF WHICH I HAVE KNOWLEDGE. THIS CERTIFICATION IS LIMITED TO THOSE PERSONS OR ENTITIES SHOWN ON THE FACE OF THIS PLAT AND IS NON-TRANSFERABLE, AND MADE FOR THIS TRANSACTION ONLY.
4. LANDING POINT, BOTTOM HOLE, AND DRILL PATH INFORMATION PROVIDED BY OPERATOR AS SHOWN AND ARE NOT SURVEYED LOCATIONS.
5. THE INFORMATION SHOWN HEREIN IS FOR CONSTRUCTION PURPOSES ONLY.

### SASSY SUE #5

DATE: 03/23/2022

DRAWN BY: KEU

SHEET: 1 OF 2