

Oklahoma Corporation Commission
Oil & Gas Conservation Division
Post Office Box 52000
Oklahoma City, Oklahoma 73152-2000
Rule 165: 10-3-25

Form 1002A

API No.: 35049251080000

Completion Report

Spud Date: March 20, 2017

OTC Prod. Unit No.: 049-219097

Drilling Finished Date: April 29, 2017

1st Prod Date: September 20, 2017

Completion Date: September 01, 2017

Drill Type: HORIZONTAL HOLE

Min Gas Allowable: Yes

Well Name: MOTE 1-26-23H

Purchaser/Measurer: WOODFORD EXPRESS

Location: GARVIN 26 2N 2W
NE SW SW SW
359 FSL 400 FWL of 1/4 SEC
Derrick Elevation: 0 Ground Elevation: 1016

First Sales Date: 11/21/2017

Operator: RIMROCK RESOURCE OPERATING LLC 23802

20 E 5TH ST STE 1300
TULSA, OK 74103-4462

Completion Type	
X	Single Zone
	Multiple Zone
	Commingled

Location Exception	
Order No	
670347	

Increased Density	
Order No	
There are no Increased Density records to display.	

Casing and Cement							
Type	Size	Weight	Grade	Feet	PSI	SAX	Top of CMT
SURFACE	13 3/8	54.5	J-55	1564		830	SURFACE
INTERMEDIATE	9 5/8	43.5	P-110	7117		910	740
PRODUCTION	5 1/2	23	DWC	17551		1820	6179

Liner								
Type	Size	Weight	Grade	Length	PSI	SAX	Top Depth	Bottom Depth
There are no Liner records to display.								

Total Depth: 17572

Packer	
Depth	Brand & Type
There are no Packer records to display.	

Plug	
Depth	Plug Type
There are no Plug records to display.	

Initial Test Data

Test Date	Formation	Oil BBL/Day	Oil-Gravity (API)	Gas MCF/Day	Gas-Oil Ratio Cu FT/BBL	Water BBL/Day	Pumpin or Flowing	Initial Shut-In Pressure	Choke Size	Flow Tubing Pressure
Nov 26, 2017	WOODFORD	220	42	387	1759	898	PUMPING	800	OPEN	580

Completion and Test Data by Producing Formation

Formation Name: WOODFORD

Code: 319WDFD

Class: OIL

Spacing Orders

Order No	Unit Size
653715	640
657600	640
670150	MULTIUNIT

Perforated Intervals

From	To
8020	17475

Acid Volumes

47,000 GALLONS 15% HCL

Fracture Treatments

353,694 BARRELS WATER, 18,845,120 POUNDS PROPPANT

Formation	Top
GIBSON	6866
HART	7019
CANEY	7529
MAYES	7564
SYCAMORE	7672
WOODFORD	7946

Were open hole logs run? Yes

Date last log run: March 30, 2017

Were unusual drilling circumstances encountered? No

Explanation:

Other Remarks

There are no Other Remarks.

Lateral Holes

Sec: 23 TWP: 2N RGE: 2W County: GARVIN

NE NW NW NW

165 FNL 402 FWL of 1/4 SEC

Depth of Deviation: 0 Radius of Turn: 477 Direction: 2 Total Length: 9455

Measured Total Depth: 17572 True Vertical Depth: 6938 End Pt. Location From Release, Unit or Property Line: 165

FOR COMMISSION USE ONLY

1138383

Status: Accepted

RECEIVED

DEC 11 2017

OKLAHOMA CORPORATION COMMISSION

Form 1002A
Rev. 2009

API NO. 049-25108
OTC PROD. UNIT NO. 049-219097

PLEASE TYPE OR USE BLACK INK ONLY
NOTE:

Attach copy of original 1002A
if recompletion or reentry.

OKLAHOMA CORPORATION COMMISSION
Oil & Gas Conservation Division
Post Office Box 52000
Oklahoma City, Oklahoma 73152-2000
Rule 165-10-3-25

☒ ORIGINAL
☐ AMENDED (Reason)

COMPLETION REPORT

TYPE OF DRILLING OPERATION

☐ STRAIGHT HOLE ☐ DIRECTIONAL HOLE ☒ HORIZONTAL HOLE
☐ SERVICE WELL

If directional or horizontal, see reverse for bottom hole location.

COUNTY	Garvin	SEC	26	TWP	2N	RGE	2W
LEASE NAME	Mote			WELL NO.	1-26-23H		
NE 1/4 SW 1/4 SW 1/4 SW 1/4	FSL OF 1/4 SEC	359	FWL 1/4 SEC	400	DATE OF WELL COMPLETION	9/1/2017	
ELEVATION Derrick FL	Ground	1016	Latitude (if known)		1st PROD DATE	9/20/2017	
OPERATOR NAME	Rimrock Resource Operating, LLC			OTC/OCC OPERATOR NO.	23802		
ADDRESS	20 East 5th Street, Suite 1300						
CITY	Tulsa	STATE	OK	ZIP	74103		

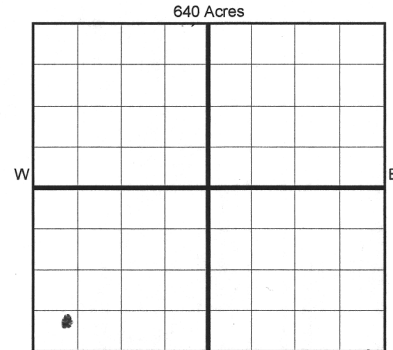

COMPLETION TYPE

<input checked="" type="checkbox"/> SINGLE ZONE
<input type="checkbox"/> MULTIPLE ZONE
Application Date
COMMINGLED
Application Date
LOCATION
EXCEPTION ORDER
INCREASED DENSITY
ORDER NO.

CASING & CEMENT (Form 1002C must be attached)

TYPE	SIZE	WEIGHT	GRADE	FEET	PSI	SAX	TOP OF CMT
CONDUCTOR	13 3/8	54.5	J-55	1564'		830	Surf.
SURFACE							
INTERMEDIATE	9 5/8	43.5	P-110	7117'		910	740'
PRODUCTION	5 1/2	23	DWC	17,551'		1820	6179'
LINER							
						TOTAL DEPTH	17,572'

PACKER @ _____ BRAND & TYPE _____ PLUG @ _____ TYPE _____ PLUG @ _____ TYPE _____
PACKER @ _____ BRAND & TYPE _____ PLUG @ _____ TYPE _____ PLUG @ _____ TYPE _____

COMPLETION & TEST DATA BY PRODUCING FORMATION

FORMATION	Woodford					
SPACING & SPACING ORDER NUMBER	#653715 - 640	#657600 - 640	#659250 - 640			
CLASS: Oil, Gas, Dry, Inj, Disp, Comm Disp, Svc	Oil					
PERFORATED INTERVALS	8,020' - 17,475' OA					
ACID/VOLUME	47,000 Gal. 15% HCL					
FRACTURE TREATMENT (Fluids/Prop Amounts)	353,694 bbls water & 18,845,120# proppant					

☒ Min Gas Allowable (165:10-17-7) OR Gas Purchaser/Measurer Woodford Express
Oil Allowable (165:10-13-3) First Sales Date 11/21/2017

INITIAL TEST DATA

INITIAL TEST DATE	11/26/2017
OIL-BBL/DAY	220
OIL-GRAVITY (API)	42.0
GAS-MCF/DAY	387
GAS-OIL RATIO CU FT/BBL	1759:1
WATER-BBL/DAY	898
PUMPING OR FLOWING	Pump
INITIAL SHUT-IN PRESSURE	800#
CHOKE SIZE	Open
FLOW TUBING PRESSURE	580#

AS SUBMITTED

A record of the formations drilled through, and pertinent remarks are presented on the reverse. I declare that I have knowledge of the contents of this report and am authorized by my organization to make this report, which was prepared by me or under my supervision and direction, with the data and facts stated herein to be true, correct, and complete to the best of my knowledge and belief.

Paulette Kadow
SIGNATURE
20 East 5th Street, Suite 1300
ADDRESS
Tulsa
CITY
OK
STATE
74103
ZIP
12/7/2017
DATE
918-301-4717
PHONE NUMBER
pkadow@rimrockresource.com
EMAIL ADDRESS

Give formation names and tops, if available, or descriptions and thickness of formations drilled through. Show intervals cored or drillstem tested.

WELL NO. 1-26-23H

NAMES OF FORMATIONS	TOP
Gibson	6,866'
Hart	7,019'
Caney	7,529'
Mayes	7,564'
Sycamore	7,672'
Woodford	7'946'

FOR COMMISSION USE ONLY	
ITD on file	<input type="checkbox"/> YES <input type="checkbox"/> NO
APPROVED	DISAPPROVED
2) Reject Codes _____ _____ _____ _____ _____	

Were open hole logs run? X yes ___ no

Date Last log was run 3/30/2017

Was CO₂ encountered? ___ yes X no at what depths? _____

Was H₂S encountered? ___ yes X no at what depths? _____

Were unusual drilling circumstances encountered? ___ yes X no

If yes, briefly explain below.

Other remarks:

640 Acres

A blank 10x10 grid for drawing a 10-sided polygon.

If more than three drainholes are proposed, attach a separate sheet indicating the necessary information.

Direction must be stated in degrees azimuth.
Please note, the horizontal drainhole and its end point must be located within the boundaries of the lease or spacing unit.

Directional surveys are required for all drainholes and directional wells.

640 Acres

A blank 10x10 grid with a thick cross dividing it into four 5x5 quadrants.

BOTTOM HOLE LOCATION FOR DIRECTIONAL HOLE

SEC	TWP	RGE	COUNTY			
Spot Location				Feet From 1/4 Sec Lines	FSL	FWL
1/4	1/4	1/4	1/4			
Measured Total Depth		True Vertical Depth		BHL From Lease, Unit, or Property Line:		

BOTTOM HOLE LOCATION FOR HORIZONTAL HOLE: (LATERALS)

LATERAL #1

SEC	23	TWP	2N	RGE	2W	COUNTY	Garvin		
Spot Location							Feet From 1/4 Sec Lines	FNL 165	FWL 402 400
NE 1/4		NW 1/4		NW 1/4		NW 1/4			
Depth of Deviation				Radius of Turn		477	Direction	2	Total Length 9,455'
Measured Total Depth				True Vertical Depth		BHL From Lease, Unit, or Property Line:			
17,572'				6,938'		165			

LATERAL #2

SEC	TWP	RGE	COUNTY			
Spot Location			Feet From 1/4 Sec Lines		FSL	FWL
1/4	1/4	1/4	1/4			
Depth of Deviation		Radius of Turn	Direction	Total Length		
Measured Total Depth		True Vertical Depth	BHL From Lease, Unit, or Property Line:			

LATERAL #3

SEC	TWP	RGE	COUNTY			
Spot Location						
1/4	1/4	1/4	1/4	Feet From 1/4 Sec Lines	FSL	FWL
Depth of Deviation		Radius of Turn		Direction	Total Length	
Measured Total Depth		True Vertical Depth		BHL From Lease, Unit, or Property Line:		