

Oklahoma Corporation Commission  
Oil & Gas Conservation Division  
Post Office Box 52000  
Oklahoma City, Oklahoma 73152-2000  
Rule 165: 10-3-25

Form 1002A

API No.: 35019262710000

**Completion Report**

Spud Date: April 03, 2017

OTC Prod. Unit No.: 019-110302

Drilling Finished Date: April 15, 2017

1st Prod Date: May 27, 2017

Completion Date: May 17, 2017

**Drill Type: STRAIGHT HOLE**

Well Name: CECIL JONES 6

Purchaser/Measurer:

Location: CARTER 1 1S 3W  
SW SW SE SE  
165 FSL 1485 FWL of 1/4 SEC  
Derrick Elevation: 0 Ground Elevation: 0

First Sales Date:

Operator: DEHART COMPANY (THE) 11992  
PO BOX 914  
115 4TH AVE SW  
ARDMORE, OK 73402-0914

Completion Type		Location Exception		Increased Density	
X	Single Zone	Order No		Order No	
	Multiple Zone	There are no Location Exception records to display.		There are no Increased Density records to display.	
	Commingled				

Casing and Cement							
Type	Size	Weight	Grade	Feet	PSI	SAX	Top of CMT
PRODUCTION	5 1/2	15.50		1328		190	SURFACE

Liner								
Type	Size	Weight	Grade	Length	PSI	SAX	Top Depth	Bottom Depth
There are no Liner records to display.								

**Total Depth: 1360**

Packer		Plug	
Depth	Brand & Type	Depth	Plug Type
There are no Packer records to display.		There are no Plug records to display.	

Initial Test Data										
Test Date	Formation	Oil BBL/Day	Oil-Gravity (API)	Gas MCF/Day	Gas-Oil Ratio Cu FT/BBL	Water BBL/Day	Pumpin or Flowing	Initial Shut-In Pressure	Choke Size	Flow Tubing Pressure
May 27, 2017	TATUMS	4	24				PUMPING			

Completion and Test Data by Producing Formation										
---	--	--	--	--	--	--	--	--	--	--

Formation Name: TATUMS		Code: 404TTMS	Class: OIL
<b>Spacing Orders</b>		<b>Perforated Intervals</b>	
<b>Order No</b>	<b>Unit Size</b>	<b>From</b>	<b>To</b>
393793		930	955
<b>Acid Volumes</b>		<b>Fracture Treatments</b>	
NO ACID		NO FRAC	

Formation	Top
PERMIAN	0
HOXBAR	800

Were open hole logs run? No  
Date last log run:  
  
Were unusual drilling circumstances encountered? No  
Explanation:

<b>Other Remarks</b>
There are no Other Remarks.

<b>FOR COMMISSION USE ONLY</b>	
Status: Accepted	1138372

RECEIVED

Form 1002A  
Rev. 2009

DEC 08 2017

OKLAHOMA CORPORATION  
COMMISSIONAPI  
NO. 019 26271  
OTC PROD.  
UNIT NO. 019-110302PLEASE TYPE OR USE BLACK INK ONLY  
NOTE:Attach copy of original 1002A  
if recompletion or reentry.OKLAHOMA CORPORATION COMMISSION  
Oil & Gas Conservation Division  
Post Office Box 52000  
Oklahoma City, Oklahoma 73152-2000  
Rule 165:10-3-25

## COMPLETION REPORT

☒ ORIGINAL  
☐ AMENDED (Reason) \_\_\_\_\_

## TYPE OF DRILLING OPERATION

☒ STRAIGHT HOLE ☐ DIRECTIONAL HOLE ☐ HORIZONTAL HOLE  
☐ SERVICE WELL

If directional or horizontal, see reverse for bottom hole location.

COUNTY	Carter	SEC	1	TWP	1S	RGE	3W
LEASE NAME	Cecil Jones	WELL NO.	6	FSL OF 1/4 SEC	165	FWL OF 1/4 SEC	1485
ELEVATION	Ground	Latitude (if known)		Longitude (if known)			
OPERATOR NAME	The DeHart Company			OTC/OCC OPERATOR NO.	11992		
ADDRESS	P. O. Box 914						
CITY	Ardmore	STATE	OK	ZIP	73402		

SPUD DATE	4-3-17
DRLG FINISHED DATE	4-15-17
DATE OF WELL COMPLETION	5-17-17
1st PROD DATE	5-27-17
RECOMP DATE	

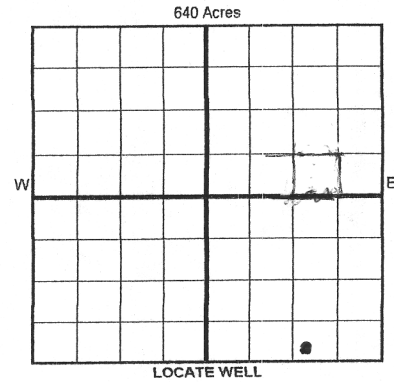

## COMPLETION TYPE

<input checked="" type="checkbox"/> SINGLE ZONE
<input type="checkbox"/> MULTIPLE ZONE
Application Date
COMMINGLED
Application Date
LOCATION EXCEPTION
ORDER NO. no
INCREASED DENSITY
ORDER NO. no

## CASING &amp; CEMENT (Form 1002C must be attached)

TYPE	SIZE	WEIGHT	GRADE	FEET	PSI	SAX	TOP OF CMT
CONDUCTOR							
SURFACE							
INTERMEDIATE							
PRODUCTION	5 1/2	15.50		1328		190	surface
LINER							
TOTAL DEPTH							1360

CBL  
Shows  
Bond  
DND
 PACKER @ \_\_\_\_\_ BRAND & TYPE \_\_\_\_\_ PLUG @ \_\_\_\_\_ TYPE \_\_\_\_\_ PLUG @ \_\_\_\_\_ TYPE \_\_\_\_\_  
 PACKER @ \_\_\_\_\_ BRAND & TYPE \_\_\_\_\_ PLUG @ \_\_\_\_\_ TYPE \_\_\_\_\_ PLUG @ \_\_\_\_\_ TYPE \_\_\_\_\_

## COMPLETION &amp; TEST DATA BY PRODUCING FORMATION

FORMATION	Tatums					No Frac
SPACING & SPACING ORDER NUMBER	393793					
CLASS: Oil, Gas, Dry, Inj, Disp, Comm Disp, Svc	oil					
PERFORATED INTERVALS	930-55					
ACID/VOLUME	na No Acid					
FRACTURE TREATMENT (Fluids/Prop Amounts)	na No Frac					

Min Gas Allowable (165:10-17-7)



OR

Oil Allowable (165:10-13-3)

Gas Purchaser/Measurer

First Sales Date

## INITIAL TEST DATA

INITIAL TEST DATE	5-27-17					
OIL-BBL/DAY	4 bbls					
OIL-GRAVITY (API)	24					
GAS-MCF/DAY						
GAS-OIL RATIO CU FT/BBL						
WATER-BBL/DAY						
PUMPING OR FLOWING	pumping					
INITIAL SHUT-IN PRESSURE						
CHOKE SIZE						
FLOW TUBING PRESSURE						

AS SUBMITTED

A record of the formations drilled through, and pertinent remarks are presented on the reverse. I declare that I have knowledge of the contents of this report and am authorized by my organization to make this report, which was prepared by me or under my supervision and direction, with the data and facts stated herein to be true, correct, and complete to the best of my knowledge and belief.

John DeHart

12-7-17 580-223-7792

SIGNATURE

NAME (PRINT OR TYPE)

DATE PHONE NUMBER

P. O. Box 914

Ardmore

OK 73402

ADDRESS

CITY

STATE

ZIP

EMAIL ADDRESS

**PLEASE TYPE OR USE BLACK INK ONLY**

**FORMATION RECORD**

Give formation names and tops, if available, or descriptions and thickness of formations drilled through. Show intervals cored or drillstem tested.

LEASE NAME Cecil Jones

WELL NO. 6

NAMES OF FORMATIONS	TOP
Surface Permian Hoxbar	800 to TD

FOR COMMISSION USE ONLY	
ITD on file <input type="checkbox"/> YES <input type="checkbox"/> NO	
APPROVED _____	DISAPPROVED _____
2) Reject Codes	

Were open hole logs run?	yes	no
Date Last log was run		
Was CO <sub>2</sub> encountered?	yes	no at what depths? _____
Was H <sub>2</sub> S encountered?	yes	no at what depths? _____
Were unusual drilling circumstances encountered?	yes	no
If yes, briefly explain below:		

Other remarks:

---



---



---



---



---



---

640 Acres

If more than three drainholes are proposed, attach a separate sheet indicating the necessary information.

Direction must be stated in degrees azimuth.  
Please note, the horizontal drainhole and its end point must be located within the boundaries of the lease or spacing unit.

Directional surveys are required for all drainholes and directional wells.

640 Acres

**BOTTOM HOLE LOCATION FOR DIRECTIONAL HOLE**

SEC	TWP	RGE	COUNTY
Spot Location		Feet From 1/4 Sec Lines	
1/4	1/4	1/4	1/4
Measured Total Depth		True Vertical Depth	BHL From Lease, Unit, or Property Line:

**BOTTOM HOLE LOCATION FOR HORIZONTAL HOLE: (LATERALS)**

**LATERAL #1**

SEC	TWP	RGE	COUNTY
Spot Location		Feet From 1/4 Sec Lines	
1/4	1/4	1/4	1/4
Depth of Deviation	Radius of Turn	Direction	Total Length
Measured Total Depth	True Vertical Depth	BHL From Lease, Unit, or Property Line:	

**LATERAL #2**

SEC	TWP	RGE	COUNTY
Spot Location		Feet From 1/4 Sec Lines	
1/4	1/4	1/4	1/4
Depth of Deviation	Radius of Turn	Direction	Total Length
Measured Total Depth	True Vertical Depth	BHL From Lease, Unit, or Property Line:	

**LATERAL #3**

SEC	TWP	RGE	COUNTY
Spot Location		Feet From 1/4 Sec Lines	
1/4	1/4	1/4	1/4
Depth of Deviation	Radius of Turn	Direction	Total Length
Measured Total Depth	True Vertical Depth	BHL From Lease, Unit, or Property Line:	