

Oklahoma Corporation Commission  
Oil & Gas Conservation Division  
Post Office Box 52000  
Oklahoma City, Oklahoma 73152-2000  
Rule 165: 10-3-25

Form 1002A

API No.: 35003232900000

**Completion Report**

Spud Date: September 25, 2017

OTC Prod. Unit No.: 003-222573

Drilling Finished Date: October 08, 2017

1st Prod Date: November 07, 2017

Completion Date: November 06, 2017

**Drill Type:** HORIZONTAL HOLE

Min Gas Allowable: Yes

Well Name: BEN 2411 1H-07 A

Purchaser/Measurer: SEMGAS

Location: ALFALFA 7 24N 11W  
NE NW NW NW  
250 FNL 400 FWL of 1/4 SEC  
Latitude: 36.578257961 Longitude: -98.424843605  
Derrick Elevation: 0 Ground Elevation: 1375

First Sales Date: 11/24/2017

Operator: MIDSTATES PETROLEUM CO LLC 23079

321 S BOSTON AVE STE 1000  
TULSA, OK 74103-3322

Completion Type		Location Exception		Increased Density	
X	Single Zone	Order No		Order No	
	Multiple Zone	672218		There are no Increased Density records to display.	
	Commingled				

Casing and Cement							
Type	Size	Weight	Grade	Feet	PSI	SAX	Top of CMT
SURFACE	13 3/8	48	J-55	417		395	SURFACE
INTERMEDIATE	9 5/8	36	J-55	1250		510	SURFACE
PRODUCTION	7	26	P-110	6910		470	2939

Liner								
Type	Size	Weight	Grade	Length	PSI	SAX	Top Depth	Bottom Depth
LINER	4.5	11.6	P-110	5301	0	575	6550	11851

**Total Depth: 11851**

Packer	
Depth	Brand & Type
There are no Packer records to display.	

Plug	
Depth	Plug Type
There are no Plug records to display.	

Initial Test Data
-------------------

Test Date	Formation	Oil BBL/Day	Oil-Gravity (API)	Gas MCF/Day	Gas-Oil Ratio Cu FT/BBL	Water BBL/Day	Pumpin or Flowing	Initial Shut-In Pressure	Choke Size	Flow Tubing Pressure
Dec 06, 2017	MISSISSIPPIAN	58	34	593	10224	8512	PUMPING	139	64/64	225

Completion and Test Data by Producing Formation

Formation Name: MISSISSIPPIAN

Code: 359MSSP

Class: OIL

Spacing Orders

Order No	Unit Size
668442	640

Perforated Intervals

From	To
6960	11773

Acid Volumes

5,164 BARRELS 15% GELLED AND RET ACID, 783 BARRELS 15% HCL

Fracture Treatments

102,065 BARRELS SLICK WATER, 172,820 POUNDS ROCK SALT

Formation	Top
ENDICOTT	4643
TONKAWA	5006
AVANT	5308
HOGSHOOTER	5536
BIG LIME	5771
OSWEGO	5878
CHEROKEE	5926
MISSISSIPPI	6234

Were open hole logs run? No

Date last log run:

Were unusual drilling circumstances encountered? No

Explanation:

Other Remarks

OCC - THIS DOCUMENT IS ACCEPTED BASED ON THE DATA SUBMITTED THE FINAL LOCATION EXCEPTION HAS NOT BEEN SUBMITTED.

Lateral Holes

Sec: 7 TWP: 24N RGE: 11W County: ALFALFA

SW SE SW SW

166 FSL 679 FWL of 1/4 SEC

Depth of Deviation: 4772 Radius of Turn: 1682 Direction: 176 Total Length: 4941

Measured Total Depth: 11851 True Vertical Depth: 6399 End Pt. Location From Release, Unit or Property Line: 166

FOR COMMISSION USE ONLY

Status: Accepted

1138382

API NO. 003 23290  
OTC PROD. UNIT NO. 003 222573

PLEASE TYPE OR USE BLACK INK ONLY  
NOTE:

Attach copy of original 1002A  
if recompletion or reentry.

OKLAHOMA CORPORATION COMMISSION  
Oil & Gas Conservation Division  
Post Office Box 52000  
Oklahoma City, Oklahoma 73152-2000  
Rule 165:10-3-25

RECEIVED

DEC 11 2017

Form 1002A  
Rev. 2009

☒ ORIGINAL  
☐ AMENDED (Reason)

COMPLETION REPORT

TYPE OF DRILLING OPERATION

☐ STRAIGHT HOLE ☐ DIRECTIONAL HOLE ☒ HORIZONTAL HOLE

If directional or horizontal, see reverse for bottom hole location.

COUNTY	Alfalfa	SEC 07	TWP 24N	RGE 11W	SPUD DATE	09/25/2017	
LEASE NAME	Ben 2411	WELL NO.	1H-07 A	DRLG FINISHED DATE	10/08/2017	DATE OF WELL COMPLETION	11/06/2017
NE 1/4 NW 1/4 NW 1/4 NW 1/4	1/4 SEC 250N	FWL OF 1/4 SEC	400	1st PROD DATE	11/07/2017	RECOMP DATE	
ELEVATION N Derrick	Ground 1375	Latitude (if known)	36.578257961	Longitude (if known)	-98.424843605	OTC/OCC OPERATOR NO.	23079
OPERATOR NAME	Midstates Petroleum Company LLC	ADDRESS	321 South Boston, Suite 1000	CITY	Tulsa	STATE	OK
ZIP	74103						

640 Acres

LOCATE WELL

COMPLETION TYPE

<input checked="" type="checkbox"/>	SINGLE ZONE
<input type="checkbox"/>	MULTIPLE ZONE
	Application Date
<input type="checkbox"/>	COMINGLED
	Application Date
LOCATION	672218 F.O.
EXCEPTION ORDER	
INCREASED DENSITY ORDER NO.	N/A

CASING & CEMENT (Form 1002C must be attached)

TYPE	SIZE	WEIGHT	GRADE	FEET	PSI	SAX	TOP OF CMT
CONDUCTOR							
SURFACE	13-3/8	48#	J-55	417'		395	surface
INTERMEDIATE	9-5/8	36#	J-55	1,250'		510	surface
PRODUCTION	7	26#	P-110	6,910'		470	2,939'
LINER	4.5	11.6#	P-110	6,550'	11,851'	575	6,549'
						TOTAL DEPTH	11,851'

PACKER @ \_\_\_\_\_ BRAND & TYPE \_\_\_\_\_ PLUG @ \_\_\_\_\_ TYPE \_\_\_\_\_ PLUG @ \_\_\_\_\_ TYPE \_\_\_\_\_  
PACKER @ \_\_\_\_\_ BRAND & TYPE \_\_\_\_\_ PLUG @ \_\_\_\_\_ TYPE \_\_\_\_\_ PLUG @ \_\_\_\_\_ TYPE \_\_\_\_\_

COMPLETION & TEST DATA BY PRODUCING FORMATION

FORMATION	Mississippian								
SPACING & SPACING ORDER NUMBER	640/668442								
CLASS: Oil, Gas, Dry, Inj, Disp, Comm Disp, Svc	Oil								
PERFORATED INTERVALS	6,960'-11,773'								
ACID/VOLUME	5164 bbls 15% gelled & ret acid	783 bbls 15% HCl							
FRACTURE TREATMENT (Fluids/Prop Amounts)	102,065 bbls slk wtr								
	172,820# rock salt								

Reported  
to Fear Focus

Min Gas Allowable (165:10-17-7)

☒ x

OR

Oil Allowable (165:10-13-3)

Gas Purchaser/Measurer  
First Sales Date

SemGas  
11/24/2017

INITIAL TEST DATA

INITIAL TEST DATE	12/06/2017								
OIL-BBL/DAY	58								
OIL-GRAVITY ( API)	34								
GAS-MCF/DAY	593								
GAS-OIL RATIO CU FT/BBL	10,224								
WATER-BBL/DAY	8,512								
PUMPING OR FLOWING	Pumping								
INITIAL SHUT-IN PRESSURE	139								
CHOKE SIZE	64/64								
FLOW TUBING PRESSURE	225								

AS SUBMITTED

A record of the formations drilled through, and pertinent remarks are presented on the reverse. I declare that I have knowledge of the contents of this report and am authorized by my organization to make this report, which was prepared by me or under my supervision and direction, with the data and facts stated herein to be true, correct, and complete to the best of my knowledge and belief.

SIGNATURE Chelce Rouse NAME (PRINT OR TYPE) Chelce Rouse DATE 11/14/2017 PHONE NUMBER 918-947-4647  
321 South Boston, Suite 1000 Tulsa, OK 74103  
ADDRESS CITY STATE ZIP chelce.rouse@midstatespetroleum.com EMAIL ADDRESS

PLEASE TYPE OR USE BLACK INK ONLY

FORMATION RECORD

Give formation names and tops, if available, or descriptions and thickness of formations drilled through. Show intervals cored or drillstem tested.

NAMES OF FORMATIONS	TOP
ENDICOTT	4,643
TONKAWA	5,006
AVANT	5,308
HOGSHOOTER	5,536
BIG LIME	5,771
OSWEGO	5,878
CHEROKEE	5,926
MISSISSIPPI	6,234

LEASE NAME Ben 2411

WELL NO. 1H-07 A

FOR COMMISSION USE ONLY	
ITD on file <input type="checkbox"/> YES <input type="checkbox"/> NO	
APPROVED _____	DISAPPROVED _____
2) Reject Codes	
_____	
_____	
_____	
_____	
_____	

Were open hole logs run?	<input type="checkbox"/> yes <input checked="" type="checkbox"/> no
Date Last log was run	<u>N/A</u>
Was CO <sub>2</sub> encountered?	<input type="checkbox"/> yes <input checked="" type="checkbox"/> no at what depths? _____
Was H <sub>2</sub> S encountered?	<input type="checkbox"/> yes <input checked="" type="checkbox"/> no at what depths? _____
Were unusual drilling circumstances encountered?	<input type="checkbox"/> yes <input checked="" type="checkbox"/> no
If yes, briefly explain below	

Other remarks:

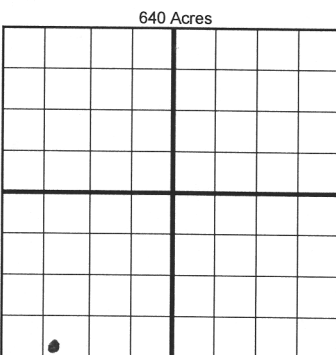



If more than three drainholes are proposed, attach a separate sheet indicating the necessary information.

Direction must be stated in degrees azimuth.

Please note, the horizontal drainhole and its end point must be located within the boundaries of the lease or spacing unit.

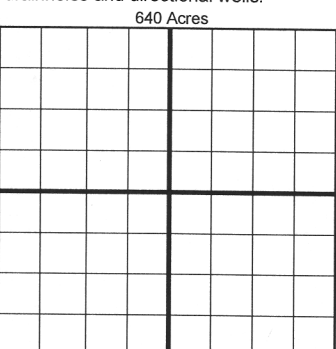
Directional surveys are required for all drainholes and directional wells.



BOTTOM HOLE LOCATION FOR DIRECTIONAL HOLE

SEC	TWP	RGE	COUNTY
Spot Location	1/4	1/4	1/4
Measured Total Depth	True Vertical Depth	BHL From Lease, Unit, or Property Line:	

BOTTOM HOLE LOCATION FOR HORIZONTAL HOLE: (LATERALS)

LATERAL #1			
SEC	TWP	RGE	COUNTY
07	24N	11W	Alfalfa
Spot Location	1/4	1/4	1/4
Depth of Deviation	Radius of Turn	Direction	Total Length
Measured Total Depth	True Vertical Depth	BHL From Lease, Unit, or Property Line:	

LATERAL #2			
SEC	TWP	RGE	COUNTY
Spot Location	1/4	1/4	1/4
Depth of Deviation	Radius of Turn	Direction	Total Length
Measured Total Depth	True Vertical Depth	BHL From Lease, Unit, or Property Line:	

LATERAL #3			
SEC	TWP	RGE	COUNTY
Spot Location	1/4	1/4	1/4
Depth of Deviation	Radius of Turn	Direction	Total Length
Measured Total Depth	True Vertical Depth	BHL From Lease, Unit, or Property Line:	