

Oklahoma Corporation Commission
Oil & Gas Conservation Division
Post Office Box 52000
Oklahoma City, Oklahoma 73152-2000
Rule 165: 10-3-25

Form 1002A

API No.: 35085212760000

Completion Report

Spud Date: January 29, 2017

OTC Prod. Unit No.: 085-222532

Drilling Finished Date: July 13, 2017

1st Prod Date: November 18, 2017

Completion Date: November 18, 2017

Drill Type: HORIZONTAL HOLE

Well Name: RANDY 1-13H11X2

Purchaser/Measurer:

Location: LOVE 13 7S 1E
SW NW NW NW
635 FNL 220 FWL of 1/4 SEC
Derrick Elevation: 945 Ground Elevation: 918

First Sales Date: 11/18/2017

Operator: XTO ENERGY INC 21003

810 HOUSTON ST
FORT WORTH, TX 76102-6203

Completion Type	
X	Single Zone
	Multiple Zone
	Commingled

Location Exception
Order No
661737

Increased Density
Order No
661594

Casing and Cement							
Type	Size	Weight	Grade	Feet	PSI	SAX	Top of CMT
CONDUCTOR	20	169	J-55	107			SURFACE
SURFACE	9 5/8	36	J-55	2050		460	SURFACE
PRODUCTION	7	52	P-110	15205		490	10860

Liner								
Type	Size	Weight	Grade	Length	PSI	SAX	Top Depth	Bottom Depth
LINER	4 1/2	15.10	P-110	8954	0	695	14579	23533

Total Depth: 23533

Packer	
Depth	Brand & Type
There are no Packer records to display.	

Plug	
Depth	Plug Type
There are no Plug records to display.	

Initial Test Data

Test Date	Formation	Oil BBL/Day	Oil-Gravity (API)	Gas MCF/Day	Gas-Oil Ratio Cu FT/BBL	Water BBL/Day	Pumpin or Flowing	Initial Shut-In Pressure	Choke Size	Flow Tubing Pressure
Dec 12, 2017	WOODFORD	53	42	144	2717	3681	FLOWING		18/64	3750

Completion and Test Data by Producing Formation

Formation Name: WOODFORD

Code: 319WDFD

Class: OIL

Spacing Orders

Order No	Unit Size
620744	640
648680	640
661595	MULTIUNIT

Perforated Intervals

From	To
15895	23361

Acid Volumes

36,000 GALLONS HCL

Fracture Treatments

39 STAGES - 808,905 BBLS TREATED WATER, 1,862,250 POUNDS 100 MESH SAND AND, 15,268,400 POUNDS 40/70 SAND
--

Formation	Top
WOODFORD	15611

Were open hole logs run? No

Date last log run:

Were unusual drilling circumstances encountered? No

Explanation:

Other Remarks

IRREGULAR SECTION. TIE-BACK WAS RUN FROM SURFACE TO 14,579'. OCC - THIS DOCUMENT IS ACCEPTED BASED ON THE DATA SUBMITTED NEITHER THE FINAL LOCATION EXCEPTION NOR THE FINAL MULTIUNIT ORDERS HAVE BEEN ISSUED.

Lateral Holes

Sec: 2 TWP: 7S RGE: 1E County: LOVE

NW NE NE SE

2539 FSL 495 FEL of 1/4 SEC

Depth of Deviation: 11975 Radius of Turn: 2533 Direction: 355 Total Length: 8479

Measured Total Depth: 23533 True Vertical Depth: 15068 End Pt. Location From Release, Unit or Property Line: 2539

FOR COMMISSION USE ONLY

Status: Accepted

1138418

RECEIVED

DEC 15 2017

Form 1002A
Rev. 2009

OKLAHOMA CORPORATION COMMISSION

API NO. 085-21276
OTC PROD. UNIT NO. 085-222532

PLEASE TYPE OR USE BLACK INK ONLY
NOTE:

Attach copy of original 1002A
if recompletion or reentry.

OKLAHOMA CORPORATION COMMISSION
Oil & Gas Conservation Division
Post Office Box 52000
Oklahoma City, Oklahoma 73152-2000
Rule 165:10-3-25

☒ ORIGINAL
☐ AMENDED (Reason)

COMPLETION REPORT

TYPE OF DRILLING OPERATION

☐ STRAIGHT HOLE ☐ DIRECTIONAL HOLE ☒ HORIZONTAL HOLE
SERVICE WELL

If directional or horizontal, see reverse for bottom hole location.

COUNTY	Love	SEC	13	TWP	7S	RGE	1E
LEASE NAME	Randy 1-13H11X2			WELL NO.	→		
SW 1/4 NW 1/4 NW 1/4 NW 1/4	FNL OF 1/4 SEC 635			FWL OF 1/4 SEC	220		
ELEVATION N Derrick	945'	Ground	918'	Latitude (if known)	33.953141N		
OPERATOR NAME	XTO Energy Inc.			OTC/OCC OPERATOR NO.	21003		
ADDRESS	210 Park Avenue, Suite 2350						
CITY	Oklahoma City	STATE	Oklahoma	ZIP	73102		

SPUD DATE 1/29/2017
DRLG FINISHED DATE 7/13/2017
DATE OF WELL COMPLETION 11/18/2017
1st PROD DATE 11/18/2017
RECOMP DATE
Longitude (if known) - 97.160054W

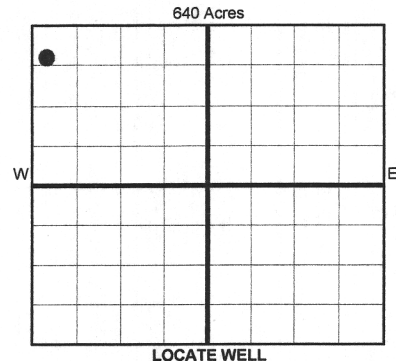

COMPLETION TYPE

<input checked="" type="checkbox"/> SINGLE ZONE
<input type="checkbox"/> MULTIPLE ZONE
Application Date
COMMINGLED
Application Date
LOCATION
EXCEPTION ORDER
INCREASED DENSITY
ORDER NO.

661737, 661595
661594

CASING & CEMENT (Form 1002C must be attached)

TYPE	SIZE	WEIGHT	GRADE	FEET	PSI	SAX	TOP OF CMT
CONDUCTOR	20"	169#	J-55	107			Surface
SURFACE	9 5/8"	36#	J-55	2,050		460	Surface
INTERMEDIATE	7"	52#	P110	15,205		490,300	10,860
PRODUCTION	4 1/2"	15.10#	P110	14,579			
LINER	4 1/2"	15.10#	P110	8,951		23533	14,579
TOTAL DEPTH							23,533'

PACKER @ _____ BRAND & TYPE _____ PLUG @ _____ TYPE _____ PLUG @ _____ TYPE _____
PACKER @ _____ BRAND & TYPE _____ PLUG @ _____ TYPE _____ PLUG @ _____ TYPE _____

COMPLETION & TEST DATA BY PRODUCING FORMATION

FORMATION	Woodford				
SPACING & SPACING ORDER NUMBER	640: 620744,	648680	(640)	661595 (Multiunit)	
CLASS: Oil, Gas, Dry, Inj, Disp, Comm Disp, Svc	Oil				
PERFORATED INTERVALS	39 Stages				
	15,895-23,361'				
ACID/VOLUME	36,000 gals				
	808,905 BTW				
FRACTURE TREATMENT (Fluids/Prop Amounts)	1,862,250# 100 Mesh				
	15,268,400# 40/70				

Min Gas Allowable (165:10-17-7) ☐ OR Gas Purchaser/Measurer
Oil Allowable (165:10-13-3) First Sales Date 11/18/2017

INITIAL TEST DATA

INITIAL TEST DATE	12/12/2017				
OIL-BBL/DAY	53				
OIL-GRAVITY (API)	42				
GAS-MCF/DAY	144				
GAS-OIL RATIO CU FT/BBL	2717				
WATER-BBL/DAY	3681				
PUMPING OR FLOWING	Flowing				
INITIAL SHUT-IN PRESSURE					
CHOKE SIZE	18/64"				
FLOW TUBING PRESSURE	3750 FCP				

AS SUBMITTED

A record of the formations drilled through, and pertinent remarks are presented on the reverse. I declare that I have knowledge of the contents of this report and am authorized by my organization to make this report, which was prepared by me or under my supervision and direction, with the data and facts stated herein to be true, correct, and complete to the best of my knowledge and belief.

Signature: Debbie Waggoner NAME (PRINT OR TYPE) Debbie Waggoner DATE 12/13/2017 PHONE NUMBER 405-319-3243
ADDRESS 210 Park Avenue, Suite 2350 CITY Oklahoma City STATE Ok ZIP 73102 EMAIL ADDRESS debbie_waggoner@xtoenergy.com

Give formation names and tops, if available, or descriptions and thickness of formations drilled through. Show intervals cored or drillstem tested.

WELL NO. 1-13H11X2

Were open hole logs run? ___ yes X no

Date Last log was run _____

Was CO₂ encountered? ___ yes X no at what depths? _____

Was H₂S encountered? ___ yes X no at what depths? _____

Were unusual drilling circumstances encountered? ___ yes X no

If yes, briefly explain below _____

Tie-back was run from surface to 14,579'.

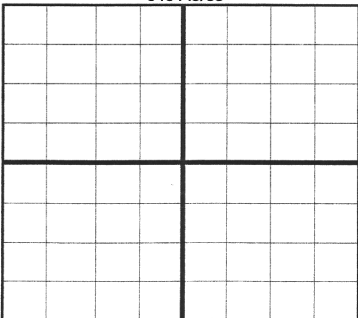

INTERNAL #3							
SEC	TWP	RGE	COUNTY				
Spot Location				Feet From 1/4 Sec Lines		FSL	FWL
1/4	1/4	1/4	1/4				
Depth of Deviation		Radius of Turn	Direction		Total Length		
Measured Total Depth		True Vertical Depth	BHL From Lease, Unit, or Property Line:				