

Oklahoma Corporation Commission  
Oil & Gas Conservation Division  
Post Office Box 52000  
Oklahoma City, Oklahoma 73152-2000  
Rule 165: 10-3-25

Form 1002A

API No.: 35049387770004

**Completion Report**

Spud Date: August 28, 1948

OTC Prod. Unit No.:

Drilling Finished Date: November 20, 1948

**Amended**

1st Prod Date: September 26, 1990

Amend Reason: PLUGGED AND ABANDONED

Completion Date: September 26, 1990

Recomplete Date: November 13, 2017

**Drill Type: STRAIGHT HOLE**

Well Name: STATE LAND G 2

Purchaser/Measurer:

Location: GARVIN 25 4N 3W  
C NE NW SW  
2310 FSL 990 FWL of 1/4 SEC  
Derrick Elevation: 0 Ground Elevation: 1113

First Sales Date:

Operator: XTO ENERGY INC 21003

810 HOUSTON ST  
FORT WORTH, TX 76102-6203

Completion Type		Location Exception		Increased Density	
	Single Zone	Order No		Order No	
	Multiple Zone	There are no Location Exception records to display.		There are no Increased Density records to display.	
	Commingled				

Casing and Cement							
Type	Size	Weight	Grade	Feet	PSI	SAX	Top of CMT
SURFACE	10 3/4	32.75		952		700	SURFACE
PRODUCTION	7	23		7747		600	6270

Liner								
Type	Size	Weight	Grade	Length	PSI	SAX	Top Depth	Bottom Depth
There are no Liner records to display.								

**Total Depth: 7747**

Packer	
Depth	Brand & Type
There are no Packer records to display.	

Plug	
Depth	Plug Type
There are no Plug records to display.	

Initial Test Data										
Test Date	Formation	Oil BBL/Day	Oil-Gravity (API)	Gas MCF/Day	Gas-Oil Ratio Cu FT/BBL	Water BBL/Day	Pumpin or Flowing	Initial Shut-In Pressure	Choke Size	Flow Tubing Pressure
There are no Initial Data records to display.										

**Completion and Test Data by Producing Formation**

Formation Name: NONE

Code:

Class: PLUG AND ABANDON

**Formation****Top**

Were open hole logs run? No

Date last log run:

Were unusual drilling circumstances encountered? No

Explanation:

**Other Remarks**

IRREGULAR SECTION

**FOR COMMISSION USE ONLY**

1138458

Status: Accepted

# RECEIVED

DEC 11 2017

Form 1002A  
Rev. 2009

OKLAHOMA CORPORATION COMMISSION

API NO. **049-38777**  
OTC PROD. UNIT NO.

PLEASE TYPE OR USE BLACK INK ONLY  
NOTE:

Attach copy of original 1002A  
if recompletion or reentry.

OKLAHOMA CORPORATION COMMISSION  
Oil & Gas Conservation Division  
Post Office Box 52000  
Oklahoma City, Oklahoma 73152-2000  
Rule 165:10-3-25

☐ ORIGINAL  
☒ AMENDED (Reason)

**Plugged and Abandoned**

## COMPLETION REPORT

### TYPE OF DRILLING OPERATION

☒ STRAIGHT HOLE ☐ DIRECTIONAL HOLE ☐ HORIZONTAL HOLE  
☐ SERVICE WELL

If directional or horizontal, see reverse for bottom hole location.

COUNTY	Garvin	SEC	25	TWP	4N	RGE	3W
LEASE NAME	State Land G			WELL NO.	2		
NE 1/4 NW 1/4 SW 1/4	1/4	FSL OF 1/4 SEC	2310	FWL OF 1/4 SEC	990'		
ELEVATION N Derrick	Ground	1113	Latitude (if known)				
OPERATOR NAME	XTO Energy Inc.			OTC/OCC OPERATOR NO.	21003		
ADDRESS	210 Park Avenue, Suite 2350						
CITY	Oklahoma City	STATE	Oklahoma	ZIP	73102		

SPUD DATE **8/28/1948**  
DRLG FINISHED DATE **11/20/48 12/10/48**  
DATE OF WELL COMPLETION **9/26/1990**  
1st PROD DATE **9/26/1990**  
RECOMP DATE **11-13-2017**

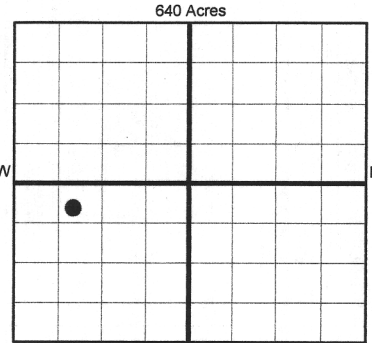

### COMPLETION TYPE

<input type="checkbox"/> SINGLE ZONE
<input type="checkbox"/> MULTIPLE ZONE
Application Date
COMINGLED
Application Date
LOCATION
EXCEPTION ORDER
INCREASED DENSITY
ORDER NO.

### CASING & CEMENT (Form 1002C must be attached)

TYPE	SIZE	WEIGHT	GRADE	FEET	PSI	SAX	TOP OF CMT
CONDUCTOR							
SURFACE	10 3/4"	32.75#		952		700	Surface
INTERMEDIATE							
PRODUCTION	7"	23#		7,747		600	6270
LINER							
						TOTAL DEPTH	7747'

PACKER @ \_\_\_\_\_ BRAND & TYPE \_\_\_\_\_ PLUG @ \_\_\_\_\_ TYPE \_\_\_\_\_ PLUG @ \_\_\_\_\_ TYPE \_\_\_\_\_  
PACKER @ \_\_\_\_\_ BRAND & TYPE \_\_\_\_\_ PLUG @ \_\_\_\_\_ TYPE \_\_\_\_\_ PLUG @ \_\_\_\_\_ TYPE \_\_\_\_\_

### COMPLETION & TEST DATA BY PRODUCING FORMATION

FORMATION	P & A'd	11/13/2017					
SPACING & SPACING ORDER NUMBER							
CLASS: Oil, Gas, Dry, Inj, Disp, Comm Disp, Svc							
PERFORATED INTERVALS							
ACID/VOLUME							
FRACTURE TREATMENT (Fluids/Prop Amounts)							

Min Gas Allowable (165:10-17-7)

Gas Purchaser/Measurer

OR

First Sales Date

Oil Allowable (165:10-13-3)

### INITIAL TEST DATA

INITIAL TEST DATE							
OIL-BBL/DAY							
OIL-GRAVITY ( API)							
GAS-MCF/DAY							
GAS-OIL RATIO CU FT/BBL							
WATER-BBL/DAY							
PUMPING OR FLOWING							
INITIAL SHUT-IN PRESSURE							
CHOKE SIZE							
FLOW TUBING PRESSURE							

**AS SUBMITTED**

A record of the formations drilled through, and pertinent remarks are presented on the reverse. I declare that I have knowledge of the contents of this report and am authorized by my organization to make this report, which was prepared by me or under my supervision and direction, with the data and facts stated herein to be true, correct, and complete to the best of my knowledge and belief.

*Debbie Waggoner*  
SIGNATURE NAME (PRINT OR TYPE) DATE PHONE NUMBER  
210 Park Avenue, Suite 2350 Oklahoma City Ok 73102  
ADDRESS CITY STATE ZIP  
debbie\_waggoner@xtoenergy.com  
EMAIL ADDRESS

Give formation names and tops, if available, or descriptions and thickness of formations drilled through. Show intervals cored or drillstem tested.

NAMES OF FORMATIONS	TOP

FOR COMMISSION USE ONLY	
ITD on file	<input type="checkbox"/> YES <input type="checkbox"/> NO
APPROVED	DISAPPROVED
	2) Reject Codes  <hr/> <hr/> <hr/> <hr/> <hr/>

Were open hole logs run? ☐ yes ☒ no

Date Last log was run \_\_\_\_\_

Was CO<sub>2</sub> encountered? ☐ yes ☒ no at what depths? \_\_\_\_\_

Was H<sub>2</sub>S encountered? ☐ yes ☒ no at what depths? \_\_\_\_\_

Were unusual drilling circumstances encountered? ☐ yes ☒ no

If yes, briefly explain below \_\_\_\_\_

Other remarks:	Irregular Section

A blank 10x10 grid with a bold cross dividing it into four 5x5 quadrants.

Direction must be stated in degrees azimuth.  
Please note, the horizontal drainhole and its end point must be located within the boundaries of the lease or spacing unit.

SEC	TWP	RGE	COUNTY
Spot Location			
1/4	1/4	1/4	1/4
Measured Total Depth		True Vertical Depth	BHL From Lease, Unit, or Property Line:

LATERAL #1						
SEC	TWP	RGE	COUNTY			
Spot Location						
1/4			1/4	1/4	Feet From 1/4 Sec Lines	FSL
Depth of Deviation			Radius of Turn	Direction	Total Length	
Measured Total Depth			True Vertical Depth	BHL From Lease, Unit, or Property Line:		

INTERNAL #2						
SEC	TWP	RGE	COUNTY			
Spot Location						
1/4	1/4	1/4	1/4	Feet From 1/4 Sec Lines	FSL	FWL
Depth of Deviation		Radius of Turn	Direction		Total Length	
Measured Total Depth		True Vertical Depth	BHL From Lease, Unit, or Property Line:			

EXTERNAL #3						
SEC	TWP	RGE	COUNTY			
Spot Location						
1/4	1/4	1/4	1/4	Feet From 1/4 Sec Lines	FSL	FWL
Depth of Deviation			Radius of Turn	Direction	Total Length	
Measured Total Depth			True Vertical Depth	BHL From Lease, Unit, or Property Line:		