

Oklahoma Corporation Commission
Oil & Gas Conservation Division
Post Office Box 52000
Oklahoma City, Oklahoma 73152-2000
Rule 165: 10-3-25

Form 1002A

API No.: 35137135160002

Completion Report

Spud Date: January 15, 1953

OTC Prod. Unit No.: 24762

Drilling Finished Date: January 28, 1953

1st Prod Date:

Amended

Completion Date: February 07, 1953

Amend Reason: CHANGE TO TEMPORARILY ABANDONED STATUS / CHANGE WELL
NAME AND NUMBER

Recomplete Date: December 19, 2017

Drill Type: STRAIGHT HOLE

Well Name: WEST MARLOW HOXBAR UNIT (ROSA SEARS 5) 10-5

Purchaser/Measurer:

Location: STEPHENS 20 2N 8W
C NE SW NE
990 FSL 990 FWL of 1/4 SEC
Latitude: 34.6347 Longitude: -98.06001
Derrick Elevation: 0 Ground Elevation: 0

First Sales Date:

Operator: WISE OIL & GAS COMPANY LLC 20756
PO BOX 3517
3500 ROAD (PRAGUE)
SHAWNEE, OK 74802-3517

| Completion Type | | Location Exception | | Increased Density | |
|-----------------|---------------|---|--|--|--|
| X | Single Zone | Order No | | Order No | |
| | Multiple Zone | There are no Location Exception records to display. | | There are no Increased Density records to display. | |
| | Commingled | | | | |

| Casing and Cement | | | | | | | |
|-------------------|-------|--------|-------|------|-----|-----|------------|
| Type | Size | Weight | Grade | Feet | PSI | SAX | Top of CMT |
| CONDUCTOR | 10 3/ | 32.75 | 8 RD | 451 | | 300 | |
| PRODUCTION | 7 | 23 | 8 RD | 6885 | | 200 | |

| Liner | | | | | | | | |
|--|------|--------|-------|--------|-----|-----|-----------|--------------|
| Type | Size | Weight | Grade | Length | PSI | SAX | Top Depth | Bottom Depth |
| There are no Liner records to display. | | | | | | | | |

Total Depth: 8316

| Packer | | Plug | |
|---|--------------|-------|-----------|
| Depth | Brand & Type | Depth | Plug Type |
| There are no Packer records to display. | | 6761 | CIBP |

| Initial Test Data |
|-------------------|
|-------------------|

| Test Date | Formation | Oil BBL/Day | Oil-Gravity (API) | Gas MCF/Day | Gas-Oil Ratio Cu FT/BBL | Water BBL/Day | Pumpin or Flowing | Initial Shut- In Pressure | Choke Size | Flow Tubing Pressure |
|-----------|-----------|----------------|----------------------|----------------|----------------------------|------------------|----------------------|---------------------------------|---------------|-------------------------|
|-----------|-----------|----------------|----------------------|----------------|----------------------------|------------------|----------------------|---------------------------------|---------------|-------------------------|

There are no Initial Data records to display.

Completion and Test Data by Producing Formation

Formation Name: SEARS

Code: 406SERS

Class: TA

| Spacing Orders | |
|--|-----------|
| Order No | Unit Size |
| There are no Spacing Order records to display. | |

| Perforated Intervals | |
|----------------------|------|
| From | To |
| 6712 | 6815 |

| Acid Volumes | |
|--|--|
| There are no Acid Volume records to display. | |

| Fracture Treatments | |
|--|--|
| There are no Fracture Treatments records to display. | |

| Formation | Top |
|--------------------|-----|
| SEE ORIGINAL 1002A | 0 |

Were open hole logs run? No

Date last log run:

Were unusual drilling circumstances encountered? No

Explanation:

| Other Remarks |
|-----------------------------|
| There are no Other Remarks. |

FOR COMMISSION USE ONLY

1138421

Status: Accepted

API NO. 137-13516
OTC PROD. UNIT NO. 24762

PLEASE TYPE OR USE BLACK INK ONLY

NOTE:

Attach copy of original 1002A if recompletion or reentry.

OKLAHOMA CORPORATION COMMISSION
Oil & Gas Conservation Division
Post Office Box 52000
Oklahoma City, Oklahoma 73152-2000

Form 1002A
Rev. 2009

☐ ORIGINAL
☒ AMENDED (Reason)

Change to TA status / Change Well Name and Number

Rule 165:10-3-25

COMPLETION REPORT

TYPE OF DRILLING OPERATION

☒ STRAIGHT HOLE ☐ DIRECTIONAL HOLE ☐ HORIZONTAL HOLE
☐ SERVICE WELL

If directional or horizontal, see reverse for bottom hole location.

COUNTY Stephens SEC 20 TWP 2N RGE 8W
LEASE NAME West Marlow Hoxbar Unit WELL NO. 10-5
DATE OF WELL COMPLETION 2-7-1953
1st PROD DATE
FSL OF 1/4 SEC 990 FWL OF 1/4 SEC 990 RECOMP DATE 12-19-2017
ELEVATION Derrick FL Ground Latitude (if known) 34.6347 Longitude (if known) -98.06001
OPERATOR NAME Wise Oil & Gas OTC/OCC OPERATOR NO. 20756
ADDRESS PO Box 3517
CITY Shawnee STATE OK. ZIP 74802

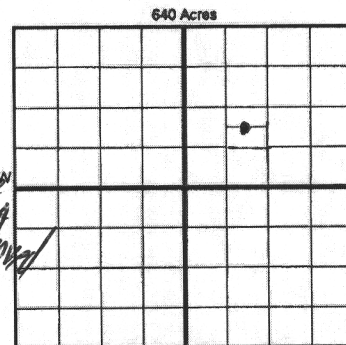

COMPLETION TYPE

☒ SINGLE ZONE
☐ MULTIPLE ZONE
Application Date
☐ COMMINGLED
Application Date
LOCATION EXCEPTION
ORDER NO.
INCREASED DENSITY
ORDER NO.

CASING & CEMENT (Form 1002C must be attached)

| TYPE | SIZE | WEIGHT | GRADE | FEET | PSI | SAX | TOP OF CMT |
|--------------|--------|--------|-------|------|-----|-------|------------|
| CONDUCTOR | 10 3/4 | 32.75 | 8 rd | 451 | | 300 | |
| SURFACE | | | | | | | |
| INTERMEDIATE | | | | | | | |
| PRODUCTION | 7 | 23 | 8 rd | 6885 | | 200 | |
| LINER | CIBP | PBTD | | 6761 | | | |
| TOTAL DEPTH | | | | | | 8,316 | |

PACKER @ _____ BRAND & TYPE _____ PLUG @ 6761 TYPE CIBP PLUG @ _____ TYPE _____
PACKER @ _____ BRAND & TYPE _____ PLUG @ _____ TYPE _____ PLUG @ _____ TYPE _____

COMPLETION & TEST DATA BY PRODUCING FORMATION

| | | | | | | | |
|---|-----------|--|--|--|--|--|--|
| FORMATION | Sears | | | | | | |
| SPACING & SPACING ORDER NUMBER | | | | | | | |
| CLASS: Oil, Gas, Dry, Inj, Disp, Comm Disp, Svc | TA | | | | | | |
| | 6712-6815 | | | | | | |
| PERFORATED INTERVALS | | | | | | | |
| ACID/VOLUME | | | | | | | |
| FRACTURE TREATMENT (Fluids/Prop Amounts) | | | | | | | |

RECEIVED

DEC 14 2017

OKLAHOMA CORPORATION COMMISSION
OCCUPANCY OFFICE

Min Gas Allowable (165:10-17-7)

Gas Purchaser/Measurer



OR

First Sales Date

INITIAL TEST DATA

Oil Allowable (165:10-13-3)

| | | | | | | | |
|--------------------------|--|--|--|--|--|--|--|
| INITIAL TEST DATE | | | | | | | |
| OIL-BBL/DAY | | | | | | | |
| OIL-GRAVITY (API) | | | | | | | |
| GAS-MCF/DAY | | | | | | | |
| GAS-OIL RATIO CU FT/BBL | | | | | | | |
| WATER-BBL/DAY | | | | | | | |
| PUMPING OR FLOWING | | | | | | | |
| INITIAL SHUT-IN PRESSURE | | | | | | | |
| CHOKE SIZE | | | | | | | |
| FLOW TUBING PRESSURE | | | | | | | |

AS SUBMITTED

A record of the formations drilled through, and pertinent remarks are presented on the reverse. I declare that I have knowledge of the contents of this report and am authorized by my organization to make this report, which was prepared by me or under my supervision and direction, with the data and facts stated herein to be true, correct, and complete to the best of my knowledge and belief.

SIGNATURE

NAME (PRINT OR TYPE)

DATE

PHONE NUMBER

PO Box 3517

Shawnee

OK 74802-3517

WISE1007@icloud.com

ADDRESS

CITY

STATE

ZIP

EMAIL ADDRESS

Give formation names and tops, if available, or descriptions and thickness of formations drilled through. Show intervals cored or drillstem tested.

| NAMES OF FORMATIONS | TOP |
|---------------------------|-----|
| <p>see original 1002A</p> | |

| FOR COMMISSION USE ONLY | |
|-------------------------|--|
| ITD on file | <input type="checkbox"/> YES <input type="checkbox"/> NO |
| APPROVED | DISAPPROVED |
| 2) Reject Codes | |
| | |
| | |
| | |
| | |
| | |

Were open hole logs run? ☐ yes ☐ no

Date Last log was run _____

Was CO₂ encountered? ☐ yes ☐ no at what depths? _____

Was H₂S encountered? ☐ yes ☐ no at what depths? _____

Were unusual drilling circumstances encountered? ☐ yes ☐ no

If yes, briefly explain below:

Other remarks:

A blank 10x10 grid for graphing, with a horizontal and vertical axis intersecting at the center. The grid is divided into four quadrants by these axes. The top-left quadrant is labeled 'Q2', the top-right 'Q1', the bottom-left 'Q3', and the bottom-right 'Q4'.

Direction must be stated in degrees azimuth. Please note, the horizontal drainhole and its end point must be located within the boundaries of the lease or spacing unit.

640 Acres

A blank 10x10 grid for graphing, with a thicker vertical line separating the first column from the rest of the grid.

| | | | | | | |
|----------------------|-----|---------------------|--------|---|-----|-----|
| SEC | TWP | RGE | COUNTY | | | |
| Spot Location 1/4 | | 1/4 | 1/4 | Feet From 1/4 Sec Lines | FSL | FWL |
| Measured Total Depth | | True Vertical Depth | | BHL From Lease, Unit, or Property Line: | | |

| LATERAL #1 | | | | | | |
|-----------------------------|------------|----------------------------|---------------|--|--------------------------------|---------------------|
| SEC | TWP | RGE | COUNTY | | | |
| Spot Location : | | | | | | |
| 1/4 | | 1/4 | | 1/4 | Feet From 1/4 Sec Lines | FSL |
| Depth of Deviation : | | Radius of Turn | | Direction | | Total Length |
| Measured Total Depth | | True Vertical Depth | | BHL From Lease, Unit, or Property Line: | | |

| LATERAL #2 | | | | | | |
|----------------------|-----|---------------------|---|-------------------------|-----|-----|
| SEC | TWP | RGE | COUNTY | | | |
| Spot Location | | | | Feet From 1/4 Sec Lines | FSL | FWL |
| 1/4 | 1/4 | 1/4 | 1/4 | | | |
| Depth of Deviation | | Radius of Turn | Direction | Total Length | | |
| Measured Total Depth | | True Vertical Depth | BHL From Lease, Unit, or Property Line: | | | |

| LATERAL #3 | | | | | | |
|----------------------|-----|---------------------|---|-------------------------|-----|-----|
| SEC | TWP | RGE | COUNTY | | | |
| Spot Location | | | | Feet From 1/4 Sec Lines | FSL | FWL |
| 1/4 | 1/4 | 1/4 | 1/4 | | | |
| Depth of Deviation | | Radius of Turn | Direction | Total Length | | |
| Measured Total Depth | | True Vertical Depth | BHL From Lease, Unit, or Property Line: | | | |