

Oklahoma Corporation Commission
Oil & Gas Conservation Division
Post Office Box 52000
Oklahoma City, Oklahoma 73152-2000
Rule 165: 10-3-25

Form 1002A

API No.: 35073225190001

Completion Report

Spud Date: February 05, 1980

OTC Prod. Unit No.: 073-61238

Drilling Finished Date: February 21, 1980

1st Prod Date: April 15, 1980

Completion Date: April 15, 1980

Amended

Amend Reason: TEMPORARILY ABANDONED

Drill Type: STRAIGHT HOLE

Well Name: JICO-HARRIS (HARRIS 1) 1

Purchaser/Measurer:

Location: KINGFISHER 9 18N 5W
C NE SE
1980 FSL 1980 FWL of 1/4 SEC
Derrick Elevation: 1131 Ground Elevation: 1124

First Sales Date:

Operator: PEARL OIL COMPANY 18493

1506 BUTTRAM RD
NICHOLS HILLS, OK 73120-1408

Completion Type		Location Exception		Increased Density	
	Single Zone	Order No		Order No	
	Multiple Zone	There are no Location Exception records to display.		There are no Increased Density records to display.	
X	Commingled				

Casing and Cement							
Type	Size	Weight	Grade	Feet	PSI	SAX	Top of CMT
CONDUCTOR	26			50			SURFACE
SURFACE	8 5/8	23	J	620	1000	500	SURFACE
PRODUCTION	4 1/2	MISC	K	7100		450	

Liner								
Type	Size	Weight	Grade	Length	PSI	SAX	Top Depth	Bottom Depth
There are no Liner records to display.								

Total Depth: 7116

Packer		Plug	
Depth	Brand & Type	Depth	Plug Type
6850	PENGO	There are no Plug records to display.	

Initial Test Data

Test Date	Formation	Oil BBL/Day	Oil-Gravity (API)	Gas MCF/Day	Gas-Oil Ratio Cu FT/BBL	Water BBL/Day	Pumpin or Flowing	Initial Shut-In Pressure	Choke Size	Flow Tubing Pressure
There are no Initial Data records to display.										
Completion and Test Data by Producing Formation										
Formation Name: VIOLA			Code: 202VIOL			Class: TA				
Spacing Orders				Perforated Intervals						
Order No		Unit Size		From			To			
There are no Spacing Order records to display.				6946			6968			
Acid Volumes				Fracture Treatments						
There are no Acid Volume records to display.				There are no Fracture Treatments records to display.						
Formation Name: MISSISSIPPI			Code: 351MISS			Class: TA				
Spacing Orders				Perforated Intervals						
Order No		Unit Size		From			To			
There are no Spacing Order records to display.				6254			6716			
Acid Volumes				Fracture Treatments						
There are no Acid Volume records to display.				There are no Fracture Treatments records to display.						
Formation Name: OSWEGO			Code: 404OSWG			Class: TA				
Spacing Orders				Perforated Intervals						
Order No		Unit Size		From			To			
There are no Spacing Order records to display.				5981			5988			
Acid Volumes				Fracture Treatments						
There are no Acid Volume records to display.				There are no Fracture Treatments records to display.						

Formation	Top
LAYTON SAND	5273
BIG LIME OSWEGO	5850
LOWER OSWEGO	5980
MISSISSIPPI	6250
WOODFORD	6732
VIOLA	6886

Were open hole logs run? Yes
Date last log run: February 21, 1980

Were unusual drilling circumstances encountered? No
Explanation:

Other Remarks
ELECTRIC LOGS: FIL, FDC, GR/CAL BY SCHLUMBERGER FEBRUARY 21, 1980

Status: Accepted

RECEIVED

MAR 09 2018

OKLAHOMA CORPORATION COMMISSION

Form 1002A
Rev. 2009

API NO. 07322519
OTC PROD UNIT NO. 073-61238

PLEASE TYPE OR USE BLACK INK ONLY

NOTE:

Attach copy of original 1002A
if recompletion or reentry.

OKLAHOMA CORPORATION COMMISSION
Oil & Gas Conservation Division
Post Office Box 52000
Oklahoma City, Oklahoma 73152-2000
Rule 165:10-3-25

☐ ORIGINAL
☒ AMENDED (Reason)

TA

COMPLETION REPORT

TYPE OF DRILLING OPERATION

☒ STRAIGHT HOLE ☐ DIRECTIONAL HOLE ☐ HORIZONTAL HOLE
☒ SERVICE WELL

If directional or horizontal, see reverse for bottom hole location.

COUNTY Kingfisher SEC 9 TWP 18N RGE 5W
LEASE NAME JiCo - Harris
NE 1/4 SE 1/4 1/4 1/4 FSL OF 1/4 SEC 1980
WELL NO. 1 FWL OF 1/4 SEC 1980

SPUD DATE 2-5-1980

DRIG FINISHED DATE 2-21-1980

DATE OF WELL COMPLETION 4-15-1980

1st PROD DATE 4-15-1980

RECOMP DATE

ELEVATION Derrick FL 1131 Ground 1124

Latitude (if known)

Longitude (if known)

OPERATOR NAME Pearl Oil Company

OTC/OCC OPERATOR NO. 18493

ADDRESS 1506 Buttram Road

CITY Nichols Hills

STATE OK

ZIP 73120

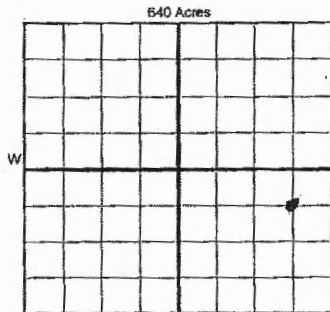

COMPLETION TYPE

☐ SINGLE ZONE
☐ MULTIPLE ZONE
☒ COMMINGLED
LOCATION
EXCEPTION ORDER
INCREASED DENSITY
ORDER NO.

CASING & CEMENT (Form 1002C must be attached)

TYPE	SIZE	WEIGHT	GRADE	FEET	PSI	SAX	TOP OF CMT
CONDUCTOR	26"			50			surface
SURFACE	8 5/8	23#	J	620	1000	500	surface
INTERMEDIATE							
PRODUCTION	4 1/2	Misc	K	7100		450	
LINER							
						TOTAL DEPTH	7116

PACKER @ 6850 BRAND & TYPE Pengo

PLUG @ TYPE PLUG @ TYPE

PACKER @ BRAND & TYPE

PLUG @ TYPE PLUG @ TYPE

COMPLETION & TEST DATA BY PRODUCING FORMATION

FORMATION	Viola	Mississippi	Oswego
SPACING & SPACING ORDER NUMBER			
CLASS: Oil, Gas, Dry, Inj, Disp, Comm Disp, Svc	Oil TA	Oil TA	Oil TA
PERFORATED INTERVALS	6946/68	6254/6716	5981/88
ACID/VOLUME	44 shots	88 shots	21 shots
FRACTURE TREATMENT (Fluids/Prop Amounts)			

Min Gas Allowable (165:10-17-7)

Gas Purchaser/Measurer



OR

First Sales Date

INITIAL TEST DATA

Oil Allowable (165:10-13-3)

INITIAL TEST DATE	5-2-1980
OIL-BBL/DAY	60
OIL-GRAVITY (API)	40.0
GAS-MCF/DAY	150
GAS-OIL RATIO CU FT/BBL	
WATER-BBL/DAY	Frac water
PUMPING OR FLOWING	Flowing
INITIAL SHUT-IN PRESSURE	
CHOKE SIZE	18/64
FLOW TUBING PRESSURE	200 psi

A record of the formations drilled through, and pertinent remarks are presented on the reverse. I declare that I have knowledge of the contents of this report and am authorized by my organization to make this report, which was prepared by me or under my supervision and direction, with the data and facts stated herein to be true, correct, and complete to the best of my knowledge and belief.

SIGNATURE E. W. Jiles NAME (PRINT OR TYPE)
1506 Buttram Road, Nichols Hills, OK 73120 DATE 3-7-2018 PHONE NUMBER
ADDRESS CITY STATE ZIP EMAIL ADDRESS ewjiles@aol.com

AS SUBMITTED

PLEASE TYPE OR USE BLACK INK ONLY

FORMATION RECORD

Give formation names and tops, if available, or descriptions and thickness of formations drilled through. Show intervals cored or drillstem tested.

NAMES OF FORMATIONS	TOP
Layton Sand	5273
Big Lime Oswego	5850
Lower Oswego	5980
Mississippi	6250
Woodford	6732
Viola	6886

Electric logs: FIL, FDC,
GR/Cal
by Schlumberger 2-21-1980

LEASE NAME JiCo-Harris

WELL NO. 1

FOR COMMISSION USE ONLY	
ITD on file <input type="checkbox"/> YES <input type="checkbox"/> NO	
APPROVED <input type="checkbox"/> DISAPPROVED <input type="checkbox"/>	2) Reject Codes

Were open hole logs run?	<input checked="" type="checkbox"/> yes <input type="checkbox"/> no
Date Last log was run	<u>2-21-1980</u>
Was CO ₂ encountered?	<input type="checkbox"/> yes <input checked="" type="checkbox"/> no at what depths?
Was H ₂ S encountered?	<input type="checkbox"/> yes <input checked="" type="checkbox"/> no at what depths?
Were unusual drilling circumstances encountered?	<input type="checkbox"/> yes <input checked="" type="checkbox"/> no
If yes, briefly explain below	

Other remarks:

640 Acres

If more than three drainholes are proposed, attach a separate sheet indicating the necessary information.

Direction must be stated in degrees azimuth.
Please note, the horizontal drainhole and its end point must be located within the boundaries of the lease or spacing unit.

Directional surveys are required for all drainholes and directional wells.

640 Acres

BOTTOM HOLE LOCATION FOR DIRECTIONAL HOLE

SEC	TWP	RGE	COUNTY
Spot Location			
1/4	1/4	1/4	1/4
Measured Total Depth		True Vertical Depth	BHL From Lease, Unit, or Property Line:

BOTTOM HOLE LOCATION FOR HORIZONTAL HOLE: (LATERALS)

LATERAL #1			
SEC	TWP	RGE	COUNTY
Spot Location			
1/4	1/4	1/4	1/4
Depth of Deviation		Radius of Turn	Direction
Measured Total Depth		True Vertical Depth	Total Length
			BHL From Lease, Unit, or Property Line:

LATERAL #2			
SEC	TWP	RGE	COUNTY
Spot Location			
1/4	1/4	1/4	1/4
Depth of Deviation		Radius of Turn	Direction
Measured Total Depth		True Vertical Depth	Total Length
			BHL From Lease, Unit, or Property Line:

LATERAL #3			
SEC	TWP	RGE	COUNTY
Spot Location			
1/4	1/4	1/4	1/4
Depth of Deviation		Radius of Turn	Direction
Measured Total Depth		True Vertical Depth	Total Length
			BHL From Lease, Unit, or Property Line: