

Oklahoma Corporation Commission
Oil & Gas Conservation Division
Post Office Box 52000
Oklahoma City, Oklahoma 73152-2000
Rule 165: 10-3-25

Form 1002A

API No.: 35019254070001

Completion Report

Spud Date: July 16, 2010

OTC Prod. Unit No.: 019-028554

Drilling Finished Date: July 17, 2010

Amended

1st Prod Date: September 09, 2010

Amend Reason: CONVERT TO INJECTOR

Completion Date: September 08, 2010

Recomplete Date: June 11, 2018

Drill Type: STRAIGHT HOLE

SERVICE WELL

Well Name: BRADY 78

Purchaser/Measurer:

Location: CARTER 5 2S 2W
SE SW NW NE
1515 FSL 495 FWL of 1/4 SEC
Derrick Elevation: 1057 Ground Elevation: 1050

First Sales Date:

Operator: KODIAK OIL & GAS INC 23226

204 N WALNUT ST
MUNSTER, TX 76252-2766

Completion Type		Location Exception		Increased Density	
X	Single Zone	Order No		Order No	
	Multiple Zone	There are no Location Exception records to display.		There are no Increased Density records to display.	
	Commingled				

Casing and Cement							
Type	Size	Weight	Grade	Feet	PSI	SAX	Top of CMT
PRODUCTION	5 1/2			1995		350	SURFACE

Liner								
Type	Size	Weight	Grade	Length	PSI	SAX	Top Depth	Bottom Depth
There are no Liner records to display.								

Total Depth: 2000

Packer		Plug	
Depth	Brand & Type	Depth	Plug Type
1700	ARROW TENSION	1995	PBTD

Initial Test Data										
Test Date	Formation	Oil BBL/Day	Oil-Gravity (API)	Gas MCF/Day	Gas-Oil Ratio Cu FT/BBL	Water BBL/Day	Pumpin or Flowing	Initial Shut-In Pressure	Choke Size	Flow Tubing Pressure
There are no Initial Data records to display.										

Completion and Test Data by Producing Formation			
Formation Name: DEESE		Code: 404DEESS	Class: INJ
Spacing Orders		Perforated Intervals	
Order No	Unit Size	From	To
UNSPACED		1750	1784
Acid Volumes		Fracture Treatments	
There are no Acid Volume records to display.		There are no Fracture Treatments records to display.	

Formation	Top
SEE ORIGINAL	0

Were open hole logs run? Yes
Date last log run: July 17, 2010

Were unusual drilling circumstances encountered? No
Explanation:

Other Remarks
BRADY 78 IS NOW PART OF THE WILDCAT JIM BRAKERS UNIT (664581). PERMIT NUMBER 1812580013

FOR COMMISSION USE ONLY	
Status: Accepted	1140220

RECEIVED

Form 1002A
Rev. 2009

JUN 19 2018

OKLAHOMA CORPORATION COMMISSION

API NO. 019-25407
OTC PROD. 019
UNIT NO. 028554

PLEASE TYPE OR USE BLACK INK ONLY
NOTE:

Attach copy of original 1002A
if recompletion or reentry.

OKLAHOMA CORPORATION COMMISSION
Oil & Gas Conservation Division
Post Office Box 52000
Oklahoma City, Oklahoma 73152-2000
Rule 165:10-3-25

☒ ORIGINAL
☐ AMENDED (Reason)

CONVERT TO INJECTOR

COMPLETION REPORT

TYPE OF DRILLING OPERATION

☒ STRAIGHT HOLE ☐ DIRECTIONAL HOLE ☐ HORIZONTAL HOLE
☒ SERVICE WELL

If directional or horizontal, see reverse for bottom hole location.

COUNTY CARTER SEC 5 TWP 25 RGE 2W
LEASE NAME BRADY WELL NO. 78
DATE OF WELL COMPLETION 9/8/10
1st PROD DATE 9/9/10
RECOMP DATE 6/11/18
FSL OF 1/4 SEC 1515 FWL OF 1/4 SEC 495
ELEVATION 1057 Ground 1050 Latitude (if known)
Longitude (if known)
OPERATOR NAME KODIAK OIL & GAS, INC. OTC/OCC OPERATOR NO. 23226-0
ADDRESS 204 N. WALNUT ST.
CITY MUNSTER STATE TX ZIP 76252

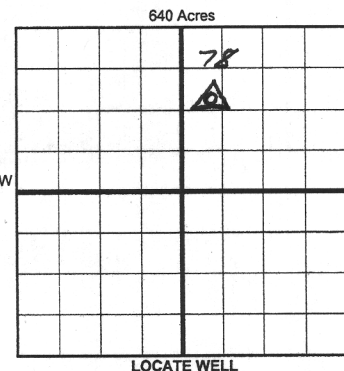

COMPLETION TYPE

☒ SINGLE ZONE
☐ MULTIPLE ZONE
Application Date
☐ COMMINGLED
Application Date
LOCATION
EXCEPTION ORDER
INCREASED DENSITY
ORDER NO.

CASING & CEMENT (Form 1002C must be attached)

TYPE	SIZE	WEIGHT	GRADE	FEET	PSI	SAX	TOP OF CMT
CONDUCTOR							
SURFACE							
INTERMEDIATE							
PRODUCTION	<u>5 1/2</u>			<u>1995</u>		<u>350</u>	<u>SURF</u>
LINER							

PACKER @ 1700 BRAND & TYPE ARROW TENSION PLUG @ 1995 TYPE PBTD PLUG @ TYPE
PACKER @ BRAND & TYPE PLUG @ TYPE PLUG @ TYPE
TOTAL DEPTH 2,000
PBTD 1995

COMPLETION & TEST DATA BY PRODUCING FORMATION

FORMATION	<u>DEESE</u>						
SPACING & SPACING ORDER NUMBER	<u>UNSPACED</u>						
CLASS: Oil, Gas, Dry, Inj, Disp, Comm Disp, Svc	<u>INT</u>						
PERFORATED INTERVALS	<u>1750-84</u>						
ACID/VOLUME							
FRACTURE TREATMENT (Fluids/Prop Amounts)							

Min Gas Allowable (165:10-17-7)

Gas Purchaser/Measurer



OR

First Sales Date

Oil Allowable (165:10-13-3)

INITIAL TEST DATA

INITIAL TEST DATE							
OIL-BBL/DAY							
OIL-GRAVITY (API)							
GAS-MCF/DAY							
GAS-OIL RATIO CU FT/BBL							
WATER-BBL/DAY							
PUMPING OR FLOWING							
INITIAL SHUT-IN PRESSURE							
CHOKE SIZE							
FLOW TUBING PRESSURE							

AS SUBMITTED

A record of the formations drilled through, and pertinent remarks are presented on the reverse. I declare that I have knowledge of the contents of this report and am authorized by my organization to make this report, which was prepared by me or under my supervision and direction, with the data and facts stated herein to be true, correct, and complete to the best of my knowledge and belief.

SIGNATURE JOHN R. LAWS NAME (PRINT OR TYPE)
DATE 6/11/18 PHONE NUMBER 220-8455
ADDRESS 1515 WARDOR, ARDMORE, OK. 73401 EMAIL ADDRESS JRLAWS@HOTMAIL.COM

PLEASE TYPE OR USE BLACK INK ONLY
FORMATION RECORD

Give formation names and tops, if available, or descriptions and thickness of formations drilled through. Show intervals cored or drillstem tested.

NAMES OF FORMATIONS	TOP
SEE ORIGINAL	

LEASE NAME BRADY WELL NO. 78

FOR COMMISSION USE ONLY	
ITD on file <input type="checkbox"/> YES <input type="checkbox"/> NO	
APPROVED _____ DISAPPROVED _____	2) Reject Codes

Were open hole logs run?	<input checked="" type="checkbox"/> yes <input type="checkbox"/> no
Date Last log was run	<u>7/17/10</u>
Was CO ₂ encountered?	<input type="checkbox"/> yes <input checked="" type="checkbox"/> no at what depths? _____
Was H ₂ S encountered?	<input type="checkbox"/> yes <input checked="" type="checkbox"/> no at what depths? _____
Were unusual drilling circumstances encountered?	<input type="checkbox"/> yes <input checked="" type="checkbox"/> no
If yes, briefly explain below	

Other remarks: BRADY # 78 IS NOW PART OF THE WILDCAT
JIM BRAKERS UNIT (664581) PERMIT 1812580013

640 Acres

If more than three drainholes are proposed, attach a separate sheet indicating the necessary information.

Direction must be stated in degrees azimuth.
Please note, the horizontal drainhole and its end point must be located within the boundaries of the lease or spacing unit.

Directional surveys are required for all drainholes and directional wells.

640 Acres

BOTTOM HOLE LOCATION FOR DIRECTIONAL HOLE

SEC	TWP	RGE	COUNTY
Spot Location			
1/4	1/4	1/4	1/4
Measured Total Depth		True Vertical Depth	Feet From 1/4 Sec Lines FSL FWL
BHL From Lease, Unit, or Property Line:			

BOTTOM HOLE LOCATION FOR HORIZONTAL HOLE: (LATERALS)

LATERAL #1

SEC	TWP	RGE	COUNTY
Spot Location			
1/4	1/4	1/4	1/4
Depth of Deviation		Radius of Turn	Direction
Measured Total Depth		True Vertical Depth	Total Length
BHL From Lease, Unit, or Property Line:			

LATERAL #2

SEC	TWP	RGE	COUNTY
Spot Location			
1/4	1/4	1/4	1/4
Depth of Deviation		Radius of Turn	Direction
Measured Total Depth		True Vertical Depth	Total Length
BHL From Lease, Unit, or Property Line:			

LATERAL #3

SEC	TWP	RGE	COUNTY
Spot Location			
1/4	1/4	1/4	1/4
Depth of Deviation		Radius of Turn	Direction
Measured Total Depth		True Vertical Depth	Total Length
BHL From Lease, Unit, or Property Line:			