

Oklahoma Corporation Commission
Oil & Gas Conservation Division
Post Office Box 52000
Oklahoma City, Oklahoma 73152-2000
Rule 165: 10-3-25

Form 1002A

API No.: 35073000840001

Completion Report

Spud Date: August 21, 1960

OTC Prod. Unit No.:

Drilling Finished Date: September 30, 1960

Amended

1st Prod Date: October 24, 1960

Amend Reason: SHOW MISSISSIPPI PLUGGED OFF 7/21/2018 / SHOW OSWEGO
RECOMPLETED 9/26/2000

Completion Date: November 22, 1960

Recomplete Date: July 21, 2018

Drill Type: STRAIGHT HOLE

Well Name: LINCOLN NORTH UNIT (BROWN 1) 18-1

Purchaser/Measurer:

Location: KINGFISHER 30 18N 5W
E2 W2 SE SW
660 FSL 1862 FWL of 1/4 SEC
Derrick Elevation: 0 Ground Elevation: 1180

First Sales Date:

Operator: HINKLE OIL & GAS INC 21639

5600 N MAY AVE STE 295
OKLAHOMA CITY, OK 73112-4275

Completion Type		Location Exception		Increased Density	
X	Single Zone	Order No		Order No	
	Multiple Zone	There are no Location Exception records to display.		There are no Increased Density records to display.	
	Commingled				

Casing and Cement							
Type	Size	Weight	Grade	Feet	PSI	SAX	Top of CMT
SURFACE	9 5/8	25.4		400		400	SURFACE
PRODUCTION	5 1/2	15.5	J-55	6696		165	5720

Liner								
Type	Size	Weight	Grade	Length	PSI	SAX	Top Depth	Bottom Depth
There are no Liner records to display.								

Total Depth: 6758

Packer		Plug	
Depth	Brand & Type	Depth	Plug Type
There are no Packer records to display.		6500	CIBP

Initial Test Data										
Test Date	Formation	Oil BBL/Day	Oil-Gravity (API)	Gas MCF/Day	Gas-Oil Ratio Cu FT/BBL	Water BBL/Day	Pumpin or Flowing	Initial Shut-In Pressure	Choke Size	Flow Tubing Pressure
Jul 22, 2018	OSWEGO	2	42.5	5	2500		PUMPING			

Completion and Test Data by Producing Formation

Formation Name: OSWEGO

Code: 404OSWG

Class: OIL

Spacing Orders

Order No	Unit Size
119269	UNIT

Perforated Intervals

From	To
6289	6308

Acid Volumes

There are no Acid Volume records to display.

Fracture Treatments

There are no Fracture Treatments records to display.

Formation	Top
SHALE - RED BEDS	46
SHALE	920
SHALE - SAND	1658
SHALE	1904
SHALE - SANDY LIME	2593
SHALE	2713
SHALE - SAND	2896
SHALE - LIME	3255
SAND - SHALE	3444
LIME - SHALE	3652
SAND - SHALE	4828
SHALE	6288
LIME - SHALE	6338
SHALE - LIME	6688

Were open hole logs run? No

Date last log run:

Were unusual drilling circumstances encountered? No

Explanation:

Other Remarks

OCC - WELL NAME FORMERLY BROWN 1. PER EARLIER DOCUMENT, LAST 100' OF HOLE WAS DRILLED AT 90 DEGREES TO THE NORTH. THIS WELL WAS RE-PERFORATED IN THE OSWEGO SEPTEMBER 26, 2000, PER LAURA HINKLE. OPERATOR WAS REQUIRED TO FILE PERMIT FOR RECOMPLETION AFTER THAT FACT, AND WILL BE WARNED RECOMPLETING WITHOUT A PERMIT.

FOR COMMISSION USE ONLY

1139933

Status: Accepted

API NO. 073-00084
OTC PROD. UNIT NO. 1602

PLEASE TYPE OR USE BLACK INK ONLY
NOTE:

Attach copy of original 1002A
if recompletion or reentry.

OKLAHOMA CORPORATION COMMISSION
Oil & Gas Conservation Division
Post Office Box 52000
Oklahoma City, Oklahoma 73152-2000
Rule 165:10-3-25

RECEIVED

JUL 23 2018

Form 1002A
Rev. 2009

OKLAHOMA CORPORATION
COMMISSION

☐ ORIGINAL
☒ AMENDED (Reason)

Plug off Mississippi

COMPLETION REPORT

TYPE OF DRILLING OPERATION
☒ STRAIGHT HOLE ☐ DIRECTIONAL HOLE ☐ HORIZONTAL HOLE
☐ SERVICE WELL

If directional or horizontal, see reverse for bottom hole location.

COUNTY Kingfisher SEC 30 TWP 18N RGE 05W
LEASE NAME Lincoln North Unit WELL NO. 18-1
ELEVATION N Derrick Ground 1180' FSL OF 1/4 SEC 660' DATE OF WELL COMPLETION 11/22/1960
OPERATOR NAME Hinkle Oil & Gas, Inc. 1st PROD DATE 10/24/1960
ADDRESS 5600 N. May Avenue, Suite 295 RECOMP DATE 7/21/2018
CITY Oklahoma City STATE OK ZIP 73112

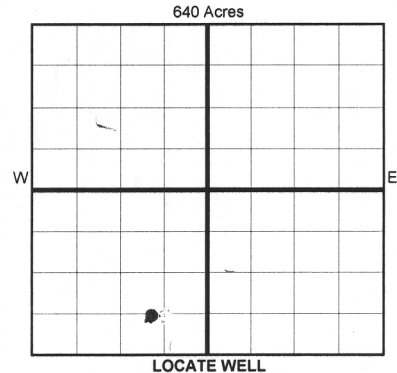

COMPLETION TYPE

☒ SINGLE ZONE
☐ MULTIPLE ZONE
Application Date
☐ COMMINGLED
Application Date
LOCATION
EXCEPTION ORDER
INCREASED DENSITY
ORDER NO.

CASING & CEMENT (Form 1002C must be attached)

TYPE	SIZE	WEIGHT	GRADE	FEET	PSI	SAX	TOP OF CMT
CONDUCTOR							
SURFACE	9 5/8"	25.4		400'		400	Surface
INTERMEDIATE							
PRODUCTION	5 1/2"	15.5	J-55	6696'		165	5720'
LINER							

PACKER @ BRAND & TYPE PLUG @ 6500' TYPE CIBP PLUG @ TYPE
PACKER @ BRAND & TYPE PLUG @ TYPE PLUG @ TYPE

TOTAL DEPTH 6758'

COMPLETION & TEST DATA BY PRODUCING FORMATION

FORMATION	Oswego						
SPACING & SPACING ORDER NUMBER	119269 (unit)						
CLASS: Oil, Gas, Dry, Inj, Disp, Comm Disp, Svc	Oil						
PERFORATED INTERVALS	6289'-93', 6300'-08', 6315'-25', 6334'-38' (4 spf)						
ACID/VOLUME							
FRACTURE TREATMENT (Fluids/Prop Amounts)							

Min Gas Allowable (165:10-17-7)



OR

Oil Allowable (165:10-13-3)

Gas Purchaser/Measurer

First Sales Date

INITIAL TEST DATA

INITIAL TEST DATE	7-22-2018						
OIL-BBL/DAY	2						
OIL-GRAVITY (API)	42.5						
GAS-MCF/DAY	5						
GAS-OIL RATIO CU FT/BBL	2500						
WATER-BBL/DAY	pumping						
PUMPING OR FLOWING							
INITIAL SHUT-IN PRESSURE							
CHOKE SIZE							
FLOW TUBING PRESSURE							

AS SUBMITTED

A record of the formations drilled through, and pertinent remarks are presented on the reverse. I declare that I have knowledge of the contents of this report and am authorized by my organization to make this report, which was prepared by me or under my supervision and direction, with the data and facts stated herein to be true, correct, and complete to the best of my knowledge and belief.

SIGNATURE: B. Hinkle NAME (PRINT OR TYPE): Bruce A. Hinkle DATE: 7/23/2018 PHONE NUMBER: 405-848-0924
ADDRESS: 5600 N. May Avenue, Suite 295 CITY: Oklahoma City STATE: OK ZIP: 73112 EMAIL ADDRESS: Laurahinkle@hoagi.com

Give formation names and tops, if available, or descriptions and thickness of formations drilled through. Show intervals cored or drillstem tested.

FOR COMMISSION USE ONLY	
ITD on file	<input type="checkbox"/> YES <input type="checkbox"/> NO
APPROVED	DISAPPROVED
2) Reject Codes _____ _____ _____ _____ _____	

Were open hole logs run? ___ yes X no
Date Last log was run N/A
Was CO₂ encountered? ___ yes X no at what depths? _____
Was H₂S encountered? ___ yes X no at what depths? _____
Were unusual drilling circumstances encountered? ___ yes X no
If yes, briefly explain below

Other remarks: PLUG OFF MISSISSIPPI, OCC - Per earlier document last 100' of hole was drilled at 90° to the North. Formerly Brown 1
OCC - This well was re-perforated in the Oswego 9-26-2000 per Laura Hinkle operator was required to ~~re~~ file permit for recompletion after that fact ~~and~~ and will be warned recompleting without a permit.

640 Acres

A blank 10x10 grid for graphing, consisting of 10 columns and 10 rows of squares. The grid is used for plotting the graph of the function $y = \frac{1}{2}x^2$.

If more than three drainholes are proposed, attach a separate sheet indicating the necessary information.

Direction must be stated in degrees azimuth.
Please note, the horizontal drainhole and its end point must be located within the boundaries of the lease or spacing unit.

Directional surveys are required for all drainholes and directional wells.

640 Acres

BOTTOM HOLE LOCATION FOR DIRECTIONAL HOLE

SEC	TWP	RGE	COUNTY			
Spot Location				Feet From 1/4 Sec Lines	FSL	FWL
1/4	1/4	1/4	1/4	BHL From Lease, Unit, or Property Line:		
Measured Total Depth		True Vertical Depth				

BOTTOM HOLE LOCATION FOR HORIZONTAL HOLE: (LATERALS)

LATERAL #1

LATERAL #1						
SEC	TWP	RGE	COUNTY			
Spot Location				Feet From 1/4 Sec Lines	FNL	FEL
1/4		1/4	1/4			
Depth of Deviation		Radius of Turn		Direction	Total Length	
Measured Total Depth		True Vertical Depth	BHL From Lease, Unit, or Property Line:			

LATERAL #2

LATERAL #2					
SEC	TWP	RGE	COUNTY		
Spot Location			Feet From 1/4 Sec Lines	FSL	FWL
1/4	1/4	1/4	1/4		
Depth of Deviation		Radius of Turn	Direction	Total Length	
Measured Total Depth		True Vertical Depth	BHL From Lease, Unit, or Property Line:		

LATERAL #3

LATERAL #3						
SEC	TWP	RGE	COUNTY			
Spot Location				Feet From 1/4 Sec Lines	FSL	FWL
1/4	1/4	1/4				
Depth of Deviation		Radius of Turn	Direction		Total Length	
Measured Total Depth		True Vertical Depth	BHL From Lease, Unit, or Property Line:			