

Oklahoma Corporation Commission  
Oil & Gas Conservation Division  
Post Office Box 52000  
Oklahoma City, Oklahoma 73152-2000  
Rule 165: 10-3-25

Form 1002A

API No.: 35045236970000

**Completion Report**

Spud Date: October 22, 2017

OTC Prod. Unit No.: 045-223053

Drilling Finished Date: December 10, 2017

1st Prod Date: February 11, 2018

Completion Date: January 21, 2018

**Drill Type:** HORIZONTAL HOLE

Min Gas Allowable: Yes

Well Name: TERRY 14-11 1H

Purchaser/Measurer: MARKWEST

Location: ELLIS 14 18N 23W  
SE SE SW SW  
250 FSL 1110 FWL of 1/4 SEC  
Latitude: 36.0288 Longitude: -99.6271  
Derrick Elevation: 2273 Ground Elevation: 2246

First Sales Date: 02/11/2018

Operator: VALPOINT OPERATING LLC 23241

600 S TYLER ST STE 1701  
AMARILLO, TX 79101-2353

Completion Type		Location Exception		Increased Density	
X	Single Zone	Order No		Order No	
	Multiple Zone	There are no Location Exception records to display.		There are no Increased Density records to display.	
	Commingled				

Casing and Cement							
Type	Size	Weight	Grade	Feet	PSI	SAX	Top of CMT
CONDUCTOR	20	54	H-40	120			SURFACE
SURFACE	13 3/8	54.5	J-55	1536		1010	SURFACE
INTERMEDIATE	9 5/8	40	HCL-80	9489		860	5727
INTERMEDIATE	7	29	P-110	9842		495	6832
PRODUCTION	5 1/2	20	P-110	18758		870	2909

Liner								
Type	Size	Weight	Grade	Length	PSI	SAX	Top Depth	Bottom Depth
There are no Liner records to display.								

**Total Depth: 18758**

Packer	
Depth	Brand & Type
There are no Packer records to display.	

Plug	
Depth	Plug Type
There are no Plug records to display.	

Initial Test Data										
Test Date	Formation	Oil BBL/Day	Oil-Gravity (API)	Gas MCF/Day	Gas-Oil Ratio Cu FT/BBL	Water BBL/Day	Pumpin or Flowing	Initial Shut-In Pressure	Choke Size	Flow Tubing Pressure
Feb 13, 2018	OSWEGO	743	42	1356	1825	2838	FLOWING	2000	40	820

Completion and Test Data by Producing Formation									
Formation Name: OSWEGO				Code: 404OSWG			Class: OIL		
Spacing Orders				Perforated Intervals					
Order No		Unit Size		From			To		
670973		1280		9880			18161		
Acid Volumes				Fracture Treatments					
160,860 GALLONS 15% HCL				11,159,736 GALLONS, 881,957 POUNDS 100 MESH SAND, 2,622,581 POUNDS 40/70 SAND					

Formation	Top
DOUGLAS	7284
TONKAWA	7818
COTTAGE GROVE	8379
CLEVELAND	8933
BIG LIME	9291
OSWEGO	9396

Were open hole logs run? Yes

Date last log run:

Were unusual drilling circumstances encountered? Yes

Explanation: OCC - OPERATOR LOST HOLE AT 9531'.  
SIDE TRACK STARTED AT 9303'.

Other Remarks
7" CASING IS 2ND INTERMEDIATE STRING - 6,472' - 9,842' MD. PRODUCTION CASING - 5-1/2" 20# @ 9,473' AND 4-1/2" 9,473' - 18,754' MD. FRAC COMPLETED ON FEBRUARY 1, 2018. STARTED THROUGH PRODUCTION EQUIPMENT AND FIRST SALES ON FEBRUARY 11, 2018 @ 8:30 PM. OCC - THIS WELL IS SPACED ON A 1280 ACRE UNIT COMPRISING OF SECTION 11 & 14 OF 18N-23W. THE WELL IS AT A LEGAL DISTANCE TO WHAT THE SPACING ORDER ALLOWS.

Lateral Holes
Sec: 11 TWP: 18N RGE: 23W County: ELLIS
NE SE NW NW
1770 FSL 1113 FWL of 1/4 SEC
Depth of Deviation: 8883 Radius of Turn: 1156 Direction: 6 Total Length: 8719
Measured Total Depth: 18758 True Vertical Depth: 9404 End Pt. Location From Release, Unit or Property Line: 870

FOR COMMISSION USE ONLY
Status: Accepted
1139083

API NO. 35-045-23697  
OTC PROD. UNIT NO. 045-223053

PLEASE TYPE OR USE BLACK INK ONLY  
NOTE:

Attach copy of original 1002A  
if recompletion or reentry.

OKLAHOMA CORPORATION COMMISSION  
Oil & Gas Conservation Division  
Post Office Box 52000  
Oklahoma City, Oklahoma 73152-2000  
Rule 165:10-3-25

RECEIVED

MAR 19 2018

OKLAHOMA CORPORATION  
COMMISSION

Form 1002A  
Rev. 2009

☒ ORIGINAL  
☐ AMENDED (Reason)

COMPLETION REPORT

TYPE OF DRILLING OPERATION

☐ STRAIGHT HOLE ☐ DIRECTIONAL HOLE ☒ HORIZONTAL HOLE

If directional or horizontal, see reverse for bottom hole location.

COUNTY	Ellis	SEC	14	TWP	18N	RGE	23W	SPUD DATE	10/23/2017
LEASE NAME	Terry			WELL NO.	14-11 1			DRLG FINISHED DATE	12/10/2017
SE 1/4 SE 1/4 SW 1/4 SW 1/4	FSL OF 1/4 SEC 250'			FWL OF 1/4 SEC	1110'			DATE OF WELL COMPLETION	1/21/2018
ELEVATION DEMON FL	2,273'	Ground	2,246'	Latitude (if known)	36.02880			1st PROD DATE	2/11/2018
OPERATOR NAME	VALPOINT OPERATING, LLC			OTC/OCC OPERATOR NO.	23241				
ADDRESS	600 S. Tyler St, Suite 1701								
CITY	Amarillo			STATE	Texas		ZIP	79101	

640 Acres									
14									
LOCATE WELL									

COMPLETION TYPE

<input checked="" type="checkbox"/> SINGLE ZONE
<input type="checkbox"/> MULTIPLE ZONE
<input type="checkbox"/> COMMINGLED
<input type="checkbox"/> LOCATION EXCEPTION
ORDER NO.
INCREASED DENSITY
ORDER NO.

CASING & CEMENT (Form 1002C must be attached)

TYPE	SIZE	WEIGHT	GRADE	FEET	PSI	SAX	TOP OF CMT
CONDUCTOR	20"	54#	H-40	120'			Surface
SURFACE	13-3/8"	54.5#	J-55	1,536.5'		1,010	Surface
INTERMEDIATE	9-5/8"	40#	HCL-80	9,489'		860	5,727'
PRODUCTION	7"	29#	P-110	9,842'		495	6,832'
LINER	5-1/2"	20#	P-110	18,758'		870	2,909'

PACKER @ \_\_\_\_\_ BRAND & TYPE \_\_\_\_\_ PLUG @ \_\_\_\_\_ TYPE \_\_\_\_\_ PLUG @ \_\_\_\_\_ TYPE \_\_\_\_\_  
PACKER @ \_\_\_\_\_ BRAND & TYPE \_\_\_\_\_ PLUG @ \_\_\_\_\_ TYPE \_\_\_\_\_ PLUG @ \_\_\_\_\_ TYPE \_\_\_\_\_

TOTAL DEPTH 18758

Per 1002C

Sidetrack 1

COMPLETION & TEST DATA BY PRODUCING FORMATION

FORMATION	Oswego	4040 SWG					
SPACING & SPACING ORDER NUMBER	201706295 (1280 ac)	670973					Reported to Frac Focus
CLASS: Oil, Gas, Dry, Inj, Disp, Comm Disp, Svc	Oil						
PERFORATED INTERVALS	Last: 18,161' MD						
	First: 9,880' MD						
ACID/VOLUME	160,860 gals	15% HCL					
FRACTURE TREATMENT (Fluids/Prop Amounts)	11,159,736 gals						
	881,957 # 100 Mesh	Sand					
	2,622,581 # 40/70	Sand					

☒ Min Gas Allowable (165:10-17-7)  
OR  
☐ Oil Allowable (165:10-13-3)

Gas Purchaser/Measurer  
First Sales Date

Markwest  
2/11/2018

INITIAL TEST DATA

INITIAL TEST DATE	2/13/2018						
OIL-BBL/DAY	743						
OIL-GRAVITY ( API)	42						
GAS-MCF/DAY	1,356						
GAS-OIL RATIO CU FT/BBL	1,825						
WATER-BBL/DAY	2,838						
PUMPING OR FLOWING	Flowing						
INITIAL SHUT-IN PRESSURE	2000						
CHOKE SIZE	40						
FLOW TUBING PRESSURE	820						

AS SUBMITTED

A record of the formations drilled through, and pertinent remarks are presented on the reverse. I declare that I have knowledge of the contents of this report and am authorized by my organization to make this report, which was prepared by me or under my supervision and direction, with the data and facts stated herein to be true, correct, and complete to the best of my knowledge and belief.

<u>Matt Ramsden</u> SIGNATURE	Matt Ramsden NAME (PRINT OR TYPE)	2/27/2018 DATE	806-376-4675 PHONE NUMBER
600 S. Tyler St, Suite 1701 ADDRESS	Amarillo TX 79101 CITY STATE ZIP	matt@valpointoperating.com EMAIL ADDRESS	

PLEASE TYPE OR USE BLACK INK ONLY  
FORMATION RECORD

Give formation names and tops, if available, or descriptions and thickness of formations drilled through. Show intervals cored or drillstem tested.

LEASE NAME \_\_\_\_\_

WELL NO. \_\_\_\_\_

NAMES OF FORMATIONS	TOP
Douglas	7284' (-5011')
Tonkawa	7818' (-5539')
Cottage Grove	8379' (-6106')
Cleveland	8933' (-6659')
Big Lime	9291' (-7018')
Oswego	9396' (-7123')

FOR COMMISSION USE ONLY	
ITD on file <input type="checkbox"/> YES <input type="checkbox"/> NO	
APPROVED _____	DISAPPROVED _____
2) Reject Codes	
_____	
_____	
_____	
_____	

Were open hole logs run?	<input checked="" type="checkbox"/> yes <input type="checkbox"/> no
Date Last log was run	12/7/2018
Was CO <sub>2</sub> encountered?	<input type="checkbox"/> yes <input checked="" type="checkbox"/> no at what depths? _____
Was H <sub>2</sub> S encountered?	<input type="checkbox"/> yes <input checked="" type="checkbox"/> no at what depths? _____
Were unusual drilling circumstances encountered? if yes, briefly explain below	<input type="checkbox"/> yes <input checked="" type="checkbox"/> no

Other remarks:

7" casing is 2nd intermediate string - 6,472' - 9,842' MD.

Production Casing - 5-1/2" 20# @ 9,473' and 4-1/2" 9,473'-18,754' MD.

Frac completed on 2/1/2018. Started through production equipment and first sales on 2/11/2018 @8:30 pm.

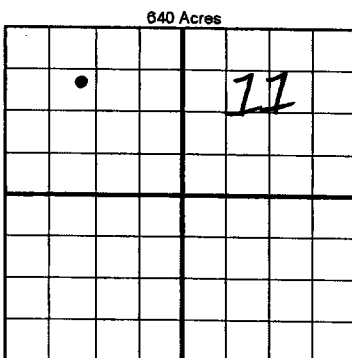

If more than three drainholes are proposed, attach a separate sheet indicating the necessary information.

Direction must be stated in degrees azimuth. Please note, the horizontal drainhole and its end point must be located within the boundaries of the lease or spacing unit.

Directional surveys are required for all drainholes and directional wells.

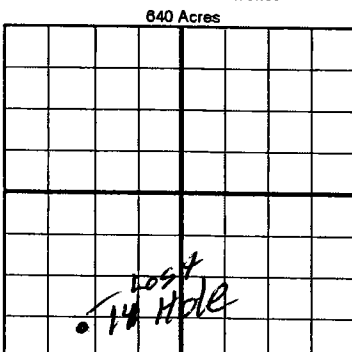

BOTTOM HOLE LOCATION FOR DIRECTIONAL HOLE *Lost Hole (see Surveys)*

SEC 14	TWP 18N	RGE 23W	COUNTY Ellis
Spot Location NE 1/4 SE 1/4 SW 1/4 SW 1/4		Feet From 1/4 Sec Lines	FSL 586 FWL 994
Measured Total Depth 9531		True Vertical Depth 9408	BHL From Lease, Unit, or Property Line: 586

BOTTOM HOLE LOCATION FOR HORIZONTAL HOLE: (LATERALS)

LATERAL #1 <i>Sidetrack #1</i>			
SEC 11	TWP 18N	RGE 23W	COUNTY Ellis
Spot Location NE 1/4 SE 1/4 NW 1/4 NW 1/4		Feet From 1/4 Sec Lines	FSL 1770' FWL 1113'
Depth of Deviation 8,883'		Radius of Turn 1,156'	Direction 6.1 Total Length 8,719'
Measured Total Depth 18,758'		True Vertical Depth 9,404'	BHL From Lease, Unit, or Property Line: 870'

LATERAL #2

SEC 14	TWP 18N	RGE 23W	COUNTY Ellis
Spot Location NE 1/4 SE 1/4 SW 1/4 SW 1/4		Feet From 1/4 Sec Lines	FSL 586 FWL 994
Depth of Deviation		Radius of Turn 123	Direction 4 Total Length
Measured Total Depth 9531		True Vertical Depth 9408	BHL From Lease, Unit, or Property Line: 586

LATERAL #3

SEC	TWP	RGE	COUNTY
Spot Location 1/4 1/4 1/4 1/4		Feet From 1/4 Sec Lines	FSL FWL
Depth of Deviation		Radius of Turn	Direction Total Length
Measured Total Depth		True Vertical Depth	BHL From Lease, Unit, or Property Line: