

Oklahoma Corporation Commission  
Oil & Gas Conservation Division  
Post Office Box 52000  
Oklahoma City, Oklahoma 73152-2000  
Rule 165: 10-3-25

Form 1002A

API No.: 35087203340002

**Completion Report**

Spud Date: October 11, 1976

OTC Prod. Unit No.: 087-050697-0-3375

Drilling Finished Date: October 17, 1976

**Amended**

1st Prod Date: October 19, 1976

Amend Reason: CONVERT TO INJECTOR

Completion Date: October 19, 1976

Recomplete Date: December 15, 2017

**Drill Type: STRAIGHT HOLE**

**SERVICE WELL**

Well Name: ODELL 3

Purchaser/Measurer:

Location: MCCLAIN 25 6N 3E  
C NE SW SE  
990 FSL 990 FWL of 1/4 SEC  
Derrick Elevation: 927 Ground Elevation: 917

First Sales Date:

Operator: OKLAHOMA PRIME ENERGY LLC 23208

301 W MAIN ST STE 430  
ARDMORE, OK 73401-6322

Completion Type		Location Exception		Increased Density	
X	Single Zone	Order No		Order No	
	Multiple Zone	There are no Location Exception records to display.		There are no Increased Density records to display.	
	Commingled				

Casing and Cement							
Type	Size	Weight	Grade	Feet	PSI	SAX	Top of CMT
SURFACE	8 5/8			305		200	SURFACE
PRODUCTION	5 1/2			3350		75	2900

Liner								
Type	Size	Weight	Grade	Length	PSI	SAX	Top Depth	Bottom Depth
LINER	3 1/2			354	0	75	3730	4084

**Total Depth: 4084**

Packer		Plug	
Depth	Brand & Type	Depth	Plug Type
3280	BAKER COMPR	3348	PBTD

Initial Test Data
-------------------

Test Date	Formation	Oil BBL/Day	Oil-Gravity (API)	Gas MCF/Day	Gas-Oil Ratio Cu FT/BBL	Water BBL/Day	Pumpin or Flowing	Initial Shut- In Pressure	Choke Size	Flow Tubing Pressure
-----------	-----------	----------------	----------------------	----------------	----------------------------	------------------	----------------------	---------------------------------	---------------	-------------------------

There are no Initial Data records to display.

Completion and Test Data by Producing Formation

Formation Name: WANETTE                      Code: 404WNTT                      Class: INJ

Spacing Orders		Perforated Intervals	
Order No	Unit Size	From	To
There are no Spacing Order records to display.		3294	3296
Acid Volumes		Fracture Treatments	
500 GALLONS		NONE	

Formation	Top
SEE ORIGINAL	0

Were open hole logs run? Yes  
Date last log run: October 17, 1976  
  
Were unusual drilling circumstances encountered? No  
Explanation:

Other Remarks
CONVERTING PRODUCER TO INJECTOR. PERMIT NUMBER 1806220019

FOR COMMISSION USE ONLY

1139062

Status: Accepted

# RECEIVED

DEC 20 2017

Form 1002A  
Rev. 2009

API NO. **087-20334**  
OTC PROD. UNIT NO. **087**

PLEASE TYPE OR USE BLACK INK ONLY  
NOTE:

Attach copy of original 1002A  
if recompletion or reentry.

OKLAHOMA CORPORATION COMMISSION  
Oil & Gas Conservation Division  
Post Office Box 52000  
Oklahoma City, Oklahoma 73152-2000  
Rule 165-10-3-25

OKLAHOMA CORPORATION  
COMMISSION

ORIGINAL AMENDED (Reason) **050697-0-3375 CONVERT TO INT.**

## COMPLETION REPORT

### TYPE OF DRILLING OPERATION

☒ STRAIGHT HOLE ☐ DIRECTIONAL HOLE ☐ HORIZONTAL HOLE  
☒ SERVICE WELL

If directional or horizontal, see reverse for bottom hole location.

COUNTY **MCCLAIN** SEC **25** TWP **6N** RGE **3E**  
LEASE NAME **O'DELL** WELL NO. **3**  
DIR **1/4 NE 1/4 SW 1/4 SE 1/4** FSL OF 1/4 SEC **990** FWL OF 1/4 SEC **990**  
ELEVATION **927** Ground **917** Latitude (if known) Longitude (if known)  
OPERATOR NAME **OKLAHOMA PRIME ENERGY, LLC** OTC/OCC OPERATOR NO. **23208-0**  
ADDRESS **301 W. MAIN, #430**  
CITY **ARMORE** STATE **OK.** ZIP **73401**

SPUD DATE **10/11/76**  
DRLG FINISHED DATE **10/17/76**  
DATE OF WELL COMPLETION **10/19/76**  
1st PROD DATE **10/19/76**  
RECOMP DATE **12/15/17**

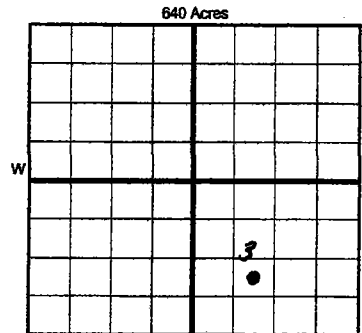

### COMPLETION TYPE

☒ SINGLE ZONE  
☐ MULTIPLE ZONE  
Application Date  
COMINGLED  
Application Date  
LOCATION  
EXCEPTION ORDER  
INCREASED DENSITY  
ORDER NO.

### CASING & CEMENT (Form 1002C must be attached)

TYPE	SIZE	WEIGHT	GRADE	FEET	PSI	SAX	TOP OF CMT
CONDUCTOR							
SURFACE	<b>8 5/8</b>			<b>305</b>		<b>200</b>	<b>SURF</b>
INTERMEDIATE							
PRODUCTION	<b>5 1/2</b>			<b>3350</b>		<b>7.5</b>	<b>2900</b>
LINER	<b>3 1/2</b>			<b>3730-4084</b>		<b>75</b>	

PACKER @ **3280** BRAND & TYPE **BAKER COMP** PLUG @ TYPE PLUG @ TYPE  
PACKER @ BRAND & TYPE PLUG @ TYPE PLUG @ TYPE  
COMPLETION & TEST DATA BY PRODUCING FORMATION **404 VVNTT** TOTAL DEPTH **3350** **4084**  
**PSTD 3348**

FORMATION	<b>WAB NETTE</b>						
SPACING & SPACING ORDER NUMBER							
CLASS: Oil, Gas, Dry, Inj, Disp, Comm Disp, Svc	<b>INT</b>						
PERFORATED INTERVALS	<b>3294-96</b>						
ACID VOLUME	<b>500 GAL.</b>						
FRACTURE TREATMENT (Fluids/Prop Amounts)	<b>NONE</b>						

Min Gas Allowable (165-10-17-7)

Gas Purchaser/Measurer  
First Sales Date

### INITIAL TEST DATA

Oil Allowable (165-10-13-3)

INITIAL TEST DATE	<b>12/5/17</b>						
OIL-BBL/DAY	<b>INT</b>						
OIL-GRAVITY (API)							
GAS-MCF/DAY							
GAS-OIL RATIO CU FT/BBL							
WATER-BBL/DAY							
PUMPING OR FLOWING							
INITIAL SHUT-IN PRESSURE							
CHOKE SIZE							
FLOW TUBING PRESSURE							

**AS SUBMITTED**

A record of the formations drilled through, and pertinent remarks are presented on the reverse. I declare that I have knowledge of the contents of this report and am authorized by my organization to make this report, which was prepared by me or under my supervision and direction, with the data and facts stated herein to be true, correct, and complete to the best of my knowledge and belief.

SIGNATURE **JOHN R. LAWS** NAME (PRINT OR TYPE) **12/15/17 580-220-8455**  
ADDRESS **1515 WARD RD., ARMORE, OK. 73401** CITY STATE ZIP **JRLAWS@HOTMAIL.COM** EMAIL ADDRESS  
DATE PHONE NUMBER

PLEASE TYPE OR USE BLACK INK ONLY

FORMATION RECORD

Give formation names and tops, if available, or descriptions and thickness of formations drilled through. Show intervals cored or drillstem tested.

NAMES OF FORMATIONS	TOP
SEE ORIGINAL	

LEASE NAME

ODELL

WELL NO.

3

FOR COMMISSION USE ONLY

ITD on file ☐ YES ☐ NO

APPROVED

DISAPPROVED

2) Reject Codes

Were open hole logs run?

☒ yes ☐ no

Date Last log was run

10/17/26

Was CO<sub>2</sub> encountered?

☐ yes ☒ no at what depths?

Was H<sub>2</sub>S encountered?

☐ yes ☒ no at what depths?

Were unusual drilling circumstances encountered?

☐ yes ☒ no

If yes, briefly explain below.

Other remarks:

CONVERTING PRODUCER TO INTECTOR PERMIT 1806220019

640 Acres

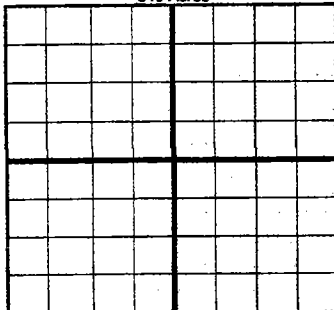

If more than three drainholes are proposed, attach a separate sheet indicating the necessary information.

Direction must be stated in degrees azimuth. Please note, the horizontal drainhole and its end point must be located within the boundaries of the lease or spacing unit.

Directional surveys are required for all drainholes and directional wells.

640 Acres

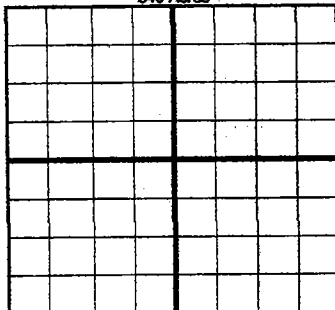

BOTTOM HOLE LOCATION FOR DIRECTIONAL HOLE

SEC	TWP	RGE	COUNTY
Spot Location	1/4	1/4	1/4
Measured Total Depth	True Vertical Depth	Feet From 1/4 Sec Lines	FSL
		BHL From Lease, Unit, or Property Line:	FWL

BOTTOM HOLE LOCATION FOR HORIZONTAL HOLE: (LATERALS)

SEC	TWP	RGE	COUNTY
Spot Location	1/4	1/4	1/4
Depth of Deviation	Radius of Turn	Direction	Total Length
Measured Total Depth	True Vertical Depth	BHL From Lease, Unit, or Property Line:	

SEC	TWP	RGE	COUNTY
Spot Location	1/4	1/4	1/4
Depth of Deviation	Radius of Turn	Direction	Total Length
Measured Total Depth	True Vertical Depth	BHL From Lease, Unit, or Property Line:	

SEC	TWP	RGE	COUNTY
Spot Location	1/4	1/4	1/4
Depth of Deviation	Radius of Turn	Direction	Total Length
Measured Total Depth	True Vertical Depth	BHL From Lease, Unit, or Property Line:	