

Oklahoma Corporation Commission
Oil & Gas Conservation Division
Post Office Box 52000
Oklahoma City, Oklahoma 73152-2000
Rule 165: 10-3-25

Form 1002A

API No.: 35049223030002

Completion Report

Spud Date: October 26, 1983

OTC Prod. Unit No.:

Drilling Finished Date: November 20, 1983

Amended

1st Prod Date: January 05, 1984

Amend Reason: TEMPORARILY ABANDONED

Completion Date: December 31, 1983

Recomplete Date: December 12, 2017

Drill Type: SERVICE WELL

Well Name: GEORGE WASHINGTON 2

Purchaser/Measurer:

Location: GARVIN 36 2N 3W
C NE SE NE
990 FSL 2310 FWL of 1/4 SEC
Derrick Elevation: 1012 Ground Elevation: 0

First Sales Date:

Operator: SPARKS RESOURCES INC 21820
PO BOX 779
24135 S HIGHWAY 48
BRISTOW, OK 74010-0779

Completion Type	
X	Single Zone
	Multiple Zone
	Commingled

Location Exception	
Order No	
There are no Location Exception records to display.	

Increased Density	
Order No	
There are no Increased Density records to display.	

Casing and Cement							
Type	Size	Weight	Grade	Feet	PSI	SAX	Top of CMT
SURFACE	8 5/8	24	K-56	922		500	SURFACE
PRODUCTION	5 1/2	16.5	K-56	7197		250	6090

Liner								
Type	Size	Weight	Grade	Length	PSI	SAX	Top Depth	Bottom Depth
There are no Liner records to display.								

Total Depth: 7212

Packer	
Depth	Brand & Type
There are no Packer records to display.	

Plug	
Depth	Plug Type
2040	CIBP
6967	CIBP

Initial Test Data

Test Date	Formation	Oil BBL/Day	Oil-Gravity (API)	Gas MCF/Day	Gas-Oil Ratio Cu FT/BBL	Water BBL/Day	Pumpin or Flowing	Initial Shut- In Pressure	Choke Size	Flow Tubing Pressure
There are no Initial Data records to display.										

Completion and Test Data by Producing Formation									
Formation Name: PERMIAN				Code: 459PRMN			Class: TA		
Spacing Orders				Perforated Intervals					
Order No		Unit Size		From			To		
There are no Spacing Order records to display.				1292			1372		
Acid Volumes				Fracture Treatments					
There are no Acid Volume records to display.				There are no Fracture Treatments records to display.					

Formation	Top
PERMIAN SANDS	1792
PHARAOH	6995

Were open hole logs run? No
Date last log run:

Were unusual drilling circumstances encountered? No
Explanation:

Other Remarks
There are no Other Remarks.

FOR COMMISSION USE ONLY
<div>Status: Accepted</div> <div>1139107</div>

API NO. 049-22308
OTC PROD. UNIT NO.

PLEASE TYPE OR USE BLACK INK ONLY
NOTE:
Attach copy of original 1002A
if recompletion or reentry.

OKLAHOMA CORPORATION COMMISSION
Oil & Gas Conservation Division
Post Office Box 62000
Oklahoma City, Oklahoma 73152-2000
Rule 105-10-3-25

Form 1002A
Rev. 2008

☐ ORIGINAL
☒ AMENDED (Reason) TIA

TYPE OF DRILLING OPERATION

☒ STRAIGHT HOLE ☐ DIRECTIONAL HOLE ☐ HORIZONTAL HOLE

If directional or horizontal, see reverse for bottom hole location.

COUNTY Garvin SEC 35 T2N R3E

LEASE NAME George Washington WELL NO. 2

C # NE 1/4 SE 1/4 NE 1/4 14 SEC 990 14 SEC 2310

ELEVATION 1012 Ground Latitude (if known)

OPERATOR NAME Sparks Resources, Inc. OTC/OCC OPERATOR NO. 21420

ADDRESS PO Box 779

CITY Bristow STATE OK ZIP 74016

COMPLETION REPORT

SPUD DATE 10-26-83

DRILL FINISHED DATE 11-20-83

DATE OF WELL COMPLETION 12-31-83

1st PROD DATE 1-5-84

RECOMP DATE 2-2-2007

Longitude (if known) 12-12-2017

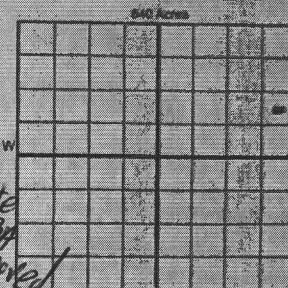

LOCATE WELL

COMPLETION TYPE

☒ SINGLE ZONE

☐ MULTIPLE ZONE

☐ Application Data

☐ COMMINGLED

☐ Application Data

LOCATION

EXCEPTION ORDER

INCREASED DENSITY

ORDER NO.

CASING & CEMENT (Form 1002C must be attached)

TYPE	SIZE	WEIGHT	GRADE	FEET	PSI	SAX	TOP OF CMT
CONDUCTOR	8 3/8	24	K56	922'			
SURFACE	8 5/8			922'		500	surface
INTERMEDIATE							
PRODUCTION	5 1/2	16.5	K56	719.7		250	6090
LINER							

PACKER @ BRAND & TYPE

PLUG @ 6967 TYPE CCBP

PACKER @ BRAND & TYPE

PLUG @ 2040 TYPE CCBP

COMPLETION & TEST DATA BY PRODUCING FORMATION

459 PRMN

FORMATION	Permian
SPACING & SPACING ORDER NUMBER	
CLASS: Oil Gas, Dry, Int. Disp. Comm Disp. Svc	TA
	1292-1372
PERFORATED INTERVALS	
ACID VOLUME	
FRACTURE TREATMENT (Fluids/Prop Amounts)	

RECEIVED

DEC 12 2017

Min Gas Allowable (145-10-17-7)

Gas Purchase/Measurer First Sales Date

OKLAHOMA CORPORATION COMMISSION
DUNCAN OFFICE

INITIAL TEST DATA

INITIAL TEST DATE	3-2-2006
OIL-EBL/DAY	
OIL-GRAVITY (API)	
GAS-MCF/DAY	
GAS-OIL RATIO CU FT/BBL	
WATER-EBL/DAY	Supply well
PUMPING OR FLOWING	pressure
INITIAL SHUT-IN PRESSURE	
CHOKE SIZE	
FLOWING PRESSURE	

AS SUBMITTED

I, the undersigned, being a resident of the State of Oklahoma, do hereby certify that the above is a true and correct copy of the original as submitted to me by the applicant, and that the same has been filed for record in the office of the Oklahoma Corporation Commission, in accordance with the provisions of the Oklahoma Statutes, Chapter 105, Section 3-25.

SIGNATURE: [Signature] NAME (PRINT OR TYPE): Sparks, George
ADDRESS: PO Box 779 CITY: Bristow STATE: OK ZIP: 74016

PLEASE TYPE OR USE BLACK INK ONLY
FORMATION RECORD

Give formation names and tops, if available, or descriptions and thickness of formations drilled through. Show intervals cored or drillstem tested.

NAMES OF FORMATIONS	TOP
Pharoch	6995- 7004
Permian Sand	1792- 1800 1592- 1593 1564- 1572 1464- 1480 1410-1426 1352-1373

LEASE NAME

George Washington WELL NO 2

FOR COMMISSION USE ONLY

FTD on file ☐ YES ☐ NO

APPROVED DISAPPROVED

2) Reject Codes

Were open hole logs run? ☐ yes ☐ no

Date Last log was run

Was CO₂ encountered? ☐ yes ☐ no at what depths?

Was H₂S encountered? ☐ yes ☐ no at what depths?

Were unusual drilling circumstances encountered? ☐ yes ☐ no
If yes, briefly explain below.

Other remarks:

RECEIVED

DEC 12 2017

OKLAHOMA
CORPORATION COMMISSION
DUNCAN OFFICE

640 Acres

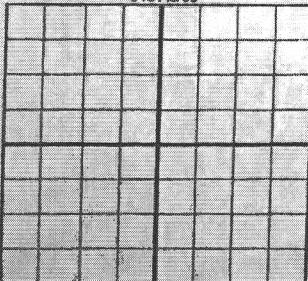

If more than three drainholes are proposed, attach a separate sheet indicating the necessary information.

Direction must be stated in degrees azimuth. Please note, the horizontal drainhole and its end point must be located within the boundaries of the lease or spacing unit.

Directional surveys are required for all drainholes and directional wells.

640 Acres

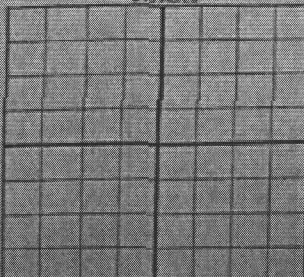

BOTTOM HOLE LOCATION FOR DIRECTIONAL HOLE

SEC	TWP	RGE	COUNTY
Spot Location	1/4	1/4	1/4
Measured Total Depth	True Vertical Depth		BHL From Lease, Unit, or Property Line
			FSL FWL

BOTTOM HOLE LOCATION FOR HORIZONTAL HOLE: (LATERALS)

LATERAL #1	SEC	TWP	RGE	COUNTY
Spot Location	1/4	1/4	1/4	1/4
Depth of Deviation	Radius of Turn		Direction	
Measured Total Depth	True Vertical Depth		BHL From Lease, Unit, or Property Line	
				FSL FWL

LATERAL #2	SEC	TWP	RGE	COUNTY
Spot Location	1/4	1/4	1/4	1/4
Depth of Deviation	Radius of Turn		Direction	
Measured Total Depth	True Vertical Depth		BHL From Lease, Unit, or Property Line	
				FSL FWL

LATERAL #3	SEC	TWP	RGE	COUNTY
Spot Location	1/4	1/4	1/4	1/4
Depth of Deviation	Radius of Turn		Direction	
Measured Total Depth	True Vertical Depth		BHL From Lease, Unit, or Property Line	
				FSL FWL