

Oklahoma Corporation Commission
Oil & Gas Conservation Division
Post Office Box 52000
Oklahoma City, Oklahoma 73152-2000
Rule 165: 10-3-25

Form 1002A

API No.: 35007230760002

Completion Report

Spud Date: July 22, 1985

OTC Prod. Unit No.: 007-69367

Drilling Finished Date: August 06, 1985

Amended

1st Prod Date: March 02, 1986

Amend Reason: RECOMPLETION

Completion Date: June 12, 1986

Recomplete Date: February 05, 2018

Drill Type: STRAIGHT HOLE

Well Name: PHEASANT RUN 1-23

Purchaser/Measurer:

Location: BEAVER 23 6N 21E CM
C N2 NW SW
2310 FSL 660 FWL of 1/4 SEC
Derrick Elevation: 0 Ground Elevation: 0

First Sales Date:

Operator: HUNTINGTON ENERGY LLC 19961

908 NW 71ST ST
OKLAHOMA CITY, OK 73116-7402

Completion Type	
	Single Zone
	Multiple Zone
X	Commingled

Location Exception	
Order No	
541652	
666195	

Increased Density	
Order No	
There are no Increased Density records to display.	

Casing and Cement							
Type	Size	Weight	Grade	Feet	PSI	SAX	Top of CMT
SURFACE	9 5/8	36		1500		750	SURFACE
INTERMEDIATE	7	23		5678		250	5100
PRODUCTION	4 1/2	11.6		6380		125	5540

Liner								
Type	Size	Weight	Grade	Length	PSI	SAX	Top Depth	Bottom Depth
There are no Liner records to display.								

Total Depth: 6380

Packer	
Depth	Brand & Type
There are no Packer records to display.	

Plug	
Depth	Plug Type
There are no Plug records to display.	

Initial Test Data

Test Date	Formation	Oil BBL/Day	Oil-Gravity (API)	Gas MCF/Day	Gas-Oil Ratio Cu FT/BBL	Water BBL/Day	Pumpin or Flowing	Initial Shut-In Pressure	Choke Size	Flow Tubing Pressure
Feb 05, 2018	MORROW LOW-CHESTER						COMPRES SION			

Completion and Test Data by Producing Formation									
Formation Name: MORROW LOW				Code: 402MRRWL			Class: DRY		
Spacing Orders				Perforated Intervals					
Order No		Unit Size		From			To		
179367		640		6012			6035		
Acid Volumes				Fracture Treatments					
1,725 GALLONS 7 1/2% HCL				There are no Fracture Treatments records to display.					

Formation Name: CHESTER		Code: 354CSTR		Class: DRY	
Spacing Orders		Perforated Intervals			
Order No	Unit Size	From	To		
27771	640	6231	6303		
Acid Volumes		Fracture Treatments			
There are no Acid Volume records to display.		There are no Fracture Treatments records to display.			
Formation Name: MORROW LOW-CHESTER		Code:		Class: DRY	

Formation	Top
MORROW	6010
CHESTER	6100

Were open hole logs run? Yes
 Date last log run: September 02, 2008

 Were unusual drilling circumstances encountered? No
 Explanation:

Other Remarks
WELL IS SHUT IN - NO PRODUCTION. NO COMMINGLE APPLICATION DUE TO NO PRODUCTION. EVALUATING FOR FUTURE USE.

FOR COMMISSION USE ONLY
<div>Status: Accepted</div> <div>1138973</div>

API NO. 35-007-23076
OTC PROD. UNIT NO. 007-69367

PLEASE TYPE OR USE BLACK INK ONLY
NOTE:

Attach copy of original 1002A
if recompletion or reentry.

OKLAHOMA CORPORATION COMMISSION
Oil & Gas Conservation Division
Post Office Box 52000
Oklahoma City, Oklahoma 73152-2000

Rule 165:10-3-25

COMPLETION REPORT

ORIGINAL
☒ AMENDED (Reason)

Recompletion

TYPE OF DRILLING OPERATION

☒ STRAIGHT HOLE ☐ DIRECTIONAL HOLE ☐ HORIZONTAL HOLE
☐ SERVICE WELL

If directional or horizontal, see reverse for bottom hole location.

COUNTY	Beaver	SEC	23	TWP	6N	RGE	21E	SPUD DATE	7/22/1985
LEASE NAME	Pheasant Run			WELL NO.	1-23	DATE OF WELL COMPLETION	6-12-1986	DRLG FINISHED DATE	8/6/1985
C	1/4	N/2	1/4	NW	1/4	SW	1/4	1st PROD DATE	3-2-1986
FSL OF 1/4 SEC	2310			FWL OF 1/4 SEC	660			RECOMP DATE	2/5/2018
ELEVATION Derrick FL	Ground			Latitude (if known)				Longitude (if known)	
OPERATOR NAME	Huntington Energy, L.L.C.						OTC/OCC OPERATOR NO.	19961	
ADDRESS	908 N.W. 71st Street								
CITY	Oklahoma City			STATE	OK		ZIP	73116	

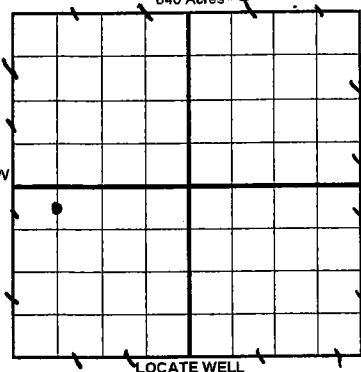

COMPLETION TYPE

<input type="checkbox"/>	SINGLE ZONE
<input type="checkbox"/>	MULTIPLE ZONE
<input checked="" type="checkbox"/>	Application Date COMMINGLED
<input type="checkbox"/>	Application Date LOCATION EXCEPTION
<input type="checkbox"/>	ORDER NO. 541652/666195
<input type="checkbox"/>	INCREASED DENSITY ORDER NO. 660195

CASING & CEMENT (Form 1002C must be attached)

TYPE	SIZE	WEIGHT	GRADE	FEET	PSI	SAX	TOP OF CMT
CONDUCTOR							
SURFACE	9 5/8"	36		1500'		750	Surf
INTERMEDIATE	7"	23		5678'		250	5100'
PRODUCTION	4 1/2"	11.6		6380'		125	5540'
LINER							
						TOTAL DEPTH	6,380

PACKER @ _____ BRAND & TYPE _____ PLUG @ _____ TYPE _____ PLUG @ _____ TYPE _____
PACKER @ _____ BRAND & TYPE _____ PLUG @ _____ TYPE _____ PLUG @ _____ TYPE _____

COMPLETION & TEST DATA BY PRODUCING FORMATION

FORMATION	Morrow (Lower)	Chester					
SPACING & SPACING ORDER NUMBER	179367 (640)	27771 (640)					
CLASS: Oil, Gas, Dry, Inj, Disp, Comm Disp, Svc	Dry	Dry					
PERFORATED INTERVALS	6012-6035	6231-6303					
ACID/VOLUME	1725 gal 7 1/2% HCL						
FRACTURE TREATMENT (Fluids/Prop Amounts)							

INITIAL TEST DATA

INITIAL TEST DATE	2/5/2018						
OIL-BBL/DAY	0						
OIL-GRAVITY (API)							
GAS-MCF/DAY	0						
GAS-OIL RATIO CU FT/BBL							
WATER-BBL/DAY							
PUMPING OR FLOWING	Compression						
INITIAL SHUT-IN PRESSURE							
CHOKE SIZE							
FLOW TUBING PRESSURE							

AS SUBMITTED

A record of the formations drilled through and pertinent remarks are presented on the reverse. I declare that I have knowledge of the contents of this report and am authorized by my organization to make this report which was prepared by me or under my supervision and direction, with the data and facts stated herein to be true, correct, and complete to the best of my knowledge and belief.

SIGNATURE	Catherine Smith	DATE	3/1/2018	PHONE NUMBER	405-840-9876
ADDRESS	908 N.W. 71st Street	CITY	Oklahoma City	STATE	OK
		ZIP	73116	EMAIL ADDRESS	csmith@huntingtonenergy.com

PLEASE TYPE OR USE BLACK INK ONLY

FORMATION RECORD

Give formation names and tops, if available, or descriptions and thickness of formations drilled through. Show intervals cored or drillstem tested.

LEASE NAME

Pheasant Run

WELL NO.

1-23

NAMES OF FORMATIONS	TOP
Morrow	6,010
Chester	6,100

FOR COMMISSION USE ONLY

ITD on file ☐ YES ☐ NO

APPROVED _____ DISAPPROVED _____

2) Reject Codes

Were open hole logs run? ☒ yes ☐ no

Date Last log was run 9/2/2008

Was CO₂ encountered? ☐ yes ☒ no at what depths? _____

Was H₂S encountered? ☐ yes ☒ no at what depths? _____

Were unusual drilling circumstances encountered? ☐ yes ☒ no

If yes, briefly explain below

Other remarks: Well is shut in - no production. No commingle application due to no production.. Evaluating for future use.

640 Acres

If more than three drainholes are proposed, attach a separate sheet indicating the necessary information.

Direction must be stated in degrees azimuth.
Please note, the horizontal drainhole and its end point must be located within the boundaries of the lease or spacing unit.

Directional surveys are required for all drainholes and directional wells.

640 Acres

BOTTOM HOLE LOCATION FOR DIRECTIONAL HOLE

SEC	TWP	RGE	COUNTY
Spot Location			
1/4	1/4	1/4	1/4
Measured Total Depth		True Vertical Depth	BHL From Lease, Unit, or Property Line:

BOTTOM HOLE LOCATION FOR HORIZONTAL HOLE: (LATERALS)

LATERAL #1

SEC	TWP	RGE	COUNTY
Spot Location			
1/4	1/4	1/4	1/4
Depth of Deviation		Radius of Turn	Direction
			Total Length
Measured Total Depth		True Vertical Depth	BHL From Lease, Unit, or Property Line:

LATERAL #2

SEC	TWP	RGE	COUNTY
Spot Location			
1/4	1/4	1/4	1/4
Depth of Deviation		Radius of Turn	Direction
			Total Length
Measured Total Depth		True Vertical Depth	BHL From Lease, Unit, or Property Line:

LATERAL #3

SEC	TWP	RGE	COUNTY
Spot Location			
1/4	1/4	1/4	1/4
Depth of Deviation		Radius of Turn	Direction
			Total Length
Measured Total Depth		True Vertical Depth	BHL From Lease, Unit, or Property Line: