

Oklahoma Corporation Commission
Oil & Gas Conservation Division
Post Office Box 52000
Oklahoma City, Oklahoma 73152-2000
Rule 165: 10-3-25

Form 1002A

API No.: 35103211230002

Completion Report

Spud Date: August 02, 1980

OTC Prod. Unit No.: N/A

Drilling Finished Date: August 17, 1980

Amended

1st Prod Date: August 27, 1980

Amend Reason: WORKOVER (REMOVED PACKER / ADDED CIBP)

Completion Date: August 20, 1980

Recomplete Date: June 21, 2018

Drill Type: STRAIGHT HOLE

SERVICE WELL

Well Name: DONOVAN YOST SWD 1-15

Purchaser/Measurer:

Location: NOBLE 15 23N 2W
S2 NW NW SW
2160 FSL 330 FWL of 1/4 SEC
Derrick Elevation: 975 Ground Elevation: 966

First Sales Date:

Operator: CHESAPEAKE OPERATING LLC 17441
PO BOX 18496
6100 N WESTERN AVE
OKLAHOMA CITY, OK 73154-0496

Completion Type		Location Exception		Increased Density	
X	Single Zone	Order No		Order No	
	Multiple Zone	N/A		N/A	
	Commingled				

Casing and Cement							
Type	Size	Weight	Grade	Feet	PSI	SAX	Top of CMT
SURFACE	8 5/8	24	J-55	323	2000	215	SURFACE
PRODUCTION	4 1/2	10.5	J-55	4386	4500	200	3328

Liner								
Type	Size	Weight	Grade	Length	PSI	SAX	Top Depth	Bottom Depth
There are no Liner records to display.								

Total Depth: 4386

Packer		Plug	
Depth	Brand & Type	Depth	Plug Type
There are no Packer records to display.		3470	CIBP

Initial Test Data

Test Date	Formation	Oil BBL/Day	Oil-Gravity (API)	Gas MCF/Day	Gas-Oil Ratio Cu FT/BBL	Water BBL/Day	Pumpin or Flowing	Initial Shut- In Pressure	Choke Size	Flow Tubing Pressure
-----------	-----------	----------------	----------------------	----------------	----------------------------	------------------	----------------------	---------------------------------	---------------	-------------------------

There are no Initial Data records to display.

Completion and Test Data by Producing Formation

Formation Name: ARBUCKLE Code: 169ABCK Class: DISP

Spacing Orders		Perforated Intervals	
Order No	Unit Size	From	To
N/A		There are no Perf. Intervals records to display.	
Acid Volumes		Fracture Treatments	
There are no Acid Volume records to display.		There are no Fracture Treatments records to display.	

Formation	Top
WILCOX	4170
SIMPSON	4260
ARBUCKLE	4350

Were open hole logs run? Yes
Date last log run: August 16, 1980

Were unusual drilling circumstances encountered? No
Explanation:

Other Remarks

UIC PERMIT ORDER NUMBER 443067. OCC - THIS WELL WAS AN OPEN HOLE COMPLETION FROM BOTTOM OF THE 4 1/2" CASING AT 4,386' TO TOTAL DEPTH AT 4,387', BUT SETTING THE PLUG THIS WELL IS PRESENTLY SHUT IN AND NOT IN SERVICE AS A DISPOSAL WELL AT THIS TIME, BUT STILL CLASSIFIED AS DISPOSAL.

FOR COMMISSION USE ONLY	
Status: Accepted	1140616

API NO. 103-21123
OTC PROD.
UNIT NO. N/A

PLEASE TYPE OR USE BLACK INK ONLY
NOTE:
Attach copy of original 1002A if recompletion or reentry.

OKLAHOMA CORPORATION COMMISSION
Oil & Gas Conservation Division
Post Office Box 52000
Oklahoma City, Oklahoma 73152-2000
Rule 165:10-3-25

RECEIVED
Form 1002A
Rev. 2009

AUG 17 2018

OKLAHOMA CORPORATION
COMMISSION

ORIGINAL
☒ AMENDED
Reason Amended Workover (removed packer/added CIBP)

TYPE OF DRILLING OPERATION
☒ STRAIGHT HOLE ☐ DIRECTIONAL HOLE ☐ HORIZONTAL HOLE
☒ SERVICE WELL
If directional or horizontal, see reverse for bottom hole location.

COMPLETION REPORT

COUNTY	Noble	SEC	15	TWP	23N	RGE	2W
LEASE NAME	Donovan Yost SWD			WELL NO	1-15		
SHL	S2 1/4 NW 1/4 NW 1/4 SW 1/4	FSL	2,160	FWL OF	1/4 SEC	330	
ELEVATION	Derrick Fl 975 Ground 966			Latitude (if Known)			
OPERATOR NAME	CHESAPEAKE OPERATING, L.L.C.			OTC/OCC OPERATOR NO.	17441		
ADDRESS	P.O. BOX 18496						
CITY	OKLAHOMA CITY			STATE	OK	ZIP	73154

SPUD DATE	8/2/1980
DRLG FINISHED DATE	8/17/1980
DATE OF WELL COMPLETION	8/20/1980
1ST PROD DATE	8/27/1980
RECOMP DATE	6/21/2018
Longitude (if Known)	

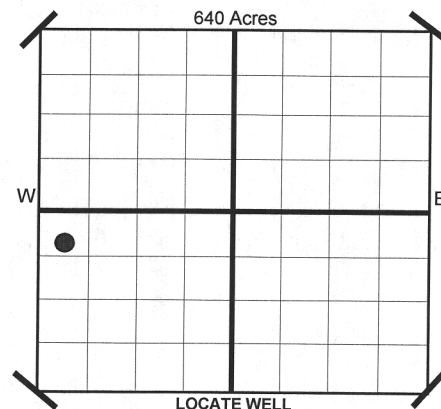

COMPLETION TYPE

<input checked="" type="checkbox"/> SINGLE ZONE	
<input type="checkbox"/> MULTIPLE ZONE	
<input type="checkbox"/> COMMINGLED	
LOCATION EXCEPTION ORDER NO.	N/A
INCREASED DENSITY ORDER NO.	N/A

CASING & CEMENT (Form 1002C must be attached)

TYPE	SIZE	WEIGHT	GRADE	FEET	PSI	SAX	TOP
CONDUCTOR							
SURFACE	8-5/8"	24#	J-55	323	2,000	215	Surface
INTERMEDIATE							
PRODUCTION	4-1/2"	10.5#	J-55	4,386	4,500	200	3,328
LINER							

PACKER @ BRAND & TYPE
PACKER @ BRAND & TYPE

PLUG @ TYPE
PLUG @ TYPE
PLUG @ TYPE
PLUG @ TYPE

TOTAL DEPTH 4,386

COMPLETION & TEST DATA BY PRODUCING FORMATION

FORMATION	Arbuckle
SPACING & SPACING ORDER NUMBER	N/A
CLASS: Oil, Gas, Dry, Inj. Disp, Comm Disp, Svc	Disposal — not in service at this time
PERFORATED INTERVALS	Open Hole sealed off by plug
ACID/VOLUME	
FRACTURE TREATMENT (Fluids/Prop Amounts)	

Minimum Gas Allowable (165:10-17-7)

Gas Purchaser/Measurer

☐

OR

1st Sales Date

Oil Allowable (165:10-13-3)

INITIAL TEST DATA

INITIAL TEST DATE	
OIL-BBL/DAY	
OIL-GRAVITY (API)	
GAS-MCF/DAY	
GAS-OIL RATIO CU FT/BBL	
WATER-BBL/DAY	
PUMPING OR FLOWING	
INITIAL SHUT-IN PRESSURE	
CHOKE SIZE	
FLOW TUBING PRESSURE	

AS SUBMITTED

A record of the formations drilled through, and pertinent remarks are presented on the reverse. I declare that I have knowledge of the contents of this report and am authorized by my organization to make this report, which was prepared by me or under my supervision and direction, with the data and facts stated herein to be true, correct, and complete to the best of my knowledge and belief.

SIGNATURE	JUANITA COOPER - SR. REGULATORY ANALYST	DATE	8/16/2018	PHONE NUMBER	405-848-8000
P.O. BOX 18496	OKLAHOMA CITY	OK	73154	EMAIL ADDRESS	juanita.cooper@chk.com
ADDRESS	CITY	STATE	ZIP		

PLEASE TYPE OR USE BLACK INK ONLY
FORMATION RECORD

Give formation names and tops, if available, or descriptions and thickness of formations drilled through. Show intervals cored or drillstem tested.

LEASE NAME Donovan Yost SWD

WELL NO. 1-15

NAMES OF FORMATIONS	TOP
Wilcox	4,170
Simpson	4,260
Arbuckle	4,350

FOR COMMISSION USE ONLY	
ITD on file <input type="checkbox"/> YES <input type="checkbox"/> NO	
APPROVED _____	DISAPPROVED _____
2) Reject Codes	

Were open hole logs run?	<input checked="" type="checkbox"/> yes	<input type="checkbox"/> no
Date Last log was run	8/16/1980	
Was CO ₂ encountered?	<input type="checkbox"/> yes	<input checked="" type="checkbox"/> no at what depths?
Was H ₂ S encountered?	<input type="checkbox"/> yes	<input checked="" type="checkbox"/> no at what depths?
Were unusual drilling circumstances encountered?	<input type="checkbox"/> yes	<input checked="" type="checkbox"/> no
If yes, briefly explain.		

Other remarks:

UIC Permit Order No. 443067

OCC - This well was an open hole completion from bottom of the 4 1/2" casing at 4386' to total depth at 4387', but setting the plug this well is presently shut in and not in service as a disposal well at this time, but still classified as disposal.

640 Acres

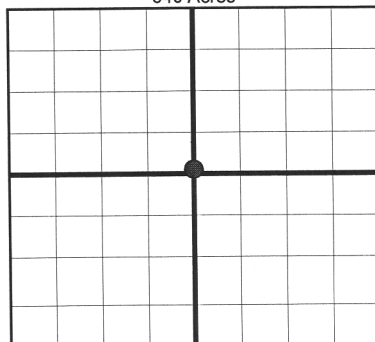

BOTTOM HOLE LOCATION FOR DIRECTIONAL HOLE

SEC	TWP	RGE	COUNTY
Spot Location	1/4	1/4	1/4
Measured Total Depth	True Vertical Depth		Feet From 1/4 Sec Lines FSL FWL
BHL From Lease, Unit, or Property Line:			

BOTTOM HOLE LOCATION FOR HORIZONTAL HOLE: (LATERALS)

LATERAL #1

SEC	TWP	RGE	COUNTY
Spot Location	1/4	1/4	1/4
Depth of Deviation	Radius of Turn	Direction	Total Length
Measured Total Depth	True Vertical Depth		BHL From Lease, Unit, or Property Line:

LATERAL #2

SEC	TWP	RGE	COUNTY
Spot Location	1/4	1/4	1/4
Depth of Deviation	Radius of Turn	Direction	Total Length
Measured Total Depth	True Vertical Depth		BHL From Lease, Unit, or Property Line:

LATERAL #3

SEC	TWP	RGE	COUNTY
Spot Location	1/4	1/4	1/4
Depth of Deviation	Radius of Turn	Direction	Total Length
Measured Total Depth	True Vertical Depth		BHL From Lease, Unit, or Property Line:

If more than three drainholes are proposed, attach a separate sheet indicating the necessary information.

Direction must be stated in degrees azimuth. Please note, the horizontal drainhole and its end point must be located within the boundaries of the lease or spacing unit.

Directional surveys are required for all drainholes and directional wells.

640 Acres

