

Oklahoma Corporation Commission  
Oil & Gas Conservation Division  
Post Office Box 52000  
Oklahoma City, Oklahoma 73152-2000  
Rule 165: 10-3-25

Form 1002A

API No.: 35151237500001

**Completion Report**

Spud Date: September 16, 2012

OTC Prod. Unit No.: 151-209733

Drilling Finished Date: October 24, 2012

1st Prod Date: December 05, 2012

**Amended**

Completion Date: November 27, 2012

Amend Reason: AMENDED TO ADD INITIAL TEST DATA AND CORRECT PERFORATIONS

**Drill Type: HORIZONTAL HOLE**

Min Gas Allowable: Yes

Well Name: STELLING 2H-9

Purchaser/Measurer: SEMGAS

Location: WOODS 4 26N 13W  
SW SE SW SE  
200 FSL 1881 FEL of 1/4 SEC  
Latitude: 36.754384072 Longitude: -98.600831361  
Derrick Elevation: 0 Ground Elevation: 1409

First Sales Date: 12/05/2012

Operator: MIDSTATES PETROLEUM CO LLC 23079

321 S BOSTON AVE STE 1000  
TULSA, OK 74103-3322

Completion Type		Location Exception		Increased Density	
X	Single Zone	Order No		Order No	
	Multiple Zone	There are no Location Exception records to display.		There are no Increased Density records to display.	
	Commingled				

Casing and Cement							
Type	Size	Weight	Grade	Feet	PSI	SAX	Top of CMT
SURFACE	13 3/8	48	K-55	527		495	SURFACE
INTERMEDIATE	9 5/8	36	J-55	1017		360	SURFACE
PRODUCTION	7	23	E-80	6127		285	1686

Liner								
Type	Size	Weight	Grade	Length	PSI	SAX	Top Depth	Bottom Depth
LINER	4.5	11.6	I-80	4271	0	470	5869	10140

**Total Depth: 10145**

Packer	
Depth	Brand & Type
There are no Packer records to display.	

Plug	
Depth	Plug Type
There are no Plug records to display.	

Initial Test Data
-------------------

Test Date	Formation	Oil BBL/Day	Oil-Gravity (API)	Gas MCF/Day	Gas-Oil Ratio Cu FT/BBL	Water BBL/Day	Pumpin or Flowing	Initial Shut-In Pressure	Choke Size	Flow Tubing Pressure
Dec 13, 2012	MISSISSIPPIAN	24		15	625	595	FLOWING	80	64/64	150

#### Completion and Test Data by Producing Formation

Formation Name: MISSISSIPPIAN

Code: 359MSSP

Class: OIL

#### Spacing Orders

Order No	Unit Size
599671	640

#### Perforated Intervals

From	To
6525	10082

#### Acid Volumes

5,571 BARRELS 15% HCL

#### Fracture Treatments

27,599 BARRELS SLICK WATER, 420,750 POUNDS  
30/50 OTTAWA SAND

Formation	Top
HEEBNER SHALE	4330
HASKELL LIME	4660
TONKAWA	4736
AVANT	5018
COTTAGE GROVE	5072
OSWEGO	5322
CHEROKEE	5456
RED FORK	5555
MISSISSIPPI CHAT	5656
MISSISSIPPI	5671

Were open hole logs run? No

Date last log run:

Were unusual drilling circumstances encountered? No

Explanation:

#### Other Remarks

OCC - THIS WELL'S COMPLETION INTERVAL IS WITHIN THE LEGAL LIMITS ALLOWED BY THE SPACING ORDER.

#### Lateral Holes

Sec: 9 TWP: 26N RGE: 13W County: WOODS

C SW SE

660 FSL 1980 FEL of 1/4 SEC

Depth of Deviation: 4731 Radius of Turn: 1072 Direction: 181 Total Length: 3985

Measured Total Depth: 10145 True Vertical Depth: 5744 End Pt. Location From Release, Unit or Property Line: 660

#### FOR COMMISSION USE ONLY

1139771

Status: Accepted

# RECEIVED

Form 1002A  
Rev. 2009

MAY 04 2018

OKLAHOMA CORPORATION COMMISSION

API NO. 151 23750  
OTC PROD. UNIT NO. 151 209733

PLEASE TYPE OR USE BLACK INK ONLY  
NOTE:

Attach copy of original 1002A  
if recompletion or reentry.

OKLAHOMA CORPORATION COMMISSION  
Oil & Gas Conservation Division  
Post Office Box 52000  
Oklahoma City, Oklahoma 73152-2000  
Rule 165:10-3-25

## COMPLETION REPORT

☐ ORIGINAL  
☒ AMENDED (Reason) Amended to add initial test data and correct perf

### TYPE OF DRILLING OPERATION

☐ STRAIGHT HOLE ☐ DIRECTIONAL HOLE ☒ HORIZONTAL HOLE

If directional or horizontal, see reverse for bottom hole location.

COUNTY Woods	SEC 04	TWP 26N	RGE 13W	SPUD DATE 09/16/2012
LEASE NAME Stelling	WELL NO. 2H-9	DATE OF WELL COMPLETION 11/27/2012	1st PROD DATE 12/05/2012	
SW 1/4 SE 1/4 SW 1/4 SE 1/4	FSL OF 1/4 SEC 200	FWL OF 1/4 SEC 1881E	RECOMP DATE	
ELEVATIO N Derrick Ground 1409	Latitude (if known) 36.754384072	Longitude (if known) -98.600831361		
OPERATOR NAME Midstates Petroleum Company LLC	OTC/OCC OPERATOR NO. 23079			
ADDRESS 321 South Boston, Suite 1000				
CITY Tulsa	STATE OK	ZIP 74103		

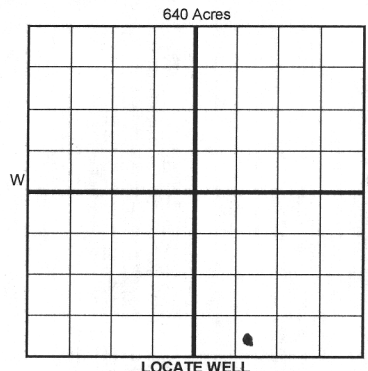

### COMPLETION TYPE

☒ SINGLE ZONE  
☐ MULTIPLE ZONE  
☐ COMMINGLED  
☐ EXCEPTION ORDER  
☐ INCREASED DENSITY  
☐ ORDER NO.

### CASING & CEMENT (Form 1002C must be attached)

TYPE	SIZE	WEIGHT	GRADE	FEET	PSI	SAX	TOP OF CMT
CONDUCTOR							
SURFACE	13-3/8	48#	K-55	527'		495	surface
INTERMEDIATE	9-5/8	36#	J-55	1,017'		360	surface
PRODUCTION	7	23#	E-80	6,127'		285	1,686
LINER	4.5	11.6#	I-80	5,869'	10,140'	470	5,375
							10,145'

PACKER @ \_\_\_\_\_ BRAND & TYPE \_\_\_\_\_ PLUG @ \_\_\_\_\_ TYPE \_\_\_\_\_ PLUG @ \_\_\_\_\_ TYPE \_\_\_\_\_  
 PACKER @ \_\_\_\_\_ BRAND & TYPE \_\_\_\_\_ PLUG @ \_\_\_\_\_ TYPE \_\_\_\_\_ PLUG @ \_\_\_\_\_ TYPE \_\_\_\_\_

TOTAL DEPTH

### COMPLETION & TEST DATA BY PRODUCING FORMATION

FORMATION	Mississippian								
SPACING & SPACING ORDER NUMBER	640/599671								
CLASS: Oil, Gas, Dry, Inj, Disp, Comm Disp, Svc	Oil								
PERFORATED INTERVALS	6,525'-10,082'								
ACID/VOLUME	5571 bbls 15% HCl								
FRACTURE TREATMENT (Fluids/Prop Amounts)	27,599 bbls slk wtr								
	420,750# 30/50 Ottawa Sd								

Monitor  
Report to Frac Focus

Min Gas Allowable (165:10-17-7) ☐ OR Gas Purchaser/Measurer SemGas  
 Oil Allowable (165:10-13-3) First Sales Date 12/05/2012

### INITIAL TEST DATA

INITIAL TEST DATE	12/13/2012						
OIL-BBL/DAY	24						
OIL-GRAVITY ( API)	N/A						
GAS-MCF/DAY	15						
GAS-OIL RATIO CU FT/BBL	625						
WATER-BBL/DAY	595						
PUMPING OR FLOWING	Flowing						
INITIAL SHUT-IN PRESSURE	80						
CHOKE SIZE	64/64						
FLOW TUBING PRESSURE	150						

**AS SUBMITTED**

A record of the formations drilled through, and pertinent remarks are presented on the reverse. I declare that I have knowledge of the contents of this report and am authorized by my organization to make this report which was prepared by me or under my supervision and direction, with the data and facts stated herein to be true, correct, and complete to the best of my knowledge and belief.

SIGNATURE *Chelce Rouse* NAME (PRINT OR TYPE) Chelce Rouse DATE 04/26/2018 PHONE NUMBER 918-947-4647

321 South Boston, Suite 1000 Tulsa, OK 74103 chelce.rouse@midstatespetroleum.com

ADDRESS CITY STATE ZIP EMAIL ADDRESS

PLEASE TYPE OR USE BLACK INK ONLY  
FORMATION RECORD

Give formation names and tops, if available, or descriptions and thickness of formations drilled through. Show intervals cored or drillstem tested.

LEASE NAME Stelling

WELL NO. 2H-9

NAMES OF FORMATIONS	TOP
Heebner Shale	4330
Haskell Lime	4660
Tonkawa	4736
Avant	5018
Cottage Grove	5072
Oswego	5322
Cherokee	5456
Red Fork	5555
Miss. Chat	5656
Mississippi	5671

FOR COMMISSION USE ONLY

ITD on file ☐ YES ☐ NO

APPROVED \_\_\_\_\_ DISAPPROVED \_\_\_\_\_

2) Reject Codes \_\_\_\_\_

Were open hole logs run? ☐ yes ☒ no

Date Last log was run N/A

Was CO<sub>2</sub> encountered? ☐ yes ☒ no at what depths? \_\_\_\_\_

Was H<sub>2</sub>S encountered? ☐ yes ☒ no at what depths? \_\_\_\_\_

Were unusual drilling circumstances encountered? ☐ yes ☒ no

If yes, briefly explain below \_\_\_\_\_

Other remarks:

640 Acres

If more than three drainholes are proposed, attach a separate sheet indicating the necessary information.

Direction must be stated in degrees azimuth.  
Please note, the horizontal drainhole and its end point must be located within the boundaries of the lease or spacing unit.

Directional surveys are required for all drainholes and directional wells.

640 Acres

BOTTOM HOLE LOCATION FOR DIRECTIONAL HOLE

SEC	TWP	RGE	COUNTY
Spot Location	1/4	1/4	1/4
Measured Total Depth	True Vertical Depth	BHL From Lease, Unit, or Property Line:	

BOTTOM HOLE LOCATION FOR HORIZONTAL HOLE: (LATERALS)

LATERAL #1

SEC	TWP	RGE	COUNTY
9	26N	13W	Woods
Spot Location	1/4	1/4	1/4
Depth of Deviation	Radius of Turn	Direction	Total Length
4,731	1,072	181	3,985
Measured Total Depth	True Vertical Depth	BHL From Lease, Unit, or Property Line:	
10,145	5,744	660 612	

LATERAL #2

SEC	TWP	RGE	COUNTY
Spot Location	1/4	1/4	1/4
Depth of Deviation	Radius of Turn	Direction	Total Length
Measured Total Depth	True Vertical Depth	BHL From Lease, Unit, or Property Line:	

LATERAL #3

SEC	TWP	RGE	COUNTY
Spot Location	1/4	1/4	1/4
Depth of Deviation	Radius of Turn	Direction	Total Length
Measured Total Depth	True Vertical Depth	BHL From Lease, Unit, or Property Line:	

1948 FEL