

Oklahoma Corporation Commission
Oil & Gas Conservation Division
Post Office Box 52000
Oklahoma City, Oklahoma 73152-2000
Rule 165: 10-3-25

Form 1002A

API No.: 35085212740000

Completion Report

Spud Date: December 26, 2016

OTC Prod. Unit No.: 085-219188

Drilling Finished Date: February 02, 2017

1st Prod Date: August 20, 2017

Completion Date: April 14, 2018

Drill Type: STRAIGHT HOLE

Min Gas Allowable: Yes

Well Name: DAISY DUKE 1-15

Purchaser/Measurer: TARGA PIPELINE

Location: LOVE 15 6S 2E
NW NE SW SW
1080 FSL 880 FWL of 1/4 SEC
Latitude: 34.03042 Longitude: -97.08856
Derrick Elevation: 788 Ground Elevation: 766

First Sales Date: 09/10/2017

Operator: CHARTER OAK PRODUCTION CO LLC 21672

13929 QUAIL POINTE DR
OKLAHOMA CITY, OK 73134-1037

Completion Type		Location Exception		Increased Density	
	Single Zone	Order No		Order No	
	Multiple Zone	660294		There are no Increased Density records to display.	
X	Commingled				

Casing and Cement							
Type	Size	Weight	Grade	Feet	PSI	SAX	Top of CMT
CONDUCTOR	16			80			SURFACE
SURFACE	9 5/8	36	J-55	512		250	SURFACE
PRODUCTION	7	26	P-110	12046		850	5730

Liner								
Type	Size	Weight	Grade	Length	PSI	SAX	Top Depth	Bottom Depth
There are no Liner records to display.								

Total Depth: 12046

Packer		Plug	
Depth	Brand & Type	Depth	Plug Type
There are no Packer records to display.		10720	CIBP

Initial Test Data

Test Date	Formation	Oil BBL/Day	Oil-Gravity (API)	Gas MCF/Day	Gas-Oil Ratio Cu FT/BBL	Water BBL/Day	Pumpin or Flowing	Initial Shut-In Pressure	Choke Size	Flow Tubing Pressure
Apr 08, 2017	SIMPSON					220	FLOWING	1900		800
Aug 17, 2017	VIOLA						SHUT-IN	4229		
Oct 06, 2017	WOODFORD						SHUT-IN	2546		
Oct 06, 2017	SYCAMORE						SHUT-IN	2244		
Apr 14, 2018	VIOLA-WOODFORD-SYCAMORE	252	37	241	956	42	PUMPING	250		

Completion and Test Data by Producing Formation

Formation Name: SIMPSON

Code: 202SMPS

Class: DRY

Spacing Orders

Order No	Unit Size
646921	640

Perforated Intervals

From	To
11570	11679

Acid Volumes

There are no Acid Volume records to display.

Fracture Treatments

There are no Fracture Treatments records to display.

Formation Name: VIOLA

Code: 202VIOL

Class: OIL

Spacing Orders

Order No	Unit Size
646921	640

Perforated Intervals

From	To
8755	10446

Acid Volumes

108,000 GALLONS 20% NEFE

Fracture Treatments

44,102 BARRELS SLICK WATER, 1,193,467 POUNDS 20/40 SAND

Formation Name: WOODFORD

Code: 319WDFD

Class: OIL

Spacing Orders

Order No	Unit Size
646921	640

Perforated Intervals

From	To
7248	7606

Acid Volumes

1,500 GALLONS 15% NEFE

Fracture Treatments

8,505 BW, 301,114 POUNDS 20/40 SAND

Formation Name: SYCAMORE

Code: 352SCMR

Class: OIL

Spacing Orders

Order No	Unit Size
646921	640

Perforated Intervals

From	To
6820	7020

Acid Volumes

1,500 GALLONS 15% NEFE

Fracture Treatments

8,745 BW, 319,930 POUNDS 20/40 SAND

Formation Name: VIOLA-WOODFORD-
SYCAMORE

Code:

Class: OIL

Formation	Top
SPRINGER	3053
SYCAMORE	6779
WOODFORD	7215
HUNTON	7630
VIOLA	8715
SIMPSON	10447

Were open hole logs run? Yes

Date last log run: February 02, 2017

Were unusual drilling circumstances encountered? No

Explanation:

Other Remarks

There are no Other Remarks.

FOR COMMISSION USE ONLY

1139703

Status: Accepted

RECEIVED

Form 1002A
Rev. 2009

APR 27 2018

OKLAHOMA CORPORATION
COMMISSION

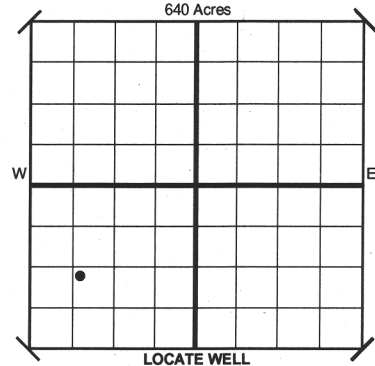

API NO. 35-085-21274
OTC PROD. 085-219188
UNIT NO.

PLEASE TYPE OR USE BLACK INK ONLY

NOTE:

Attach copy of original 1002A
if recompletion or reentry.

OKLAHOMA CORPORATION COMMISSION
Oil & Gas Conservation Division
Post Office Box 52000
Oklahoma City, Oklahoma 73152-2000
Rule 165:10-3-25

☒ ORIGINAL
☐ AMENDED (Reason)

TYPE OF DRILLING OPERATION

☒ STRAIGHT HOLE ☐ DIRECTIONAL HOLE ☐ HORIZONTAL HOLE
☐ SERVICE WELL

If directional or horizontal, see reverse for bottom hole location.

COUNTY Love	SEC 15	TWP 06S	RGE 02E	SPUD DATE 12/26/16
LEASE NAME Daisy Duke	WELL NO. 1-15	DATE OF WELL COMPLETION 4/14/18	DRLG FINISHED DATE 2/2/17	
NW 1/4 NE 1/4 SW 1/4 SW 1/4	FSL OF 1/4 SEC 1080'	FWL OF 1/4 SEC 880'	1st PROD DATE 8/20/17	
ELEVATION N Derrick 788' Ground 766'	Latitude (if known) 34.03042	Longitude (if known) -97.08856	RECOMP DATE	
OPERATOR NAME Charter Oak Production Co., LLC			OTC/OCC OPERATOR NO. 21672	
ADDRESS 13929 Quail Pointe Dr.				
CITY Oklahoma City		STATE OK	ZIP 73134	

COMPLETION TYPE

<input type="checkbox"/> SINGLE ZONE
<input type="checkbox"/> MULTIPLE ZONE
Application Date
<input checked="" type="checkbox"/> COMMINGLED
Application Date 4/25/18
LOCATION 660294
EXCEPTION ORDER
INCREASED DENSITY ORDER NO.

CASING & CEMENT (Form 1002C must be attached)

TYPE	SIZE	WEIGHT	GRADE	FEET	PSI	SAX	TOP OF CMT
CONDUCTOR	16"			80'			Surface
SURFACE	9 5/8"	36#	J-55	512'		250	Surface
INTERMEDIATE							
PRODUCTION	7"	26#	P-110	12046'		850	5730'
LINER							
				TOTAL DEPTH	12046'		

PACKER @ _____ BRAND & TYPE _____ PLUG @ 10720' TYPE CIBP _____ PLUG @ _____ TYPE _____
PACKER @ _____ BRAND & TYPE _____ PLUG @ _____ TYPE _____ PLUG @ _____ TYPE _____

COMPLETION & TEST DATA BY PRODUCING FORMATION

FORMATION	Simpson	Viola	Woodford	Sycamore	SCMR, WDFD, VIOL	
SPACING & SPACING ORDER NUMBER	640 Ac. - 646921	640 Ac. - 646921	640 Ac. - 646921	640 Ac. - 646921	640 Ac. - 646921	
CLASS: Oil, Gas, Dry, Inj, Disp, Comm Disp, Svc	Dry	Oil	Oil	Oil	Oil	
PERFORATED INTERVALS	11570' - 11679' O.A.	8755' - 10446' O.A.	7248' - 7606' O.A.	6820' - 7020' O.A.	6820' - 10446' O.A.	
ACID/VOLUME		108,000 Gal 20% NeFe	1500 Gal 15% NeFe	1500 Gal 15% NeFe	N/A	
FRACTURE TREATMENT (Fluids/Prop Amounts)		44,102 BBL slick water	8505 BW	8745 BW	N/A	
		1,193,467# 20/40 sand	301,114# 20/40 sand	319,930# 20/40 sand		

☒ Min Gas Allowable (165:10-17) OR Gas Purchaser/Measurer First Sales Date Targa Pipeline 9/10/17
☐ Oil Allowable (165:10-13-3)

INITIAL TEST DATA

INITIAL TEST DATE	4/8/17	8/17/17	10/6/17	10/6/17	4/14/18
OIL-BBL/DAY	0	N/A	N/A	N/A	252
OIL-GRAVITY (API)	N/A	N/A	N/A	N/A	37.0
GAS-MCF/DAY	H2S	N/A	N/A	N/A	241
GAS-OIL RATIO CU FT/BBL	N/A	N/A	N/A	N/A	956
WATER-BBL/DAY	220	N/A	N/A	N/A	42
PUMPING OR FLOWING	Flowing	Shut-in	Shut-in	Shut-in	Pumping
INITIAL SHUT-IN PRESSURE	1900 psi	4229 psi	2546 psi	2244 psi	250 psi
CHOKE SIZE	N/A	N/A	N/A	N/A	N/A
FLOW TUBING PRESSURE	800 FCP	N/A	N/A	N/A	N/A

A record of the formations drilled through, and pertinent remarks are presented on the reverse. I declare that I have knowledge of the contents of this report and am authorized by my organization to make this report which was prepared by me or under my supervision and direction, with the data and facts stated herein to be true, correct, and complete to the best of my knowledge and belief.

Joseph C. Brevetti
SIGNATURE NAME (PRINT OR TYPE) DATE 4/25/18 PHONE NUMBER (405) 286-0361
13929 Quail Pointe Dr. Oklahoma City OK 73134 brevetti@charteroakproduction.com
ADDRESS CITY STATE ZIP EMAIL ADDRESS

AS SUBMITTED

