

Oklahoma Corporation Commission
Oil & Gas Conservation Division
Post Office Box 52000
Oklahoma City, Oklahoma 73152-2000
Rule 165: 10-3-25

Form 1002A

API No.: 35139231710005

Completion Report

Spud Date: September 11, 2000

OTC Prod. Unit No.: 139-013962-2

Drilling Finished Date: September 22, 2000

Amended

Amend Reason: RETURN STATUS TO GAS

1st Prod Date: February 09, 2001

Completion Date: December 23, 2000

Recomplete Date: April 16, 2018

Drill Type: STRAIGHT HOLE

Well Name: STONEBRAKER A (FRANK 29-2) 134

Purchaser/Measurer:

Location: TEXAS 29 3N 13E CM
SW SE NE SW
1600 FSL 2300 FWL of 1/4 SEC
Derrick Elevation: 3152 Ground Elevation: 3139

First Sales Date:

Operator: MERIT ENERGY COMPANY 18934

13727 NOEL RD STE 1200
DALLAS, TX 75240-7312

Completion Type		Location Exception		Increased Density	
X	Single Zone	Order No		Order No	
	Multiple Zone	There are no Location Exception records to display.		There are no Increased Density records to display.	
	Commingled				

Casing and Cement							
Type	Size	Weight	Grade	Feet	PSI	SAX	Top of CMT
SURFACE	8 5/8	24	A	1528	1000	600	SURFACE
PRODUCTION	5 1/2	15.5	A	2799	1000	200	2122

Liner								
Type	Size	Weight	Grade	Length	PSI	SAX	Top Depth	Bottom Depth
There are no Liner records to display.								

Total Depth: 4600

Packer	
Depth	Brand & Type
There are no Packer records to display.	

Plug	
Depth	Plug Type
There are no Plug records to display.	

Initial Test Data										
Test Date	Formation	Oil BBL/Day	Oil-Gravity (API)	Gas MCF/Day	Gas-Oil Ratio Cu FT/BBL	Water BBL/Day	Pumpin or Flowing	Initial Shut-In Pressure	Choke Size	Flow Tubing Pressure
Feb 15, 2001	GUYMON-HUGOTON			60			PUMPING			

Completion and Test Data by Producing Formation			
Formation Name: GUYMON-HUGOTON		Code: 451GYHG	Class: GAS
Spacing Orders		Perforated Intervals	
Order No	Unit Size	From	To
17867	640	2549	2608
27014	640		
Acid Volumes		Fracture Treatments	
2,000 GALLONS 7 1/2%		15,000 GALLONS 75% N2	

Formation	Top
SEE WELL FORMERLY KNOWN AS FRANK 29-2	0

Were open hole logs run? No

Date last log run:

Were unusual drilling circumstances encountered? No

Explanation:

Other Remarks
There are no Other Remarks.

FOR COMMISSION USE ONLY	
Status: Accepted	1139646

API NO. 139-231710004
OTC PROD. UNIT NO. 139-013962-2

(PLEASE TYPE OR USE BLACK INK ONLY)

OKLAHOMA CORPORATION COMMISSION

Oil & Gas Conservation Division

Post Office Box 52000

Oklahoma City, Oklahoma 73152-2000

Rule 165:10-3-25

COMPLETION REPORT

☐ ORIGINAL
☒ AMENDED (Reason)

Return status to gas

TYPE OF DRILLING OPERATION

☒ STRAIGHT HOLE ☐ DIRECTIONAL HOLE ☐ HORIZONTAL HOLE
☐ SERVICE WELL

If directional or horizontal, see reverse for bottom hole location.

COUNTY Texas SEC 29 TWP 03N RGE 13ECM
LEASE NAME Stonebraker A WELL NO. 134
SW 1/4 SE 1/4 NE 1/4 SW 1/4 FSL OF 1/4 SEC 1600 FWL OF 1/4 SEC 2300
ELEVATION Derrick FL 3152 Ground 3139 Latitude (if known) Longitude (if known)
OPERATOR NAME Merit Energy Company OTC/OCC OPERATOR NO. 18934
ADDRESS 13727 Noel Road, Suite 1200
CITY Dallas STATE TX ZIP 75240

SPUD DATE 09/11/2000
DRLG FINISHED DATE 9/22/2000
DATE OF WELL COMPLETION 12/23/2000
1st PROD DATE 02/09/2001
RECOMP DATE 4/16/2014

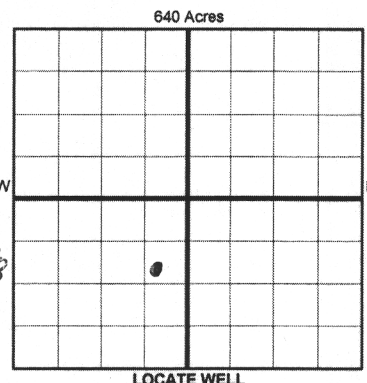

COMPLETION TYPE

☒ SINGLE ZONE
☐ MULTIPLE ZONE
Application Date
COMINGLED
Application Date
LOCATION EXCEPTION
ORDER NO.
INCREASED DENSITY
ORDER NO.

CASING & CEMENT (Form 1002C must be attached)

TYPE	SIZE	WEIGHT	GRADE	FEET	PSI	SAX	TOP OF CMT
CONDUCTOR							
SURFACE	8 5/8	24	A	1528	1000	600	Surface
INTERMEDIATE							
PRODUCTION	5 1/2	15.5	A	2799	1000	200	2122
LINER							
				TOTAL DEPTH	4,600		

PACKER @ _____ BRAND & TYPE _____ PLUG @ _____ TYPE _____ PLUG @ _____ TYPE _____
PACKER @ _____ BRAND & TYPE _____ PLUG @ _____ TYPE _____ PLUG @ _____ TYPE _____

COMPLETION & TEST DATA BY PRODUCING FORMATION

FORMATION (Chase) Guyman-Hugoton No New Frac
SPACING & SPACING ORDER NUMBER 17867 (640) 27014 (640)
CLASS: Oil, Gas, Dry, Inj, Disp, Comm Disp, Svc Gas
PERFORATED INTERVALS 2549-2596 2608
ACID/VOLUME 7 1/2% 2000 gals
FRACTURE TREATMENT (Fluids/Prop Amounts) 15,000 gals 75% N/2

Min Gas Allowable (165:10-17-7)

Gas Purchaser/Measurer

☐

OR

First Sales Date

INITIAL TEST DATA

Oil Allowable (165:10-13-3)

INITIAL TEST DATE 5/3/1906 2-15-01
OIL-BBL/DAY
OIL-GRAVITY (API)
GAS-MCF/DAY 10,200 60
GAS-OIL RATIO CU FT/BBL
WATER-BBL/DAY
PUMPING OR FLOWING flowing Pumping
INITIAL SHUT-IN PRESSURE 412#
CHOKE SIZE
FLOW TUBING PRESSURE

AS SUBMITTED

A record of the formations drilled through, and pertinent remarks are presented on the reverse. I declare that I have knowledge of the contents of this report and am authorized by my organization to make this report, which was prepared by me or under my supervision and direction, with the data and facts stated herein to be true, correct, and complete to the best of my knowledge and belief.

SIGNATURE Katherine McClurkan 4/16/2018 972-628-1660
13727 Noel Road, Suite 1200 Dallas TX 75240
ADDRESS CITY STATE ZIP EMAIL ADDRESS kathy.mcclurkan@meritenergy.com

Give formation names and tops, if available, or descriptions and thickness of formations drilled through. Show intervals cored or drillstem tested.

LEASE NAME

Stonebraker A

WELL NO. 134

NAMES OF FORMATIONS	TOP
SeeWell FKA Frank 29-2	

FOR COMMISSION USE ONLY	
ITD on file	<input type="checkbox"/> YES <input type="checkbox"/> NO
APPROVED	DISAPPROVED
2) Reject Codes	

Were open hole logs run? ☐ yes ☐ no

Date Last log was run _____

Was CO₂ encountered? ☐ yes ☐ no at what depths? _____

Was H₂S encountered? ☐ yes ☐ no at what depths? _____

Were unusual drilling circumstances encountered? ☐ yes ☐ no

If yes, briefly explain below

Other remarks:

640 Acres

A 10x10 grid representing 640 acres. The grid is divided into four 5x5 quadrants by a thick black cross. The text '640 Acres' is centered at the top of the grid.

If more than three drainholes are proposed, attach a separate sheet indicating the necessary information.

Direction must be stated in degrees azimuth.
Please note, the horizontal drainhole and its end
point must be located within the boundaries of the
lease or spacing unit.

Directional surveys are required for all drainholes and directional wells.

640 Acres

SEC	TWP	RGE	COUNTY
Spot Location			
1/4	1/4	1/4	1/4
Measured Total Depth	True Vertical Depth	BHL From Lease, Unit, or Property Line:	

LATERAL #1						
SEC	TWP	RGE	COUNTY			
Spot Location				Feet From 1/4 Sec Lines	FSL	FWL
1/4	1/4	1/4	1/4			
Depth of Deviation		Radius of Turn		Direction	Total Length	
Measured Total Depth		True Vertical Depth		BHL From Lease, Unit, or Property Line:		

SEC		TWP		RGE		COUNTY	
Spot Location							
1/4		1/4		1/4		1/4	
Feet From 1/4 Sec Lines		FSL		FWL			
Depth of Deviation		Radius of Turn		Direction		Total Length	
Measured Total Depth		True Vertical Depth		BHL From Lease, Unit, or Property Line:			

EXTERNAL #						
SEC	TWP	RGE	COUNTY			
Spot Location						
1/4	1/4	1/4	1/4	Feet From 1/4 Sec Lines	FSL	FWL
Depth of Deviation		Radius of Turn		Direction	Total Length	
Measured Total Depth		True Vertical Depth		BHL From Lease, Unit, or Property Line:		

API NO. 139-231710004
OTC PROD. 139-013962-2
UNIT NO.

(PLEASE TYPE OR USE BLACK INK ONLY)

OKLAHOMA CORPORATION COMMISSION

Oil & Gas Conservation Division

Post Office Box 52000

Oklahoma City, Oklahoma 73152-2000

Rule 165:10-3-25

RECEIVED

APR 25 2018

OKLAHOMA CORPORATION COMMISSION

Form 1002A

Rev. 2009

ORIGINAL
☒ AMENDED (Reason)

Return status to gas

COMPLETION REPORT

TYPE OF DRILLING OPERATION

☒ STRAIGHT HOLE ☐ DIRECTIONAL HOLE ☐ HORIZONTAL HOLE
☐ SERVICE WELL

If directional or horizontal, see reverse for bottom hole location.

COUNTY Texas SEC 29 TWP 03N RGE 13ECM
LEASE NAME Stonebraker A WELL NO. 134
SW 1/4 SE 1/4 NE 1/4 SW 1/4 FSL OF 1/4 SEC 1600 FWL OF 1/4 SEC 2300
ELEVATION Derrick FL 3152 Ground 3139 Latitude (if known) Longitude (if known)
OPERATOR NAME Merit Energy Company OTC/OCC OPERATOR NO. 18934
ADDRESS 13727 Noel Road, Suite 1200
CITY Dallas STATE TX ZIP 75240

SPUD DATE 09/11/2000
DRLG FINISHED DATE 9/22/2000
DATE OF WELL COMPLETION 12/23/2000
1st PROD DATE 02/09/2001
RECOMP DATE 4-16-18

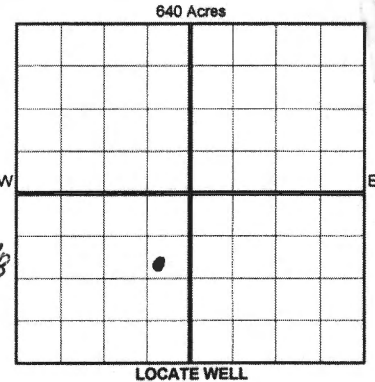

COMPLETION TYPE

☒ SINGLE ZONE
☐ MULTIPLE ZONE
Application Date
COMINGLED
Application Date
LOCATION EXCEPTION
ORDER NO.
INCREASED DENSITY
ORDER NO.

CASING & CEMENT (Form 1002C must be attached)

TYPE	SIZE	WEIGHT	GRADE	FEET	PSI	SAX	TOP OF CMT
CONDUCTOR							
SURFACE	8 5/8	24	A	1528	1000	600	Surface
INTERMEDIATE							
PRODUCTION	5 1/2	15.5	A	2799	1000	200	2122
LINER							
TOTAL DEPTH						4,600	

PACKER @ BRAND & TYPE PLUG @ TYPE PLUG @ TYPE
PACKER @ BRAND & TYPE PLUG @ TYPE PLUG @ TYPE

COMPLETION & TEST DATA BY PRODUCING FORMATION

FORMATION Chase GUYMAN - HUGGTON No New Frac
SPACING & SPACING ORDER NUMBER 17867 (640) 27844 (640)
CLASS: Oil, Gas, Dry, Inj, Disp, Comm Disp, Svc Gas
PERFORATED INTERVALS 2549-2596 2608
ACID/VOLUME 7 1/2% 2000 gals
FRACTURE TREATMENT (Fluids/Prop Amounts) 15,000 gals 75% N1/2

Min Gas Allowable (165:10-17-7)

Gas Purchaser/Measurer

☐

OR

First Sales Date

Oil Allowable (165:10-13-3)

INITIAL TEST DATA

INITIAL TEST DATE 5/3/1906 275-01
OIL-BBL/DAY
OIL-GRAVITY (API)
GAS-MCF/DAY 10,200 60
GAS-OIL RATIO CU FT/BBL
WATER-BBL/DAY
PUMPING OR FLOWING flowing Pumping
INITIAL SHUT-IN PRESSURE 412#
CHOKE SIZE
FLOW TUBING PRESSURE

AS SUBMITTED

A record of the formations drilled through, and pertinent remarks are presented on the reverse. I declare that I have knowledge of the contents of this report and am authorized by my organization to make this report, which was prepared by me or under my supervision and direction, with the data and facts stated herein to be true, correct, and complete to the best of my knowledge and belief.

Katherine McClurkan
SIGNATURE NAME (PRINT OR TYPE) 4/16/2018 972-628-1660
13727 Noel Road, Suite 1200 Dallas TX 75240
ADDRESS CITY STATE ZIP DATE PHONE NUMBER
kathy.mcclurkan@meritenergy.com
EMAIL ADDRESS