

Oklahoma Corporation Commission
Oil & Gas Conservation Division
Post Office Box 52000
Oklahoma City, Oklahoma 73152-2000
Rule 165: 10-3-25

Form 1002A

API No.: 35139302200002

Completion Report

Spud Date: April 23, 1965

OTC Prod. Unit No.:

Drilling Finished Date: May 12, 1965

Amended

1st Prod Date: May 19, 1965

Amend Reason: RETURN STATUS TO OIL

Completion Date: May 21, 1965

Recomplete Date: December 03, 1975

Drill Type: STRAIGHT HOLE

Well Name: POSTLE MORROW L-3 UNIT 904

Purchaser/Measurer:

Location: TEXAS 29 5N 13E CM
C SE NW
660 FSL 1980 FWL of 1/4 SEC
Derrick Elevation: 3373 Ground Elevation: 3366

First Sales Date:

Operator: MERIT ENERGY COMPANY 18934

13727 NOEL RD STE 1200
DALLAS, TX 75240-7312

Completion Type		Location Exception		Increased Density	
X	Single Zone	Order No		Order No	
	Multiple Zone	There are no Location Exception records to display.		There are no Increased Density records to display.	
	Commingled				

Casing and Cement							
Type	Size	Weight	Grade	Feet	PSI	SAX	Top of CMT
SURFACE	8 5/8	24	J-55	1727		700	SURFACE
PRODUCTION	4 1/2	9.5	J-55	6250		200	5550

Liner								
Type	Size	Weight	Grade	Length	PSI	SAX	Top Depth	Bottom Depth
There are no Liner records to display.								

Total Depth: 6480

Packer	
Depth	Brand & Type
There are no Packer records to display.	

Plug	
Depth	Plug Type
There are no Plug records to display.	

Initial Test Data										
Test Date	Formation	Oil BBL/Day	Oil-Gravity (API)	Gas MCF/Day	Gas-Oil Ratio Cu FT/BBL	Water BBL/Day	Pumpin or Flowing	Initial Shut-In Pressure	Choke Size	Flow Tubing Pressure
Dec 03, 1975	MORROW UP	13		35	2691	1	PUMPING			

Completion and Test Data by Producing Formation			
Formation Name: MORROW UP		Code: 402MRRWU	Class: OIL
Spacing Orders		Perforated Intervals	
Order No	Unit Size	From	To
128530	UNIT	6142	6177
Acid Volumes		Fracture Treatments	
There are no Acid Volume records to display.		There are no Fracture Treatments records to display.	

Formation	Top
SURFACE CLAY AND SAND	0
SAND	75
RED BEDS	445
SHALE AND SHELLS	954
GYP	1025
SAND	1160
RED BEDS AND SHELLS	1365
SHALE AND SHELLS	1728
SHALE AND LIME	2305
SHALE AND SHELLS	2515
SHALE AND LIME	2945
SHALE AND SHELLS	3115
LIME	3235
LIME AND SHALE	5309
LIME	5392
LIME AND SHALE	5502
SHALE WITH SAND	6037
LIME AND SHALE	6270
SHALE AND SAND	6382

Were open hole logs run? No
Date last log run:

Were unusual drilling circumstances encountered? No
Explanation:

Other Remarks
There are no Other Remarks.

FOR COMMISSION USE ONLY	
Status: Accepted	1139741

API NO. 139-30220
OTC PROD.
UNIT NO.

(PLEASE TYPE OR USE BLACK INK ONLY)

OKLAHOMA CORPORATION COMMISSION

Oil & Gas Conservation Division

Post Office Box 52000

Oklahoma City, Oklahoma 73152-2000

Rule 165:10-3-25

RECEIVED

MAY 02 2018

OKLAHOMA CORPORATION COMMISSION

☐ ORIGINAL
☒ AMENDED (Reason)

Return status to Oil

COMPLETION REPORT

TYPE OF DRILLING OPERATION

☒ STRAIGHT HOLE ☐ DIRECTIONAL HOLE ☐ HORIZONTAL HOLE
☐ SERVICE WELL

If directional or horizontal, see reverse for bottom hole location.

COUNTY Texas SEC 29 TWP 05N RGE 13 ECM
LEASE NAME Postle Morrow L-3 Unit
WELL NO. 904
1/4 C 1/4 SE 1/4 NW 1/4 FSL OF 660 FWL OF 1980
ELEVATION 3373 Ground 3366
Derrick FL. Latitude (if known) Longitude (if known)
OPERATOR NAME Merit Energy Company OTC/OCC OPERATOR NO. 18934
ADDRESS 13727 Noel Road, Suite 1200
CITY Dallas STATE TX ZIP 75240

SPUD DATE 04/23/1965
DRLG FINISHED DATE 05/12/1965
DATE OF WELL COMPLETION 05/21/1965
1st PROD DATE 05/19/1965
RECOMP DATE 12/03/1975

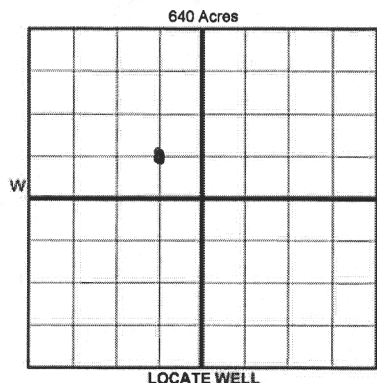

COMPLETION TYPE

☒ SINGLE ZONE
☐ MULTIPLE ZONE
Application Date
COMINGLED
Application Date
LOCATION EXCEPTION
ORDER NO.
INCREASED DENSITY
ORDER NO.

CASING & CEMENT (Form 1002C must be attached)

TYPE	SIZE	WEIGHT	GRADE	FEET	PSI	SAX	TOP OF CMT
CONDUCTOR							
SURFACE	8 5/8	24	J-55	1727		700	Surface
INTERMEDIATE							
PRODUCTION	4 1/2	9.5	J-55	6250		200	5550
LINER							
						TOTAL DEPTH	6,480

PACKER @ _____ BRAND & TYPE _____ PLUG @ _____ TYPE _____ PLUG @ _____ TYPE _____
PACKER @ _____ BRAND & TYPE _____ PLUG @ _____ TYPE _____ PLUG @ _____ TYPE _____

COMPLETION & TEST DATA BY PRODUCING FORMATION

FORMATION Upper Morrow (keyes)
SPACING & SPACING ORDER NUMBER Unit 128530
CLASS: Oil, Gas, Dry, [n], Disp, Comm Disp, Svc Oil
6142-6177
PERFORATED INTERVALS
ACID/VOLUME
FRACTURE TREATMENT (Fluids/Prop Amounts)

Min Gas Allowable (165:10-17-7)

Gas Purchaser/Measurer

☐

OR

First Sales Date

Oil Allowable (165:10-13-3)

INITIAL TEST DATA

INITIAL TEST DATE	12/3/1975
OIL-BBL/DAY	13
OIL-GRAVITY (API)	
GAS-MCF/DAY	35
GAS-OIL RATIO CU FT/BBL	2692
WATER-BBL/DAY	1
PUMPING OR FLOWING	Pumping
INITIAL SHUT-IN PRESSURE	
CHOKE SIZE	
FLOW TUBING PRESSURE	

AS SUBMITTED

A record of the formations drilled through, and pertinent remarks are presented on the reverse. I declare that I have knowledge of the contents of this report and am authorized by my organization to make this report, which was prepared by me or under my supervision and direction, with the data and facts stated herein to be true, correct, and complete to the best of my knowledge and belief.

SIGNATURE Katherine McClurkan
13727 Noel Road, Suite 1200 Dallas TX 75240
ADDRESS CITY STATE ZIP
DATE 4/16/2018 PHONE NUMBER 972-628-1660
EMAIL ADDRESS kathy.mcclurkan@meritenergy.com

PLEASE TYPE OR USE BLACK INK ONLY

FORMATION RECORD

Give formation names and tops, if available, or descriptions and thickness of formations drilled through. Show intervals cored or drillstem tested.

NAMES OF FORMATIONS	TOP
Surface Clay & Sand	0
Sand	75
Red Bed	445
Shale & Shells	954
Gyp	1,025
Sand	1,160
Red Bed & Shells	1,365
Shale & Shells	1,728
Shale & Lime	2,305
Shale & Shells	25,515
Shale & Lime	2,945
Shale & Shells	3,115
Lime	3,235
Lime & Shale	5,309
See Remarks Below	

LEASE NAME Postle Morrow L-3 Ut WELL NO. 904

FOR COMMISSION USE ONLY	
ITD on file <input type="checkbox"/> YES <input type="checkbox"/> NO	
APPROVED _____ DISAPPROVED _____	2) Reject Codes

Were open hole logs run?	_____ yes _____ no
Date Last log was run	_____
Was CO ₂ encountered?	_____ yes _____ no at what depths? _____
Was H ₂ S encountered?	_____ yes _____ no at what depths? _____
Were unusual drilling circumstances encountered?	_____ yes _____ no
If yes, briefly explain below	

Other remarks: Lime 5392'; Lime & Shale 5502'; Shale w/Sand 6037'; Lime & Shale 6270'; Shale & Sand 6382'

640 Acres

If more than three drainholes are proposed, attach a separate sheet indicating the necessary information.

Direction must be stated in degrees azimuth.
Please note, the horizontal drainhole and its end point must be located within the boundaries of the lease or spacing unit.

Directional surveys are required for all drainholes and directional wells.

640 Acres

BOTTOM HOLE LOCATION FOR DIRECTIONAL HOLE

SEC	TWP	RGE	COUNTY
Spot Location			
1/4	1/4	1/4	1/4
Measured Total Depth		True Vertical Depth	BHL From Lease, Unit, or Property Line:

BOTTOM HOLE LOCATION FOR HORIZONTAL HOLE: (LATERALS)

LATERAL #1

SEC	TWP	RGE	COUNTY
Spot Location			
1/4	1/4	1/4	1/4
Depth of Deviation		Radius of Turn	Direction
Measured Total Depth		True Vertical Depth	Total Length
			BHL From Lease, Unit, or Property Line:

LATERAL #2

SEC	TWP	RGE	COUNTY
Spot Location			
1/4	1/4	1/4	1/4
Depth of Deviation		Radius of Turn	Direction
Measured Total Depth		True Vertical Depth	Total Length
			BHL From Lease, Unit, or Property Line:

LATERAL #3

SEC	TWP	RGE	COUNTY
Spot Location			
1/4	1/4	1/4	1/4
Depth of Deviation		Radius of Turn	Direction
Measured Total Depth		True Vertical Depth	Total Length
			BHL From Lease, Unit, or Property Line: