

Oklahoma Corporation Commission
Oil & Gas Conservation Division
Post Office Box 52000
Oklahoma City, Oklahoma 73152-2000
Rule 165: 10-3-25

Form 1002A

API No.: 35139002230002

Completion Report

Spud Date: May 16, 1960

OTC Prod. Unit No.:

Drilling Finished Date: June 14, 1960

Amended

1st Prod Date: June 19, 1960

Amend Reason: RETURN STATUS TO GAS

Completion Date: June 24, 1960

Drill Type: STRAIGHT HOLE

Well Name: WILSON "E" 1

Purchaser/Measurer:

Location: TEXAS 34 5N 15E CM
C SE NW
660 FSL 1980 FWL of 1/4 SEC
Derrick Elevation: 3125 Ground Elevation: 3117

First Sales Date:

Operator: MERIT ENERGY COMPANY 18934

13727 NOEL RD STE 1200
DALLAS, TX 75240-7312

Completion Type		Location Exception		Increased Density	
X	Single Zone	Order No		Order No	
	Multiple Zone	There are no Location Exception records to display.		There are no Increased Density records to display.	
	Commingled				

Casing and Cement								
Type		Size	Weight	Grade	Feet	PSI	SAX	Top of CMT
SURFACE		8 5/8	24, 32		2884		900	SURFACE
PRODUCTION		5 1/2	14, 15.5		6194		800	5450

Liner								
Type	Size	Weight	Grade	Length	PSI	SAX	Top Depth	Bottom Depth
There are no Liner records to display.								

Total Depth: 6812

Packer		Plug	
Depth	Brand & Type	Depth	Plug Type
There are no Packer records to display.		There are no Plug records to display.	

Initial Test Data										
Test Date	Formation	Oil BBL/Day	Oil-Gravity (API)	Gas MCF/Day	Gas-Oil Ratio Cu FT/BBL	Water BBL/Day	Pumpin or Flowing	Initial Shut-In Pressure	Choke Size	Flow Tubing Pressure
Jun 24, 1960	MORROW			3500			FLOWING	1381		

Completion and Test Data by Producing Formation

Formation Name: MORROW

Code: 402MRRW

Class: GAS

Spacing Orders

Order No

Unit Size

There are no Spacing Order records to display.

Perforated Intervals

From

To

6010

6111

Acid Volumes

There are no Acid Volume records to display.

Fracture Treatments

There are no Fracture Treatments records to display.

Formation	Top
CLAY AND SAND	0
RED BEDS	407
GYP AND ANHYDRITE	927
SAND	1030
SAND AND SHALE	1083
ANHYDRITE AND SHALE	1200
ANHYDRITE AND GYP	1600
ANHYDRITE, SHALE, AND GYP	1797
ANHYDRITE AND LIME	1965
ANHYDRITE	2166
ANHYDRITE, LIME AND SHALE	2196
ANHYDRITE AND LIME	2355
ANHYDRITE	2420
ANHYDRITE AND LIME	2487
ANHYDRITE, LIME, SHALE AND DOLOMITE	2745
LIME	2885
LIME AND DOLOMITE	2933
LIME CHALK	3030
LIME	3145
LIME, SHALE, AND SAND	4252
LIME	4359
SHALE AND LIME	5509
SHALE	5633
LIME AND SHALE	5651
LIME	5710
LIME AND SHALE	5844
LIME	6040
LIME AND SHALE	6117
SAND AND SHALE	6395
SAND, LIME, AND SHALE	6436

Were open hole logs run? No

Date last log run:

Were unusual drilling circumstances encountered? No

Explanation:

LIME	6495
LIME AND SAND	6732
LIME	5788

Other Remarks
There are no Other Remarks.

FOR COMMISSION USE ONLY	
Status: Accepted	1139749

API NO. 139-00223
OTC PROD.
UNIT NO.

(PLEASE TYPE OR USE BLACK INK ONLY)

OKLAHOMA CORPORATION COMMISSION

Oil & Gas Conservation Division

Post Office Box 52000

Oklahoma City, Oklahoma 73152-2000

Rule 165:10-3-25

RECEIVED

MAY 03 2018

OKLAHOMA CORPORATION COMMISSION

Form 1002A

Rev. 2009

☐ ORIGINAL
☒ AMENDED (Reason)

Return status to Gas

COMPLETION REPORT

TYPE OF DRILLING OPERATION

☒ STRAIGHT HOLE ☐ DIRECTIONAL HOLE ☐ HORIZONTAL HOLE
☐ SERVICE WELL

If directional or horizontal, see reverse for bottom hole location.

COUNTY Texas SEC 34 TWP 05N RGE 15ECM
LEASE NAME Wilson E WELL NO. 1
1/4 C 1/4 SE 1/4 NW 1/4 FSL OF 1/4 SEC 660 FWL OF 1/4 SEC 1980
ELEVATION Derrick FL 3125 Ground 3117 Latitude (if known) Longitude (if known)
OPERATOR NAME Merit Energy Company OTC/OCC OPERATOR NO. 18934
ADDRESS 13727 Noel Road, Suite 1200
CITY Dallas STATE TX ZIP 75240

SPUD DATE 05/16/1960
DRLG FINISHED DATE 06/14/1960
DATE OF WELL COMPLETION 06/24/1960
1st PROD DATE 06/19/1960
RECOMP DATE

640 Acres
LOCATE WELL

COMPLETION TYPE

☒ SINGLE ZONE
☐ MULTIPLE ZONE
Application Date
COMINGLED
Application Date
LOCATION EXCEPTION
ORDER NO.
INCREASED DENSITY
ORDER NO.

CASING & CEMENT (Form 1002C must be attached)

TYPE	SIZE	WEIGHT	GRADE	FEET	PSI	SAX	TOP OF CMT
CONDUCTOR							
SURFACE	8 5/8	24, 32		2884		900	Surface
INTERMEDIATE							
PRODUCTION	5 1/2	14, 15.5		6194		800	5450
LINER							
						TOTAL DEPTH	6,812

PACKER @ BRAND & TYPE PLUG @ TYPE PLUG @ TYPE
PACKER @ BRAND & TYPE PLUG @ TYPE PLUG @ TYPE

COMPLETION & TEST DATA BY PRODUCING FORMATION

FORMATION Morrow
SPACING & SPACING ORDER NUMBER
CLASS: Oil, Gas, Dry, Inj, Disp, Comm Disp, Svc Gas
PERFORATED INTERVALS 6010-6111 40 shots
ACID/VOLUME
FRACTURE TREATMENT (Fluids/Prop Amounts)

Min Gas Allowable (165:10-17-7) Gas Purchaser/Measurer
OR
Oil Allowable (165:10-13-3) First Sales Date

INITIAL TEST DATA

INITIAL TEST DATE 6/24/1960
OIL-BBL/DAY
OIL-GRAVITY (API)
GAS-MCF/DAY 3500mcf
GAS-OIL RATIO CU FT/BBL
WATER-BBL/DAY
PUMPING OR FLOWING Flowing
INITIAL SHUT-IN PRESSURE 1381
CHOKE SIZE
FLOW TUBING PRESSURE

AS SUBMITTED

A record of the formations drilled through, and pertinent remarks are presented on the reverse. I declare that I have knowledge of the contents of this report and am authorized by my organization to make this report, which was prepared by me or under my supervision and direction, with the data and facts stated herein to be true, correct, and complete to the best of my knowledge and belief.

Katherine McClurkan
SIGNATURE NAME (PRINT OR TYPE)
13727 Noel Road, Suite 1200 Dallas TX 75240
ADDRESS CITY STATE ZIP
4/16/2018 972-628-1660
DATE PHONE NUMBER
kathy.mcclurkan@meritenergy.com
EMAIL ADDRESS

PLEASE TYPE OR USE BLACK INK ONLY
FORMATION RECORD

Give formation names and tops, if available, or descriptions and thickness of formations drilled through. Show intervals cored or drillstem tested.

NAMES OF FORMATIONS	TOP
Clay & Sand	0
Red Bed	407
Gyp & Anhydrate	927
Sand	1,030
Sand & Shale	1,083
Anydrate & Shale	1,200
Anydrate & Gyp	1,600
Anydrate & Shale & Gyp	1,797
Anydrate & Lime	1,965
Anydrate	2,166
Anydrate & Lime & Shale	2,196
Anydrate & Lime	2,355
Anydrate	2,420
Anydrate & Lime	2,487
See Remarks	

LEASE NAME Wilson E WELL NO. 1

FOR COMMISSION USE ONLY		
ITD on file	<input type="checkbox"/> YES	<input type="checkbox"/> NO
APPROVED	DISAPPROVED	2) Reject Codes
<hr/> <hr/> <hr/> <hr/> <hr/>		

Were open hole logs run?	<input type="checkbox"/> yes	<input type="checkbox"/> no
Date Last log was run	<hr/>	
Was CO ₂ encountered?	<input type="checkbox"/> yes	<input type="checkbox"/> no at what depths? <hr/>
Was H ₂ S encountered?	<input type="checkbox"/> yes	<input type="checkbox"/> no at what depths? <hr/>
Were unusual drilling circumstances encountered?	<input type="checkbox"/> yes	<input type="checkbox"/> no
If yes, briefly explain below		

Other remarks: Anydrate & Lime & Shale & Dolomite 2745; Lime 2885; Lime & Dolomite 293; Lime Chalk 3030; Lime 3145; Line & Shale & Sand 4252; lime 4359; Shale & Lime 5509; Shale 5633; Lime & Shale 5651; Lime 5710; Lime & Shale 5844; Lime 6040; Lime & Shale 6117; Sand & Shale 6395; Sand & Lime & Shale 6436; Lime 6495; Lime & Sand 6732; Lime 5788 (TD 6812)

640 Acres

If more than three drainholes are proposed, attach a separate sheet indicating the necessary information.

Direction must be stated in degrees azimuth.
Please note, the horizontal drainhole and its end point must be located within the boundaries of the lease or spacing unit.

Directional surveys are required for all drainholes and directional wells.

640 Acres

BOTTOM HOLE LOCATION FOR DIRECTIONAL HOLE

SEC	TWP	RGE	COUNTY
Spot Location			
1/4	1/4	1/4	1/4
Measured Total Depth		True Vertical Depth	BHL From Lease, Unit, or Property Line:

BOTTOM HOLE LOCATION FOR HORIZONTAL HOLE: (LATERALS)

LATERAL #1

SEC	TWP	RGE	COUNTY
Spot Location			
1/4	1/4	1/4	1/4
Depth of Deviation		Radius of Turn	Direction
Measured Total Depth		True Vertical Depth	Total Length
			BHL From Lease, Unit, or Property Line:

LATERAL #2

SEC	TWP	RGE	COUNTY
Spot Location			
1/4	1/4	1/4	1/4
Depth of Deviation		Radius of Turn	Direction
Measured Total Depth		True Vertical Depth	Total Length
			BHL From Lease, Unit, or Property Line:

LATERAL #3

SEC	TWP	RGE	COUNTY
Spot Location			
1/4	1/4	1/4	1/4
Depth of Deviation		Radius of Turn	Direction
Measured Total Depth		True Vertical Depth	Total Length
			BHL From Lease, Unit, or Property Line:

API NO. 139-00223
OTC PROD. UNIT NO. 139-014019-1

(PLEASE TYPE OR USE BLACK INK ONLY)

OKLAHOMA CORPORATION COMMISSION

Oil & Gas Conservation Division

Post Office Box 52000

Oklahoma City, Oklahoma 73152-2000

Rule 165:10-3-25

RECEIVED

MAY 03 2018

OKLAHOMA CORPORATION COMMISSION

Form 1002A

Rev. 2009

1016EZ

ORIGINAL
X AMENDED (Reason)

Return status to Gas

COMPLETION REPORT

TYPE OF DRILLING OPERATION

X STRAIGHT HOLE ☐ DIRECTIONAL HOLE ☐ HORIZONTAL HOLE
☐ SERVICE WELL

If directional or horizontal, see reverse for bottom hole location.

COUNTY Texas SEC 34 TWP 05N RGE 15ECM
LEASE NAME Wilson E WELL NO. 1
1/4 C 1/4 SE 1/4 NW 1/4 FSL OF 1/4 SEC 660 FWL OF 1/4 SEC 1980
ELEVATION Derrick FL 3125 Ground 3117 Latitude (if known) Longitude (if known)
OPERATOR NAME Merit Energy Company OTC/OCC OPERATOR NO. 18934
ADDRESS 13727 Noel Road, Suite 1200
CITY Dallas STATE TX ZIP 75240

SPUD DATE 05/16/1960

DRLG FINISHED DATE 06/14/1960

DATE OF WELL COMPLETION 06/24/1960

1st PROD DATE 06/19/1960

RECOMP DATE

Longitude (if known)

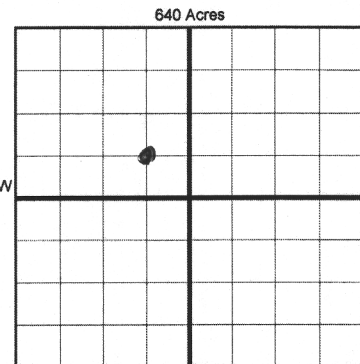

LOCATE WELL

COMPLETION TYPE

X SINGLE ZONE
☐ MULTIPLE ZONE
Application Date
COMINGLED
Application Date
LOCATION EXCEPTION
ORDER NO.
INCREASED DENSITY
ORDER NO.

CASING & CEMENT (Form 1002C must be attached)

TYPE	SIZE	WEIGHT	GRADE	FEET	PSI	SAX	TOP OF CMT
CONDUCTOR							
SURFACE	8 5/8	24, 32		2884		900	Surface
INTERMEDIATE							
PRODUCTION	5 1/2	14, 15.5		6194		800	5450
LINER							
						TOTAL DEPTH	6,812

PACKER @ BRAND & TYPE PLUG @ TYPE PLUG @ TYPE
PACKER @ BRAND & TYPE PLUG @ TYPE PLUG @ TYPE

COMPLETION & TEST DATA BY PRODUCING FORMATION

FORMATION Morrow
SPACING & SPACING ORDER NUMBER
CLASS: Oil, Gas, Dry, Inj, Disp, Comm Disp, Svc
PERFORATED INTERVALS 6010-6111
40 shots
ACID/VOLUME
FRACTURE TREATMENT (Fluids/Prop Amounts)

Corrected back to producing gas classification - original status reinstated

Min Gas Allowable (165:10-17-7)

Gas Purchaser/Measurer

☐

OR

First Sales Date

INITIAL TEST DATA

Oil Allowable (165:10-13-3)

INITIAL TEST DATE 6/24/1960
OIL-BBL/DAY
OIL-GRAVITY (API)
GAS-MCF/DAY 3500mcf
GAS-OIL RATIO CU FT/BBL
WATER-BBL/DAY
PUMPING OR FLOWING Flowing
INITIAL SHUT-IN PRESSURE 1381
CHOKE SIZE
FLOW TUBING PRESSURE

AS SUBMITTED

2014: 1317

A record of the formations drilled through, and pertinent remarks are presented on the reverse. I declare that I have knowledge of the contents of this report and am authorized by my organization to make this report, which was prepared by me or under my supervision and direction, with the data and facts stated herein to be true, correct, and complete to the best of my knowledge and belief.

Katherine McClurkan

Katherine McClurkan

4/16/2018

972-628-1660

SIGNATURE

NAME (PRINT OR TYPE)

DATE

PHONE NUMBER

13727 Noel Road, Suite 1200

Dallas

TX

75240

kathy.mcclurkan@meritenergy.com

ADDRESS

CITY

STATE

ZIP

EMAIL ADDRESS

Handwritten signatures and initials.