

Oklahoma Corporation Commission
Oil & Gas Conservation Division
Post Office Box 52000
Oklahoma City, Oklahoma 73152-2000
Rule 165: 10-3-25

Form 1002A

API No.: 35139214240004

Completion Report

Spud Date: November 05, 1980

OTC Prod. Unit No.:

Drilling Finished Date: November 21, 1980

Amended

1st Prod Date: February 26, 2003

Amend Reason: RETURN STATUS TO GAS

Completion Date: January 19, 1981

Recomplete Date: April 16, 2018

Drill Type: STRAIGHT HOLE

Well Name: INTERSTATE A 15

Purchaser/Measurer:

Location: TEXAS 32 5N 12E CM
C SE SE
660 FSL 1980 FWL of 1/4 SEC
Derrick Elevation: 3418 Ground Elevation: 3411

First Sales Date:

Operator: MERIT ENERGY COMPANY 18934

13727 NOEL RD STE 1200
DALLAS, TX 75240-7312

Completion Type		Location Exception		Increased Density	
X	Single Zone	Order No		Order No	
	Multiple Zone	There are no Location Exception records to display.		There are no Increased Density records to display.	
	Commingled				

Casing and Cement							
Type	Size	Weight	Grade	Feet	PSI	SAX	Top of CMT
SURFACE	8 5/8	24	A	1589		850	SURFACE
PRODUCTION	5 1/2	14 / 15.5	A	6031		150	5380

Liner								
Type	Size	Weight	Grade	Length	PSI	SAX	Top Depth	Bottom Depth
There are no Liner records to display.								

Total Depth: 6032

Packer	
Depth	Brand & Type
There are no Packer records to display.	

Plug	
Depth	Plug Type
There are no Plug records to display.	

Initial Test Data										
Test Date	Formation	Oil BBL/Day	Oil-Gravity (API)	Gas MCF/Day	Gas-Oil Ratio Cu FT/BBL	Water BBL/Day	Pumpin or Flowing	Initial Shut-In Pressure	Choke Size	Flow Tubing Pressure
Feb 26, 2003	KEYES			30			PUMPING			

Completion and Test Data by Producing Formation			
Formation Name: KEYES		Code: 402KEYS	Class: GAS
Spacing Orders		Perforated Intervals	
Order No	Unit Size	From	To
There are no Spacing Order records to display.		5949	5956
Acid Volumes		Fracture Treatments	
There are no Acid Volume records to display.		There are no Fracture Treatments records to display.	

Formation	Top
CLAY AND SAND	0
RED BEDS	540
RED BEDS, SAND AND SHALE	905
ANHYDRITE	1580
SHALE	1590
LIME AND SHALE	2855
TD	5032
PBTD	5992

Were open hole logs run? No
Date last log run:

Were unusual drilling circumstances encountered? No
Explanation:

Other Remarks
PRODUCTION CASING FIRST STAGE - 6,032' OF 5 1/2" CASING SET @ 6,031', CEMENT WITH 150 SACKS CEMENT, TOP OF CEMENT 5,380'; SECOND STAGE - DV TOOL @ 5,238', CEMENT WITH 150 SACKS, TOP OF CEMENT 4,395'

FOR COMMISSION USE ONLY	
Status: Accepted	1139648

API NO. 139-21424
OTC PROD.
UNIT NO.

(PLEASE TYPE OR USE BLACK INK ONLY)

OKLAHOMA CORPORATION COMMISSION

Oil & Gas Conservation Division

Post Office Box 52000

Oklahoma City, Oklahoma 73152-2000

Rule 165:10-3-25

COMPLETION REPORT

RECEIVED

APR 25 2018

OKLAHOMA CORPORATION COMMISSION

Form 1002A

Rev. 2009

ORIGINAL
☒ AMENDED (Reason)

Return status to Gas

TYPE OF DRILLING OPERATION

☒ STRAIGHT HOLE ☐ DIRECTIONAL HOLE ☐ HORIZONTAL HOLE
☐ SERVICE WELL

If directional or horizontal, see reverse for bottom hole location.

COUNTY Texas SEC 32 TWP 05N RGE 12ECM
LEASE NAME Interstate A WELL NO. 15
1/4 C 1/4 SE 1/4 SE 1/4 FSL OF 1/4 SEC 660 FWL OF 1/4 SEC 1980
ELEVATION Derrick FL 3418 Ground 3411 Latitude (if known) Longitude (if known)
OPERATOR NAME Merit Energy Company OTC/OCC OPERATOR NO. 18934
ADDRESS 13727 Noel Road, Suite 1200
CITY Dallas STATE TX ZIP 75240

640 Acres
W E
LOCATE WELL

COMPLETION TYPE

☒ SINGLE ZONE
☐ MULTIPLE ZONE
Application Date
☐ COMMINGLED
Application Date
LOCATION EXCEPTION
ORDER NO.
INCREASED DENSITY
ORDER NO.

CASING & CEMENT (Form 1002C must be attached)

TYPE	SIZE	WEIGHT	GRADE	FEET	PSI	SAX	TOP OF CMT
CONDUCTOR							
SURFACE	8 5/8	24	A	1589		850	Surface
INTERMEDIATE							
PRODUCTION	5 1/2	14/15.5	A	6031		150	5380
LINER							
TOTAL DEPTH						6,032	

PACKER @ BRAND & TYPE PLUG @ TYPE PLUG @ TYPE
PACKER @ BRAND & TYPE PLUG @ TYPE PLUG @ TYPE

COMPLETION & TEST DATA BY PRODUCING FORMATION

FORMATION Keys
SPACING & SPACING ORDER NUMBER State Wide 1-501
CLASS: Oil, Gas, Dry, Inj, Disp, Comm Disp, Svc Gas
5949-5956
PERFORATED INTERVALS
ACID/VOLUME
FRACTURE TREATMENT (Fluids/Prop Amounts)

Min Gas Allowable (165:10-17-7) Gas Purchaser/Measurer
OR
Oil Allowable (165:10-13-3) First Sales Date

INITIAL TEST DATA

INITIAL TEST DATE 2/26/2003
OIL-BBL/DAY 0
OIL-GRAVITY (API)
GAS-MCF/DAY 30
GAS-OIL RATIO CU FT/BBL
WATER-BBL/DAY
PUMPING OR FLOWING Pumping
INITIAL SHUT-IN PRESSURE
CHOKE SIZE
FLOW TUBING PRESSURE

AS SUBMITTED

A record of the formations drilled through, and pertinent remarks are presented on the reverse. I declare that I have knowledge of the contents of this report and am authorized by my organization to make this report, which was prepared by me or under my supervision and direction, with the data and facts stated herein to be true, correct, and complete to the best of my knowledge and belief.

Katherine McClurkan
SIGNATURE NAME (PRINT OR TYPE) DATE 4/16/2018 PHONE NUMBER 972-628-1660
13727 Noel Road, Suite 1200 Dallas TX 75240
ADDRESS CITY STATE ZIP EMAIL ADDRESS kathy.mcclurkan@meritenergy.com

PLEASE TYPE OR USE BLACK INK ONLY

FORMATION RECORD

Give formation names and tops, if available, or descriptions and thickness of formations drilled through. Show intervals cored or drillstem tested.

NAMES OF FORMATIONS	TOP
Clay & Sand	0
Red Bed	540
Red Bed, Sand & Shale	905
Anhydrite	1,580
Shale	1,590
Lime & Shale	2,855
TD	5,032
PBTD	5,992

LEASE NAME Interstate A WELL NO. 15

FOR COMMISSION USE ONLY	
ITD on file <input type="checkbox"/> YES <input type="checkbox"/> NO	
APPROVED _____ DISAPPROVED _____	2) Reject Codes

Were open hole logs run?	_____ yes _____ no
Date Last log was run	_____
Was CO ₂ encountered?	_____ yes _____ no at what depths? _____
Was H ₂ S encountered?	_____ yes _____ no at what depths? _____
Were unusual drilling circumstances encountered?	_____ yes _____ no
If yes, briefly explain below	

Other remarks: Productin CSG 1st Stage= 6032' of 5 1/2" csg set @ 6031' cmt w/150 sx cmt, TOC 5380'
2nd Stage=DV Tool@5238', cmt w/150 sx TOC 4395'

640 Acres

If more than three drainholes are proposed, attach a separate sheet indicating the necessary information.

Direction must be stated in degrees azimuth.

Please note, the horizontal drainhole and its end point must be located within the boundaries of the lease or spacing unit.

Directional surveys are required for all drainholes and directional wells.

640 Acres

BOTTOM HOLE LOCATION FOR DIRECTIONAL HOLE

SEC	TWP	RGE	COUNTY		
Spot Location			Feet From 1/4 Sec Lines	FSL	FWL
1/4	1/4	1/4			
Measured Total Depth		True Vertical Depth	BHL From Lease, Unit, or Property Line:		

BOTTOM HOLE LOCATION FOR HORIZONTAL HOLE: (LATERALS)

LATERAL #1

SEC	TWP	RGE	COUNTY		
Spot Location			Feet From 1/4 Sec Lines	FSL	FWL
1/4	1/4	1/4			
Depth of Deviation		Radius of Turn	Direction	Total Length	
Measured Total Depth		True Vertical Depth	BHL From Lease, Unit, or Property Line:		

LATERAL #2

SEC	TWP	RGE	COUNTY		
Spot Location			Feet From 1/4 Sec Lines	FSL	FWL
1/4	1/4	1/4			
Depth of Deviation		Radius of Turn	Direction	Total Length	
Measured Total Depth		True Vertical Depth	BHL From Lease, Unit, or Property Line:		

LATERAL #3

SEC	TWP	RGE	COUNTY		
Spot Location			Feet From 1/4 Sec Lines	FSL	FWL
1/4	1/4	1/4			
Depth of Deviation		Radius of Turn	Direction	Total Length	
Measured Total Depth		True Vertical Depth	BHL From Lease, Unit, or Property Line:		

API NO. 139-21424
OTC PROD. UNIT NO. 139-013904

(PLEASE TYPE OR USE BLACK INK ONLY)

OKLAHOMA CORPORATION COMMISSION

Oil & Gas Conservation Division
Post Office Box 52000
Oklahoma City, Oklahoma 73152-2000
Rule 165:10-3-25

RECEIVED

Form 1002A

Rev. 2009

APR 25 2018

OKLAHOMA CORPORATION COMMISSION

1016EZ

ORIGINAL
☒ AMENDED (Reason)

Return status to Gas

COMPLETION REPORT

TYPE OF DRILLING OPERATION

☒ STRAIGHT HOLE ☐ DIRECTIONAL HOLE ☐ HORIZONTAL HOLE
☐ SERVICE WELL

If directional or horizontal, see reverse for bottom hole location.

COUNTY	Texas	SEC	32	TWP	05N	RGE	12ECM
LEASE NAME	Interstate A			WELL NO.	15		
1/4	C	1/4	SE	1/4	SE	1/4	FSL OF 1/4 SEC 660
ELEVATION Derrick FL	3418	Ground	3411	Latitude (if known)	Longitude (if known)		
OPERATOR NAME	Merit Energy Company			OTC/OCC OPERATOR NO.	18934		
ADDRESS	13727 Noel Road, Suite 1200						
CITY	Dallas	STATE	TX	ZIP	75240		

SPUD DATE 11/05/1980
DRLG FINISHED DATE 11/21/1980
DATE OF WELL COMPLETION 01/19/1981
1st PROD DATE 02/26/2003
RECOMP DATE 4-16-2018

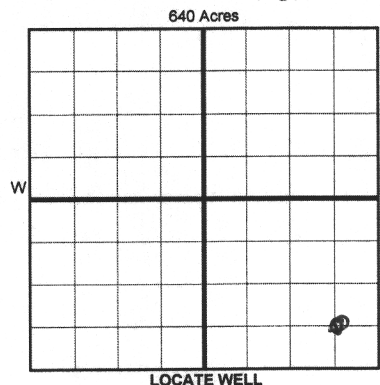

COMPLETION TYPE

<input checked="" type="checkbox"/> SINGLE ZONE
<input type="checkbox"/> MULTIPLE ZONE
Application Date
COMINGLED
Application Date
LOCATION EXCEPTION
ORDER NO.
INCREASED DENSITY
ORDER NO.

CASING & CEMENT (Form 1002C must be attached)

TYPE	SIZE	WEIGHT	GRADE	FEET	PSI	SAX	TOP OF CMT
CONDUCTOR							
SURFACE	8 5/8	24	A	1589		850	Surface
INTERMEDIATE							
PRODUCTION	5 1/2	14/15.5	A	6031		150	5380
LINER							
TOTAL DEPTH						6,032	

PACKER @ BRAND & TYPE PLUG @ TYPE PLUG @ TYPE
PACKER @ BRAND & TYPE PLUG @ TYPE PLUG @ TYPE

COMPLETION & TEST DATA BY PRODUCING FORMATION

FORMATION	Keys				
SPACING & SPACING ORDER NUMBER	State Wide 1-504				
CLASS: Oil, Gas, Dry, Inj, Disp, Comm Disp, Svc	Gas				
	5949-5956				
PERFORATED INTERVALS					
ACID/VOLUME					
FRACTURE TREATMENT (Fluids/Prop Amounts)					

Min Gas Allowable (165:10-17-7)

Gas Purchaser/Measurer



OR

First Sales Date

Oil Allowable (165:10-13-3)

INITIAL TEST DATA

INITIAL TEST DATE	2/26/2003
OIL-BBL/DAY	0
OIL-GRAVITY (API)	
GAS-MCF/DAY	30
GAS-OIL RATIO CU FT/BBL	
WATER-BBL/DAY	
PUMPING OR FLOWING	Pumping
INITIAL SHUT-IN PRESSURE	
CHOKE SIZE	
FLOW TUBING PRESSURE	

AS SUBMITTED

A record of the formations drilled through, and pertinent remarks are presented on the reverse. I declare that I have knowledge of the contents of this report and am authorized by my organization to make this report, which was prepared by me or under my supervision and direction, with the data and facts stated herein to be true, correct, and complete to the best of my knowledge and belief.

Katherine McClurkan
13727 Noel Road, Suite 1200
Dallas TX 75240
kathy.mcclurkan@meritenergy.com
4/16/2018 972-628-1660

SCANNED