

Oklahoma Corporation Commission  
Oil & Gas Conservation Division  
Post Office Box 52000  
Oklahoma City, Oklahoma 73152-2000  
Rule 165: 10-3-25

Form 1002A

API No.: 35153223400004

**Completion Report**

Spud Date: March 24, 2001

OTC Prod. Unit No.: 153-107140

Drilling Finished Date: March 29, 2001

**Amended**

1st Prod Date: February 17, 2018

Amend Reason: RECOMPLETE TO OSWEGO

Completion Date: May 08, 2001

Recomplete Date: February 17, 2018

**Drill Type: STRAIGHT HOLE**

Well Name: REED 2-24

Purchaser/Measurer: DCP / HOWARD

Location: WOODWARD 24 25N 19W  
E2 NE SW SE  
990 FSL 1170 FWL of 1/4 SEC  
Derrick Elevation: 1843 Ground Elevation: 1832

First Sales Date: 02/17/2018

Operator: XTO ENERGY INC 21003

810 HOUSTON ST  
FORT WORTH, TX 76102-6203

Completion Type		Location Exception		Increased Density	
	Single Zone	Order No		Order No	
	Multiple Zone	449353		449352	
X	Commingled	462647			
		664395			

Casing and Cement							
Type	Size	Weight	Grade	Feet	PSI	SAX	Top of CMT
CONDUCTOR	16	44		80		30	SURFACE
SURFACE	8 5/8	24	J-55	1015		550	SURFACE
PRODUCTION	5 1/2	17	J-55	7146		400	5300

Liner								
Type	Size	Weight	Grade	Length	PSI	SAX	Top Depth	Bottom Depth
There are no Liner records to display.								

**Total Depth: 7150**

Packer		Plug	
Depth	Brand & Type	Depth	Plug Type
There are no Packer records to display.		There are no Plug records to display.	

Initial Test Data
-------------------

Test Date	Formation	Oil BBL/Day	Oil-Gravity (API)	Gas MCF/Day	Gas-Oil Ratio Cu FT/BBL	Water BBL/Day	Pumpin or Flowing	Initial Shut-In Pressure	Choke Size	Flow Tubing Pressure
Feb 17, 2018	OSWEGO-CHESTER LIME-MERAMEC			56	56000	22	PUMPING	130	OPEN	

#### Completion and Test Data by Producing Formation

Formation Name: OSWEGO

Code: 404OSWG

Class: GAS

##### Spacing Orders

Order No	Unit Size
662878	640

##### Perforated Intervals

From	To
6310	6317

##### Acid Volumes

2,016 GALLONS 20% HCL
-----------------------

##### Fracture Treatments

70,825 GALLONS + 48,000 30/50 WHITE SAND
--

Formation Name: CHESTER LIME

Code: 354CRLM

Class: GAS

##### Spacing Orders

Order No	Unit Size
57280	640

##### Perforated Intervals

From	To
6528	6711

##### Acid Volumes

There are no Acid Volume records to display.
--

##### Fracture Treatments

103,250 GALLONS 50 AND 65Q FLUID
----------------------------------

Formation Name: MERAMEC

Code: 353MRMC

Class: GAS

##### Spacing Orders

Order No	Unit Size
452283	640

##### Perforated Intervals

From	To
7016	7087

##### Acid Volumes

3,500 GALLONS 15% HCL
-----------------------

##### Fracture Treatments

NONE
------

Formation Name: OSWEGO-CHESTER LIME-MERAMEC

Code:

Class: GAS

Formation	Top
HEEBNER	5018
TONKAWA	5409
COTTAGE GROVE	5829
HOGSHOOTER	5914
LANSING - KANSAS CITY	5951
OSWEGO	6148
INOLA	6454

Were open hole logs run? Yes

Date last log run: March 28, 2001

Were unusual drilling circumstances encountered? No

Explanation:

CHESTER	6520
MERAMEC	6992

<b>Other Remarks</b>
There are no Other Remarks.

<b>FOR COMMISSION USE ONLY</b>	
Status: Accepted	1139660

RECEIVED

APR 24 2018

OKLAHOMA CORPORATION  
COMMISSION

OKLAHOMA CORPORATION COMMISSION

Oil &amp; Gas Conservation Division

Post Office Box 52000

Oklahoma City, Oklahoma 73152-2000

Rule 165:10-3-25

NOTE:

Attach a copy of original  
1002A if this is a  
recompletion or reentry.

Form 1002A

Rev. 2009

API NO. 153-22340

OTC PROD. 153-107140

UNIT NO.

(PLEASE TYPE OR USE BLACK INK ONLY)

☐ ORIGINAL

☒ AMENDED (Reason)

Recomplete to Oswego

## COMPLETION REPORT

TYPE OF DRILLING OPERATION

☒ STRAIGHT HOLE ☐ DIRECTIONAL HOLE ☐ HORIZONTAL HOLE

☐ SERVICE WELL

If directional or horizontal, see reverse for bottom hole location.

COUNTY	Woodward	SEC	24	TWP	25N	RGE	19W
LEASE NAME	Reed			WELL NO.	2-24		
E/2 1/4 NE 1/4 SW 1/4 SE 1/4	FSL OF 1/4 SEC 990			FWL OF 1/4 SEC	1170		
ELEVATION	1843'	Ground	1832'	Latitude (if known)	Longitude (if known)		
OPERATOR NAME	XTO Energy Inc.			OTC/OCC OPERATOR NO.	21003		
ADDRESS	210 Park Ave., Suite 2350						
CITY	Oklahoma City	STATE	OK	ZIP	73102		

SPUD DATE	3/24/2001
DRLG FINISHED DATE	3/29/2001
DATE OF WELL COMPLETION	5/8/2001
1st PROD DATE	2/17/18
RECOMP DATE	2/17/18

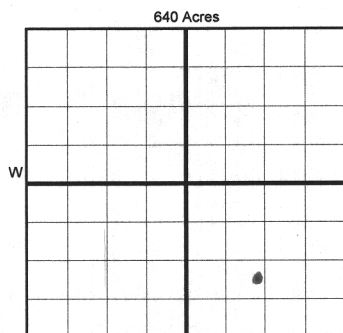

LOCATE WELL

## COMPLETION TYPE

<input type="checkbox"/> SINGLE ZONE
<input type="checkbox"/> MULTIPLE ZONE
<input checked="" type="checkbox"/> COMMINGLED
Application Date
LOCATION EXCEPTION
ORDER NO.
INCREASED DENSITY
ORDER NO.

## CASING &amp; CEMENT (Form 1002C must be attached)

TYPE	SIZE	WEIGHT	GRADE	FEET	PSI	SAX	TOP OF CMT
CONDUCTOR	16"	44#		80'		30	Surf
SURFACE	8 5/8"	24#	J-55	1015'		550	Surf
INTERMEDIATE							
PRODUCTION	5 1/2"	17#	J-55	7146'		400	5300'
LINER							
						TOTAL DEPTH	7150'

PACKER @ \_\_\_\_\_ BRAND & TYPE \_\_\_\_\_

PACKER @ \_\_\_\_\_ BRAND & TYPE \_\_\_\_\_

PLUG @ \_\_\_\_\_ TYPE \_\_\_\_\_

PLUG @ \_\_\_\_\_ TYPE \_\_\_\_\_

PLUG @ \_\_\_\_\_ TYPE \_\_\_\_\_

## COMPLETION &amp; TEST DATA BY PRODUCING FORMATION

FORMATION	Oswego	Chester Lime	Meramec
SPACING & SPACING ORDER NUMBER	640 / 662878	640 / 57280	640 / 452283
CLASS: Oil, Gas, Dry, Inj, Disp, Comm Disp, Svc	Comgl. gas	Comgl. gas	Comgl. gas
PERFORATED INTERVALS	6310 - 6317	6528 - 6711	7016 - 7087
ACID/VOLUME	2016 gals 20% HCl		5500 gals 15% HCl
FRACTURE TREATMENT (Fluids/Prop Amounts)	70,825 gals + 48,000 30/50 white sand	103,250 gals 50 & 65Q fld.	None

## INITIAL TEST DATA

INITIAL TEST DATE	2/17/2018	2/17/2018	2/17/2018
OIL-BBL/DAY	Comgl. - 0	Comgl. - 0	Comgl. - 0
OIL-GRAVITY (API)			
GAS-MCF/DAY	Comgl. - 56	Comgl. - 56	Comgl. - 56
GAS-OIL RATIO CU FT/BBL	56,000	56,000	56,000
WATER-BBL/DAY	Comgl. - 22	Comgl. - 22	Comgl. - 22
PUMPING OR FLOWING	Pumping	Pumping	Pumping
INITIAL SHUT-IN PRESSURE	130	130	130
CHOKE SIZE	open	open	open
FLOW TUBING PRESSURE	0	0	0

A record of the formations drilled through, and pertinent remarks are presented on the reverse. I declare that I have knowledge of the contents of this report and am authorized by my organization to make this report, which was prepared by me or under my supervision and direction, with the data and facts stated herein to be true, correct, and complete to the best of my knowledge and belief.

SIGNATURE	Karen Byers	NAME (PRINT OR TYPE)	Karen Byers	DATE	2/17/2018	PHONE NUMBER	405-319-3212
ADDRESS	210 Park Ave., Suite 2310	CITY	Oklahoma City	STATE	OK	ZIP	73102
EMAIL ADDRESS	karen_byers@xtoenergy.com						

AS SUBMITTED

Give formation names and tops, if available, or descriptions and thickness of formations drilled through. Show intervals cored or drillstem tested.

NAMES OF FORMATIONS	TOP
Heebner	5,018
Tonkawa	5,409
Cottage Grove	5,829
Hogshooter	5,914
Lansing - Kansas City	5,951
Oswego	6,148
Inola	6,454
Chester	6,520
Meramec	6,992

## 2) Reject Codes

Other remarks:

A blank 10x10 grid for graphing. The grid is composed of 10 columns and 10 rows of squares. The top-left square is shaded gray. The grid is used for plotting the graph of the function  $f(x) = 2x^2 - 12x + 14$  on the coordinate plane.

640 Acres

SEC	TWP	RGE	COUNTY			
Spot Location				Feet From 1/4 Sec Lines	FSL	FWL
1/4	1/4	1/4	1/4			
Measured Total Depth		True Vertical Depth	BHL From Lease, Unit, or Property Line:			

LATERAL #1						
SEC	TWP	RGE	COUNTY			
Spot Location						
1/4	1/4	1/4	1/4	Feet From 1/4 Sec Lines	FSL	FWL
Depth of Deviation		Radius of Turn	Direction		Total Length	
Measured Total Depth		True Vertical Depth	BHL From Lease, Unit, or Property Line:			

SEC	TWP	RGE	COUNTY		
Spot Location			1/4	1/4	1/4
Feet From 1/4 Sec Lines			FSL	FWL	
Depth of Deviation		Radius of Turn	Direction	Total Length	
Measured Total Depth		True Vertical Depth	BHL From Lease, Unit, or Property Line:		

SEC	TWP	RGE	COUNTY
Spot Location			
1/4	1/4	1/4	1/4
Feet From 1/4 Sec Lines		FSL	FWL
Depth of Deviation	Radius of Turn	Direction	Total Length
Measured Total Depth	True Vertical Depth	BHL From Lease, Unit, or Property Line:	

5/1/18

APR 24 2018

API NO. 153-22340

OTC PROD. UNIT NO. 153-107140

(PLEASE TYPE OR USE BLACK INK ONLY)

Recomplete to Oswego

OKLAHOMA CORPORATION COMMISSION

Oil & Gas Conservation Division

Post Office Box 52000

Oklahoma City, Oklahoma 73152-2000

Rule 165:10-3-25

NOTE:

Attach a copy of original 1002A if this is a recompletion or reentry.

Form 1002A

Rev. 2009

1016EZ

☐ ORIGINAL

☒ AMENDED (Reason)

## COMPLETION REPORT

TYPE OF DRILLING OPERATION

☒ STRAIGHT HOLE ☐ DIRECTIONAL HOLE ☐ HORIZONTAL HOLE

☐ SERVICE WELL

If directional or horizontal, see reverse for bottom hole location.

COUNTY **Woodward** SEC **24** TWP **25N** RGE **19W**

LEASE NAME **Reed** WELL NO. **2-24**

E/2 1/4 NE 1/4 SW 1/4 SE 1/4 FSL OF 1/4 SEC **990** FWL OF 1/4 SEC **1170**

ELEVATION **1843'** Ground **1832'** Latitude (if known) Longitude (if known)

OPERATOR NAME **XTO Energy Inc.** OTC/OCC OPERATOR NO. **21003**

ADDRESS **210 Park Ave., Suite 2350**

CITY **Oklahoma City** STATE **OK** ZIP **73102**

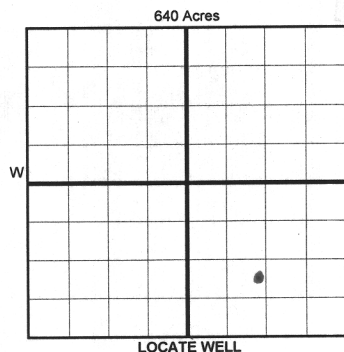

## COMPLETION TYPE

☐ SINGLE ZONE

☒ MULTIPLE ZONE

Application Date **Pending**

COMINGLED **449353, 462647,**

Application Date **664395**

LOCATION EXCEPTION ORDER NO. **449352**

INCREASED DENSITY ORDER NO.

## CASING &amp; CEMENT (Form 1002C must be attached)

TYPE	SIZE	WEIGHT	GRADE	FEET	PSI	SAX	TOP OF CMT
CONDUCTOR	16"	44#		80'		30	Surf
SURFACE	8 5/8"	24#	J-55	1015'		550	Surf
INTERMEDIATE							
PRODUCTION	5 1/2"	17#	J-55	7146'		400	5300'
LINER							
TOTAL DEPTH							7150'

PACKER @ \_\_\_\_\_ BRAND & TYPE \_\_\_\_\_

PACKER @ \_\_\_\_\_ BRAND & TYPE \_\_\_\_\_

PLUG @ \_\_\_\_\_ TYPE \_\_\_\_\_ PLUG @ \_\_\_\_\_ TYPE \_\_\_\_\_

PLUG @ \_\_\_\_\_ TYPE \_\_\_\_\_ PLUG @ \_\_\_\_\_ TYPE \_\_\_\_\_

## COMPLETION &amp; TEST DATA BY PRODUCING FORMATION

FORMATION	Oswego	Chester Lime	Meramec
SPACING & SPACING ORDER NUMBER	640 / 662878	640 / 57280	640 / 452283
CLASS: Oil, Gas, Dry, Inj, Disp, Comm Disp, Svc	Comgl. gas	Comgl. gas	Comgl. gas
PERFORATED INTERVALS	6310 - 6317	6528 - 6711	7016 - 7087
ACID/VOLUME	2016 gals 20% HCl	3500 gals 15% HCl	None
FRACTURE TREATMENT (Fluids/Prop Amounts)	70,825 gals + 48,000 30/50 white sand	103,250 gals 50 & 65Q fld.	

## INITIAL TEST DATA

INITIAL TEST DATE	2/17/2018	2/17/2018	2/17/2018
OIL-BBL/DAY	Comgl. - 0	Comgl. - 0	Comgl. - 0
OIL-GRAVITY ( API)			
GAS-MCF/DAY	Comgl. - 56	Comgl. - 56	Comgl. - 56
GAS-OIL RATIO CU FT/BBL	56,000	56,000	56,000
WATER-BBL/DAY	Comgl. - 22	Comgl. - 22	Comgl. - 22
PUMPING OR FLOWING	Pumping	Pumping	Pumping
INITIAL SHUT-IN PRESSURE	130	130	130
CHOKE SIZE	open	open	open
FLOW TUBING PRESSURE	0	0	0

AS SUBMITTED

A record of the formations drilled through, and pertinent remarks are presented on the reverse. I declare that I have knowledge of the contents of this report and am authorized by my organization to make this report, which was prepared by me or under my supervision and direction, with the data and facts stated herein to be true, correct, and complete to the best of my knowledge and belief.

**Karen Byers** **Karen Byers** **405-319-3212**

SIGNATURE NAME (PRINT OR TYPE) DATE PHONE NUMBER

210 Park Ave., Suite 2310 Oklahoma City OK 73102 karen\_byers@xtoenergy.com

ADDRESS CITY STATE ZIP EMAIL ADDRESS

SCANNED

E Z