

Oklahoma Corporation Commission  
Oil & Gas Conservation Division  
Post Office Box 52000  
Oklahoma City, Oklahoma 73152-2000  
Rule 165: 10-3-25

Form 1002A

API No.: 35053002080003

**Completion Report**

Spud Date: January 01, 1900

OTC Prod. Unit No.:

Drilling Finished Date: June 28, 2006

**Amended**

1st Prod Date:

Amend Reason: PLUG BACK DISPOSAL WELL

Completion Date: November 02, 2006

Recomplete Date: October 27, 2015

**Drill Type: STRAIGHT HOLE**

**SERVICE WELL**

Well Name: DIXON 1

Purchaser/Measurer:

Location: GRANT 16 25N 3W  
C SW SW NE  
330 FSL 330 FWL of 1/4 SEC  
Derrick Elevation: 1002 Ground Elevation: 990

First Sales Date:

Operator: DEM OPERATIONS INC 15271

16489 COUNTY ROAD 1060  
LAMONT, OK 74643-5010

Completion Type		Location Exception		Increased Density	
X	Single Zone	Order No		Order No	
	Multiple Zone	There are no Location Exception records to display.		There are no Increased Density records to display.	
	Commingled				

Casing and Cement							
Type	Size	Weight	Grade	Feet	PSI	SAX	Top of CMT
SURFACE	10	450		450			
PRODUCTION	7	23	NEW AND USED	5825		300	4700

Liner								
Type	Size	Weight	Grade	Length	PSI	SAX	Top Depth	Bottom Depth
There are no Liner records to display.								

**Total Depth: 7230**

Packer		Plug	
Depth	Brand & Type	Depth	Plug Type
5724	ARROW 4 1/2 X 7 CASING PACKER	6909	CEMENT

Initial Test Data
-------------------

Test Date	Formation	Oil BBL/Day	Oil-Gravity (API)	Gas MCF/Day	Gas-Oil Ratio Cu FT/BBL	Water BBL/Day	Pumpin or Flowing	Initial Shut- In Pressure	Choke Size	Flow Tubing Pressure
There are no Initial Data records to display.										

Completion and Test Data by Producing Formation										
Formation Name: ARBUCKLE				Code: 169ABCK			Class: DISP			

Formation	Top
ARBUCKLE	5780

Were open hole logs run? Yes  
Date last log run: June 28, 2006

Were unusual drilling circumstances encountered? No  
Explanation:

Other Remarks
OCC - THIS WELL IS AN OPEN HOLE COMPLETION IN THE ARBUCKLE FROM BOTTOM OF THE 7" CASING AT 7,230' TO TOP OF CEMENT PLUG AT 6,909'. UIC ORDER NUMBER 535014

FOR COMMISSION USE ONLY
<div>Status: Accepted</div> <div>1139706</div>

API  
NO. 053-00208  
OTC PROD.  
UNIT NO.

(PLEASE TYPE OR USE BLACK INK ONLY)

☐ ORIGINAL  
☒ AMENDED (Reason)

OKLAHOMA CORPORATION COMMISSION

Oil & Gas Conservation Division

Post Office Box 52000

Oklahoma City, Oklahoma 73152-2000

Rule 165:10-3-25

RECEIVED

APR 30 2018

OKLAHOMA CORPORATION  
COMMISSION

Form 1002A

Rev. 2009

03  
BACK DISPOSAL WELL

COMPLETION REPORT

TYPE OF DRILLING OPERATION

☐ STRAIGHT HOLE ☐ DIRECTIONAL HOLE ☐ HORIZONTAL HOLE  
☒ SERVICE WELL

If directional or horizontal, see reverse for bottom hole location.

COUNTY GRANT SEC 16 TWP 25N RGE 03W  
LEASE NAME DIXON WELL NO. #1  
C 1/4 SW 1/4 SW 1/4 NE 1/4 FSL OF 1/4 SEC 330 FWL OF 1/4 SEC 330  
ELEVATION Derrick FL 1002 Ground 990 Latitude (if known) Longitude (if known)  
OPERATOR NAME DEM OPERATIONS INC OTC/OCC OPERATOR NO. B271-D  
ADDRESS 16489 County Road 1060  
CITY LAMONT STATE OK ZIP 74643

SPUD DATE 1-1-1900  
DRLG FINISHED DATE 6-28-06  
DATE OF WELL COMPLETION 11-2-06  
1st PROD DATE  
RECOMP DATE 10-27-15

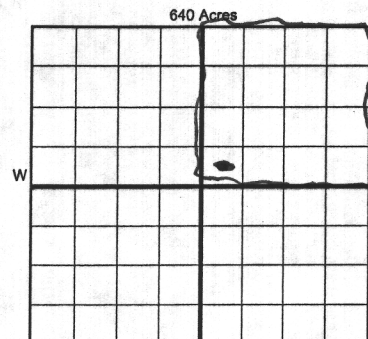

COMPLETION TYPE

☒ SINGLE ZONE  
☐ MULTIPLE ZONE  
Application Date  
COMMINGLED  
Application Date  
LOCATION EXCEPTION  
ORDER NO  
INCREASED DENSITY  
ORDER NO

CASING & CEMENT (Form 1002C must be attached)

TYPE	SIZE	WEIGHT	GRADE	FEET	PSI	SAX	TOP OF CMT
CONDUCTOR							
SURFACE	<u>10" 450</u>			<u>450</u>			
INTERMEDIATE							
PRODUCTION	<u>7 23#</u>	<u>NEW</u>	<u>USED</u>	<u>5825</u>		<u>300</u>	<u>4700</u>
LINER							

PACKER @ 5724 BRAND & TYPE CASING PACKER PLUG @ 6909 TYPE Cement TOTAL DEPTH 7230  
PACKER @ 169 BRAND & TYPE ABCK PLUG @ 6909 TYPE Cement PLUG @ 6909 TYPE Cement

COMPLETION & TEST DATA BY PRODUCING FORMATION

FORMATION ARBuckle  
SPACING & SPACING ORDER NUMBER  
CLASS: Oil, Gas, Dry, Inj, Disp, Comm Disp, Svc  
PERFORATED INTERVALS 5825 to 7230  
ACID/VOLUME 5000 GAL  
FRACTURE TREATMENT (Fluids/Prop Amounts)  
NEW COMPLETION DEPTH 10-27-15 WITH SUPERVISION OF CEMENT PLUG BACK FROM ORIGINAL DEPTH OF 7230' to NEW DEPTH OF 6909' WITH CEMENT PLUG

Min Gas Allowable (165:10-17-7)  
OR  
Oil Allowable (165:10-13-3)

Gas Purchaser/Measurer  
First Sales Date

INITIAL TEST DATA

INITIAL TEST DATE	
OIL-BBL/DAY	
OIL-GRAVITY (API)	
GAS-MCF/DAY	
GAS-OIL RATIO CU FT/BBL	
WATER-BBL/DAY	
PUMPING OR FLOWING	
INITIAL SHUT-IN PRESSURE	
CHOKE SIZE	
FLOW TUBING PRESSURE	

AS SUBMITTED

A record of the formations drilled through, and pertinent remarks are presented on the reverse. I declare that I have knowledge of the contents of this report and am authorized by my organization to make this report, which was prepared by me or under my supervision and direction, with the data and facts stated herein to be true, correct, and complete to the best of my knowledge and belief.

SIGNATURE DONE Muegge NAME (PRINT OR TYPE) DONE Muegge DATE 4-27-18 PHONE NUMBER 580389435  
ADDRESS 16489 CR 1060 CITY LAMONT STATE OK ZIP 74643 EMAIL ADDRESS Muegge@necpld.net

PLEASE TYPE OR USE BLACK INK ONLY  
FORMATION RECORD

Give formation names and tops, if available, or descriptions and thickness of formations drilled through. Show intervals cored or drillstem tested.

NAMES OF FORMATIONS	TOP
Arbuckle	5780 <del>5829</del> To 7230

LEASE NAME \_\_\_\_\_ WELL NO. \_\_\_\_\_

FOR COMMISSION USE ONLY	
ITD on file	<input type="checkbox"/> YES <input type="checkbox"/> NO
APPROVED	DISAPPROVED
2) Reject Codes	

Were open hole logs run?	<input checked="" type="checkbox"/> yes <input type="checkbox"/> no
Date Last log was run	6-28-06
Was CO <sub>2</sub> encountered?	<input type="checkbox"/> yes <input checked="" type="checkbox"/> no at what depths?
Was H <sub>2</sub> S encountered?	<input type="checkbox"/> yes <input checked="" type="checkbox"/> no at what depths?
Were unusual drilling circumstances encountered?	<input type="checkbox"/> yes <input checked="" type="checkbox"/> no
If yes, briefly explain below	

Other remarks: OCC - This well is an open hole completion in the Arbuckle from bottom of the 7" casing at 7230' to top of cement plug at 6909'. The UIC order # 532136 535014

640 Acres

If more than three drainholes are proposed, attach a separate sheet indicating the necessary information.

Direction must be stated in degrees azimuth. Please note, the horizontal drainhole and its end point must be located within the boundaries of the lease or spacing unit.

Directional surveys are required for all drainholes and directional wells.

640 Acres

BOTTOM HOLE LOCATION FOR DIRECTIONAL HOLE

SEC	TWP	RGE	COUNTY
Spot Location		Feet From 1/4 Sec Lines	
1/4	1/4	1/4	1/4
Measured Total Depth		True Vertical Depth	
		BHL From Lease, Unit, or Property Line:	

BOTTOM HOLE LOCATION FOR HORIZONTAL HOLE: (LATERALS)

LATERAL #1			
SEC	TWP	RGE	COUNTY
Spot Location		Feet From 1/4 Sec Lines	
1/4	1/4	1/4	1/4
Depth of Deviation		Radius of Turn	Direction
Measured Total Depth		True Vertical Depth	Total Length
		BHL From Lease, Unit, or Property Line:	

LATERAL #2			
SEC	TWP	RGE	COUNTY
Spot Location		Feet From 1/4 Sec Lines	
1/4	1/4	1/4	1/4
Depth of Deviation		Radius of Turn	Direction
Measured Total Depth		True Vertical Depth	Total Length
		BHL From Lease, Unit, or Property Line:	

LATERAL #3			
SEC	TWP	RGE	COUNTY
Spot Location		Feet From 1/4 Sec Lines	
1/4	1/4	1/4	1/4
Depth of Deviation		Radius of Turn	Direction
Measured Total Depth		True Vertical Depth	Total Length
		BHL From Lease, Unit, or Property Line:	

Image @ 100ZA

☐ POLLUTION  
☒ NON POLLUTION

OKLAHOMA CORPORATION COMMISSION  
INCIDENT AND COMPLAINT INVESTIGATION REPORT

Form 1085-0  
Rev-2014

**Complainant Type:** Inspection Discovery

**Complainant:**

Tim McReynolds  
101 S 6TH ST  
PO Box 1107  
Kingfisher, OK 73750-1107

Taken By: Tim McReynolds		Incident No. 18515OGDO22850
Date 10/27/2015	Time 5	Referred From

**Joint Inspection Date:**

**Home Phone:** Not on file.  
**Work Phone:** (405) 375-5570  
**FAX No.:** Not on file.

**Company:**

DEM OPERATIONS INC  
16489 COUNTY ROAD 1060  
LAMONT, OK 74643-5010

**Joint Inspection Date:**

**Phone No.:** (580) 388-4315  
**Second Number:** Not on file.  
**Operator No.:** 15271

Lease/Well Name: DIXON Well No.: 1 API No: 053-00208

Location within Sec.: SW4 SW4 NE4 Sec 16 Twp 25N Rge 03W County: GRANT

General Directions:

Lat: 36.644972

Long: -97.52425

**Complaint/Incident** Incident Type: Well Site

**Source Code(s) & Description(s)**

99-Other

**Nature of Complaint:**

Plugged back per UIC. Base of Arbuckle at 7164'. Fill is 225'. Tagged plug back at 6909'.

Oil Released: bbls

Oil Recovered: bbls

Water Released: bbls

Water Recovered: bbls

Water Body Affected: No

Fish/Wild Kill Reported: N

**Response**

Investigator: Tim McReynolds

Phone No. (405) 375-5570

Initial Response Date: 10/27/2015

Follow Up Dates:

Investigation Date:  
10/27/2015

Mediation Date:

Remediation Date:

Litigation Date:

Referred To:

Referred Date:

Agency of Jurisdiction: Oklahoma Corporation Commission

Resolved Date: 10/27/2015

☒ Water Body Affected Confirmed

☒ Fish/Wildlife Kill Confirmed

Incident Confirmation Status:  
Confirmed No Violation

Red-Tagged Date:

Removal Date:

Violations: Citation #:



Findings: On 10-27-15 Plugged back per UIC. Base of Arbuckle at 7164'. Fill is 225'. Tagged plug back at 6909'.

Recommendations: Plugged back per UIC. Base of Arbuckle at 7164'. Fill is 225'. Tagged plug back at 6909'. If you have any questions call Tim McReynolds 405-702-2467