

Oklahoma Corporation Commission  
Oil & Gas Conservation Division  
Post Office Box 52000  
Oklahoma City, Oklahoma 73152-2000  
Rule 165: 10-3-25

Form 1002A

API No.: 35121248000000

**Completion Report**

Spud Date: December 06, 2017

OTC Prod. Unit No.: 121-223984

Drilling Finished Date: January 08, 2018

1st Prod Date: July 01, 2018

Completion Date: June 11, 2018

**Drill Type:** HORIZONTAL HOLE

Min Gas Allowable: Yes

Well Name: PRYOR TRUST 0718 2H-16

Purchaser/Measurer: CLEARWATER ENT LLC

Location: PITTSBURG 17 7N 18E  
SE NE NE NE  
341 FNL 275 FEL of 1/4 SEC  
Latitude: 35.0864464 Longitude: -95.4207501  
Derrick Elevation: 645 Ground Elevation: 618

First Sales Date: 07/03/2018

Operator: RED MOUNTAIN OPERATING LLC 23694

5901 N WESTERN AVE  
OKLAHOMA CITY, OK 73118-1253

Completion Type		Location Exception		Increased Density	
X	Single Zone	Order No		Order No	
	Multiple Zone	669797		There are no Increased Density records to display.	
	Commingled				

Casing and Cement							
Type	Size	Weight	Grade	Feet	PSI	SAX	Top of CMT
SURFACE	13 3/8	48	J-55	310	550	340	SURFACE
INTERMEDIATE	9 5/8	40	J-55	2266	1100	490	SURFACE
PRODUCTION	5 1/2	20	P-110	15273	2700	2770	SURFACE

Liner								
Type	Size	Weight	Grade	Length	PSI	SAX	Top Depth	Bottom Depth
There are no Liner records to display.								

**Total Depth: 15283**

Packer	
Depth	Brand & Type
There are no Packer records to display.	

Plug	
Depth	Plug Type
There are no Plug records to display.	

Initial Test Data
-------------------

Test Date	Formation	Oil BBL/Day	Oil-Gravity (API)	Gas MCF/Day	Gas-Oil Ratio Cu FT/BBL	Water BBL/Day	Pumpin or Flowing	Initial Shut-In Pressure	Choke Size	Flow Tubing Pressure
Jun 29, 2018	WOODFORD			8000		550	FLOWING	2300	50/64	725

Completion and Test Data by Producing Formation

Formation Name: WOODFORD

Code: 319WDFD

Class: GAS

Spacing Orders

Order No	Unit Size
666507	640
670952	MULTIUNIT

Perforated Intervals

From	To
8081	15147

Acid Volumes

120,158 GALLONS

Fracture Treatments

277,874 BARRELS FLUID, 8,531,450 POUNDS SAND

Formation	Top
MAYES	7496
WOODFORD	7598
HUNTON	7770

Were open hole logs run? No

Date last log run:

Were unusual drilling circumstances encountered? No

Explanation:

Other Remarks

OCC - THIS DOCUMENT IS ACCEPTED BASED ON THE DATA SUBMITTED NEITHER THE FINAL LOCATION EXCEPTION NOR THE FINAL MULTIUNIT ORDERS HAVE BEEN ISSUED. OPERATOR AGREES THE EXHIBIT PRESENTED IN THESE CASES NEEDS TO BE FIXED TO THE LAST PERFORATION BEING INCORRECT.

Lateral Holes

Sec: 21 TWP: 7N RGE: 18E County: PITTSBURG

NE NW NW SW

2593 FSL 403 FWL of 1/4 SEC

Depth of Deviation: 7185 Radius of Turn: 515 Direction: 177 Total Length: 7284

Measured Total Depth: 15283 True Vertical Depth: 7722 End Pt. Location From Release, Unit or Property Line: 403

FOR COMMISSION USE ONLY

Status: Accepted

1140382

API NO. 121-24800  
OTC PROD. UNIT NO. 121-223984

(PLEASE TYPE OR USE BLACK INK ONLY)

OKLAHOMA CORPORATION COMMISSION

Oil & Gas Conservation Division

Post Office Box 52000

Oklahoma City, Oklahoma 73152-2000

Rule 165:10-3-25

RECEIVED

AUG 23 2018

OKLAHOMA CORPORATION COMMISSION

Form 1002A

Rev. 2009

☒ ORIGINAL  
☐ AMENDED (Reason)

TYPE OF DRILLING OPERATION

☐ STRAIGHT HOLE ☐ DIRECTIONAL HOLE ☒ HORIZONTAL HOLE  
☐ SERVICE WELL

If directional or horizontal, see reverse for bottom hole location.

COUNTY **Pittsburg** SEC **17** TWP **7N** RGE **18E**  
LEASE NAME **Pryor Trust 0718** WELL NO. **2H-16**  
SE 1/4 NE 1/4 NE 1/4 NE 1/4 FNL OF 1/4 SEC **341** FEL OF 1/4 SEC **275**  
ELEVATION **645 KB** Ground **618** Latitude (if known) **35.08644640** Longitude (if known) **-95.42075010**  
OPERATOR NAME **Red Mountain Operating LLC** OTC/OCC OPERATOR NO. **23694**  
ADDRESS **6832 N Robinson Ave**  
CITY **Oklahoma City** STATE **OK** ZIP **73116**

SPUD DATE **12/06/2017**  
DRLG FINISHED DATE **01/08/2018**  
DATE OF WELL COMPLETION **06/11/2018**  
1st PROD DATE **07/01/2018**  
RECOMP DATE  
DATE OF WELL COMPLETION

640 Acres  
W E  
LOCATE WELL

COMPLETION TYPE

☒ SINGLE ZONE  
☐ MULTIPLE ZONE  
Application Date  
COMINGLED  
Application Date  
LOCATION EXCEPTION  
ORDER NO. **669797 Ed.**  
INCREASED DENSITY  
ORDER NO.

CASING & CEMENT (Form 1002C must be attached)

TYPE	SIZE	WEIGHT	GRADE	FEET	PSI	SAX	TOP OF CMT
CONDUCTOR							
SURFACE	13 3/8"	48#	J-55	310	550	340	SURF
INTERMEDIATE	9 5/8"	40#	J-55	2,266	1100	490	SURF
PRODUCTION	5 1/2"	20#	P-110	15,273	2700	2780	SURF
LINER							
						TOTAL DEPTH	15,283

PACKER @ **NA** BRAND & TYPE  
PACKER @ **NA** BRAND & TYPE  
PLUG @ TYPE  
PLUG @ TYPE  
PLUG @ TYPE  
PLUG @ TYPE

COMPLETION & TEST DATA BY PRODUCING FORMATION

FORMATION **WOODFORD**  
SPACING & SPACING ORDER NUMBER **640 / 666507**  
CLASS: Oil, Gas, Dry, Inj, Disp, Comm Disp, Svc  
PERFORATED INTERVALS **8081 - 15147**  
ACID/VOLUME **120,158 GAL**  
FRACTURE TREATMENT (Fluids/Prop Amounts) **277,874 BBL FLUID**  
**8,531,450# SD**

Min Gas Allowable (165:10-17-7)

Gas Purchaser/Measurer

**CLEARWATER ENT LLC**

☒

OR

First Sales Date

**7/3/2018**

INITIAL TEST DATA

Oil Allowable (165:10-13-3)

INITIAL TEST DATE **6/29/2018**  
OIL-BBL/DAY **0**  
OIL-GRAVITY (API) **N/A**  
GAS-MCF/DAY **8000**  
GAS-OIL RATIO CU FT/BBL **N/A**  
WATER-BBL/DAY **550**  
PUMPING OR FLOWING **FLOWING**  
INITIAL SHUT-IN PRESSURE **2300**  
CHOKE SIZE **50/64"**  
FLOW TUBING PRESSURE **725**

AS SUBMITTED

A record of the formations drilled through, and pertinent remarks are presented on the reverse. I declare that I have knowledge of the contents of this report and am authorized by my organization to make this report, which was prepared by me or under my supervision and direction, with the data and facts stated herein to be true, correct, and complete to the best of my knowledge and belief.  
SIGNATURE **Tim Cummings** DATE **8/21/2018** PHONE NUMBER **405-842-4500**  
ADDRESS **6832 N Robinson Ave** CITY **Oklahoma City** STATE **OK** ZIP **73116** EMAIL ADDRESS **tcummings@redmountainenergy.net**

PLEASE TYPE OR USE BLACK INK ONLY

## FORMATION RECORD

Give formation names and tops, if available, or descriptions and thickness of formations drilled through. Show intervals cored or drillstem tested.

LEASE NAME

Pryor Trust 0718

WELL NO. 2H-16

NAMES OF FORMATIONS	TOP
MAYES	7,496
WOODFORD	7,598
HUNTON	7,770

FOR COMMISSION USE ONLY

ITD on file ☐ YES ☐ NO

APPROVED \_\_\_\_\_ DISAPPROVED \_\_\_\_\_

2) Reject Codes

\_\_\_\_\_

\_\_\_\_\_

\_\_\_\_\_

\_\_\_\_\_

Were open hole logs run? \_\_\_\_\_ yes ☒ no

Date Last log was run \_\_\_\_\_

Was CO<sub>2</sub> encountered? \_\_\_\_\_ yes ☒ no at what depths? \_\_\_\_\_

Was H<sub>2</sub>S encountered? \_\_\_\_\_ yes ☒ no at what depths? \_\_\_\_\_

Were unusual drilling circumstances encountered? ☒ yes ☒ no

If yes, briefly explain below

~~Well Blowout~~ *only Pryor Trust 0718*

*1H-9 blow out*

Other remarks:

640 Acres

If more than three drainholes are proposed, attach a separate sheet indicating the necessary information.

Direction must be stated in degrees azimuth. Please note, the horizontal drainhole and its end point must be located within the boundaries of the lease or spacing unit.

Directional surveys are required for all drainholes and directional wells.

640 Acres

X									

## BOTTOM HOLE LOCATION FOR DIRECTIONAL HOLE

SEC 21 TWP 07N RGE 18E COUNTY PITTSBURG

Spot Location SE 1/4 NE 1/4 NE 1/4 SW 1/4 Feet From 1/4 Sec Lines FSL 2592 FWL 403

Measured Total Depth 15,283 True Vertical Depth 7,722 BHL From Lease, Unit, or Property Line: 403

*Horizontal only*

## BOTTOM HOLE LOCATION FOR HORIZONTAL HOLE: (LATERALS)

LATERAL #1

SEC 21 TWP 07N RGE 18E COUNTY PITTSBURG

Spot Location SE 1/4 NW 1/4 NW 1/4 SW 1/4 Feet From 1/4 Sec Lines FSL 2593 FWL 403

Depth of Deviation 7,185 Radius of Turn 515 40deg 100 Direction 177 SOUTH Total Length 7,284

Measured Total Depth 15,940 True Vertical Depth 7,700 BHL From Lease, Unit, or Property Line: 403 380 FWL

## LATERAL #2

SEC TWP RGE COUNTY

Spot Location 1/4 1/4 1/4 1/4 Feet From 1/4 Sec Lines FSL FWL

Depth of Deviation Radius of Turn Direction Total Length

Measured Total Depth True Vertical Depth BHL From Lease, Unit, or Property Line:

## LATERAL #3

SEC TWP RGE COUNTY

Spot Location 1/4 1/4 1/4 1/4 Feet From 1/4 Sec Lines FSL FWL

Depth of Deviation Radius of Turn Direction Total Length

Measured Total Depth True Vertical Depth BHL From Lease, Unit, or Property Line:



## Dennis Niskern

---

**From:** Tim Cummings <tcummings@redmountainenergy.net>  
**Sent:** Tuesday, September 11, 2018 4:52 PM  
**To:** Dennis Niskern  
**Cc:** Marcia Hyde  
**Subject:** RE: 1002A Pryor Trust 0718 2H-16

Dennis,

Same story as the Pryor Trust 1H. We ran 2 frac sleeves and fraced thru these sleeves. The first "perf" should have been at 15,147' which is the location of the first sleeve. . The first perf of the next stage would have been at 15,061'.

Sorry for the confusion.



Tim Cummings  
Executive Vice President - Engineering and Operations  
5901 N Western Ave  
Oklahoma City, OK 73118  
Office Phone - 405-842-4500 ext 201

---

**From:** Dennis Niskern <D.Niskern@occemail.com>  
**Sent:** Thursday, August 30, 2018 4:29 PM  
**To:** Tim Cummings <tcummings@redmountainenergy.net>  
**Subject:** 1002A Pryor Trust 0718 2H-16

Tim , 1002A says last perforation is 15,147'. Exhibit testified to in both the Location Exception & Multiunit say last perforation is 15,061' . Which is correct?

## Dennis Niskern

---

**From:** Dennis Niskern  
**Sent:** Wednesday, September 12, 2018 11:20 AM  
**To:** 'eking@gablelaw.com'  
**Subject:** FW: 1002A Pryor Trust 0718 2H-16  
**Attachments:** 20180912111414566.pdf

Eric, (see attached exhibit) the final orders will be wrong we have attached flags on these. I have told your clients they need to be in touch with you on how to fix.

---

**From:** Dennis Niskern  
**Sent:** Wednesday, September 12, 2018 11:08 AM  
**To:** 'Tim Cummings' <tcummings@redmountainenergy.net>  
**Cc:** 'MHyde@redmountainenergy.net' <MHyde@redmountainenergy.net>  
**Subject:** RE: 1002A Pryor Trust 0718 2H-16

---

**From:** Tim Cummings [<mailto:tcummings@redmountainenergy.net>]  
**Sent:** Tuesday, September 11, 2018 4:52 PM  
**To:** Dennis Niskern <[D.Niskern@occeemail.com](mailto:D.Niskern@occeemail.com)>  
**Cc:** Marcia Hyde <[MHyde@redmountainenergy.net](mailto:MHyde@redmountainenergy.net)>  
**Subject:** RE: 1002A Pryor Trust 0718 2H-16

Dennis,

Same story as the Pryor Trust 1H. We ran 2 frac sleeves and fraced thru these sleeves. The first "perf" should have been at 15,147' which is the location of the first sleeve. . The first perf of the next stage would have been at 15,061'.

Sorry for the confusion.



Tim Cummings  
Executive Vice President - Engineering and Operations  
5901 N Western Ave  
Oklahoma City, OK 73118  
Office Phone - 405-842-4500 ext 201

---

**From:** Dennis Niskern <[D.Niskern@occeemail.com](mailto:D.Niskern@occeemail.com)>  
**Sent:** Thursday, August 30, 2018 4:29 PM  
**To:** Tim Cummings <[tcummings@redmountainenergy.net](mailto:tcummings@redmountainenergy.net)>  
**Subject:** 1002A Pryor Trust 0718 2H-16

Tim , 1002A says last perforation is 15,147'. Exhibit testified to in both the Location Exception & Multiunit say last perforation is 15,061'. Which is correct?

Well Name PRYOR TRUST 0718 2H-16  
 Location SEC 16 & 21, TWP 7N, RNG 18E  
 County Pittsburg  
 Operator Red Mountain

CD 2016-4937 (MU) 670952  
 CD 2016-4940 (LX) 669797

EK

SEC 16					Permitted Distance	
Surface location of well is					Surface	0 from South line
					No closer than	0 from East line
					Vertical Entry	0 from North line
SEC 16	X	X	X	Y	Perforations	165 from North line
North Unit	2740291.0	648256.0	2745578.0	648398.0	No Closer than	165 From South line
Mid Unit	2740421.0	642975.0	2745707.0	643107.0		330 from West line
South Unit	2740025.0	637678.0	2745840.0	637815.0		
SEC 21					Bottom Hole	0 from South line
Surface XY	2740025.0	647908.0			No closer than	330 from West line

Allocation for Multi Unit	
SEC 16	SEC 21
4493	2487
64.3696%	35.6304%

Formations	Depth	TVD	Location of each specific point		
Woodford SEC 16 Top	7880	7597	596	from North line	386 from West line
First Perf	8081	7622	795	from North line	386 from West line
Last Perf	12574	7701	0	from South line	407 from West line
Entry to Section	12574	7701	0	Section Boundary	407 from West line
SEC 21					
First Perf	12574	7701	0	from North line	407 from West line
Last Perf	15061	7728	2485	from North line	399 from West line

should be 15147

Bottom hole location is	15283	7722	2593 from South line	403 from West line
-------------------------	-------	------	----------------------	--------------------

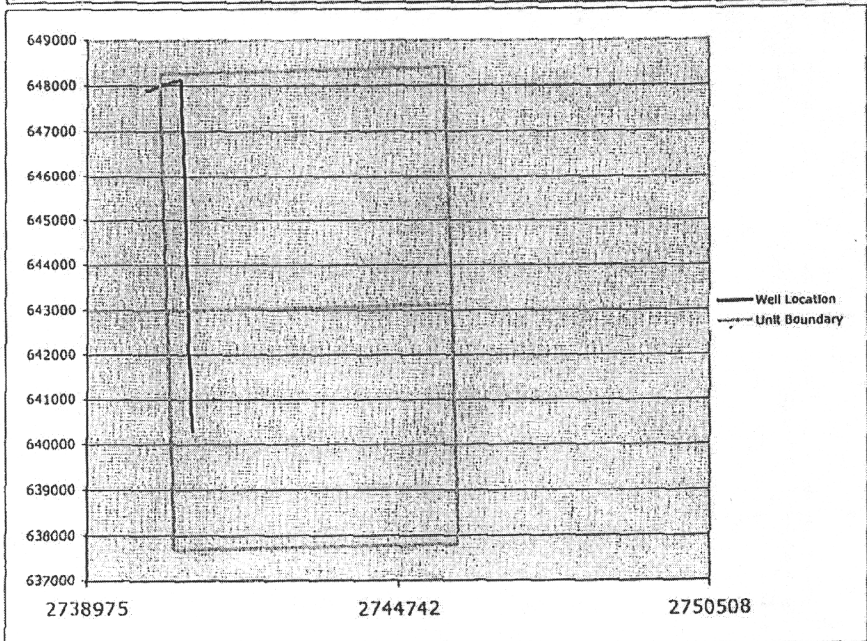

JUL 23 2018

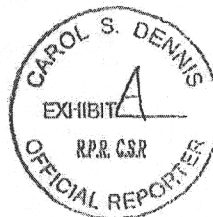

JUL 23 2018

## Dennis Niskern

---

**From:** Eric R. King <eking@gablelaw.com>  
**Sent:** Thursday, September 13, 2018 12:02 PM  
**To:** Dennis Niskern  
**Cc:** Julie K. Montgomery; Eric R. King  
**Subject:** 1002A Pryor Trust 0718 1H-9 - Response to your email  
**Attachments:** Pryor Trust 0718 2H-16.pdf; Pryor Trust 0718 1H-9.pdf

Good morning Dennis:  
Please find attached corrected exhibits.  
Could you review these and advise whether or not these will be acceptable.  
If acceptable, what is the next step?  
Do we simply amend the Order we submitted?  
Is the Order correct, but we just needed to add these corrected exhibits?  
Please advise. Thanks.

Best regards,

Eric

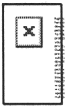

**Eric R. King | Attorney At Law | GableGotwals**  
One Leadership Square, 15th Floor | 211 North Robinson | Oklahoma City, OK 73102-7101 USA  
(m) 405-627-5749 | (w) 405.235.5518 | (f) 405.235.2875 | [www.gablelaw.com](http://www.gablelaw.com)

Well Name Pryor Trust 0718 1H-9  
 Location SEC 4 & 9, TWP 7N, RNG 18E  
 County Pittsburg  
 Operator Red Mountain

CD 2016-4947 (MU) 677138  
 CD 2016-4950 (LX) 669460

EK

					Permitted Distance
SEC 17					
Surface location of well is		341	from North line		
		290	from East line		
SEC 4	X	Y	X	Y	
North Unit	2740009	658870	2745258	659023	Perforations 165 from North line
Mid Unit	2740151	653539	2745431	653695	No Closer than 165 From South line
South Unit	2740010	648256	2745578	648398	330 from West line
SEC 9					
Surface XY	2740010	647908			
Allocation for Multi Unit					
	SEC 9	SEC 4			
	4471	4866			
	47.8848%	52.1152%			

Formations	Depth	TVD	Location of each specific point			
Woodford SEC 9 Top	7947	7579	719	from South line	817	from West line
SEC 9						
First Perf	8050	7598	820	from South line	816	from West line
Last Perf	12521	7555	0	from North line	805	from West line
Entry to Section	12521	7555	0	Section Boundary	805	from West line
SEC 4						
First Perf	12521	7555	0	from South line	805	from West line
Last Perf	17387	7575	470	from North line	835	from West line

Bottom hole location is	17513	7573	344 from North line	836 from West line
-------------------------	-------	------	---------------------	--------------------

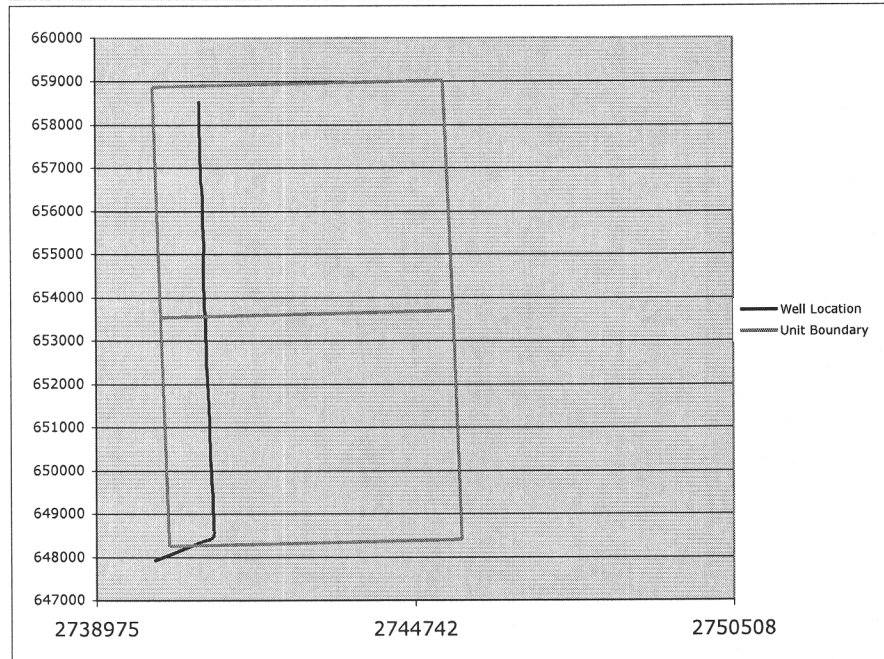

CD 2016-4947 (MU) 677138  
CD 2016-4950 (LX) 669460

EK

35-121-24801  
Red Mountain  
Pittsburg  
OK  
Pryor Trust 0718 1H-9  
SEC 4 & 9, TWP 7N, RNG 18E

Surface Location Sec 17  
Tolerance Sec 17  
Surface in Unit  
Tolerances for Entry - Vertical Zones  
Tolerances for Perforations

5286		5291	
FNL	FSL	FWL	FEL
341			290
341	4939	-290	5582
165	165	330	

	X		Y		X		Y	
	2740009	658870			2745258	659023		
NORTH UNIT			SEC 4					
	2740151	653539			2745431	653695		
SOUTH UNIT			SEC 9					
	2740291	648256			2745578	648398		

Multi-Section Unit Info	
Perfs	% Total
SEC 9	SEC 4
4471.00	4866.00
47.8848%	52.1152%

Height_west		Height_east	
5331.00	SEC 4	5328.00	
5283.00	SEC 9	5297.00	
10614.00	Multi	10625.00	

Well Location	2740010	647908
---------------	---------	--------

Measured Depth (ft)	KB	True Vertical Depth (ft)	Northings (ft)	Eastings (ft)	Perf Len (ft)	Perf Len (ft)	Coordinates from spacing acre unit boundary			
	1342						FNL	FSL	FWL	FEL

Exit from	Entry into										
	Woodford	7947	-6237	7578.75	1086.26	1078.15			718.65	817.06	
SEC 9											
	SEC 9										
	First Perf	8050	-6256	7598.19	1189.22	1074.66			819.70	815.95	
	Last Perf	12521	-6213	7554.89	5654.64	945.46	4471			805.08	
SEC 4	Entry to Section	12521	-6213	7554.89	5654.64	945.46				805.08	
	SEC 4										
	First Perf	12521	-6213	7554.89	5654.64	945.46				805.08	
	Last Perf	17387	-6233	7575.31	10516.02	846.33	4866	470.49		835.45	
	Section Line	12521			-0.33						
	Terminus	17513	91.10	358.50	7573.30	10641.98	843.75	4471.00	4866.00	344.48	836.23
	Drills TD	17513	91.10	358.50	7573.30	10641.98	843.75	4471.00		344.48	836.23

5.5" P110 23.00# csq @ = TD

Location Of Well	Measured Depth (ft)	Incl.	Azim.	True Vertical Depth (ft)	Northings (+) Southings (-) (ft)	Eastings (+) Westings (-) (ft)	Vertical Displacement	Dogleg Rate (°/100ft)	FNL	FSL	FWL	FEL
SEC 17	0	0.00	0.00	0.00	0.00	0.00	0.00	0.00	341	4939	-290	5582
SEC 17	3998	13.30	68.00	3914.74	328.14	647.43	310.73	0.00	30	5250	366	4925
SEC 17	4165	9.80	69.60	4078.33	340.29	678.57	322.77	2.10	19	5261	397	4894
SEC 17	4254	8.90	57.60	4166.16	346.62	691.48	328.77	2.41	13	5267	410	4880
SEC 17	4344	10.90	57.60	4254.81	354.91	704.55	336.72	2.22	5	5275	424	4867
SEC 9	4433	12.40	57.70	4341.98	364.53	719.73	345.95	1.69	5283	5	439	4852
SEC 9	4522	12.00	62.10	4428.97	373.97	735.99	354.96	1.14	5274	14	456	4835
SEC 9	4611	14.00	59.80	4515.68	383.71	753.47	364.26	2.32	5265	23	473	4817
SEC 9	4701	13.80	59.20	4603.05	394.68	772.10	374.75	0.27	5255	33	492	4799
SEC 9	4790	13.90	59.20	4689.46	405.59	790.40	385.18	0.11	5244	44	511	4780
SEC 9	4880	13.40	64.00	4776.92	415.70	809.06	394.81	1.38	5235	53	530	4761
SEC 9	4969	13.20	68.40	4863.54	423.96	827.78	402.59	1.16	5227	61	549	4742
SEC 9	5058	13.50	68.50	4950.13	431.51	846.89	409.64	0.34	5220	68	568	4723
SEC 9	5148	13.80	69.10	5037.59	439.19	866.69	416.81	0.37	5213	75	588	4703
SEC 9	5237	13.60	66.60	5124.06	447.13	886.21	424.25	0.70	5206	83	608	4683
SEC 9	5326	11.60	63.80	5210.91	455.24	903.84	431.90	2.35	5198	90	626	4665
SEC 9	5415	12.00	69.30	5298.03	462.46	920.53	438.69	1.34	5191	97	643	4648
SEC 9	5504	12.80	73.60	5384.96	468.51	938.64	444.28	1.37	5186	103	661	4630
SEC 9	5593	13.50	71.10	5471.62	474.66	957.93	449.93	1.01	5180	108	680	4610
SEC 9	5683	13.40	67.30	5559.16	482.09	977.49	456.86	0.99	5173	115	700	4591
SEC 9	5772	13.10	59.40	5645.80	491.21	995.68	465.50	2.06	5165	124	718	4572
SEC 9	5862	12.40	53.90	5733.58	502.09	1012.27	475.96	1.56	5154	134	735	4555
SEC 9	5952	10.50	51.00	5821.78	512.95	1026.45	486.45	2.21	5144	145	750	4541
SEC 9	6041	8.80	50.30	5909.52	522.40	1038.00	495.60	1.91	5135	154	762	4529
SEC 9	6131	7.50	47.70	5998.61	530.75	1047.64	503.70	1.50	5127	162	771	4519
SEC 9	6220	6.30	47.40	6086.97	537.96	1055.53	510.71	1.35	5120	169	780	4511
SEC 9	6310	5.40	50.10	6176.50	544.02	1062.41	516.59	1.05	5114	175	787	4504
SEC 9	6399	4.90	48.70	6265.14	549.22	1068.48	521.63	0.58	5109	180	793	4498
SEC 9	6489	4.50	44.20	6354.83	554.29	1073.83	526.56	0.60	5104	185	798	4492
SEC 9	6578	4.40	43.80	6443.57	559.25	1078.63	531.40	0.12	5099	190	803	4487
SEC 9	6667	3.40	35.30	6532.36	563.87	1082.51	535.92	1.29	5095	194	807	4483
SEC 9	6757	2.80	29.50	6622.23	567.96	1085.14	539.94	0.75	5091	198	810	4481
SEC 9	6846	2.30	28.00	6711.14	571.43	1087.05	543.36	0.57	5087	202	812	4479
SEC 9	6936	2.00	22.10	6801.08	574.48	1088.49	546.37	0.41	5084	205	813	4477
SEC 9	7033	1.60	19.80	6898.03	577.32	1089.58	549.18	0.42	5082	207	815	4476
SEC 9	7078	4.60	3.10	6942.96	579.72	1089.89	551.57	6.89	5079	210	815	4476
SEC 9	7123	9.50	0.20	6987.60	585.24	1090.00	557.08	10.91	5074	215	815	4475
SEC 9	7167	12.60	358.90	7030.78	593.67	1089.92	565.51	7.07	5065	224	815	4475
SEC 9	7212	16.00	0.20	7074.38	604.78	1089.85	576.62	7.59	5054	235	816	4475
SEC 9	7257	18.50	0.50	7117.35	618.12	1089.94	589.96	5.56	5041	248	816	4475
SEC 9	7302	21.30	0.90	7159.66	633.44	1090.13	605.26	6.23	5025	264	817	4474
SEC 9	7347	24.40	0.90	7201.13	650.91	1090.40	622.72	6.89	5008	281	817	4473
SEC 9	7391	27.10	358.50	7240.76	670.02	1090.28	641.83	6.58	4989	300	818	4473
SEC 9	7436	30.30	357.60	7280.22	691.61	1089.54	663.43	7.18	4967	322	818	4473
SEC 9	7481	34.10	355.90	7318.29	715.54	1088.16	687.39	8.68	4943	346	817	4474

CD 2016-4947 (MU) 677138  
CD 2016-4950 (LX) 669460

EK

35-121-24801  
Red Mountain  
Pittsburg  
OK  
Pryor Trust 0718 1H-9  
SEC 4 & 9, TWP 7N, RNG 18E

Surface Location Sec 17  
Tolerance Sec 17  
Surface in Unit  
Tolerances for Entry - Vertical Zones  
Tolerances for Perforations

5286		5291	
FNL	FSL	FWL	FEL
341			290
341	4939	-290	5582
165	165	330	

X		Y		X		Y	
2740009	658870	SEC 4		2745258		659023	
2740151	653539	SEC 9		2745431		653695	
2740291	648256			2745578		648398	

Multi-Section Unit Info	
Perfs	% Total
SEC 9	SEC 4
4471.00	4866.00
47.8848%	52.1152%

Height_west		Height_east	
5331.00	SEC 4	5328.00	
5283.00	SEC 9	5297.00	
10614.00	Multi	10625.00	

Well Location	2740010	647908
---------------	---------	--------

Measured Depth (ft)	KB	True Vertical Depth (ft)	Northings (ft)	Eastings (ft)	Perf Len (ft)	Perf Len (ft)	Coordinates from spacing acre unit boundary			
1342							FNL	FSL	FWL	FEL

Exit from	Entry into										
	Woodford	7947	-6237	7578.75	1086.26	1078.15			718.65	817.06	
SEC 9											
	SEC 9										
	First Perf	8050	-6256	7598.19	1186.22	1074.66			819.70	815.95	
	Last Perf	12521	-6213	7554.89	5654.64	945.46	4471			805.08	
SEC 4	Entry to Section	12521	-6213	7554.89	5654.64	945.46				805.08	
	SEC 4										
	First Perf	12521	-6213	7554.89	5654.64	945.46				805.08	
	Last Perf	17387	-6233	7575.31	10516.03	846.33	4866	470.49		835.45	
	Section Line	12521			-0.33						
	Terminus	17513	91.10	358.50	7573.30	10641.98	843.75	4471.00	4866.00	344.48	836.23
	Drills TD	17513	91.10	358.50	7573.30	10641.98	843.75	4471.00		344.48	836.23

5.5" P110 23.00# csq @

= TD

Location Of Well	Measured Depth (ft)	Incl.	Azim.	True Vertical Depth (ft)	Northings (+) Southings (-) (ft)	Eastings (+) Westings (-) (ft)	Vertical Displacement	Dogleg Rate (°/100ft)	FNL	FSL	FWL	FEL
SEC 9	7525	37.10	354.80	7354.07	741.07	1086.07	712.96	6.97	4918	371	815	4475
SEC 9	7570	41.50	355.50	7388.88	769.46	1083.67	741.41	9.83	4889	400	814	4477
SEC 9	7615	45.00	357.80	7421.66	800.24	1081.89	772.22	8.53	4858	431	813	4477
SEC 9	7659	49.70	0.30	7451.46	832.58	1081.38	804.56	11.47	4826	463	813	4477
SEC 9	7704	55.10	0.90	7478.91	868.22	1081.76	840.18	12.05	4790	499	815	4476
SEC 9	7749	59.10	0.30	7503.34	905.99	1082.15	877.93	8.96	4753	536	816	4474
SEC 9	7794	62.90	359.30	7525.16	945.34	1082.01	917.27	8.67	4713	576	817	4473
SEC 9	7839	67.00	358.70	7544.21	986.09	1081.29	958.03	9.19	4672	616	817	4473
SEC 9	7883	70.60	358.20	7560.12	1027.09	1080.18	999.04	8.25	4631	657	817	4473
SEC 9	7928	73.60	358.70	7573.95	1069.89	1079.03	1041.86	6.75	4589	700	817	4473
SEC 9	7973	77.10	357.70	7585.33	1113.40	1077.66	1085.39	8.07	4545	744	817	4473
SEC 9	8018	81.00	357.60	7593.87	1157.54	1075.84	1129.56	8.67	4501	788	816	4474
SEC 9	8046	83.10	358.10	7597.74	1185.25	1074.80	1157.28	7.71	4473	816	816	4474
SEC 9	8091	84.20	357.70	7602.72	1229.94	1073.17	1202.00	2.60	4428	860	816	4474
SEC 9	8136	85.20	358.80	7606.88	1274.72	1071.80	1246.81	3.30	4384	905	815	4474
SEC 9	8180	86.00	358.80	7610.25	1318.58	1070.88	1290.68	1.82	4340	949	816	4474
SEC 9	8225	87.60	359.10	7612.77	1363.51	1070.06	1335.61	3.62	4295	994	816	4474
SEC 9	8270	89.00	0.20	7614.10	1408.48	1069.78	1380.58	3.96	4250	1039	817	4473
SEC 9	8315	89.80	359.20	7614.57	1453.48	1069.55	1425.56	2.85	4205	1084	818	4472
SEC 9	8360	91.10	358.90	7614.22	1498.47	1068.80	1470.56	2.96	4160	1129	818	4471
SEC 9	8404	92.00	358.80	7613.03	1542.45	1067.92	1514.54	2.06	4116	1173	819	4471
SEC 9	8494	91.90	357.20	7609.97	1632.34	1064.78	1604.48	1.78	4026	1263	818	4472
SEC 9	8583	91.60	356.40	7607.25	1721.15	1059.81	1693.40	0.96	3937	1352	815	4474
SEC 9	8673	89.50	358.00	7606.38	1811.03	1055.42	1783.36	2.93	3847	1442	813	4476
SEC 9	8762	90.80	358.40	7606.15	1899.99	1052.62	1872.36	1.53	3758	1531	813	4476
SEC 9	8852	91.10	357.80	7604.66	1989.93	1049.64	1962.34	0.75	3668	1621	812	4477
SEC 9	8941	91.80	357.80	7602.41	2078.83	1046.22	2051.31	0.79	3579	1710	811	4478
SEC 9	9030	92.00	357.10	7599.45	2167.69	1042.26	2140.24	0.82	3490	1799	809	4479
SEC 9	9120	91.70	356.00	7596.55	2257.48	1036.85	2230.14	1.27	3400	1889	806	4482
SEC 9	9210	90.90	357.50	7594.51	2347.31	1031.75	2320.07	1.89	3310	1979	804	4485
SEC 9	9299	91.50	356.70	7592.64	2436.18	1027.25	2409.02	1.12	3221	2068	802	4487
SEC 9	9388	91.20	359.80	7590.55	2525.10	1024.53	2497.99	3.50	3132	2157	801	4487
SEC 9	9478	92.60	0.40	7587.56	2615.05	1024.69	2587.90	1.69	3042	2247	804	4484
SEC 9	9568	91.40	358.30	7584.42	2704.98	1023.67	2677.83	2.69	2952	2337	805	4483
SEC 9	9657	90.20	358.80	7583.18	2793.94	1021.42	2766.82	1.46	2863	2426	805	4483
SEC 9	9747	91.20	358.70	7582.08	2883.91	1019.45	2856.81	1.12	2773	2516	806	4482
SEC 9	9836	89.80	358.50	7581.30	2972.88	1017.28	2945.80	1.59	2684	2605	806	4482
SEC 9	9926	88.20	359.30	7582.87	3062.85	1015.55	3035.78	1.99	2594	2695	806	4481
SEC 9	10015	88.90	358.90	7585.13	3151.81	1014.15	3124.75	0.91	2505	2784	807	4480
SEC 9	10105	87.90	359.70	7587.64	3241.76	1013.05	3214.71	1.42	2415	2874	809	4479
SEC 9	10194	88.30	359.00	7590.59	3330.71	1012.05	3303.65	0.91	2326	2963	810	4477
SEC 9	10283	88.90	358.70	7592.76	3419.66	1010.26	3392.62	0.75	2237	3052	811	4476
SEC 9	10373	89.40	358.50	7594.10	3509.62	1008.06	3482.61	0.60	2147	3142	811	4476
SEC 9	10462	90.20	357.80	7594.41	3598.58	1005.19	3571.60	1.19	2058	3231	810	4477
SEC 9	10552	92.70	358.60	7592.13	3688.49	1002.36	3661.57	2.92	1968	3321	810	4477



CD 2016-4947 (MU) 677138  
CD 2016-4950 (LX) 669460

EK

35-121-24801  
Red Mountain  
Pittsburg  
OK  
Pryor Trust 0718 1H-9  
SEC 4 & 9, TWP 7N, RNG 18E

Surface Location Sec 17  
Tolerance Sec 17  
Surface in Unit  
Tolerances for Entry - Vertical Zones  
Tolerances for Perforations

5286		5291	
FNL	FSL	FWL	FEL
341			290
341	4939	-290	5582
165	165	330	

	X		Y		X		Y
	2740009	658870			2745258	659023	
NORTH UNIT			SEC 4				
	2740151	653539			2745431	653695	
SOUTH UNIT			SEC 9				
	2740291	648256			2745578	648398	

Multi-Section Unit Info	
Perfs	% Total
SEC 9	SEC 4
4471.00	4866.00
47.8848%	52.1152%

Height_west		Height_east	
5331.00	SEC 4	5328.00	
5283.00	SEC 9	5297.00	
10614.00	Multi	10625.00	

Well Location		2740010 647908										
Exit from	Entry into	Measured Depth (ft)	KB	True Vertical Depth (ft)	Northings (ft)	Eastings (ft)	Perf Len	Perf Len	Coordinates from spacing acre unit boundary			
							(ft)	(ft)	FNL	FSL	FWL	FEL
	Woodford	7947		-6237	7578.75	1086.26 1018.15				718.65	817.06	
SEC 9												
	SEC 9											
	First Perf	8050		-6256	7598.19	1189.27 1074.66				819.70	815.95	
	Last Perf	12521		-6213	7554.89	565.64 945.46	4471				805.08	
SEC 4	Entry to Section	12521		-6213	7554.89	5654.64 945.46					805.08	
	SEC 4											
	First Perf	12521		-6213	7554.89	5654.64 945.46					805.08	
	Last Perf	17387		-6233	7575.31	10516.02 816.33	4866		470.49		835.45	
	Section Line	12521				-0.33						
	Terminus	17513	91.10	358.50	7573.30	10641.98	843.75	4471.00	4866.00	344.48		836.23
	Drills TD	17513	91.10	358.50	7573.30	10641.98	843.75	4471.00		344.48		836.23
5.5" P110 23.00# csq @						= TD						

5.5" P110 23.00# csq @ = TD

Location Of Well	Measured Depth (ft)	Incl.	Azim.	True Vertical Depth (ft)	Northings (+) Southings (-)	Eastings (+) Westings (-)	Vertical Displacement	Dogleg Rate (°/100ft)				
									FNL	FSL	FWL	FEL
SEC 9	10641	93.60	358.00	7587.24	3777.32	999.73	3750.43	1.21	1879	3410	810	4477
SEC 9	10730	92.90	357.50	7582.20	3866.11	996.24	3839.28	0.97	1790	3499	808	4478
SEC 9	10820	92.40	357.30	7578.03	3955.92	992.16	3929.16	0.60	1700	3589	807	4480
SEC 9	10909	92.80	356.70	7574.00	4044.70	987.51	4018.04	0.81	1611	3678	804	4482
SEC 9	10999	92.30	357.90	7569.99	4134.51	983.27	4107.93	1.44	1521	3767	803	4484
SEC 9	11089	92.60	357.20	7566.15	4224.35	979.43	4197.83	0.85	1431	3857	801	4485
SEC 9	11178	93.10	356.60	7561.72	4313.11	974.62	4286.69	0.88	1342	3946	799	4487
SEC 9	11267	92.40	358.10	7557.45	4401.91	970.51	4375.56	1.86	1253	4035	797	4489
SEC 9	11356	93.10	357.30	7553.18	4490.73	966.94	4464.45	1.19	1164	4124	796	4490
SEC 9	11445	90.60	358.70	7550.31	4579.62	963.84	4553.39	3.22	1075	4213	795	4491
SEC 9	11535	89.10	358.50	7550.54	4669.59	961.64	4643.39	1.68	985	4303	795	4490
SEC 9	11625	87.50	359.60	7553.21	4759.54	960.15	4733.34	2.16	895	4393	796	4489
SEC 9	11714	87.70	359.60	7556.94	4848.46	959.53	4822.24	0.22	807	4482	798	4488
SEC 9	11803	88.60	359.00	7559.81	4937.40	958.44	4911.19	1.22	718	4571	799	4486
SEC 9	11893	86.90	359.40	7563.35	5027.32	957.19	5001.11	1.94	628	4661	800	4485
SEC 9	11982	87.20	359.30	7567.93	5116.20	956.18	5089.98	0.36	539	4750	802	4483
SEC 9	12071	89.80	359.90	7570.26	5205.15	955.56	5178.93	3.00	450	4839	803	4482
SEC 9	12161	91.20	0.40	7569.47	5295.15	955.79	5268.89	1.65	360	4929	806	4479
SEC 9	12250	92.40	358.80	7566.67	5384.10	955.17	5357.82	2.25	271	5018	808	4477
SEC 9	12339	93.50	358.40	7562.09	5472.95	953.00	5446.70	1.31	182	5107	808	4477
SEC 9	12428	91.70	357.70	7558.06	5561.80	949.97	5535.60	2.17	93	5196	807	4477
SEC 9	12518	92.20	356.80	7554.99	5651.65	945.66	5625.53	1.14	3	5286	805	4479
SEC 4	12608	91.80	355.40	7551.85	5741.38	939.54	5715.39	1.62	5248	87	801	4483
SEC 4	12697	92.60	357.20	7548.44	5830.13	933.80	5804.25	2.21	5159	176	798	4486
SEC 4	12787	92.50	358.90	7544.43	5919.98	930.74	5894.16	1.89	5069	265	797	4486
SEC 4	12876	91.80	358.90	7541.09	6008.90	929.04	5983.09	0.79	4980	354	798	4485
SEC 4	12966	92.40	358.60	7537.80	6098.82	927.07	6073.03	0.75	4890	444	799	4484
SEC 4	13055	93.20	357.60	7533.45	6187.66	924.13	6161.92	1.44	4801	533	798	4484
SEC 4	13145	92.70	359.20	7528.82	6277.51	921.62	6251.80	1.86	4711	623	798	4483
SEC 4	13234	93.50	358.90	7524.00	6366.36	920.14	6340.66	0.96	4622	712	799	4482
SEC 4	13323	91.80	358.40	7519.89	6455.24	918.05	6429.56	1.99	4533	801	799	4481
SEC 4	13413	88.70	358.30	7519.50	6545.19	915.46	6519.55	3.45	4443	891	799	4481
SEC 4	13502	88.50	0.70	7521.67	6634.15	914.68	6608.51	2.71	4354	980	800	4479
SEC 4	13591	87.80	1.10	7524.54	6723.10	916.08	6697.38	0.91	4265	1069	804	4475
SEC 4	13681	89.50	1.50	7526.66	6813.04	918.12	6787.25	1.94	4175	1159	809	4470
SEC 4	13770	87.30	0.60	7529.15	6901.99	919.75	6876.12	2.67	4087	1248	813	4465
SEC 4	13860	88.70	0.40	7532.29	6991.93	920.54	6966.01	1.57	3997	1338	816	4461
SEC 4	13950	88.50	1.10	7534.49	7081.89	921.71	7055.92	0.81	3907	1428	819	4457
SEC 4	14039	88.30	1.40	7536.97	7170.84	923.65	7144.78	0.41	3818	1517	824	4452
SEC 4	14128	87.90	359.60	7539.92	7259.78	924.43	7233.68	2.07	3729	1605	827	4449
SEC 4	14218	88.00	358.50	7543.14	7349.71	922.94	7323.61	1.23	3639	1695	828	4447
SEC 4	14307	90.00	358.00	7544.70	7438.65	920.22	7412.59	2.32	3550	1784	827	4447
SEC 4	14397	90.70	357.30	7544.15	7528.57	916.53	7502.58	1.10	3460	1874	826	4448
SEC 4	14486	88.10	357.20	7545.08	7617.45	912.26	7591.55	2.92	3371	1963	824	4449
SEC 4	14575	90.80	359.00	7545.93	7706.39	909.31	7680.53	3.65	3282	2052	824	4449



CD 2016-4947 (MU) 677138  
CD 2016-4950 (LX) 669460

EK

35-121-24801  
Red Mountain  
Pittsburg  
OK  
Pryor Trust 0718 1H-9  
SEC 4 & 9, TWP 7N, RNG 18E

Surface Location Sec 17  
Tolerance Sec 17  
Surface in Unit  
Tolerances for Entry - Vertical Zones  
Tolerances for Perforations

5286		5291	
FNL	FSL	FWL	FEL
341			290
341	4939	-290	5582
165	165	330	

	X			Y	
	2740009	658870		2745258	659023
NORTH UNIT			SEC 4		
	2740151	653539		2745431	653695
SOUTH UNIT			SEC 9		
	2740291	648256		2745578	648398

Multi-Section Unit Info	
Perfs	% Total
SEC 9	SEC 4
4471.00	4866.00
47.8848%	52.1152%

Height_west		Height_east
5331.00	SEC 4	5328.00
5283.00	SEC 9	5297.00
10614.00	Multi	10625.00

Well Location		2740010	647908								
Measured Depth (ft)	KB	True Vertical Depth (ft)	Northings (ft)	Eastings (ft)	Perf Len	Perf Len	Coordinates from spacing acre unit boundary				
					(ft)	(ft)	FNL	FSL	FWL	FEL	

Exit from	Entry into										
	Woodford	7947	-6237	7578.75	1086.26	1078.15			718.65	817.06	
SEC 9											
	SEC 9										
	First Perf	8050	-6256	7598.19	1189.27	1074.66			819.70	815.95	
	Last Perf	12521	-6213	7554.89	5654.64	945.46	4471			805.08	
SEC 4	Entry to Section	12521	-6213	7554.89	5654.64	945.46				805.08	
	SEC 4										
	First Perf	12521	-6213	7554.89	5654.64	945.46				805.08	
	Last Perf	17387	-6233	7575.31	10516.03	846.33	4866	470.49		835.45	
	Section Line	12521			-0.33						
	Terminus	17513	91.10	358.50	7573.30	10641.98	843.75	4471.00	4866.00	344.48	836.23
	Drills TD	17513	91.10	358.50	7573.30	10641.98	843.75	4471.00		344.48	836.23

5.5" P110 23.00# csq @ = TD

Location Of Well	Measured Depth (ft)	Incl.	Azim.	True Vertical Depth (ft)	Northings (+) Southings (-)	Eastings (+) Westings (-)	Vertical Displacement	Dogleg Rate (in/100ft)	FNL	FSL	FWL	FEL
SEC 4	14665	88.70	359.20	7546.33	7796.37	907.90	7770.52	2.34	3192	2143	825	4448
SEC 4	14755	90.00	1.10	7547.35	7886.36	908.13	7860.47	2.56	3102	2232	827	4445
SEC 4	14844	89.50	1.10	7547.74	7975.34	909.84	7949.38	0.56	3013	2321	831	4440
SEC 4	14933	88.80	0.40	7549.06	8064.32	911.01	8038.30	1.11	2924	2410	835	4436
SEC 4	15022	87.10	359.60	7552.24	8153.26	911.01	8127.21	2.11	2835	2499	837	4433
SEC 4	15112	87.40	358.20	7556.56	8243.14	909.28	8217.10	1.59	2745	2589	838	4432
SEC 4	15201	88.20	357.30	7559.97	8332.01	905.79	8306.03	1.35	2656	2678	837	4433
SEC 4	15290	89.20	356.20	7561.99	8420.84	900.75	8394.96	1.67	2567	2767	834	4435
SEC 4	15379	90.50	357.10	7562.23	8509.68	895.55	8483.91	1.78	2478	2856	831	4437
SEC 4	15469	90.60	355.30	7561.36	8599.48	889.58	8573.82	2.00	2388	2946	828	4440
SEC 4	15558	88.90	356.00	7561.75	8688.21	882.83	8662.71	2.07	2300	3035	823	4444
SEC 4	15647	89.10	357.50	7563.30	8777.06	877.79	8751.65	1.70	2211	3124	821	4446
SEC 4	15736	91.50	359.40	7562.84	8866.01	875.38	8840.64	3.44	2121	3213	821	4446
SEC 4	15825	92.50	359.10	7559.73	8954.95	874.22	8929.57	1.17	2032	3302	822	4444
SEC 4	15915	91.20	358.90	7556.83	9044.89	872.65	9019.52	1.46	1942	3392	823	4443
SEC 4	16004	87.20	357.50	7558.07	9133.81	869.85	9108.49	4.76	1853	3481	822	4442
SEC 4	16094	87.80	358.60	7562.00	9223.67	866.79	9198.40	1.39	1764	3571	821	4443
SEC 4	16183	87.90	358.00	7565.33	9312.57	864.15	9287.34	0.68	1675	3660	821	4442
SEC 4	16272	90.90	359.90	7566.27	9401.54	862.52	9376.32	3.99	1585	3749	822	4441
SEC 4	16361	91.60	359.60	7564.32	9490.51	862.13	9465.27	0.86	1496	3838	824	4439
SEC 4	16451	90.20	359.20	7562.91	9580.50	861.19	9555.25	1.62	1406	3928	825	4437
SEC 4	16540	90.50	358.60	7562.37	9669.48	859.48	9644.25	0.75	1317	4017	826	4435
SEC 4	16630	89.40	358.60	7562.45	9759.45	857.29	9734.24	1.22	1227	4107	826	4435
SEC 4	16719	88.30	359.00	7564.23	9848.41	855.42	9823.22	1.32	1138	4196	827	4434
SEC 4	16808	88.40	359.50	7566.79	9937.37	854.26	9912.18	0.57	1049	4285	828	4432
SEC 4	16897	88.50	358.90	7569.20	10026.32	853.02	10001.14	0.68	960	4374	829	4430
SEC 4	16986	87.30	359.00	7572.46	10115.25	851.39	10090.08	1.35	871	4463	830	4429
SEC 4	17076	87.70	358.80	7576.39	10205.14	849.66	10179.99	0.50	782	4553	830	4428
SEC 4	17165	88.90	359.20	7579.03	10294.09	848.11	10268.95	1.42	693	4642	831	4427
SEC 4	17255	92.00	359.70	7578.32	10384.07	847.24	10358.92	3.49	602	4732	833	4424
SEC 4	17344	91.10	359.80	7575.92	10473.04	846.85	10447.87	1.02	513	4821	835	4422
SEC 4	17433	90.50	358.80	7574.67	10562.02	845.77	10536.85	1.31	424	4910	836	4420
SEC 4	17464	91.10	358.50	7574.24	10593.01	845.04	10567.84	2.16	393	4941	836	4420
SEC 4	17513	91.10	358.50	7573.30	10641.98	843.75	10616.84	0.00	344	4990	836	4420

CD 2016-4947 (MU) 677138  
CD 2016-4950 (LX) 669460

EK

35-121-24801  
Red Mountain  
Pittsburg  
OK  
Pryor Trust 0718 1H-9  
SEC 4 & 9, TWP 7N, RNG 18E

Surface Location Sec 17  
Tolerance Sec 17  
Surface in Unit  
Tolerances for Entry - Vertical Zones  
Tolerances for Perforations

5286		5291	
FNL	FSL	FWL	FEL
341			290
341	4939	-290	5582
165	165	330	

	X		Y		X		Y
NORTH UNIT	2740009	658870		SEC 4	2745258	659023	
	2740151	653539			2745431	653695	
SOUTH UNIT				SEC 9			
	2740291	648256			2745578	648398	

Multi-Section Unit Info	
Perfs	% Total
SEC 9	SEC 4
4471.00	4866.00
47.8848%	52.1152%

Height_west		Height_east	
5331.00	SEC 4	5328.00	
5283.00	SEC 9	5297.00	
10614.00	Multi	10625.00	

Well Location	2740010	647908
---------------	---------	--------

Measured Depth (ft)	KB	True Vertical Depth (ft)	Northings (ft)	Eastings (ft)	Perf Len (ft)	Perf Len (ft)	Coordinates from spacing acre unit boundary			
	1342						FNL	FSL	FWL	FEL

Exit from	Entry into										
	Woodford	7947		-6237	7578.75	1066.26	1078.15			718.65	817.06
SEC 9											
	SEC 9 First Perf	8050		-6256	7598.19	1189.27	1074.66			819.70	815.95
	Last Perf	12521		-6213	7554.89	5654.64	945.46	4471			805.08
SEC 4	Entry to Section	12521		-6213	7554.89	5654.64	945.46				805.08
	SEC 4 First Perf	12521		-6213	7554.89	5654.64	945.46				805.08
	Last Perf	17387		-6233	7575.31	10516.03	816.33	4866	470.49		835.45
	Section Line	12521				-0.33					
	Terminus	17513	91.10	358.50	7573.30	10641.98	843.75	4471.00	4866.00	344.48	836.23
	Drills TD	17513	91.10	358.50	7573.30	10641.98	843.75	4471.00		344.48	836.23

5.5" P110 23.00# csg @  = TD

Location Of Well	Measured Depth (ft)	Incl.	Azim.	True Vertical Depth (ft)	Northings (+) Southings (-) (ft)	Eastings (+) Westings (-) (ft)	Vertical Displacement	Dogleg Rate (°/100ft)	FNL	FSL	FWL	FEL
------------------	---------------------	-------	-------	--------------------------	----------------------------------	--------------------------------	-----------------------	-----------------------	-----	-----	-----	-----

CD 2016-4947 (MU) 677138  
CD 2016-4950 (LX) 669460

EK

35-121-24801  
Red Mountain  
Pittsburg  
OK  
Pryor Trust 0718 1H-9  
SEC 4 & 9, TWP 7N, RNG 18E

Surface Location Sec 17  
Tolerance Sec 17  
Surface in Unit  
Tolerances for Entry - Vertical Zones  
Tolerances for Perforations

5286		5291	
FNL	FSL	FWL	FEL
341			290
341	4939	-290	5582
165	165	330	

	X		Y		X		Y
	2740009	658870			2745258	659023	
NORTH UNIT				SEC 4			
	2740151	653539			2745431	653695	
SOUTH UNIT				SEC 9			
	2740291	648256			2745578	648398	

Multi-Section Unit Info	
Perfs	% Total
SEC 9	SEC 4
4471.00	4866.00
47.8848%	52.1152%

Height_west		Height_east	
5331.00	SEC 4	5328.00	
5283.00	SEC 9	5297.00	
10614.00	Multi	10625.00	

Well Location	2740010	647908
---------------	---------	--------

Measured Depth (ft)	KB	True Vertical Depth (ft)	Northings (ft)	Eastings (ft)	Perf Len (ft)	Perf Len (ft)	Coordinates from spacing acre unit boundary			
	1342						FNL	FSL	FWL	FEL

Exit from	Entry into									
SEC 9	Woodford	7947	-6237	7578.75	1066.16	1078.15		718.65	817.06	
	SEC 9									
	First Perf	8050	-6256	7598.19	1189.22	1074.66		819.70	815.95	
	Last Perf	12521	-6213	7554.89	5654.64	945.46	4471		805.08	
SEC 4	Entry to Section	12521	-6213	7554.89	5654.64	945.46			805.08	
	SEC 4									
	First Perf	12521	-6213	7554.89	5654.64	945.46			805.08	
	Last Perf	17387	-6233	7575.31	10516.92	816.33	4866	470.49	835.45	
	Section Line	12521			-0.33					
	Terminus	17513	91.10	358.50	7573.30	10641.98	843.75	4471.00	4866.00	344.48
	Drills TD	17513	91.10	358.50	7573.30	10641.98	843.75	4471.00		344.48

5.5" P110 23.00# csg @  = TD

Location Of Well	Measured Depth (ft)	Incl.	Azim.	True Vertical Depth (ft)	Northings (+) Southings (-) (ft)	Eastings (+) Westings (-) (ft)	Vertical Displacement	Dogleg Rate (°/100ft)	FNL	FSL	FWL	FEL
------------------	---------------------	-------	-------	--------------------------	----------------------------------	--------------------------------	-----------------------	-----------------------	-----	-----	-----	-----

## Dennis Niskern

---

**From:** Dennis Niskern  
**Sent:** Friday, September 14, 2018 10:27 AM  
**To:** 'Eric R. King'  
**Cc:** Julie K. Montgomery; Bob McCoy  
**Subject:** RE: 1002A Pryor Trust 0718 1H-9 - Response to your email

The exhibits attached match the 1002A's that I have received from Red Mountain Operating LLC therefore I assume they are correct because that is what your client has told me. I' am copying Bob McCoy to let him discuss with you what needs to be done next.

---

**From:** Eric R. King [mailto:eking@gablelaw.com]  
**Sent:** Thursday, September 13, 2018 12:02 PM  
**To:** Dennis Niskern <D.Niskern@occemail.com>  
**Cc:** Julie K. Montgomery <jmontgomery@gablelaw.com>; Eric R. King <eking@gablelaw.com>  
**Subject:** 1002A Pryor Trust 0718 1H-9 - Response to your email

Good morning Dennis:  
Please find attached corrected exhibits.  
Could you review these and advise whether or not these will be acceptable.  
If acceptable, what is the next step?  
Do we simply amend the Order we submitted?  
Is the Order correct, but we just needed to add these corrected exhibits?  
Please advise. Thanks.

Best regards,  
Eric



**Eric R. King | Attorney At Law | GableGotwals**  
One Leadership Square, 15th Floor | 211 North Robinson | Oklahoma City, OK 73102-7101 USA  
(m) 405-627-5749 | (w) 405.235.5518 | (f) 405.235.2875 | [www.gablelaw.com](http://www.gablelaw.com)