

Oklahoma Corporation Commission
Oil & Gas Conservation Division
Post Office Box 52000
Oklahoma City, Oklahoma 73152-2000
Rule 165: 10-3-25

Form 1002A

API No.: 35051243140000

Completion Report

Spud Date: May 05, 2018

OTC Prod. Unit No.:

Drilling Finished Date: May 18, 2018

1st Prod Date:

Completion Date: July 04, 2018

Drill Type: STRAIGHT HOLE

SERVICE WELL

Well Name: MIDDLEBERG SWD 1

Purchaser/Measurer:

Location: GRADY 9 7N 5W
NE SW NE SW
1752 FSL 1840 FWL of 1/4 SEC
Derrick Elevation: 1265 Ground Elevation: 1253

First Sales Date:

Operator: KYBENCO DISPOSALS LLC 23518

14272 E COUNTY ROAD 1558
LINDSAY, OK 73052-9506

Completion Type	
X	Single Zone
	Multiple Zone
	Commingled

Location Exception
Order No
There are no Location Exception records to display.

Increased Density
Order No
There are no Increased Density records to display.

Casing and Cement							
Type	Size	Weight	Grade	Feet	PSI	SAX	Top of CMT
SURFACE	9 5/8	36	J-55	475	1000	250	SURFACE
PRODUCTION	7	26	L-80	8048	3000	815	2510

Liner								
Type	Size	Weight	Grade	Length	PSI	SAX	Top Depth	Bottom Depth
There are no Liner records to display.								

Total Depth: 8050

Packer	
Depth	Brand & Type
3990	AS-1X

Plug	
Depth	Plug Type
There are no Plug records to display.	

Initial Test Data

Test Date	Formation	Oil BBL/Day	Oil-Gravity (API)	Gas MCF/Day	Gas-Oil Ratio Cu FT/BBL	Water BBL/Day	Pumpin or Flowing	Initial Shut- In Pressure	Choke Size	Flow Tubing Pressure
-----------	-----------	----------------	----------------------	----------------	----------------------------	------------------	----------------------	---------------------------------	---------------	-------------------------

There are no Initial Data records to display.

Completion and Test Data by Producing Formation

Formation Name: PERMIAN

Code: 459PRMN

Class: COMM DISP

Spacing Orders		Perforated Intervals	
Order No	Unit Size	From	To
N/A		4002	4832
Acid Volumes		Fracture Treatments	
38,700 GALLONS 15% NEFE		NO FRAC	

Formation Name: PENNSYLVANIAN

Code: 409PSLV

Class: COMM DISP

Spacing Orders		Perforated Intervals	
Order No	Unit Size	From	To
N/A		5700	7852
Acid Volumes		Fracture Treatments	
ACIDIZED WITH PERMIAN		NO FRAC	

Formation	Top
PERMIAN	3950
PENNSYLVANIAN	4950

Were open hole logs run? Yes

Date last log run: May 18, 2018

Were unusual drilling circumstances encountered? No

Explanation:

Other Remarks

UIC PERMIT NUMBER 1808300010. PACKER @ 3,990'. TOP PERFORATION 4,002'. OCC - DV TOOL @ 4,885'

FOR COMMISSION USE ONLY

Status: Accepted

1140477

API NO. 051-24314
OTC PROD. 23518
UNIT NO.

(PLEASE TYPE OR USE BLACK INK ONLY)

OKLAHOMA CORPORATION COMMISSION

Oil & Gas Conservation Division

Post Office Box 52000

Oklahoma City, Oklahoma 73152-2000

Rule 165:10-3-25

RECEIVED

AUG 01 2018

OKLAHOMA CORPORATION
COMMISSION

Form 1002A

Rev. 2009

☒ ORIGINAL
☐ AMENDED (Reason)

COMPLETION REPORT

TYPE OF DRILLING OPERATION

☒ STRAIGHT HOLE ☐ DIRECTIONAL HOLE ☐ HORIZONTAL HOLE
☒ SERVICE WELL

If directional or horizontal, see reverse for bottom hole location.

COUNTY GRADY SEC 9 TWP 7 N RGE 5 W
LEASE NAME MIDDLEBERG SWD
NE 1/4 SW 1/4 NE 1/4 SW 1/4 FSL OF 1/4 SEC 1752' FWL OF 1/4 SEC 1840'
ELEVATION 1265' Ground 1253' Latitude (if known)
WELL NO. #1 1st PROD DATE
RECOMP DATE
OPERATOR NAME KYBENCO DISPOSALS LLC OTC/OCC OPERATOR NO. 23518
ADDRESS 14272 ECR 1558
CITY LINDSAY STATE OK ZIP 73052

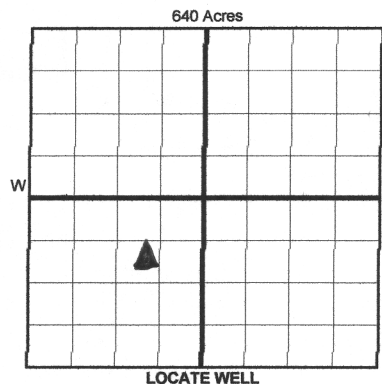

COMPLETION TYPE

☒ SINGLE ZONE
☐ MULTIPLE ZONE
Application Date
COMINGLED
Application Date
LOCATION EXCEPTION
ORDER NO.
INCREASED DENSITY
ORDER NO.

CASING & CEMENT (Form 1002C must be attached)

TYPE	SIZE	WEIGHT	GRADE	FEET	PSI	SAX	TOP OF CMT
CONDUCTOR							
SURFACE	9 5/8"	36#	J-55	475'	1000	250	CIRC
INTERMEDIATE							
PRODUCTION	7"	26#	L-80	8048'	3000	815	2510'
LINER				DV TOOL 4885'	see remarks		
						TOTAL DEPTH	8050'

PACKER @ 3990' BRAND & TYPE AS-1X PLUG @ TYPE PLUG @ TYPE
PACKER @ BRAND & TYPE PLUG @ TYPE PLUG @ TYPE

COMPLETION & TEST DATA BY PRODUCING FORMATION

FORMATION	PERMIAN & PENN.	Pennsylvanian	No Frac
SPACING & SPACING ORDER NUMBER	NA		
CLASS: Oil, Gas, Dry, Inj, Disp, Comm Disp, Svc	COMM DISPOSAL	Comm. Disposal	
	4002-4832	5700-7852	
PERFORATED INTERVALS	SEE ATTACHED		
	LIST		
ACID/VOLUME	38,700 GALS ← 15% NE/FE	Acidize @ Permian	
FRACTURE TREATMENT (Fluids/Prop Amounts)	NOT FRAC'D	No Frac	

Min Gas Allowable (165:10-17-7) Gas Purchaser/Measurer
OR
Oil Allowable (165:10-13-3) First Sales Date

INITIAL TEST DATA

INITIAL TEST DATE 7/4/2018
OIL-BBL/DAY
OIL-GRAVITY (API)
GAS-MCF/DAY
GAS-OIL RATIO CU FT/BBL
WATER-BBL/DAY 8500-BWPD @ 750 PSI
PUMPING OR FLOWING
INITIAL SHUT-IN PRESSURE
CHOKE SIZE
FLOW TUBING PRESSURE

AS SUBMITTED

A record of the formations drilled through, and pertinent remarks are presented on the reverse. I declare that I have knowledge of the contents of this report and am authorized by my organization to make this report, which was prepared by me or under my supervision and direction, with the data and facts stated herein to be true, correct, and complete to the best of my knowledge and belief.

SIGNATURE

14272 ECR 1558

ADDRESS

DANNY L RAY

NAME (PRINT OR TYPE)

LINDSAY

CITY

OK

STATE

73052

ZIP

7/6/2018

DATE

580-504-0428

PHONE NUMBER

dannyrayconsulting@msn.com

EMAIL ADDRESS

PLEASE TYPE OR USE BLACK INK ONLY

FORMATION RECORD

Give formation names and tops, if available, or descriptions and thickness of formations drilled through. Show intervals cored or drillstem tested.

NAMES OF FORMATIONS	TOP
PERMIAN	3950'
PENNSYLVANIAN	4950'
TD	8050'

LEASE NAME MIDDLEBERG SWD WELL NO. # 1

FOR COMMISSION USE ONLY	
ITD on file <input type="checkbox"/> YES <input type="checkbox"/> NO	
APPROVED _____	DISAPPROVED _____
2) Reject Codes	

Were open hole logs run?	<u>X</u> yes <u> </u> no
Date Last log was run	<u>5/18/2018</u>
Was CO ₂ encountered?	<u> </u> yes <u>X</u> no at what depths? _____
Was H ₂ S encountered?	<u> </u> yes <u>X</u> no at what depths? _____
Were unusual drilling circumstances encountered?	<u> </u> yes <u>X</u> no
If yes, briefly explain below	

Other remarks: UIC PERMIT # 1808300010PACKER @ 3990'. TOP PERF 4002'.OCC - DV tool at 4885

640 Acres

If more than three drainholes are proposed, attach a separate sheet indicating the necessary information.

Direction must be stated in degrees azimuth.
Please note, the horizontal drainhole and its end point must be located within the boundaries of the lease or spacing unit.

Directional surveys are required for all drainholes and directional wells.

640 Acres

BOTTOM HOLE LOCATION FOR DIRECTIONAL HOLE

SEC	TWP	RGE	COUNTY
Spot Location	1/4	1/4	1/4
Measured Total Depth	True Vertical Depth		BHL From Lease, Unit, or Property Line:
Feet From 1/4 Sec Lines	FSL	FWL	

BOTTOM HOLE LOCATION FOR HORIZONTAL HOLE: (LATERALS)

SEC	TWP	RGE	COUNTY
Spot Location	1/4	1/4	1/4
Depth of Deviation	Radius of Turn	Direction	Total Length
Measured Total Depth	True Vertical Depth		BHL From Lease, Unit, or Property Line:
Feet From 1/4 Sec Lines	FSL	FWL	

LATERAL #2

SEC	TWP	RGE	COUNTY
Spot Location	1/4	1/4	1/4
Depth of Deviation	Radius of Turn	Direction	Total Length
Measured Total Depth	True Vertical Depth		BHL From Lease, Unit, or Property Line:
Feet From 1/4 Sec Lines	FSL	FWL	

LATERAL #3

SEC	TWP	RGE	COUNTY
Spot Location	1/4	1/4	1/4
Depth of Deviation	Radius of Turn	Direction	Total Length
Measured Total Depth	True Vertical Depth		BHL From Lease, Unit, or Property Line:
Feet From 1/4 Sec Lines	FSL	FWL	

MIDDLEBERG SWD # 1
API # 051-24314
NE SW NE SW
SEC 9 T7N-R5W
GRADY COUNTY, OK

LIST OF PERFORATIONS FOR ORIGINAL 1002A

4002'- 4022'	(ALL 4 SPF)
4051'- 4061'	
4090'- 4094'	
4166'- 4188'	
4204'- 4214'	
4225'- 4245'	
4310'- 4356'	
4385'- 4425'	
4535'- 4575'	
4585'- 4606'	
4636'- 4640'	
4682'- 4692'	
4826'- 4832'	(BASE OF PERMIAN PERFS)
5700'- 5730'	(TOP OF PENN PERFS)
5882'- 5888'	
5912'- 5922'	
6177'- 6183'	
6282'- 6292'	
6770'- 6780'	
6900'- 6930'	
6960'- 6970'	
7254'- 7264'	
7370'- 7380'	
7445'- 7455'	
7473'- 7483'	
7503'- 7521'	
7745'- 7750'	
7752'- 7852'	