

Oklahoma Corporation Commission
Oil & Gas Conservation Division
Post Office Box 52000
Oklahoma City, Oklahoma 73152-2000
Rule 165: 10-3-25

Form 1002A

API No.: 35073254060002

Completion Report

Spud Date: December 24, 2016

OTC Prod. Unit No.:

Drilling Finished Date: January 10, 2017

1st Prod Date: December 12, 2017

Completion Date: March 25, 2017

Drill Type: HORIZONTAL HOLE

Well Name: EAST HENNESSEY UNIT 216H

Purchaser/Measurer:

Location: KINGFISHER 15 19N 6W
NE NE NE NW
323 FNL 250 FEL of 1/4 SEC
Latitude: 36.1299394 Longitude: -97.82745353
Derrick Elevation: 0 Ground Elevation: 1105

First Sales Date:

Operator: HINKLE OIL & GAS INC 21639

5600 N MAY AVE STE 295
OKLAHOMA CITY, OK 73112-4275

Completion Type	
X	Single Zone
	Multiple Zone
	Commingle

Location Exception	
Order No	
There are no Location Exception records to display.	

Increased Density	
Order No	
There are no Increased Density records to display.	

Casing and Cement							
Type	Size	Weight	Grade	Feet	PSI	SAX	Top of CMT
CONDUCTOR	20			120		10	SURFACE
SURFACE	9 5/8	36	NT-95	382		300	SURFACE
PRODUCTION	7	29	P-110	7001		285	5305

Liner								
Type	Size	Weight	Grade	Length	PSI	SAX	Top Depth	Bottom Depth
LINER	4 1/2	13.5	P-110	5984	0	0	6855	12839

Total Depth: 12841

Packer	
Depth	Brand & Type
There are no Packer records to display.	

Plug	
Depth	Plug Type
There are no Plug records to display.	

Initial Test Data

Test Date	Formation	Oil BBL/Day	Oil-Gravity (API)	Gas MCF/Day	Gas-Oil Ratio Cu FT/BBL	Water BBL/Day	Pumpin or Flowing	Initial Shut-In Pressure	Choke Size	Flow Tubing Pressure
Dec 12, 2017	MISSISSIPPIAN SOLID	43	37.1	61	1418	2669	PUMPING		OPEN	

Completion and Test Data by Producing Formation

Formation Name: MISSISSIPPIAN SOLID

Code: 359MSSSD

Class: OIL

Spacing Orders

Order No	Unit Size
61709	UNIT

Perforated Intervals

From	To
There are no Perf. Intervals records to display.	

Acid Volumes

281,148 GALLONS 15% HCL

Fracture Treatments

333,836 BARRELS SLICKWATER, 6,570,108 POUNDS 30/50 SAND

Formation	Top
COTTAGE GROVE	5598
CHECKERBOARD	6042
CLEVELAND	6112
BIG LIME	6226
2ND OSWEGO	6304
3RD OSWEGO	6322
VERDIGRIS	6343
4TH OSWEGO	6373
PINK LIME	6565
RED FORK	6596
MANNING	6715
MISSISSIPPI	6958

Were open hole logs run? No

Date last log run:

Were unusual drilling circumstances encountered? No

Explanation:

Other Remarks

OCC - THIS WELL IS AN OPEN HOLE COMPLETION FROM BOTTOM OF THE 7" CASING AT 7,001' TO TERMINUS AT 12,841'. THE 4 1/2" LINER IS NOT CEMENTED. THIS WELL IS AT A LEGAL LOCATION TO THE OUTSIDE BOUNDARY OF THE UNIT.

Lateral Holes

Sec: 15 TWP: 19N RGE: 6W County: KINGFISHER

SW SW SE SW

18 FSL 1552 FWL of 1/4 SEC

Depth of Deviation: 7031 Radius of Turn: 1524 Direction: 180 Total Length: 4286

Measured Total Depth: 12841 True Vertical Depth: 7241 End Pt. Location From Release, Unit or Property Line: 18

FOR COMMISSION USE ONLY

1138485

API NO. * 073-25406
OTC PROD. Merge #0342
UNIT NO.

PLEASE TYPE OR USE BLACK INK ONLY
NOTE:

Attach copy of original 1002A
if recompletion or reentry.

OKLAHOMA CORPORATION COMMISSION
Oil & Gas Conservation Division
Post Office Box 52000
Oklahoma City, Oklahoma 73152-2000
Rule 165:10-3-25

RECEIVED

Form 1002A
Rev. 2009

DEC 20 2017

OKLAHOMA CORPORATION
COMMISSION

☒ ORIGINAL
☐ AMENDED (Reason) _____

TYPE OF DRILLING OPERATION

☐ STRAIGHT HOLE ☐ DIRECTIONAL HOLE ☒ HORIZONTAL HOLE
☐ SERVICE WELL

If directional or horizontal, see reverse for bottom hole location.

COUNTY	Kingfisher	SEC	15	TWP	19N	RGE	06W		
LEASE NAME	East Hennessey Unit						WELL NO.	216H	
NE 1/4	NE 1/4	NE 1/4	NW 1/4	FNL OF 1/4 SEC	323'	FEL OF 1/4 SEC	250'		
ELEVATION N Derrick	Ground	1105'	Latitude (if known)	36.1299394				Longitude (if known)	97.827453530
OPERATOR NAME	Hinkle Oil & Gas, Inc.						OTC/OCC OPERATOR NO.	21639	
ADDRESS	5600 N. May Avenue, Suite 295								
CITY	Oklahoma City	STATE	OK	ZIP	73112				

SPUD DATE	12/24/2016
DRLG FINISHED DATE	1/10/2017
DATE OF WELL COMPLETION	3/25/2017
1st PROD DATE	12/12/2017
RECOMP DATE	

640 Acres

LOCATE WELL

COMPLETION TYPE

<input checked="" type="checkbox"/> SINGLE ZONE
<input type="checkbox"/> MULTIPLE ZONE
Application Date
<input type="checkbox"/> COMMINGLED
Application Date
LOCATION
EXCEPTION ORDER
INCREASED DENSITY
ORDER NO.

CASING & CEMENT (Form 1002C must be attached)

TYPE	SIZE	WEIGHT	GRADE	FEET	PSI	SAX	TOP OF CMT
CONDUCTOR	20"			120'		10 yds	Surface
SURFACE	9 5/8"	36#	NT95	382'		300	Surface
INTERMEDIATE							
PRODUCTION	7"	29#	P110	7001'		285	5305' (Calc)
LINER	4 1/2"	13.5#	P110	6855'-12,839'			FS
TOTAL DEPTH							12,841

PACKER @ _____ BRAND & TYPE _____ PLUG @ _____ TYPE _____
PACKER @ _____ BRAND & TYPE _____ PLUG @ _____ TYPE _____
PACKER @ _____ BRAND & TYPE _____ PLUG @ _____ TYPE _____

COMPLETION & TEST DATA BY PRODUCING FORMATION

FORMATION	Mississippian Solid
SPACING & SPACING ORDER NUMBER	61709 (unit)
CLASS: Oil, Gas, Dry, Inj, Disp, Comm Disp, Svc	Oil
PERFORATED INTERVALS	7614'-12,604' (6 spf) open hole
ACID/VOLUME	gals
FRACTURE TREATMENT (Fluids/Prop Amounts)	281148 g. 15% HCL 333836 Bbls. Wt. Bbls of Slickwater 6570108 # 30/50 Sand

☐ Min Gas Allowable (165:10-17-7)
OR
☐ Oil Allowable (165:10-13-3)

Gas Purchaser/Measurer
First Sales Date

INITIAL TEST DATA

INITIAL TEST DATE	12/12/2017
OIL-BBL/DAY	43
OIL-GRAVITY (API)	37.1
GAS-MCF/DAY	61
GAS-OIL RATIO CU FT/BBL	1418
WATER-BBL/DAY	2669
PUMPING OR FLOWING	Pumping
INITIAL SHUT-IN PRESSURE	N/A
CHOKE SIZE	Open
FLOW TUBING PRESSURE	N/A

AS SUBMITTED

A record of the formations drilled through, and pertinent remarks are presented on the reverse. I declare that I have knowledge of the contents of this report and am authorized by my organization to make this report, which was prepared by me or under my supervision and direction, with the data and facts stated herein to be true, correct, and complete to the best of my knowledge and belief.

SIGNATURE	Bruce A. Hinkle	DATE	12/13/2017	PHONE NUMBER	405-848-0924
ADDRESS	5600 N. May Avenue, Suite 295	CITY	Oklahoma City	STATE	OK
		ZIP	73112	EMAIL ADDRESS	Laurahinkle@hoagi.com

PLEASE TYPE OR USE BLACK INK ONLY

FORMATION RECORD

Give formation names and tops, if available, or descriptions and thickness of formations drilled through. Show intervals cored or drillstem tested.

NAMES OF FORMATIONS	TOP
Cottage Grove	5598' TVD
Checkerboard	6042'
Cleveland	6112'
Big Lime	6226'
2nd Oswego	6304'
3rd Oswego	6322'
4th Oswego	6373'
Verdigris	6343'
Pink Lime	6565'
Red Fork	6596'
Manning	6715'
Mississippi	6958'

LEASE NAME East Hennessey UnitWELL NO. 216H

FOR COMMISSION USE ONLY		
ITD on file	<input type="checkbox"/> YES	<input type="checkbox"/> NO
APPROVED	DISAPPROVED	2) Reject Codes
<div style="border: 1px solid black; height: 100px; width: 100%;"></div>		

Were open hole logs run?	<input type="checkbox"/> yes	<input checked="" type="checkbox"/> no
Date Last log was run		
Was CO ₂ encountered?	<input type="checkbox"/> yes	<input checked="" type="checkbox"/> no at what depths? _____
Was H ₂ S encountered?	<input type="checkbox"/> yes	<input checked="" type="checkbox"/> no at what depths? _____
Were unusual drilling circumstances encountered?	<input type="checkbox"/> yes	<input checked="" type="checkbox"/> no
If yes, briefly explain below		

Other remarks:

OCC- This well is an open hole completion from bottom of the 7" casing at 7001' to terminus at 12,841'. The 4 1/2" Liner is not cemented.

640 Acres

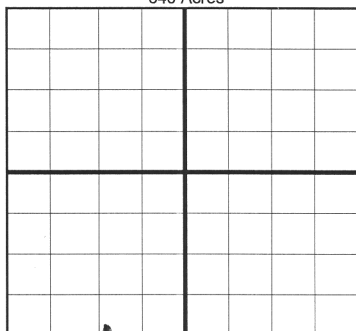

If more than three drainholes are proposed, attach a separate sheet indicating the necessary information.

Direction must be stated in degrees azimuth. Please note, the horizontal drainhole and its end point must be located within the boundaries of the lease or spacing unit.

Directional surveys are required for all drainholes and directional wells.

640 Acres

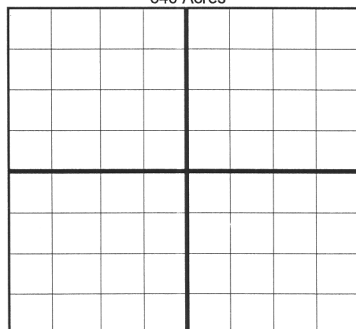

BOTTOM HOLE LOCATION FOR DIRECTIONAL HOLE

SEC	TWP	RGE	COUNTY
Spot Location			
1/4	1/4	1/4	1/4
Measured Total Depth		True Vertical Depth	BHL From Lease, Unit, or Property Line:

BOTTOM HOLE LOCATION FOR HORIZONTAL HOLE: (LATERALS)

LATERAL #1

SEC	TWP	RGE	COUNTY
15	19N	6W	Kingfisher
Spot Location			
SW 1/4	SW 1/4	SE 1/4	SW 1/4
Depth of Deviation		Radius of Turn	Direction
7031'		1524'	180 South
Measured Total Depth		True Vertical Depth	BHL From Lease, Unit, or Property Line:
12,841		7241'	X 18

LATERAL #2

SEC	TWP	RGE	COUNTY
Spot Location			
1/4	1/4	1/4	1/4
Depth of Deviation		Radius of Turn	Direction
Measured Total Depth		True Vertical Depth	BHL From Lease, Unit, or Property Line:

LATERAL #3

SEC	TWP	RGE	COUNTY
Spot Location			
1/4	1/4	1/4	1/4
Depth of Deviation		Radius of Turn	Direction
Measured Total Depth		True Vertical Depth	BHL From Lease, Unit, or Property Line: