

Oklahoma Corporation Commission
Oil & Gas Conservation Division
Post Office Box 52000
Oklahoma City, Oklahoma 73152-2000
Rule 165: 10-3-25

Form 1002A

API No.: 35109219940003

Completion Report

Spud Date: November 09, 1995

OTC Prod. Unit No.:

Drilling Finished Date: November 23, 1995

Amended

1st Prod Date: January 10, 1996

Amend Reason: TO SHOW CORRECTED PBDT

Completion Date: December 18, 1995

Recomplete Date: November 01, 2015

Drill Type: STRAIGHT HOLE

SERVICE WELL

Well Name: MCCOON (MCCOON 1-3) 3

Purchaser/Measurer:

Location: OKLAHOMA 3 14N 1W
S2 S2 NW NE
1460 FSL 660 FWL of 1/4 SEC
Derrick Elevation: 1144 Ground Elevation: 1138

First Sales Date:

Operator: CALLIE OIL COMPANY LLC 23711

344442 E 790 RD
AGRA, OK 74824-6317

Completion Type	Location Exception	Increased Density
Single Zone	Order No	Order No
Multiple Zone	There are no Location Exception records to display.	There are no Increased Density records to display.
Commingled		

Casing and Cement							
Type	Size	Weight	Grade	Feet	PSI	SAX	Top of CMT
SURFACE	8 5/8	24	K-55	508		350	SURFACE
PRODUCTION	4 1/2	10.5	J-55	4480		200	3810

Liner								
Type	Size	Weight	Grade	Length	PSI	SAX	Top Depth	Bottom Depth
LINER	3 1/2	9.0	J-55	2404	0	0	4220	6624

Total Depth: 6690

Packer		Plug	
Depth	Brand & Type	Depth	Plug Type
4380	ARROW 2	6396	CIBP

Initial Test Data

Test Date	Formation	Oil BBL/Day	Oil-Gravity (API)	Gas MCF/Day	Gas-Oil Ratio Cu FT/BBL	Water BBL/Day	Pumpin or Flowing	Initial Shut-In Pressure	Choke Size	Flow Tubing Pressure
-----------	-----------	-------------	-------------------	-------------	-------------------------	---------------	-------------------	--------------------------	------------	----------------------

There are no Initial Data records to display.

Completion and Test Data by Producing Formation

Formation Name: 2ND WILCOX

Code: 202WLCX2

Class: DISP

Spacing Orders

Order No	Unit Size
There are no Spacing Order records to display.	

Perforated Intervals

From	To
5980	6184

Acid Volumes

There are no Acid Volume records to display.
--

Fracture Treatments

There are no Fracture Treatments records to display.
--

Formation Name: VIOLA

Code: 202VIOL

Class: DISP

Spacing Orders

Order No	Unit Size
There are no Spacing Order records to display.	

Perforated Intervals

From	To
5735	5930

Acid Volumes

There are no Acid Volume records to display.
--

Fracture Treatments

There are no Fracture Treatments records to display.
--

Formation Name: CHECKERBOARD

Code: 405CCKB

Class: DISP

Spacing Orders

Order No	Unit Size
There are no Spacing Order records to display.	

Perforated Intervals

From	To
4663	4760

Acid Volumes

There are no Acid Volume records to display.
--

Fracture Treatments

There are no Fracture Treatments records to display.
--

Formation Name: HOGSHOOTER

Code: 405HGSR

Class: DISP

Spacing Orders

Order No	Unit Size
There are no Spacing Order records to display.	

Perforated Intervals

From	To
4460	4585

Acid Volumes

There are no Acid Volume records to display.
--

Fracture Treatments

There are no Fracture Treatments records to display.
--

Formation	Top
TONKAWA	3440
OSAGE LAYTON	4298

Were open hole logs run? Yes

Date last log run: November 23, 1995

Were unusual drilling circumstances encountered? No

HOGSHOOTER	4460
CHECKERBOARD	4663
OSWEGO	5206
VIOLA	5735
2ND WILCOX	5980
ARBUCKLE	6496

Explanation:

Other Remarks
3 1/2" LINER FROM 4,420' TO 6,624'. CALLIE OIL COMPANY, LLC ACQUIRED THE MCCOON 3-1 FROM THE TRUSTEE OF THE OPTIMA EXPLORATION, LLC BANKRUPTCY, EFFECTIVE DECEMBER 21, 2015. THE WELL WAS THE ERRONEOUSLY BELIEVED TO BE OPEN IN THE ARBUCKLE FROM 6,496' TO 6,624'. CALLIE OIL COMPANY, LLC CONFIRMED THAT A CIBP HAD BEEN SET IN THE 3 1/2" LINER AT 6,396' USING A GR-CCL. CALLIE OIL COMPANY, LLC SET A 2 SACK CEMENT PLUG ON THE CIBP AT 6,396'. UIC ORDER NUMBER 494929

FOR COMMISSION USE ONLY	
Status: Accepted	1138482

RECEIVED

DEC 20 2017

Form 1002A
Rev. 2009

OKLAHOMA CORPORATION
COMMISSION

API NO. **10921944**
OTC PROD.
UNIT NO.

PLEASE TYPE OR USE BLACK INK ONLY
NOTE:

Attach copy of original 1002A
if recompletion or reentry.

OKLAHOMA CORPORATION COMMISSION
Oil & Gas Conservation Division
Post Office Box 52000
Oklahoma City, Oklahoma 73152-2000
Rule 165:10-3-25

☐ ORIGINAL
☒ AMENDED (Reason)

To show corrected PBSD

COMPLETION REPORT

TYPE OF DRILLING OPERATION

☒ STRAIGHT HOLE ☐ DIRECTIONAL HOLE ☐ HORIZONTAL HOLE
☒ SERVICE WELL

If directional or horizontal, see reverse for bottom hole location.

COUNTY	OKLAHOMA	SEC	3	TWP	14N	RGE	1W
LEASE NAME	McCOON			WELL NO.	1-3		
ELEVATION	1144	Ground	1138	FSL OF 1/4 SEC	1460	FWL OF 1/4 SEC	660
Latitude (if known)				Longitude (if known)			
OPERATOR NAME	Callie Oil Company			OTC/OCC OPERATOR NO.	23711		
ADDRESS	344442 E. 790 ROAD						
CITY	AGRA	STATE	OK	ZIP	74824-6317		

SPUD DATE	11/9/1995
DRLG FINISHED DATE	11/23/1995
DATE OF WELL COMPLETION	12/18/1995
1st PROD DATE	1/10/1996
RECOMP DATE	11/1/2015

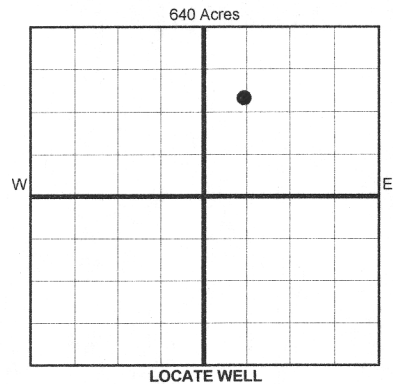

COMPLETION TYPE

SINGLE ZONE	
MULTIPLE ZONE	Disposal Well
Application Date	
COMINGLED	Order No. 494929
Application Date	
LOCATION	see remarks
EXCEPTION ORDER	
INCREASED DENSITY	
ORDER NO.	

CASING & CEMENT (Form 1002C must be attached)

TYPE	SIZE	WEIGHT	GRADE	FEET	PSI	SAX	TOP OF CMT
CONDUCTOR							
SURFACE	8 5/8"	24 lb./ft	K-55	508		350	Surface
INTERMEDIATE							
PRODUCTION	4 1/2"	10.5	J-55	4480		200	3810'
LINER	3 1/2"	9.0 lb./ft	J-55	2204* 4220-6624			
TOTAL DEPTH						6,690	

PACKER @ **4,380** BRAND & TYPE **Arrow 2** PLUG @ **6,396** TYPE **CIBP**** PLUG @ **6,396** TYPE **CIBP****
PACKER @ **6,396** BRAND & TYPE **Arrow 2** PLUG @ **6,396** TYPE **CIBP**** PLUG @ **6,396** TYPE **CIBP****

COMPLETION & TEST DATA BY PRODUCING FORMATION

FORMATION	2d Wilcox	Viola	Checkerboard	Hogshooter	
SPACING & SPACING ORDER NUMBER	494929	494929	494929	494929	see remarks
CLASS: Oil, Gas, Dry, Inj, Disp, Comm Disp, Svc	Disposal	Disposal	Disposal	Disposal	
PERFORATED INTERVALS	5980'-6184'	5735'-5930'	4663'-4760	4460'-4585'	
ACID/VOLUME					
FRACTURE TREATMENT (Fluids/Prop Amounts)					

Min Gas Allowable (165:10-17-7)

Gas Purchaser/Measurer

☐

OR

First Sales Date

INITIAL TEST DATA

INITIAL TEST DATE					
OIL-BBL/DAY					
OIL-GRAVITY (API)					
GAS-MCF/DAY					
GAS-OIL RATIO CU FT/BBL					
WATER-BBL/DAY					
PUMPING OR FLOWING					
INITIAL SHUT-IN PRESSURE					
CHOKE SIZE					
FLOW TUBING PRESSURE					

AS SUBMITTED

A record of the formations drilled through, and pertinent remarks are presented on the reverse. I declare that I have knowledge of the contents of this report and am authorized by my organization to make this report, which was prepared by me or under my supervision and direction, with the data and facts stated herein to be true, correct, and complete to the best of my knowledge and belief.

John E. Lee, III
SIGNATURE NAME (PRINT OR TYPE) DATE PHONE NUMBER
1800 Canyon Park Circle, Suite 201 Edmond OK 73013
ADDRESS CITY STATE ZIP
jlee@arwright.com
EMAIL ADDRESS

PLEASE TYPE OR USE BLACK INK ONLY

FORMATION RECORD

Give formation names and tops, if available, or descriptions and thickness of formations drilled through. Show intervals cored or drillstem tested.

LEASE NAME McCoonWELL NO. 1-3

NAMES OF FORMATIONS	TOP
Tonkawa	3,440
Osage Layton	4,298
Hogshooter	4460
Checkerboard	4,663
Oswego	5,206
Viola	5,735
2d Wilcox	5,980
Arbuckle	6,496

FOR COMMISSION USE ONLY		
ITD on file	<input type="checkbox"/> YES	<input type="checkbox"/> NO
APPROVED	DISAPPROVED	
2) Reject Codes		

Were open hole logs run?	<u>X</u> yes	no
Date Last log was run	<u>11/23/1995</u>	
Was CO ₂ encountered?	<u>X</u> yes	no at what depths?
Was H ₂ S encountered?	<u>X</u> yes	no at what depths?
Were unusual drilling circumstances encountered?	<u>X</u> yes no	
If yes, briefly explain below		

Other remarks: * 3 1/2" liner from 4,420' to 6,624'. ** Callie Oil Company, LLC acquired the McCoon No. 3-1 from the Trustee of the Optima Exploration, LLC Bankruptcy, effective 12-21-2015. The well was the erroneously believed to be open in the Arbuckle from 6,496' to 6624'. Callie Oil Company, LLC confirmed that a CIPB had been set in the 3 1/2" liner at 6,396' using a GR-CCL. Callie Oil Company, LLC set a 2-sack cement plug on the CIPB at 6,396'. *see order #494929*

640 Acres

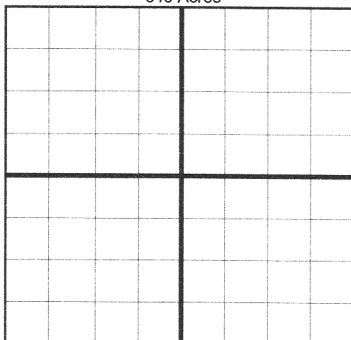

If more than three drainholes are proposed, attach a separate sheet indicating the necessary information.

Direction must be stated in degrees azimuth. Please note, the horizontal drainhole and its end point must be located within the boundaries of the lease or spacing unit.

Directional surveys are required for all drainholes and directional wells.

640 Acres

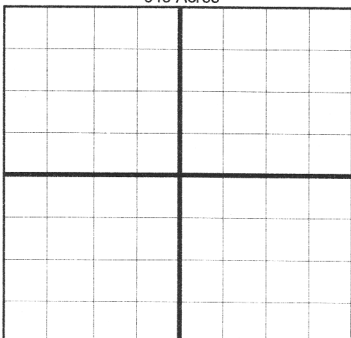

BOTTOM HOLE LOCATION FOR DIRECTIONAL HOLE

SEC	TWP	RGE	COUNTY
Spot Location	1/4	1/4	1/4
Measured Total Depth	True Vertical Depth		Feet From 1/4 Sec Lines
			FSL
			FWL
BHL From Lease, Unit, or Property Line:			

BOTTOM HOLE LOCATION FOR HORIZONTAL HOLE: (LATERALS)

LATERAL #1

SEC	TWP	RGE	COUNTY
Spot Location	1/4	1/4	1/4
Depth of Deviation	Radius of Turn		Direction
Measured Total Depth	True Vertical Depth		Total Length
			BHL From Lease, Unit, or Property Line:

LATERAL #2

SEC	TWP	RGE	COUNTY
Spot Location	1/4	1/4	1/4
Depth of Deviation	Radius of Turn		Direction
Measured Total Depth	True Vertical Depth		Total Length
			BHL From Lease, Unit, or Property Line:

LATERAL #3

SEC	TWP	RGE	COUNTY
Spot Location	1/4	1/4	1/4
Depth of Deviation	Radius of Turn		Direction
Measured Total Depth	True Vertical Depth		Total Length
			BHL From Lease, Unit, or Property Line: