

Oklahoma Corporation Commission  
Oil & Gas Conservation Division  
Post Office Box 52000  
Oklahoma City, Oklahoma 73152-2000  
Rule 165: 10-3-25

Form 1002A

API No.: 35051241680000

**Completion Report**

Spud Date: July 18, 2017

OTC Prod. Unit No.:

Drilling Finished Date: September 04, 2017

1st Prod Date: October 17, 2017

Completion Date: October 17, 2017

**Drill Type: HORIZONTAL HOLE**

Well Name: LAUPER 4-26H

Purchaser/Measurer:

Location: GRADY 26 4N 5W  
NW NE NE NW  
259 FNL 2199 FWL of 1/4 SEC  
Latitude: 34.79677023 Longitude: -97.69586231  
Derrick Elevation: 0 Ground Elevation: 1119

First Sales Date: 10/17/2017

Operator: GULFPORT MIDCON LLC 24020

3001 QUAIL SPRINGS PKWY  
OKLAHOMA CITY, OK 73134-2640

Completion Type		Location Exception		Increased Density	
X	Single Zone	Order No		Order No	
	Multiple Zone	667856		There are no Increased Density records to display.	
	Commingled				

Casing and Cement							
Type	Size	Weight	Grade	Feet	PSI	SAX	Top of CMT
CONDUCTOR	30	310	X-42	110			
SURFACE	20	94	J-55	598		1030	SURFACE
INTERMEDIATE	13 3/8	68	J-55	3745		1600	3001
INTERMEDIATE	9 5/8	40	P-110	11702		1025	4122
PRODUCTION	5 1/2	23	P-110	17637		3130	10097

Liner								
Type	Size	Weight	Grade	Length	PSI	SAX	Top Depth	Bottom Depth
LINER	7	26	P-110	1653	0	235	11488	13141

**Total Depth: 17655**

Packer	
Depth	Brand & Type
There are no Packer records to display.	

Plug	
Depth	Plug Type
There are no Plug records to display.	

Initial Test Data
-------------------

Test Date	Formation	Oil BBL/Day	Oil-Gravity (API)	Gas MCF/Day	Gas-Oil Ratio Cu FT/BBL	Water BBL/Day	Pumpin or Flowing	Initial Shut-In Pressure	Choke Size	Flow Tubing Pressure
Nov 03, 2017	SPRINGER	619	45	697	1126	1005	FLOWING	4100	34/64	

Completion and Test Data by Producing Formation									
Formation Name: SPRINGER				Code: 401SPRG			Class: OIL		
Spacing Orders				Perforated Intervals					
Order No		Unit Size		From			To		
218926		640		12790			17504		
Acid Volumes				Fracture Treatments					
1,248 BBLS 10% HCL				11,659,490 POUNDS SAND, 282,647 BARRELS FLUID					

Formation	Top
SPRINGER	12729

Were open hole logs run? No

Date last log run:

Were unusual drilling circumstances encountered? No

Explanation:

Other Remarks
RETURNED 138 SACKS TO SURFACE. OCC - THIS DOCUMENT IS ACCEPTED BASED ON THE DATA SUBMITTED THE FINAL LOCATION EXCEPTION HAS NOT BEEN ISSUED.

Lateral Holes
Sec: 26 TWP: 4N RGE: 5N County: GRADY  SW SE SE SW  27 FSL 2296 FWL of 1/4 SEC  Depth of Deviation: 12182 Radius of Turn: 382 Direction: 178 Total Length: 4714  Measured Total Depth: 17655 True Vertical Depth: 12782 End Pt. Location From Release, Unit or Property Line: 27

FOR COMMISSION USE ONLY
<div>Status: Accepted</div> <div>1138464</div>

# RECEIVED

Form 1002A  
Rev. 2009

API NO. 051-24168  
OTC PROD.  
UNIT NO.

PLEASE TYPE OR USE BLACK INK ONLY  
NOTE:

Attach copy of original 1002A  
if recompletion or reentry.

OKLAHOMA CORPORATION COMMISSION  
Oil & Gas Conservation Division  
Post Office Box 52000  
Oklahoma City, Oklahoma 73152-2000  
Rule 165:10-3-25

DEC 18 2017

OKLAHOMA CORPORATION  
COMMISSION

☒ ORIGINAL  
☐ AMENDED (Reason)

## COMPLETION REPORT

### TYPE OF DRILLING OPERATION

☐ STRAIGHT HOLE ☐ DIRECTIONAL HOLE ☒ HORIZONTAL HOLE  
☐ SERVICE WELL

If directional or horizontal, see reverse for bottom hole location.

COUNTY	Grady	SEC	26	TWP	4N	RGE	5W	SPUD DATE	7/18/17
LEASE NAME	Laufer			WELL NO.	4-26H			DRLG FINISHED DATE	9/4/17
NW 1/4 NE 1/4 NE 1/4 NW 1/4	FNL 259			FWL OF 1/4 SEC	2199			DATE OF WELL COMPLETION	10/17/17
ELEVATION	Ground	1119	Latitude (if known)	34.79677023			Longitude (if known)	-97.69586231	
OPERATOR NAME	Gulfport MidCon LLC				OTC/OCC OPERATOR NO.	24020			
ADDRESS	3001 Quail Springs Parkway								
CITY	Oklahoma City	STATE	OK	ZIP	73160				

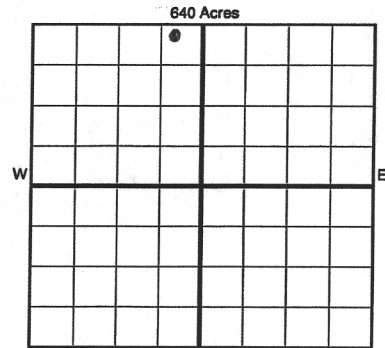

### COMPLETION TYPE

<input checked="" type="checkbox"/> SINGLE ZONE
<input type="checkbox"/> MULTIPLE ZONE
Application Date
COMINGLED
Application Date
LOCATION
EXCEPTION ORDER
INCREASED DENSITY ORDER NO.

667856 *L.O.*

### CASING & CEMENT (Form 1002C must be attached)

TYPE	SIZE	WEIGHT	GRADE	FEET	PSI	SAX	TOP OF CMT
CONDUCTOR	30	310	x42	110			
SURFACE	20	94	J55	598		1030	Surface
INTERMEDIATE	13 3/8	68	J55	3,745		1600	3,001
Intermediate	9 5/8	40	P-110	11,702		1025	4122
Production	5 1/2	23	P110	17,637		9130	10097
Liner	7	26	P110	13,141	-11488	235	1654
TOTAL DEPTH							17,655

PACKER @ \_\_\_\_\_ BRAND & TYPE \_\_\_\_\_ PLUG @ \_\_\_\_\_ TYPE \_\_\_\_\_ PLUG @ \_\_\_\_\_ TYPE \_\_\_\_\_  
PACKER @ \_\_\_\_\_ BRAND & TYPE \_\_\_\_\_ PLUG @ \_\_\_\_\_ TYPE \_\_\_\_\_ PLUG @ \_\_\_\_\_ TYPE \_\_\_\_\_

### COMPLETION & TEST DATA BY PRODUCING FORMATION

FORMATION	Springer						
SPACING & SPACING ORDER NUMBER	218926(640)						
CLASS: Oil, Gas, Dry, Inj, Disp, Comm Disp, Svc	Gas Oil per GOR						
PERFORATED INTERVALS	12,790-17504						
ACID/VOLUME	1248 bbls 10% HCL						
FRACTURE TREATMENT (Fluids/Prop Amounts)	11,659,490 lbs Sand						
	282,647 bbl Fluid						

Min Gas Allowable (165:10-17-7)



OR

Oil Allowable (165:10-13-3)

Gas Purchaser/Measurer  
First Sales Date

10/17/2017

### INITIAL TEST DATA

INITIAL TEST DATE	11/3/2017						
OIL-BBL/DAY	619						
OIL-GRAVITY (API)	45						
GAS-MCF/DAY	697						
GAS-OIL RATIO CU FT/BBL	1,126						
WATER-BBL/DAY	1,005						
PUMPING OR FLOWING	Flowing						
INITIAL SHUT-IN PRESSURE	4100						
CHOKE SIZE	34/64						
FLOW TUBING PRESSURE	N/A						

AS SUBMITTED

A record of the formations drilled through, and pertinent remarks are presented on the reverse. I declare that I have knowledge of the contents of this report and am authorized by my organization to make this report, which was prepared by me or under my supervision and direction, with the data and facts stated herein to be true, correct, and complete to the best of my knowledge and belief.

*Monica Pickens*  
SIGNATURE

Monica Pickens  
NAME (PRINT OR TYPE)

12/14/2017 405-252-4703  
DATE PHONE NUMBER

3001 Quail Springs Parkway  
ADDRESS

Oklahoma City  
CITY

OK  
STATE

73160  
ZIP

mpickens@gulfportenergy.com  
EMAIL ADDRESS

### TYPE OR USE DESCRIBE INFORMATION RECORD

LEASE NAME Lauper WELL NO. 4-26H

NAMES OF FORMATIONS	TOP
Springer	12,729

FOR COMMISSION USE ONLY	
ITD on file	<input type="checkbox"/> YES <input type="checkbox"/> NO
APPROVED	DISAPPROVED
2) Reject Codes	

Were open hole logs run?      \_\_\_ yes    X no

Date Last log was run                 N/A

Was CO<sub>2</sub> encountered?      \_\_\_ yes    X no    at what depths? \_\_\_\_\_

Was H<sub>2</sub>S encountered?      \_\_\_ yes    X no    at what depths? \_\_\_\_\_

Were unusual drilling circumstances encountered?      \_\_\_ yes    X no  
If yes, briefly explain below

Other remarks: Returned 138 sax to surface.

640 Acres

Direction must be stated in degrees azimuth.  
Please note, the horizontal drainhole and its end  
point must be located within the boundaries of the  
lease or spacing unit.

640 Acres

SEC	TWP	RGE	COUNTY			
Spot Location				Feet From 1/4 Sec Lines	FSL	FWL
1/4	1/4	1/4	1/4			
Measured Total Depth		True Vertical Depth		BHL From Lease, Unit, or Property Line:		

LATERAL #1										
SEC 26	TWP 04N	RGE 05N	COUNTY Grady							
Spot Location		SE 1/4		SE 1/4		SW 1/4		Feet From 1/4 Sec Lines	FSL 175 27	FWL 2295
Depth of Deviation		12,182		Radius of Turn		382		Direction 178	Total Length	4,714
Measured Total Depth		17,655		True Vertical Depth		12,782		BHL From Lease, Unit, or Property Line: 175 27		

LATERAL #2						
SEC	TWP	RGE	COUNTY			
Spot Location						
1/4	1/4	1/4	1/4	Feet From 1/4 Sec Lines	FSL	FWL
Depth of Deviation		Radius of Turn		Direction	Total Length	
Measured Total Depth		True Vertical Depth		BHL From Lease, Unit, or Property Line:		

LATERAL #3								
SEC	TWP	RGE	COUNTY					
Spot Location			1/4	1/4	1/4	Feet From 1/4 Sec Lines	FSL	FWL
Depth of Deviation		Radius of Turn		Direction		Total Length		
Measured Total Depth		True Vertical Depth		BHL From Lease, Unit, or Property Line:				