

Oklahoma Corporation Commission
Oil & Gas Conservation Division
Post Office Box 52000
Oklahoma City, Oklahoma 73152-2000
Rule 165: 10-3-25

Form 1002A

API No.: 35033036480001

Completion Report

Spud Date: October 18, 1957

OTC Prod. Unit No.:

Drilling Finished Date: October 22, 1957

Amended

1st Prod Date:

Amend Reason: TEMPORARILY ABANDONED / CHANGE WELL NAME AND NUMBER

Completion Date: March 11, 1958

Recomplete Date: June 27, 2018

Drill Type: STRAIGHT HOLE

Well Name: WALTERS FIELD UNIT TRACT 3 (E BILLS W-1) W-1

Purchaser/Measurer:

Location: COTTON 33 1S 10W
C SW
1320 FSL 1320 FWL of 1/4 SEC
Derrick Elevation: 0 Ground Elevation: 0

First Sales Date:

Operator: CLARK OPERATING INC 17923

2601 HARRISON STE 200
WICHITA FALLS, TX 76308-4030

Completion Type		Location Exception		Increased Density	
X	Single Zone	Order No		Order No	
	Multiple Zone	There are no Location Exception records to display.		There are no Increased Density records to display.	
	Commingled				

Casing and Cement							
Type	Size	Weight	Grade	Feet	PSI	SAX	Top of CMT
SURFACE	8 5/8	24		140		50	
PRODUCTION	4 1/2	9.5		2152		50	

Liner								
Type	Size	Weight	Grade	Length	PSI	SAX	Top Depth	Bottom Depth
There are no Liner records to display.								

Total Depth: 2171

Packer	
Depth	Brand & Type
There are no Packer records to display.	

Plug	
Depth	Plug Type
There are no Plug records to display.	

Initial Test Data										
Test Date	Formation	Oil BBL/Day	Oil-Gravity (API)	Gas MCF/Day	Gas-Oil Ratio Cu FT/BBL	Water BBL/Day	Pumpin or Flowing	Initial Shut-In Pressure	Choke Size	Flow Tubing Pressure
There are no Initial Data records to display.										

Completion and Test Data by Producing Formation

Formation Name: PRIDDY

Code: 406PRDD

Class: TA

Formation	Top
PRIDDY SAND	2154

Were open hole logs run? No

Date last log run:

Were unusual drilling circumstances encountered? No

Explanation:

Other Remarks

FILED WITH 1003A FOR TEMPORARILY ABANDONED. OCC - THIS WELL IS AN OPEN HOLE FROM BOTTOM OF THE 4 1/2" CASING AT 2,152' TO TOTAL DEPTH AT 2,171'.

FOR COMMISSION USE ONLY

1140295

Status: Accepted

API NO. **03303648**
OTC PROD.
UNIT NO.

PLEASE TYPE OR USE BLACK INK ONLY

NOTE:

Attach copy of original 1002A
if recompletion or reentry.

OKLAHOMA CORPORATION COMMISSION
Oil & Gas Conservation Division
Post Office Box 52000
Oklahoma City, Oklahoma 73152-2000
Rule 165:10-3-25

Form 1002A
Rev. 2009

☐ ORIGINAL
☒ AMENDED (Reason)

T & A / Change Well Name & number

COMPLETION REPORT

TYPE OF DRILLING OPERATION

☒ STRAIGHT HOLE ☐ DIRECTIONAL HOLE ☐ HORIZONTAL HOLE
☐ SERVICE WELL

If directional or horizontal, see reverse for bottom hole location.

COUNTY	Cotton	SEC	33	TWP	1S	RGE	10W
LEASE NAME	Walter Field Unit			WELL NO.	3W1		
1/4	1/4 C	1/4 SW 1/4	FSL OF 1/4 SEC	1320	FWL OF 1/4 SEC	1320	
ELEVATION	Ground			Latitude (if known)			
OPERATOR NAME	CLARK OPERATING INC			OTC/OCC OPERATOR NO.	17923		
ADDRESS	2601 Harrison, Suite 200						
CITY	Wichita Falls			STATE	TX	ZIP	76308

SPUD DATE **10-18-1957**
DRLG FINISHED DATE **10-22-1957**
DATE OF WELL COMPLETION **3-11-1958**
1st PROD DATE
RECOMP DATE **6-27-2018**
Longitude (if known)

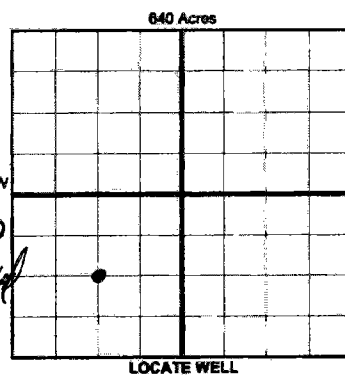

COMPLETION TYPE

☒ SINGLE ZONE
☐ MULTIPLE ZONE
Application Date
COMINGLED
Application Date
LOCATION
EXCEPTION ORDER
INCREASED DENSITY
ORDER NO.

CASING & CEMENT (Form 1002C must be attached)

TYPE	SIZE	WEIGHT	GRADE	FEET	PSI	SAX	TOP OF CMT
CONDUCTOR							
SURFACE	8 5/8	24		140		50	
INTERMEDIATE							
PRODUCTION	4 1/2	9.5		2152		50	
LINER							

PACKER @ _____ BRAND & TYPE _____ PLUG @ _____ TYPE _____ PLUG @ _____ TYPE _____
PACKER @ _____ BRAND & TYPE _____ PLUG @ _____ TYPE _____ PLUG @ _____ TYPE _____
TOTAL DEPTH **2171**

COMPLETION & TEST DATA BY PRODUCING FORMATION **406 PRDD**

FORMATION	Priddy Sand
SPACING & SPACING ORDER NUMBER	
CLASS: Oil, Gas, Dry, Inj, Disp, Comm Disp, Svc	TA
PERFORATED INTERVALS	open hole 2154-2165
ACID/VOLUME	
FRACTURE TREATMENT (Fluids/Prop Amounts)	

RECORDED

JUN 22 2018

OKLAHOMA CORPORATION COMMISSION
OKLAHOMA CITY

☐ Min Gas Allowable (165:10-17-7)
OR
☐ Oil Allowable (165:10-13-3)

Gas Purchaser/Measurer
First Sales Date

INITIAL TEST DATA

INITIAL TEST DATE	
OIL-BBL/DAY	
OIL-GRAVITY (API)	
GAS-MCF/DAY	
GAS-OIL RATIO CU FT/BBL	
WATER-BBL/DAY	
PUMPING OR FLOWING	
INITIAL SHUT-IN PRESSURE	
CHOKE SIZE	
FLOW TUBING PRESSURE	

AS SUBMITTED

A record of the formations drilled through, and pertinent remarks are presented on the reverse. I declare that I have knowledge of the contents of this report and am authorized by my organization to make this report, which was prepared by me or under my supervision and direction, with the data and facts stated herein to be true, correct, and complete to the best of my knowledge and belief.

Paul Clark **PAUL CLARK** **6-13-18** **940 704 0881**
SIGNATURE NAME (PRINT OR TYPE) DATE PHONE NUMBER
2601 Harrison, Ste 200 **Wichita Falls, TX 76308** **paul@wfdomain.com**
ADDRESS CITY STATE ZIP EMAIL ADDRESS

PLEASE TYPE OR USE BLACK INK ONLY
FORMATION RECORD

Give formation names and tops, if available, or descriptions and thickness of formations drilled through. Show intervals cored or drillstem tested.

LEASE NAME Walter Field Unit

WELL NO. 3W1

NAMES OF FORMATIONS	TOP
Priddy Sand	2154

FOR COMMISSION USE ONLY

ITD on file ☐ YES ☐ NO

APPROVED _____ DISAPPROVED _____

2) Reject Codes _____

Were open hole logs run? _____ yes _____ no

Date Last log was run _____

Was CO₂ encountered? _____ yes _____ no at what depths? _____

Was H₂S encountered? _____ yes _____ no at what depths? _____

Were unusual drilling circumstances encountered? _____ yes _____ no
If yes, briefly explain below _____

Other remarks:

Filed with 1003 A for T & A
OCC - This well is an open hole from bottom of the 4 1/2" casing
at 2152' to total depth at 2171'

640 Acres

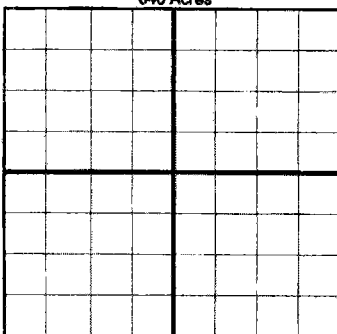

If more than three drainholes are proposed, attach a separate sheet indicating the necessary information.

Direction must be stated in degrees azimuth.
Please note, the horizontal drainhole and its end point must be located within the boundaries of the lease or spacing unit.

Directional surveys are required for all drainholes and directional wells.

640 Acres

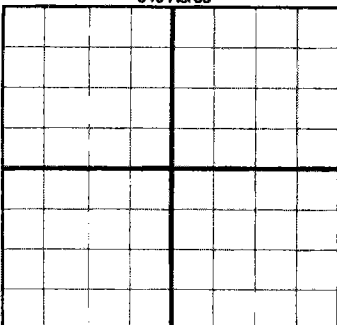

BOTTOM HOLE LOCATION FOR DIRECTIONAL HOLE

SEC	TWP	RGE	COUNTY
Spot Location	1/4	1/4	1/4
Measured Total Depth	True Vertical Depth		Feet From 1/4 Sec Lines FSL FWL
BHL From Lease, Unit, or Property Line:			

BOTTOM HOLE LOCATION FOR HORIZONTAL HOLE: (LATERALS)

LATERAL #1

SEC	TWP	RGE	COUNTY
Spot Location	1/4	1/4	1/4
Depth of Deviation	Radius of Turn	Direction	Total Length
Measured Total Depth	True Vertical Depth		BHL From Lease, Unit, or Property Line:

LATERAL #2

SEC	TWP	RGE	COUNTY
Spot Location	1/4	1/4	1/4
Depth of Deviation	Radius of Turn	Direction	Total Length
Measured Total Depth	True Vertical Depth		BHL From Lease, Unit, or Property Line:

LATERAL #3

SEC	TWP	RGE	COUNTY
Spot Location	1/4	1/4	1/4
Depth of Deviation	Radius of Turn	Direction	Total Length
Measured Total Depth	True Vertical Depth		BHL From Lease, Unit, or Property Line: