

Oklahoma Corporation Commission
Oil & Gas Conservation Division
Post Office Box 52000
Oklahoma City, Oklahoma 73152-2000
Rule 165: 10-3-25

Form 1002A

API No.: 35017212390002

Completion Report

Spud Date: March 02, 1979

OTC Prod. Unit No.:

Drilling Finished Date: April 12, 1979

Amended

1st Prod Date:

Amend Reason: CHANGED TO COMMERCIAL DISPOSAL WELL

Completion Date: May 15, 1979

Recomplete Date: February 20, 2018

Drill Type: STRAIGHT HOLE

SERVICE WELL

Well Name: HANSKA 1

Purchaser/Measurer:

Location: CANADIAN 24 12N 6W
C NE SW
1980 FSL 1980 FWL of 1/4 SEC
Derrick Elevation: 1310 Ground Elevation: 1296

First Sales Date:

Operator: S & S STAR OPERATING LLC 23996

13190 N MACARTHUR BLVD
OKLAHOMA CITY, OK 73142-3017

| Completion Type | | Location Exception | | Increased Density | |
|-----------------|---------------|---|--|--|--|
| | Single Zone | Order No | | Order No | |
| | Multiple Zone | There are no Location Exception records to display. | | There are no Increased Density records to display. | |
| | Commingled | | | | |

| Casing and Cement | | | | | | | |
|-------------------|-------|--------|-------|------|-----|-----|------------|
| Type | Size | Weight | Grade | Feet | PSI | SAX | Top of CMT |
| SURFACE | 8 5/8 | 32 | K-55 | 1249 | | 700 | SURFACE |
| PRODUCTION | 5 1/2 | 17 | K-55 | 9230 | | 700 | 1850 |

| Liner | | | | | | | | |
|--|------|--------|-------|--------|-----|-----|-----------|--------------|
| Type | Size | Weight | Grade | Length | PSI | SAX | Top Depth | Bottom Depth |
| There are no Liner records to display. | | | | | | | | |

Total Depth: 9230

| Packer | | Plug | |
|--------|--------------|-------|-----------|
| Depth | Brand & Type | Depth | Plug Type |
| 2725 | ARROW | 6500 | CIBP |

| Initial Test Data |
|-------------------|
|-------------------|

| Test Date | Formation | Oil BBL/Day | Oil-Gravity (API) | Gas MCF/Day | Gas-Oil Ratio Cu FT/BBL | Water BBL/Day | Pumpin or Flowing | Initial Shut- In Pressure | Choke Size | Flow Tubing Pressure |
|-----------|-----------|----------------|----------------------|----------------|----------------------------|------------------|----------------------|---------------------------------|---------------|-------------------------|
|-----------|-----------|----------------|----------------------|----------------|----------------------------|------------------|----------------------|---------------------------------|---------------|-------------------------|

There are no Initial Data records to display.

Completion and Test Data by Producing Formation

Formation Name: WOLFCAMPIAN Code: 451WFMP Class: COMM DISP

| Spacing Orders | | Perforated Intervals | |
|--|-----------|----------------------|------|
| Order No | Unit Size | From | To |
| There are no Spacing Order records to display. | | 2740 | 3645 |
| Acid Volumes | | Fracture Treatments | |
| 15,000 GALLONS 15% HCL | | NONE | |

Formation Name: VIRGILIAN Code: 406VRGN Class: COMM DISP

| Spacing Orders | | Perforated Intervals | |
|--|-----------|----------------------|------|
| Order No | Unit Size | From | To |
| There are no Spacing Order records to display. | | 4615 | 5970 |
| Acid Volumes | | Fracture Treatments | |
| ACIDIZED WITH WOLFCAMPIAN | | NONE | |

| Formation | Top |
|------------------|------|
| WOLFCAMPIAN 3310 | 2700 |
| VIRGILIAN | 4600 |

Were open hole logs run? Yes
Date last log run:

Were unusual drilling circumstances encountered? No
Explanation:

| Other Remarks |
|---|
| OCC - UIC PERMIT NUMBER 1804159143. OPERATOR SQUEEZED CEMENT ON 5 1/2" CASING AT 6,500', USED 500 SACKS OF CEMENT, LIFTED CEMENT TO 1,850'. |

| FOR COMMISSION USE ONLY |
|--|
| <div>Status: Accepted</div> <div>1140324</div> |

RECEIVED

JUN 29 2018

Form 1002A
Rev. 2009API NO. 017-21239
OTC PROD.
UNIT NO.PLEASE TYPE OR USE BLACK INK ONLY
NOTE:Attach copy of original 1002A
if recompletion or reentry.OKLAHOMA CORPORATION COMMISSION
Oil & Gas Conservation Division
Post Office Box 52000
Oklahoma City, Oklahoma 73152-2000
Rule 165:10-3-25OKLAHOMA CORPORATION
COMMISSION☐ ORIGINAL
☒ AMENDED (Reason)

CHANGED TO COM DISP WELL

COMPLETION REPORT

TYPE OF DRILLING OPERATION

☒ STRAIGHT HOLE ☐ DIRECTIONAL HOLE ☐ HORIZONTAL HOLE
☒ SERVICE WELL

If directional or horizontal, see reverse for bottom hole location.

| | | | | | | | |
|---------------------|--------------------------|--------|-------|----------------------|----------------------|----------------|------|
| COUNTY | CANADIAN | SEC | 24 | TWP | 12N | RGE | 6W |
| LEASE NAME | HANSKA | | | WELL NO. | 1 | | |
| 1/4 C | 1/4 NE | 1/4 SW | 1/4 | FSL OF 1/4 SEC | 1980 | FWL OF 1/4 SEC | 1980 |
| ELEVATION N Derrick | 1310 | Ground | 1296 | Latitude (if known) | Longitude (if known) | | |
| OPERATOR NAME | S & S STAR OPERATING LLC | | | OTC/OCC OPERATOR NO. | 23996 | | |
| ADDRESS | 13182 MACARTHUR BL | | | | | | |
| CITY | OKLAHOMA CITY, | | STATE | OK | ZIP | 73142 | |

SPUD DATE 3/2/1979

DRLG FINISHED DATE 4/12/1979

DATE OF WELL COMPLETION 5/15/1979

1st PROD DATE

RECOMP DATE 2/20/2018

Longitude (if known)

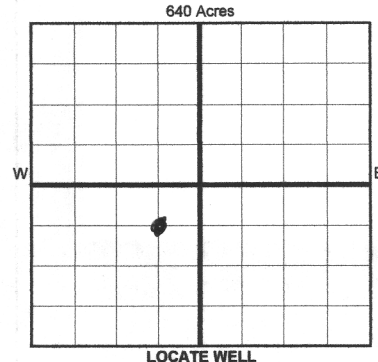

COMPLETION TYPE

| |
|-------------------|
| SINGLE ZONE |
| MULTIPLE ZONE |
| Application Date |
| COMMINGLED |
| Application Date |
| LOCATION |
| EXCEPTION ORDER |
| INCREASED DENSITY |
| ORDER NO. |

CASING & CEMENT (Form 1002C must be attached)

| TYPE | SIZE | WEIGHT | GRADE | FEET | PSI | SAX | TOP OF CMT |
|--------------|--------|--------|-------|-------|-----|-----|------------|
| CONDUCTOR | | | | | | | |
| SURFACE | 8 5/8" | 32# | K-55 | 1249 | | 700 | SURFACE |
| INTERMEDIATE | 5 1/2" | 17# | K-55 | 6,500 | | 500 | 1,850 |
| PRODUCTION | 5 1/2" | 17# | K-55 | 9230 | | 700 | 7020 |
| LINER | | | | | | | PBTD 6500 |
| | | | | | | | 9,230 |

PACKER @ 2,725 BRAND & TYPE ARROW

PLUG @ 6500

TYPE CIBP

PLUG @

TYPE

TOTAL DEPTH

PACKER @ BRAND & TYPE

PLUG @

TYPE

PLUG @

TYPE

COMPLETION & TEST DATA BY PRODUCING FORMATION

| | | | |
|---|------------------------|---------------------------|---------------|
| FORMATION | Wolfcampian, Virgilian | Virgilian | No Frac |
| SPACING & SPACING ORDER NUMBER | COM-DISP PERMIT | 1804159143 | (see remarks) |
| CLASS: Oil, Gas, Dry, Inj, Disp, Comm Disp, Svc | COM DISP | | |
| PERFORATED INTERVALS | 2740-3645 (OA) | 4615-5970 (OA) | |
| ACID/VOLUME | 15,000 gal 15% hcl | Acidized with Wolfcampian | |
| FRACTURE TREATMENT (Fluids/Prop Amounts) | None | None | |

Min Gas Allowable

(165:10-17-7)

Gas Purchaser/Measurer

First Sales Date

INITIAL TEST DATA

☐

Oil Allowable

(165:10-13-3)

| | |
|--------------------------|------------------|
| INITIAL TEST DATE | NA DISPOSAL WELL |
| OIL-BBL/DAY | |
| OIL-GRAVITY (API) | |
| GAS-MCF/DAY | |
| GAS-OIL RATIO CU FT/BBL | |
| WATER-BBL/DAY | |
| PUMPING OR FLOWING | |
| INITIAL SHUT-IN PRESSURE | |
| CHOKE SIZE | |
| FLOW TUBING PRESSURE | |

AS SUBMITTED

A record of the formations drilled through, and pertinent remarks are presented on the reverse. I declare that I have knowledge of the contents of this report and am authorized by my organization to make this report, which was prepared by me or under my supervision and direction, with the data and facts stated herein to be true, correct, and complete to the best of my knowledge and belief.

| | | | | | |
|--------------------------|--------------------------------|-------|-----------|------------------|--------------|
| SIGNATURE | Saleem Nizami-Consultant agent | DATE | 6/21/2018 | PHONE NUMBER | 405-513-6055 |
| S&S STAR 13182 MACARTHUR | OKLA CITY | OK | 73142 | APECPAEC@MSN.COM | |
| ADDRESS | CITY | STATE | ZIP | EMAIL ADDRESS | |

PLEASE TYPE OR USE BLACK INK ONLY
FORMATION RECORD

Give formation names and tops, if available, or descriptions and thickness of formations drilled through. Show intervals cored or drillstem tested.

LEASE NAME HANSKA WELL NO. 1

| NAMES OF FORMATIONS | TOP |
|---------------------|-------|
| WOLFCAMPIAN 3310 | 2,700 |
| VIRGILIAN | 4,600 |

| FOR COMMISSION USE ONLY | |
|--|-------------------|
| ITD on file <input type="checkbox"/> YES <input type="checkbox"/> NO | |
| APPROVED _____ | DISAPPROVED _____ |
| 2) Reject Codes | |
| _____ | |
| _____ | |
| _____ | |
| _____ | |

| | |
|--|---|
| Were open hole logs run? | <input checked="" type="checkbox"/> yes <input type="checkbox"/> no |
| Date Last log was run | _____ |
| Was CO ₂ encountered? | <input type="checkbox"/> yes <input checked="" type="checkbox"/> no at what depths? _____ |
| Was H ₂ S encountered? | <input type="checkbox"/> yes <input checked="" type="checkbox"/> no at what depths? _____ |
| Were unusual drilling circumstances encountered? | <input type="checkbox"/> yes <input checked="" type="checkbox"/> no |
| If yes, briefly explain below | |

Other remarks: *OCC- UIC permit #1804159143*
Operator squeezed cement on 5 1/2" casing at 6500' used 500 sacks of
cement lifted cement to 1850'

640 Acres

| | | | | | | | | | |
|--|--|--|--|--|--|--|--|--|--|
| | | | | | | | | | |
| | | | | | | | | | |
| | | | | | | | | | |
| | | | | | | | | | |
| | | | | | | | | | |
| | | | | | | | | | |
| | | | | | | | | | |
| | | | | | | | | | |
| | | | | | | | | | |
| | | | | | | | | | |

If more than three drainholes are proposed, attach a separate sheet indicating the necessary information.

Direction must be stated in degrees azimuth. Please note, the horizontal drainhole and its end point must be located within the boundaries of the lease or spacing unit.

Directional surveys are required for all drainholes and directional wells.

640 Acres

| | | | | | | | | | |
|--|--|--|--|--|--|--|--|--|--|
| | | | | | | | | | |
| | | | | | | | | | |
| | | | | | | | | | |
| | | | | | | | | | |
| | | | | | | | | | |
| | | | | | | | | | |
| | | | | | | | | | |
| | | | | | | | | | |
| | | | | | | | | | |
| | | | | | | | | | |

BOTTOM HOLE LOCATION FOR DIRECTIONAL HOLE

| SEC | TWP | RGE | COUNTY |
|----------------------|-----|---------------------|---|
| Spot Location | | | |
| 1/4 | 1/4 | 1/4 | 1/4 |
| Measured Total Depth | | True Vertical Depth | BHL From Lease, Unit, or Property Line: |
| | | | |

BOTTOM HOLE LOCATION FOR HORIZONTAL HOLE: (LATERALS)

| LATERAL #1 | | | |
|----------------------|-----|---------------------|---|
| SEC | TWP | RGE | COUNTY |
| Spot Location | | | |
| 1/4 | 1/4 | 1/4 | 1/4 |
| Depth of Deviation | | Radius of Turn | Direction |
| Measured Total Depth | | True Vertical Depth | Total Length |
| | | | BHL From Lease, Unit, or Property Line: |
| | | | |

| LATERAL #2 | | | |
|----------------------|-----|---------------------|---|
| SEC | TWP | RGE | COUNTY |
| Spot Location | | | |
| 1/4 | 1/4 | 1/4 | 1/4 |
| Depth of Deviation | | Radius of Turn | Direction |
| Measured Total Depth | | True Vertical Depth | Total Length |
| | | | BHL From Lease, Unit, or Property Line: |
| | | | |

| LATERAL #3 | | | |
|----------------------|-----|---------------------|---|
| SEC | TWP | RGE | COUNTY |
| Spot Location | | | |
| 1/4 | 1/4 | 1/4 | 1/4 |
| Depth of Deviation | | Radius of Turn | Direction |
| Measured Total Depth | | True Vertical Depth | Total Length |
| | | | BHL From Lease, Unit, or Property Line: |
| | | | |