

Oklahoma Corporation Commission  
Oil & Gas Conservation Division  
Post Office Box 52000  
Oklahoma City, Oklahoma 73152-2000  
Rule 165: 10-3-25

Form 1002A

API No.: 35143243160001

**Completion Report**

Spud Date: August 14, 2015

OTC Prod. Unit No.:

Drilling Finished Date: August 20, 2015

1st Prod Date: August 25, 2015

Completion Date: August 20, 2015

**Drill Type: STRAIGHT HOLE**

Well Name: QUINTON 4

Purchaser/Measurer:

Location: TULSA 18 20N 13E  
NW SE SE SE  
366 FSL 2188 FWL of 1/4 SEC  
Derrick Elevation: 0 Ground Elevation: 0

First Sales Date:

Operator: CROSE OIL COMPANY 10281  
PO BOX 504  
4000 CLUCK RD (CLAREMORE)  
COLLINSVILLE, OK 74021-0504

Completion Type		Location Exception		Increased Density	
X	Single Zone	Order No		Order No	
	Multiple Zone	There are no Location Exception records to display.		There are no Increased Density records to display.	
	Commingled				

Casing and Cement							
Type	Size	Weight	Grade	Feet	PSI	SAX	Top of CMT
SURFACE	7			180		40	SURFACE
PRODUCTION	4 1/2			1100		160	SURFACE

Liner								
Type	Size	Weight	Grade	Length	PSI	SAX	Top Depth	Bottom Depth
There are no Liner records to display.								

**Total Depth: 1100**

Packer		Plug	
Depth	Brand & Type	Depth	Plug Type
There are no Packer records to display.		There are no Plug records to display.	

Initial Test Data										
Test Date	Formation	Oil BBL/Day	Oil-Gravity (API)	Gas MCF/Day	Gas-Oil Ratio Cu FT/BBL	Water BBL/Day	Pumpin or Flowing	Initial Shut-In Pressure	Choke Size	Flow Tubing Pressure
Aug 20, 2015	BARTLESVILLE	3	32			30	PUMPING			

Completion and Test Data by Producing Formation			
Formation Name: BARTLESVILLE		Code: 404BRVL	Class: OIL
<b>Spacing Orders</b>		<b>Perforated Intervals</b>	
<b>Order No</b>	<b>Unit Size</b>	<b>From</b>	<b>To</b>
There are no Spacing Order records to display.		1060	1080
<b>Acid Volumes</b>		<b>Fracture Treatments</b>	
There are no Acid Volume records to display.		There are no Fracture Treatments records to display.	

Formation	Top
BARTLESVILLE	1075

Were open hole logs run? No  
Date last log run: August 20, 2015  
  
Were unusual drilling circumstances encountered? No  
Explanation:

Other Remarks
STATUS CHANGED FROM DISPOSAL TO PRODUCER

FOR COMMISSION USE ONLY	
Status: Accepted	1137779

API NO. 143-24316  
OTC PROD.  
UNIT NO.

PLEASE TYPE OR USE BLACK INK ONLY

NOTE:

Attach copy of original 1002A  
if recompletion or reentry.

OKLAHOMA CORPORATION COMMISSION

Oil & Gas Conservation Division

Post Office Box 52000

Oklahoma City, Oklahoma 73152-2000

Rule 165-10-3-25

RECEIVED  
OKLAHOMA CORPORATION  
COMMISSION

OCT 03 2017

Form 1002A

Rev. 2009

OIL & GAS CONSERVATION

☒ ORIGINAL  
☐ AMENDED (Reason) \_\_\_\_\_

TYPE OF DRILLING OPERATION

☒ STRAIGHT HOLE ☐ DIRECTIONAL HOLE ☐ HORIZONTAL HOLE  
☐ SERVICE WELL

If directional or horizontal, see reverse for bottom hole location.

COUNTY Tulsa SEC 18 TWP 20N RGE 13E  
LEASE NAME Quinton WELL NO. 4  
NW 1/4 SE 1/4 SE 1/4 SE 1/4 FSL OF 1/4 SEC 366 FWL OF 1/4 SEC 2188  
ELEVATION Ground Latitude (if known)

OPERATOR NAME CROSE Oil Company

OTC/OCC OPERATOR NO. 10281

ADDRESS P.O. Box 504

CITY Collinsville STATE OK ZIP 74021

COMPLETION REPORT

SPUD DATE 8-14-15  
DRLG FINISHED DATE 8-20-15  
DATE OF WELL COMPLETION 8-20-16  
1st PROD DATE 8-25-16  
RECOMP DATE  
Longitude (if known)

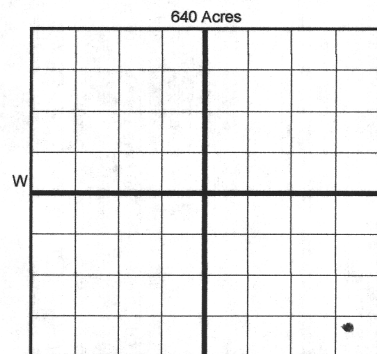

COMPLETION TYPE

☒ SINGLE ZONE  
☐ MULTIPLE ZONE  
Application Date  
COMMINGLED  
Application Date  
LOCATION  
EXCEPTION ORDER  
INCREASED DENSITY  
ORDER NO.

CASING & CEMENT (Form 1002C must be attached)

TYPE	SIZE	WEIGHT	GRADE	FEET	PSI	SAX	TOP OF CMT
CONDUCTOR							
SURFACE	<u>7"</u>			<u>180</u>		<u>40</u>	<u>SURFACE</u>
INTERMEDIATE							
PRODUCTION	<u>4 1/2"</u>			<u>1100</u>		<u>160</u>	<u>SURFACE</u>
LINER							

PACKER @ \_\_\_\_\_ BRAND & TYPE \_\_\_\_\_

PLUG @ \_\_\_\_\_ TYPE \_\_\_\_\_

TOTAL DEPTH 1100

PACKER @ \_\_\_\_\_ BRAND & TYPE \_\_\_\_\_

PLUG @ \_\_\_\_\_ TYPE \_\_\_\_\_

COMPLETION & TEST DATA BY PRODUCING FORMATION

FORMATION	<u>Birtlesville</u>						
SPACING & SPACING ORDER NUMBER	<u>NONE</u>						
CLASS: Oil, Gas, Dry, Inj, Disp, Comm Disp, Svc	<u>oil</u>						
PERFORATED INTERVALS	<u>1060-1080</u>						
ACID/VOLUME							
FRACTURE TREATMENT (Fluids/Prop Amounts)							

Min Gas Allowable (165-10-17-7)

Gas Purchaser/Measurer

INITIAL TEST DATA

OR  
Oil Allowable (165-10-13-3)

First Sales Date

INITIAL TEST DATE	<u>8-20-16</u>						
OIL-BBL/DAY	<u>3</u>						
OIL-GRAVITY (API)	<u>32</u>						
GAS-MCF/DAY							
GAS-OIL RATIO CU FT/BBL							
WATER-BBL/DAY	<u>30</u>						
PUMPING OR FLOWING	<u>PUMPING</u>						
INITIAL SHUT-IN PRESSURE							
CHOKE SIZE							
FLOW TUBING PRESSURE							

AS SUBMITTED

A record of the formations drilled through, and pertinent remarks are presented on the reverse. I declare that I have knowledge of the contents of this report and am authorized by my organization to make this report, which was prepared by me or under my supervision and direction, with the data and facts stated herein to be true, correct, and complete to the best of my knowledge and belief.

Roger Comasghan  
SIGNATURE

Roger Comasghan  
NAME (PRINT OR TYPE)

9-25-17 918-527-0460  
DATE PHONE NUMBER

P.O. Box 504 Collinsville  
ADDRESS

OK 74021  
CITY STATE ZIP

welltestllc@hotmail.com  
EMAIL ADDRESS

PLEASE TYPE OR USE BLACK INK ONLY  
FORMATION RECORD

Give formation names and tops, if available, or descriptions and thickness of formations drilled through. Show intervals cored or drillstem tested.

NAMES OF FORMATIONS	TOP
Barksville	1075

LEASE NAME

Quinton

WELL NO.

4

FOR COMMISSION USE ONLY

ITD on file ☐ YES ☐ NO

APPROVED DISAPPROVED

2) Reject Codes

Were open hole logs run?

yes ☒ no

Date Last log was run

2-3-16

Was CO<sub>2</sub> encountered?

yes ☒ no at what depths?

Was H<sub>2</sub>S encountered?

yes ☒ no at what depths?

Were unusual drilling circumstances encountered?  
If yes, briefly explain below

yes ☒ no

Other remarks:

STATUS CHANGED FROM DISPOSAL TO PRODUCER

640 Acres

If more than three drainholes are proposed, attach a separate sheet indicating the necessary information.

Direction must be stated in degrees azimuth.  
Please note, the horizontal drainhole and its end point must be located within the boundaries of the lease or spacing unit.

Directional surveys are required for all drainholes and directional wells.

640 Acres

BOTTOM HOLE LOCATION FOR DIRECTIONAL HOLE

SEC	TWP	RGE	COUNTY
Spot Location	1/4	1/4	1/4
Measured Total Depth	True Vertical Depth	BHL From Lease, Unit, or Property Line:	

BOTTOM HOLE LOCATION FOR HORIZONTAL HOLE: (LATERALS)

LATERAL #1

SEC	TWP	RGE	COUNTY
Spot Location	1/4	1/4	1/4
Depth of Deviation	Radius of Turn	Direction	Total Length
Measured Total Depth	True Vertical Depth	BHL From Lease, Unit, or Property Line:	

LATERAL #2

SEC	TWP	RGE	COUNTY
Spot Location	1/4	1/4	1/4
Depth of Deviation	Radius of Turn	Direction	Total Length
Measured Total Depth	True Vertical Depth	BHL From Lease, Unit, or Property Line:	

LATERAL #3

SEC	TWP	RGE	COUNTY
Spot Location	1/4	1/4	1/4
Depth of Deviation	Radius of Turn	Direction	Total Length
Measured Total Depth	True Vertical Depth	BHL From Lease, Unit, or Property Line:	