

Oklahoma Corporation Commission
Oil & Gas Conservation Division
Post Office Box 52000
Oklahoma City, Oklahoma 73152-2000
Rule 165: 10-3-25

Form 1002A

API No.: 35049251480001

Completion Report

Spud Date: July 22, 2017

OTC Prod. Unit No.: 049-222861

Drilling Finished Date: August 05, 2017

1st Prod Date: December 19, 2017

Completion Date: November 28, 2017

Drill Type: DIRECTIONAL HOLE

Min Gas Allowable: Yes

Well Name: G I FERGUSON 2-3

Purchaser/Measurer: ONEOK

Location: GARVIN 3 1N 3W
NW SE SW SE
420 FSL 792 FWL of 1/4 SEC
Derrick Elevation: 986 Ground Elevation: 966

First Sales Date: 12/19/2017

Operator: IRON STAR ENERGY LLC 23355
PO BOX 163793
401 S BOSTON AVE STE 325 (TULSA)
AUSTIN, TX 78716-3793

Completion Type		Location Exception		Increased Density	
	Single Zone		Order No		Order No
	Multiple Zone		670526		670917
X	Commingled				

Casing and Cement							
Type	Size	Weight	Grade	Feet	PSI	SAX	Top of CMT
CONDUCTOR	20			40			SURFACE
SURFACE	9 5/8	36	J-55	1095		400	SURFACE
PRODUCTION	5 1/2	20	P-110	10850		1350	3950

Liner								
Type	Size	Weight	Grade	Length	PSI	SAX	Top Depth	Bottom Depth
There are no Liner records to display.								

Total Depth: 10851

Packer	
Depth	Brand & Type
There are no Packer records to display.	

Plug	
Depth	Plug Type
There are no Plug records to display.	

Initial Test Data

Test Date	Formation	Oil BBL/Day	Oil-Gravity (API)	Gas MCF/Day	Gas-Oil Ratio Cu FT/BBL	Water BBL/Day	Pumpin or Flowing	Initial Shut-In Pressure	Choke Size	Flow Tubing Pressure
Dec 19, 2017	SYCAMORE- WOODFORD-HUNTON- VIOLA	200	39	1000	5000	500	FLOWING	1100	48/64	400

Completion and Test Data by Producing Formation

Formation Name: SYCAMORE

Code: 352SCMR

Class: OIL

Spacing Orders

Order No	Unit Size
176475	80

Perforated Intervals

From	To
8141	9510

Acid Volumes

There are no Acid Volume records to display.

Fracture Treatments

30,990 BARRELS, 333,697 POUNDS

Formation Name: WOODFORD

Code: 319WDFD

Class: OIL

Spacing Orders

Order No	Unit Size
656178	80

Perforated Intervals

From	To
8347	9802

Acid Volumes

There are no Acid Volume records to display.

Fracture Treatments

37,306 BARRELS, 429,398 POUNDS

Formation Name: HUNTON

Code: 269HNTN

Class: OIL

Spacing Orders

Order No	Unit Size
656178	80

Perforated Intervals

From	To
9065	10021

Acid Volumes

There are no Acid Volume records to display.

Fracture Treatments

15,385 BARRELS, 160,766 POUNDS

Formation Name: VIOLA

Code: 202VIOL

Class: OIL

Spacing Orders

Order No	Unit Size
656178	80

Perforated Intervals

From	To
10190	10693

Acid Volumes

There are no Acid Volume records to display.

Fracture Treatments

30,758 BARRELS, 321,319 POUNDS

Formation Name: SYCAMORE-WOODFORD-
HUNTON-VIOLA

Code:

Class: OIL

Formation	Top
PONTOTOC - CASING LIME MARKER	1641
EOLA CONGLOMERATE	3118
OVERTHRUST ARBUCKLE	4016
FAULT TO OIL CREEK	4808
FAULT TO GODDARD	6111
CANEY	7988
SYCAMORE	8077
WOODFORD	8347
HUNTON	9066
FAULT TO CANEY / SYCAMORE	9074
WOODFORD	9514
HUNTON	9841
SYLVAN	10021
VIOLA	10190
BROMIDE GREEN SHALE	10750

Were open hole logs run? Yes
Date last log run: August 05, 2017

Were unusual drilling circumstances encountered? No
Explanation:

Other Remarks
COMMINGLING ORDER NUMBER 671296

Bottom Holes
<p>Sec: 3 TWP: 1N RGE: 3W County: GARVIN</p> <p>SW SE SW SE</p> <p>185 FSL 772 FWL of 1/4 SEC</p> <p>Depth of Deviation: 0 Radius of Turn: 0 Direction: 0 Total Length: 0</p> <p>Measured Total Depth: 10850 True Vertical Depth: 10841 End Pt. Location From Release, Unit or Property Line: 185</p>

FOR COMMISSION USE ONLY
<div>Status: Accepted</div> <div>1138867</div>

API NO. 049-25148
OTC PROD. UNIT NO. 049-222861

PLEASE TYPE OR USE BLACK INK ONLY
NOTE:

Attach copy of original 1002A
if recompletion or reentry.

OKLAHOMA CORPORATION COMMISSION
Oil & Gas Conservation Division
Post Office Box 52000
Oklahoma City, Oklahoma 73152-2000
Rule 165:10-3-25

RECEIVED

FEB 16 2018

OKLAHOMA CORPORATION
COMMISSION

Form 1002A
Rev. 2009

☒ ORIGINAL
☐ AMENDED (Reason) _____

COMPLETION REPORT

TYPE OF DRILLING OPERATION

☐ STRAIGHT HOLE ☒ DIRECTIONAL HOLE ☐ HORIZONTAL HOLE
☐ SERVICE WELL

If directional or horizontal, see reverse for bottom hole location.

COUNTY	Garvin	SEC	3	TWP	1N	RGE	3W
LEASE NAME	G.I. Ferguson			WELL NO.	2-3		
NW 1/4 SE 1/4 SW 1/4 SE 1/4	FSL OF 1/4 SEC 420			FWL OF 1/4 SEC	792		
ELEVATION N Derrick	986	Ground	966	Latitude (if known)	34°34'50.1" N		
OPERATOR NAME	Iron Star Energy, LLC			OTC/OCC OPERATOR NO.	23355		
ADDRESS	PO Box 163713						
CITY	Austin	STATE	TX	ZIP	78716		

SPUD DATE 7/22/17
DRLG FINISHED DATE 8/5/17
DATE OF WELL COMPLETION 11/28/17
1st PROD DATE 12/19/17
RECOMP DATE
Longitude (if known) 97°29'55.4"W

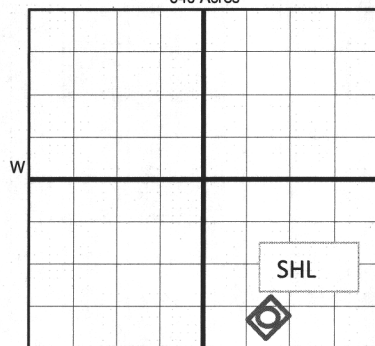

COMPLETION TYPE

<input type="checkbox"/> SINGLE ZONE	
<input type="checkbox"/> MULTIPLE ZONE	
<input checked="" type="checkbox"/> COMMINGLED	Application Date 9/11/2017
LOCATION	670526 F.O.
EXCEPTION ORDER	
INCREASED DENSITY ORDER NO.	670917

CASING & CEMENT (Form 1002C must be attached)

TYPE	SIZE	WEIGHT	GRADE	FEET	PSI	SAX	TOP OF CMT
CONDUCTOR	20"			40			Surface
SURFACE	9-5/8"	36	J-55	1095		400	Surface
INTERMEDIATE							
PRODUCTION	5-1/2"	20	P-110	10850		1350	3950
LINER							

PACKER @ _____ BRAND & TYPE _____ PLUG @ _____ TYPE _____ PLUG @ _____ TYPE _____ TOTAL DEPTH 10,851
PACKER @ _____ BRAND & TYPE _____ PLUG @ _____ TYPE _____ PLUG @ _____ TYPE _____

COMPLETION & TEST DATA BY PRODUCING FORMATION

FORMATION	Sycamore	Woodford	Hunton	Viola
SPACING & SPACING ORDER NUMBER	80 AC / 176475	80 AC / 665124	80 AC / 665124	80 AC / 665124
CLASS: Oil, Gas, Dry, Inj, Disp, Comm Disp, Svc	Gas & Oil	Gas & Oil	Gas & Oil	Gas & Oil
PERFORATED INTERVALS	8141 - 8324 9202 - 9510	8347 - 9063 9516 - 9802	9065 - 9074 9841 - 10021	10190 - 10693
ACID/VOLUME				
FRACTURE TREATMENT (Fluids/Prop Amounts)	30,990 bbls 333,697 #	37,306 bbl 429,398#	15,385 bbl 160,766#	30,758 bbl 321,319#

☒ Min Gas Allowable (165:10-17-7) OR Gas Purchaser/Measurer OneOk
Oil Allowable (165:10-13-3) First Sales Date 12/19/2017

INITIAL TEST DATA

INITIAL TEST DATE	12/19/2017
OIL-BBL/DAY	200
OIL-GRAVITY (API)	39
GAS-MCF/DAY	1000
GAS-OIL RATIO CU FT/BBL	5000
WATER-BBL/DAY	500
PUMPING OR FLOWING	Flowing
INITIAL SHUT-IN PRESSURE	1100
CHOKE SIZE	48/64
FLOW TUBING PRESSURE	400

AS SUBMITTED

A record of the formations drilled through, and pertinent remarks are presented on the reverse. I declare that I have knowledge of the contents of this report and am authorized by my organization to make this report, which was prepared by me or under my supervision and direction, with the data and facts stated herein to be true, correct, and complete to the best of my knowledge and belief.

SIGNATURE: Wayne Smith NAME (PRINT OR TYPE): Wayne Smith, Agent DATE: 2/16/2018 PHONE NUMBER: 405-842-2788
ADDRESS: PO Box 163793 CITY: Austin STATE: TX ZIP: 78716 EMAIL ADDRESS: wayne.smith@tresmanagement.com

PLEASE TYPE OR USE BLACK INK ONLY

FORMATION RECORD

Give formation names and tops, if available, or descriptions and thickness of formations drilled through. Show intervals cored or drillstem tested.

NAMES OF FORMATIONS	TOP
Pontotoc - Casing Lime Marker	1,641
Eola Conglomerate	3,118
Overthrust Arbuckle	4,016
Fault to Oil Creek	4,808
Fault to Goddard	6,111
Caney	7,988
Sycamore	8,077
Woodford	8,347
Hunton	9,066
Fault to Caney/Sycamore	9,074
Woodford	9,514
Hunton	9,841
Sylvan	10,021
Viola	10,190
Bromide Green Shale	10,750

LEASE NAME G.I. FergusonWELL NO. 2-3

FOR COMMISSION USE ONLY	
ITD on file <input type="checkbox"/> YES <input type="checkbox"/> NO	
APPROVED _____	DISAPPROVED _____
2) Reject Codes	

Were open hole logs run?	<u>X</u> yes <input type="checkbox"/> no
Date Last log was run	<u>8/5/2017</u>
Was CO ₂ encountered?	<input type="checkbox"/> yes <u>X</u> no at what depths? _____
Was H ₂ S encountered?	<input type="checkbox"/> yes <u>X</u> no at what depths? _____
Were unusual drilling circumstances encountered?	<input type="checkbox"/> yes <u>X</u> no
If yes, briefly explain below	

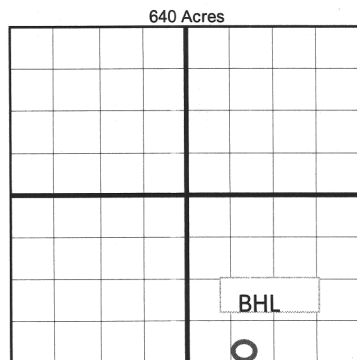
Other remarks: Commingling Order #671296

If more than three drainholes are proposed, attach a separate sheet indicating the necessary information.

Direction must be stated in degrees azimuth.
Please note, the horizontal drainhole and its end point must be located within the boundaries of the lease or spacing unit.

Directional surveys are required for all drainholes and directional wells.

640 Acres

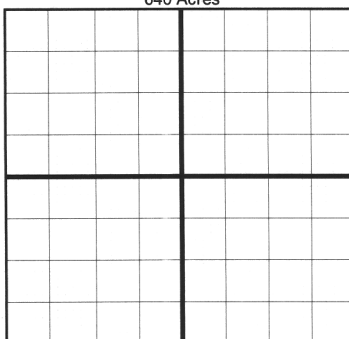

BOTTOM HOLE LOCATION FOR DIRECTIONAL HOLE

SEC 3	TWP 1N	RGE 3W	COUNTY Garvin
Spot Location SW 1/4	SE 1/4	SW 1/4	SE 1/4
Measured Total Depth	10,850	True Vertical Depth	10,841.99
Feet From 1/4 Sec Lines FSL 185 FWL 772			
BHL From Lease, Unit, or Property Line: 185 FSL & 772 FWL OF SE/4			

BOTTOM HOLE LOCATION FOR HORIZONTAL HOLE: (LATERALS)

LATERAL #1			
SEC	TWP	RGE	COUNTY
Spot Location	1/4	1/4	1/4
Depth of Deviation	Radius of Turn	Direction	Total Length
Measured Total Depth	True Vertical Depth	BHL From Lease, Unit, or Property Line:	

LATERAL #2			
SEC	TWP	RGE	COUNTY
Spot Location	1/4	1/4	1/4
Depth of Deviation	Radius of Turn	Direction	Total Length
Measured Total Depth	True Vertical Depth	BHL From Lease, Unit, or Property Line:	

LATERAL #3			
SEC	TWP	RGE	COUNTY
Spot Location	1/4	1/4	1/4
Depth of Deviation	Radius of Turn	Direction	Total Length
Measured Total Depth	True Vertical Depth	BHL From Lease, Unit, or Property Line:	