

Oklahoma Corporation Commission
Oil & Gas Conservation Division
Post Office Box 52000
Oklahoma City, Oklahoma 73152-2000
Rule 165: 10-3-25

Form 1002A

API No.: 35003233230000

Completion Report

Spud Date: July 09, 2018

OTC Prod. Unit No.: 003-224071

Drilling Finished Date: July 25, 2018

1st Prod Date: August 13, 2018

Completion Date: August 07, 2018

Drill Type: HORIZONTAL HOLE

Min Gas Allowable: Yes

Well Name: BETTY JOE 2411 3H-18 AB

Purchaser/Measurer: SEMGAS

Location: ALFALFA 7 24N 11W
NE SE SE SW
600 FSL 2400 FWL of 1/4 SEC
Latitude: 36.566190221 Longitude: -98.418045189
Derrick Elevation: 0 Ground Elevation: 1356

First Sales Date: 08/13/2018

Operator: MIDSTATES PETROLEUM CO LLC 23079

321 S BOSTON AVE STE 1000
TULSA, OK 74103-3322

Completion Type		Location Exception		Increased Density	
X	Single Zone	Order No		Order No	
	Multiple Zone	684180		682350	
	Commingled				

Casing and Cement							
Type	Size	Weight	Grade	Feet	PSI	SAX	Top of CMT
SURFACE	13 3/8	48	J-55	409		350	SURFACE
INTERMEDIATE	9 5/8	36	J-55	1250		505	SURFACE
PRODUCTION	7	26	P-110	7077		490	3050

Liner								
Type	Size	Weight	Grade	Length	PSI	SAX	Top Depth	Bottom Depth
LINER	4.5	11.6	P-110	5175	0	575	6774	11949

Total Depth: 11949

Packer	
Depth	Brand & Type
There are no Packer records to display.	

Plug	
Depth	Plug Type
There are no Plug records to display.	

Initial Test Data

Test Date	Formation	Oil BBL/Day	Oil-Gravity (API)	Gas MCF/Day	Gas-Oil Ratio Cu FT/BBL	Water BBL/Day	Pumpin or Flowing	Initial Shut-In Pressure	Choke Size	Flow Tubing Pressure
Aug 20, 2018	MISSISSIPPIAN	78	37	369	4731	2171	PUMPING	109	64/64	166

Completion and Test Data by Producing Formation	
Formation Name: MISSISSIPPIAN	Code: 359MSSP
Class: OIL	

Spacing Orders	
Order No	Unit Size
681206	640

Perforated Intervals	
From	To
7150	11856

Acid Volumes	
1,317 BARRELS 15% GELLED AND RET ACID, 443 BARRELS 15% HCL	

Fracture Treatments	
38,584 BARRELS SLICK WATER	

Formation	Top
ENDICOTT	4654
HASKELL	4993
TONKAWA	5028
AVANT	5368
COTTAGE GROVE	5431
HOGSHOOTER	5547
BIG LIME	5789
OSWEGO	5859
CHEROKEE	5944
MISSISSIPPI	6262

Were open hole logs run? No

Date last log run:

Were unusual drilling circumstances encountered? No

Explanation:

Other Remarks
OCC - THIS DOCUMENT IS ACCEPTED BASED ON THE DATA SUBMITTED NEITHER THE FINAL LOCATION EXCEPTION NOR THE FINAL INCREASE DENSITY ORDERS HAVE BEEN SUBMITTED.

Lateral Holes
Sec: 18 TWP: 24N RGE: 11W County: ALFALFA SW SE SW SW 165 FSL 755 FWL of 1/4 SEC Depth of Deviation: 7337 Radius of Turn: 1540 Direction: 179 Total Length: 4872 Measured Total Depth: 11949 True Vertical Depth: 6462 End Pt. Location From Release, Unit or Property Line: 165

FOR COMMISSION USE ONLY	
Status: Accepted	1140883

API NO. 003 23323
OTC PROD. UNIT NO. 003 224071

PLEASE TYPE OR USE BLACK INK ONLY
NOTE:

Attach copy of original 1002A
if recompletion or reentry.

OKLAHOMA CORPORATION COMMISSION
Oil & Gas Conservation Division
Post Office Box 52000
Oklahoma City, Oklahoma 73152-2000
Rule 165:10-3-25

RECEIVED

SEP 13 2018

OKLAHOMA CORPORATION
COMMISSION

Form 1002A
Rev. 2009

☒ ORIGINAL
☐ AMENDED (Reason)

COMPLETION REPORT

TYPE OF DRILLING OPERATION
☐ STRAIGHT HOLE ☐ DIRECTIONAL HOLE ☒ HORIZONTAL HOLE
☐ SERVICE WELL
If directional or horizontal, see reverse for bottom hole location.

SPUD DATE 07/09/2018
DRLG FINISHED DATE 07/25/2018
DATE OF WELL COMPLETION 08/07/2018
1st PROD DATE 08/13/2018
RECOMP DATE
Longitude (if known) -98.418045189
OTC/OCC OPERATOR NO. 23079

COUNTY Alfalfa SEC 07 TWP 24N RGE 11W
LEASE NAME Betty Joe 2411
NE 1/4 SE 1/4 SE 1/4 SW 1/4 FSL OF 1/4 SEC 600 FWL OF 1/4 SEC 2400
ELEVATIO N Derrick Ground 1356 Latitude (if known) 36.566190221
OPERATOR NAME Midstates Petroleum Company LLC
ADDRESS 321 South Boston, Suite 1000
CITY Tulsa STATE OK ZIP 74103

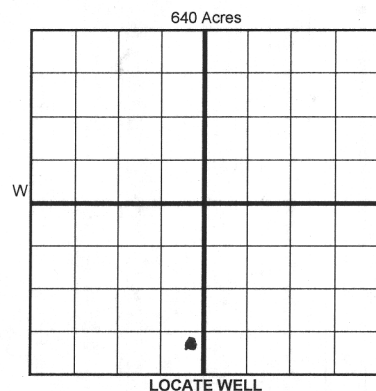

COMPLETION TYPE

☒ SINGLE ZONE
☐ MULTIPLE ZONE
Application Date
COMINGLED
Application Date
LOCATION
EXCEPTION ORDER
INCREASED DENSITY
ORDER NO. 682350 EO

CASING & CEMENT (Form 1002C must be attached)

TYPE	SIZE	WEIGHT	GRADE	FEET	PSI	SAX	TOP OF CMT
CONDUCTOR							
SURFACE	13-3/8	48#	J-55	409'		350	surface
INTERMEDIATE	9-5/8	36#	J-55	1,250'		505	surface
PRODUCTION	7	26#	P-110	7,077'		490	3,050'
LINER	4.5	11.6#	P-110	6,774'	11,949'	575	6,773'
						TOTAL DEPTH	11,949'

PACKER @ _____ BRAND & TYPE _____ PLUG @ _____ TYPE _____ PLUG @ _____ TYPE _____
PACKER @ _____ BRAND & TYPE _____ PLUG @ _____ TYPE _____ PLUG @ _____ TYPE _____

COMPLETION & TEST DATA BY PRODUCING FORMATION

FORMATION	Mississippian								
SPACING & SPACING ORDER NUMBER	640/681206								
CLASS: Oil, Gas, Dry, Inj, Disp, Comm Disp, Svc	Oil								
PERFORATED INTERVALS	7,150' - 11,856'								
ACID/VOLUME	1317 bbls 15% gelled & ret acid	443 bbls 15% HCl							
FRACTURE TREATMENT (Fluids/Prop Amounts)	38,584 bbls slk wtr								

Reported
to Eric Farris

Min Gas Allowable (165:10-17-7) Gas Purchaser/Measurer SemGas
OR First Sales Date 08/13/2018
Oil Allowable (165:10-13-3)

INITIAL TEST DATA

INITIAL TEST DATE	08/20/2018								
OIL-BBL/DAY	78								
OIL-GRAVITY (API)	37								
GAS-MCF/DAY	369								
GAS-OIL RATIO CU FT/BBL	4,731								
WATER-BBL/DAY	2,171								
PUMPING OR FLOWING	Pumping								
INITIAL SHUT-IN PRESSURE	109								
CHOKE SIZE	64/64								
FLOW TUBING PRESSURE	166								

AS SUBMITTED

A record of the formations drilled through, and pertinent remarks are presented on the reverse. I declare that I have knowledge of the contents of this report and am authorized by my organization to make this report, which was prepared by me or under my supervision and direction, with the data and facts stated herein to be true, correct, and complete to the best of my knowledge and belief.
08/15/2018 918-947-4647

SIGNATURE Chelce Rouse NAME (PRINT OR TYPE) DATE PHONE NUMBER
321 South Boston, Suite 1000 Tulsa, OK 74103 chelce.rouse@midstatespetroleum.com
ADDRESS CITY STATE ZIP EMAIL ADDRESS

PLEASE TYPE OR USE BLACK INK ONLY
FORMATION RECORD

Give formation names and tops, if available, or descriptions and thickness of formations drilled through. Show intervals cored or drillstem tested.

LEASE NAME Betty Joe 2411

WELL NO. 3H-18 AB

NAMES OF FORMATIONS	TOP
ENDICOTT	4,654
HASKELL	4,993
TONKAWA	5,028
AVANT	5,368
COTTAGE GROVE	5,431
HOGSHOOTER	5,547
BIG LIME	5,789
OSWEGO	5,859
CHEROKEE	5,944
MISSISSIPPI	6,262

FOR COMMISSION USE ONLY

ITD on file ☐ YES ☐ NO

APPROVED _____ DISAPPROVED _____

2) Reject Codes _____

Were open hole logs run? ☐ yes ☒ no

Date Last log was run N/A

Was CO₂ encountered? ☐ yes ☒ no at what depths? _____

Was H₂S encountered? ☐ yes ☒ no at what depths? _____

Were unusual drilling circumstances encountered? ☐ yes ☒ no

If yes, briefly explain below _____

Other remarks: _____

640 Acres

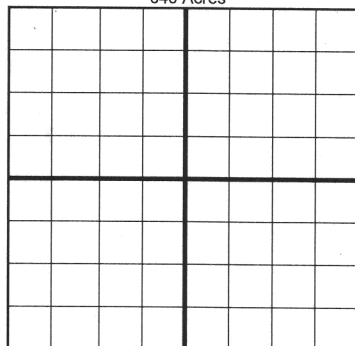

If more than three drainholes are proposed, attach a separate sheet indicating the necessary information.

Direction must be stated in degrees azimuth. Please note, the horizontal drainhole and its end point must be located within the boundaries of the lease or spacing unit.

Directional surveys are required for all drainholes and directional wells.

640 Acres

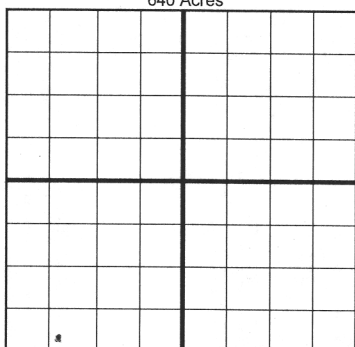

BOTTOM HOLE LOCATION FOR DIRECTIONAL HOLE

SEC	TWP	RGE	COUNTY
Spot Location			
1/4	1/4	1/4	1/4
Measured Total Depth		True Vertical Depth	BHL From Lease, Unit, or Property Line:

BOTTOM HOLE LOCATION FOR HORIZONTAL HOLE: (LATERALS)

LATERAL #1

SEC	TWP	RGE	COUNTY
18	24N	11W	Alfalfa
Spot Location			
SW	1/4 SE	1/4 SW	1/4 SW
Depth of Deviation		Radius of Turn	Direction
7,337		1,540	179.83
Measured Total Depth		True Vertical Depth	BHL From Lease, Unit, or Property Line:
11,949'		6,462	165

LATERAL #2

SEC	TWP	RGE	COUNTY
Spot Location			
1/4	1/4	1/4	1/4
Depth of Deviation		Radius of Turn	Direction
Measured Total Depth		True Vertical Depth	BHL From Lease, Unit, or Property Line:

LATERAL #3

SEC	TWP	RGE	COUNTY
Spot Location			
1/4	1/4	1/4	1/4
Depth of Deviation		Radius of Turn	Direction
Measured Total Depth		True Vertical Depth	BHL From Lease, Unit, or Property Line: