

Oklahoma Corporation Commission
Oil & Gas Conservation Division
Post Office Box 52000
Oklahoma City, Oklahoma 73152-2000
Rule 165: 10-3-25

Form 1002A

API No.: 35137275110002

Completion Report

Spud Date: July 19, 2018

OTC Prod. Unit No.: 137-023169

Drilling Finished Date: July 21, 2018

1st Prod Date: October 05, 2018

Completion Date: October 04, 2018

Drill Type: STRAIGHT HOLE

Well Name: SVPLDSU 105

Purchaser/Measurer:

Location: STEPHENS 13 2S 5W
C SE SE SE
330 FSL 2310 FWL of 1/4 SEC
Derrick Elevation: 972 Ground Elevation: 966

First Sales Date:

Operator: KODIAK OIL & GAS INC 23226

204 N WALNUT ST
MUENSTER, TX 76252-2766

| Completion Type | | Location Exception | | Increased Density | |
|-----------------|---------------|---|--|--|--|
| X | Single Zone | Order No | | Order No | |
| | Multiple Zone | There are no Location Exception records to display. | | There are no Increased Density records to display. | |
| | Commingled | | | | |

| Casing and Cement | | | | | | | |
|-------------------|-------|--------|-------|------|-----|-----|------------|
| Type | Size | Weight | Grade | Feet | PSI | SAX | Top of CMT |
| SURFACE | 8 5/8 | 24 | LS | 250 | | 170 | SURFACE |
| PRODUCTION | 4 1/2 | 11.6 | J | 2498 | | 450 | SURFACE |

| Liner | | | | | | | | |
|--|------|--------|-------|--------|-----|-----|-----------|--------------|
| Type | Size | Weight | Grade | Length | PSI | SAX | Top Depth | Bottom Depth |
| There are no Liner records to display. | | | | | | | | |

Total Depth: 2550

| Packer | | Plug | |
|---|--------------|---------------------------------------|-----------|
| Depth | Brand & Type | Depth | Plug Type |
| There are no Packer records to display. | | There are no Plug records to display. | |

| Initial Test Data | | | | | | | | | | |
|-------------------|-------------|-------------|-------------------|-------------|-------------------------|---------------|-------------------|--------------------------|------------|----------------------|
| Test Date | Formation | Oil BBL/Day | Oil-Gravity (API) | Gas MCF/Day | Gas-Oil Ratio Cu FT/BBL | Water BBL/Day | Pumpin or Flowing | Initial Shut-In Pressure | Choke Size | Flow Tubing Pressure |
| Oct 09, 2018 | DEESE LOWER | 28 | 27 | | | 40 | PUMPING | 110 | | |

| Completion and Test Data by Producing Formation | | | |
|---|------------------|---|------------|
| Formation Name: DEESE LOWER | | Code: 404DEESL | Class: OIL |
| Spacing Orders | | Perforated Intervals | |
| Order No | Unit Size | From | To |
| 40477 | UNIT | 2288 | 2408 |
| Acid Volumes | | Fracture Treatments | |
| 1,250 GALLONS 15% | | 1,200 SACKS 20/40 SAND WITH 3,000 BARRELS WATER | |

| Formation | Top |
|-----------|------|
| PONTOTOC | 416 |
| DEESE | 1144 |

Were open hole logs run? Yes
Date last log run: July 21, 2018

Were unusual drilling circumstances encountered? No
Explanation:

| Other Remarks |
|-----------------------------|
| There are no Other Remarks. |

| FOR COMMISSION USE ONLY | |
|-------------------------|---------|
| Status: Accepted | 1141203 |

API NO. 137-27511
OTC PROD. UNIT NO. 137-023169

PLEASE TYPE OR USE BLACK INK ONLY
NOTE:

Attach copy of original 1002A
if recompletion or reentry.

OKLAHOMA CORPORATION COMMISSION
Oil & Gas Conservation Division
Post Office Box 52000
Oklahoma City, Oklahoma 73152-2000
Rule 165:10-3-25

RECEIVED

OCT 31 2018

Form 1002A
Rev. 2009

☒ ORIGINAL
☐ AMENDED (Reason)

COMPLETION REPORT

TYPE OF DRILLING OPERATION

☒ STRAIGHT HOLE ☐ DIRECTIONAL HOLE ☐ HORIZONTAL HOLE
☐ SERVICE WELL

If directional or horizontal, see reverse for bottom hole location.

| | | | | | | | | |
|---------------------|------------------------|--------|----------------|---------------------|-------|----------------------|----------------------|-------|
| COUNTY | STEPHENS | SEC | 13 | TWP | 2S | RGE | 5W | |
| LEASE NAME | SVPLDSU | | | | | | WELL NO. | 105 |
| C | 1/4 | SE | 1/4 | SE | 1/4 | SE | 1/4 | |
| FSL OF 1/4 SEC | 330 | | FWL OF 1/4 SEC | | 2310 | | | |
| ELEVATION N Derrick | 972 | Ground | 966 | Latitude (if known) | | Longitude (if known) | | |
| OPERATOR NAME | Kodiak Oil & Gas, Inc. | | | | | | OTC/OCC OPERATOR NO. | 23226 |
| ADDRESS | 204 N. Walnut St | | | | | | | |
| CITY | Muenster | STATE | TX | ZIP | 76252 | | | |

OKLAHOMA CORPORATION COMMISSION

640 Acres

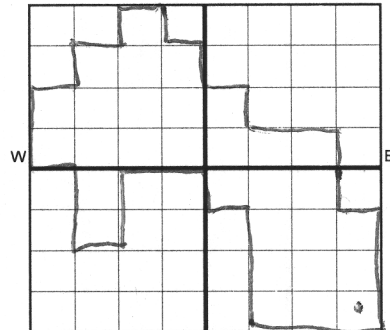

LOCATE WELL

COMPLETION TYPE

| |
|---|
| <input checked="" type="checkbox"/> SINGLE ZONE |
| <input type="checkbox"/> MULTIPLE ZONE |
| Application Date |
| COMMINGLED |
| Application Date |
| LOCATION |
| EXCEPTION ORDER |
| INCREASED DENSITY |
| ORDER NO. |

CASING & CEMENT (Form 1002C must be attached)

| TYPE | SIZE | WEIGHT | GRADE | FEET | PSI | SAX | TOP OF CMT |
|--------------|-------|--------|-------|------|-----|-----|------------|
| CONDUCTOR | | | | | | | |
| SURFACE | 8 5/8 | 24# | LS | 250 | | 170 | surface |
| INTERMEDIATE | | | | | | | |
| PRODUCTION | 4 1/2 | 11.6 | J | 2498 | | 450 | surface |
| LINER | | | | | | | |

PACKER @ _____ BRAND & TYPE _____ PLUG @ _____ TYPE _____ PLUG @ _____ TYPE _____
PACKER @ _____ BRAND & TYPE _____ PLUG @ _____ TYPE _____ PLUG @ _____ TYPE _____

TOTAL DEPTH 2,550

CBL
Shows
Bowl
DRD

COMPLETION & TEST DATA BY PRODUCING FORMATION

| | | | | | | | |
|---|-----------------|--|--|--|--|--|--|
| FORMATION | Deese Lower | | | | | | |
| SPACING & SPACING ORDER NUMBER | 40477 (unit) | | | | | | |
| CLASS: Oil, Gas, Dry, Inj, Disp, Comm Disp, Svc | oil | | | | | | |
| PERFORATED INTERVALS | 2288-2320 | | | | | | |
| | 2400-2408 | | | | | | |
| ACID/VOLUME | 1250 gal 15% | | | | | | |
| FRACTURE TREATMENT (Fluids/Prop Amounts) | 1200 sacks | | | | | | |
| | 20/40 sand with | | | | | | |
| | 3000 bbls water | | | | | | |

Reported
to For Focus

Min Gas Allowable (165:10-17-7) Gas Purchaser/Measurer
OR
Oil Allowable (165:10-13-3) First Sales Date

INITIAL TEST DATA

| | | | | | | | |
|--------------------------|-----------|--|--|--|--|--|--|
| INITIAL TEST DATE | 10/9/2018 | | | | | | |
| OIL-BBL/DAY | 28 | | | | | | |
| OIL-GRAVITY (API) | 27 | | | | | | |
| GAS-MCF/DAY | 0 | | | | | | |
| GAS-OIL RATIO CU FT/BBL | | | | | | | |
| WATER-BBL/DAY | 40 | | | | | | |
| PUMPING OR FLOWING | pumping | | | | | | |
| INITIAL SHUT-IN PRESSURE | 110 | | | | | | |
| CHOKE SIZE | - | | | | | | |
| FLOW TUBING PRESSURE | | | | | | | |

AS SUBMITTED

A record of the formations drilled through, and pertinent remarks are presented on the reverse. I declare that I have knowledge of the contents of this report and am authorized by my organization to make this report, which was prepared by me or under my supervision and direction, with the data and facts stated herein to be true, correct, and complete to the best of my knowledge and belief.

| | | | | | |
|--------------|-------------------|---------------|------------|--------------|--------------|
| SIGNATURE | Mel Walterscheid | DATE | 10/26/2018 | PHONE NUMBER | 940-759-4001 |
| 204 N Walnut | Muenster TX 76252 | wfw@ntin.net | | | |
| ADDRESS | CITY STATE ZIP | EMAIL ADDRESS | | | |

PLEASE TYPE OR USE BLACK INK ONLY
FORMATION RECORD

Give formation names and tops, if available, or descriptions and thickness of formations drilled through. Show intervals cored or drillstem tested.

LEASE NAME SVPLDSU WELL NO. 105

| NAMES OF FORMATIONS | TOP |
|---------------------|-------|
| Pontotoc | 416 |
| Deese | 1,144 |

| FOR COMMISSION USE ONLY | |
|--|-------------------|
| ITD on file <input type="checkbox"/> YES <input type="checkbox"/> NO | |
| APPROVED _____ | DISAPPROVED _____ |
| 2) Reject Codes | |
| | |
| | |
| | |
| | |
| | |

| | |
|--|--|
| Were open hole logs run? | <u>X</u> yes <input type="checkbox"/> no |
| Date Last log was run | <u>7/21/2018</u> |
| Was CO ₂ encountered? | <input type="checkbox"/> yes <u>X</u> no at what depths? _____ |
| Was H ₂ S encountered? | <input type="checkbox"/> yes <u>X</u> no at what depths? _____ |
| Were unusual drilling circumstances encountered? | <input type="checkbox"/> yes <u>X</u> no |
| If yes, briefly explain below | |

Other remarks:

640 Acres

| | | | | | | | | | |
|--|--|--|--|--|--|--|--|--|--|
| | | | | | | | | | |
| | | | | | | | | | |
| | | | | | | | | | |
| | | | | | | | | | |
| | | | | | | | | | |
| | | | | | | | | | |
| | | | | | | | | | |
| | | | | | | | | | |
| | | | | | | | | | |
| | | | | | | | | | |

If more than three drainholes are proposed, attach a separate sheet indicating the necessary information.

Direction must be stated in degrees azimuth.
Please note, the horizontal drainhole and its end point must be located within the boundaries of the lease or spacing unit.

Directional surveys are required for all drainholes and directional wells.

640 Acres

| | | | | | | | | | |
|--|--|--|--|--|--|--|--|--|--|
| | | | | | | | | | |
| | | | | | | | | | |
| | | | | | | | | | |
| | | | | | | | | | |
| | | | | | | | | | |
| | | | | | | | | | |
| | | | | | | | | | |
| | | | | | | | | | |
| | | | | | | | | | |
| | | | | | | | | | |

BOTTOM HOLE LOCATION FOR DIRECTIONAL HOLE

| SEC | TWP | RGE | COUNTY |
|----------------------|---------------------|-----|---|
| Spot Location | 1/4 | 1/4 | 1/4 |
| Measured Total Depth | True Vertical Depth | | BHL From Lease, Unit, or Property Line: |

BOTTOM HOLE LOCATION FOR HORIZONTAL HOLE: (LATERALS)

LATERAL #1

| SEC | TWP | RGE | COUNTY |
|----------------------|---------------------|-----|---|
| Spot Location | 1/4 | 1/4 | 1/4 |
| Depth of Deviation | Radius of Turn | | Direction |
| Measured Total Depth | True Vertical Depth | | BHL From Lease, Unit, or Property Line: |

LATERAL #2

| SEC | TWP | RGE | COUNTY |
|----------------------|---------------------|-----|---|
| Spot Location | 1/4 | 1/4 | 1/4 |
| Depth of Deviation | Radius of Turn | | Direction |
| Measured Total Depth | True Vertical Depth | | BHL From Lease, Unit, or Property Line: |

LATERAL #3

| SEC | TWP | RGE | COUNTY |
|----------------------|---------------------|-----|---|
| Spot Location | 1/4 | 1/4 | 1/4 |
| Depth of Deviation | Radius of Turn | | Direction |
| Measured Total Depth | True Vertical Depth | | BHL From Lease, Unit, or Property Line: |