

Oklahoma Corporation Commission  
Oil & Gas Conservation Division  
Post Office Box 52000  
Oklahoma City, Oklahoma 73152-2000  
Rule 165: 10-3-25

Form 1002A

API No.: 35123207140003

**Completion Report**

Spud Date: May 31, 1977

OTC Prod. Unit No.:

Drilling Finished Date: August 05, 1977

**Amended**

1st Prod Date: August 05, 1977

Amend Reason: SET CIBP AND PERFORATIONS ADDED / CORRECT SPOT CALL

Completion Date: August 05, 1977

Recomplete Date: September 22, 2017

**Drill Type: STRAIGHT HOLE**

Well Name: FITTS WEST UNIT 29-20

Purchaser/Measurer:

Location: PONTOTOC 25 2N 6E  
S2 N2 SW SW  
800 FSL 660 FWL of 1/4 SEC  
Derrick Elevation: 828 Ground Elevation: 818

First Sales Date:

Operator: SHERIDAN PRODUCTION COMPANY LLC 22220

9 GREENWAY PLZ STE 1300  
HOUSTON, TX 77046-0922

Completion Type	
	Single Zone
	Multiple Zone
X	Commingled

Location Exception	
Order No	
There are no Location Exception records to display.	

Increased Density	
Order No	
There are no Increased Density records to display.	

Casing and Cement							
Type	Size	Weight	Grade	Feet	PSI	SAX	Top of CMT
SURFACE	10 3/4	40.5	K-55	568		300	SURFACE
PRODUCTION	7	20	K-55	4497		600	900

Liner								
Type	Size	Weight	Grade	Length	PSI	SAX	Top Depth	Bottom Depth
There are no Liner records to display.								

**Total Depth: 4493**

Packer	
Depth	Brand & Type
There are no Packer records to display.	

Plug	
Depth	Plug Type
4102	CIBP
4440	PBTD

Initial Test Data
-------------------

Test Date	Formation	Oil BBL/Day	Oil-Gravity (API)	Gas MCF/Day	Gas-Oil Ratio Cu FT/BBL	Water BBL/Day	Pumpin or Flowing	Initial Shut-In Pressure	Choke Size	Flow Tubing Pressure						
Sep 29, 2017	CHIMNEY HILL-VIOLA	11	38			3860	PUMPING									
<b>Completion and Test Data by Producing Formation</b>																
Formation Name: CHIMNEY HILL			Code: 251CMNL			Class: OIL										
<b>Spacing Orders</b>				<b>Perforated Intervals</b>												
<b>Order No</b>		<b>Unit Size</b>		<b>From</b>			<b>To</b>									
There are no Spacing Order records to display.				3640			3651									
<b>Acid Volumes</b>				<b>Fracture Treatments</b>												
2000 GALS 20% HCL				There are no Fracture Treatments records to display.												
Formation Name: VIOLA			Code: 202VIOL			Class: OIL										
<b>Spacing Orders</b>				<b>Perforated Intervals</b>												
<b>Order No</b>		<b>Unit Size</b>		<b>From</b>			<b>To</b>									
There are no Spacing Order records to display.				3882			4050									
<b>Acid Volumes</b>				<b>Fracture Treatments</b>												
233 BARRELS 20% HCL				96,000 POUNDS 16/30 SAND, 3,082 BARRELS WATER, 3,306 BARRELS FRAC FLUID, 41,000 POUNDS RS AVG 26 BPM AND 2,482 PSI												
Formation Name: BROMIDE			Code: 202BRMD			Class: DRY										
<b>Spacing Orders</b>				<b>Perforated Intervals</b>												
<b>Order No</b>		<b>Unit Size</b>		<b>From</b>			<b>To</b>									
There are no Spacing Order records to display.				4118			4216									
<b>Acid Volumes</b>				<b>Fracture Treatments</b>												
2000 GALS 20% HCL				There are no Fracture Treatments records to display.												
Formation Name: MCLISH			Code: 202MCLS			Class: DRY										
<b>Spacing Orders</b>				<b>Perforated Intervals</b>												
<b>Order No</b>		<b>Unit Size</b>		<b>From</b>			<b>To</b>									
There are no Spacing Order records to display.				4251			4400									
<b>Acid Volumes</b>				<b>Fracture Treatments</b>												
There are no Acid Volume records to display.				There are no Fracture Treatments records to display.												
Formation Name: CHIMNEY HILL-VIOLA			Code:			Class: OIL										

Formation	Top
CHIMNEY HILL	3428
VIOLA	3786
BROMIDE	4114
MCLISH	4302

Were open hole logs run? No

Date last log run:

Were unusual drilling circumstances encountered? No

Explanation:

#### Other Remarks

THE VIOLA PERFORATIONS WERE ADDED IN OCTOBER, 2012 AND MISTAKENLY DID NOT GET REPORTED. CIBP WITH 10' CEMENT BAIL DUMPED ON TOP, CURRENTLY SET TO ISOLATE BROMIDE AND MCLISH PERFORATIONS.

#### FOR COMMISSION USE ONLY

1138281

Status: Accepted

API NO. 123-20714  
OTC PROD.  
UNIT NO.

PLEASE TYPE OR USE BLACK INK ONLY  
NOTE:  
Attach copy of original 1002A if recompletion or reent

OKLAHOMA CORPORATION COMMISSION  
Oil & Gas Conservation Division  
Post Office Box 52000  
Oklahoma City, Oklahoma 73152-2000  
Rule 165:10-3-25

RECEIVED

Form 1002A  
Rev. 2009

DEC 04 2017

OKLAHOMA CORPORATION  
COMMISSION

☐ ORIGINAL  
☒ AMENDED  
Reason Amended

SET CIBP & PERFS ADDED

TYPE OF DRILLING OPERATION

☒ STRAIGHT HOLE ☐ DIRECTIONAL HOLE ☐ HORIZONTAL HOLE  
☐ SERVICE WELL

If directional or horizontal, see reverse for bottom hole location.

COUNTY	PONTOTOC	SEC	25	TWP	2N	RGE	6E
LEASE NAME	FITTS WEST UNIT (FWU)			WELL NO.	29-20		
ELEVATION	828	SW 1/4	SW 1/4	FSL	800	FWL OF 1/4 SEC	660
Derrick FL	Ground	818	Latitude if Known		Longitude if Known		
OPERATOR NAME	SHERIDAN PRODUCTION COMPANY, LLC			OTC/OCC OPERATOR NO.	22220-0		
ADDRESS	9 GREENWAY PLAZA, SUITE 1300						
CITY	HOUSTON		STATE	TX		ZIP	77046

COMPLETION REPORT

SPUD DATE 5/31/1977  
DRLG FINISHED DATE 8/5/1977  
WELL COMPLETION DATE 8/5/1977  
1ST PROD DATE 8/5/1977  
RECOMP DATE 9/22/2017

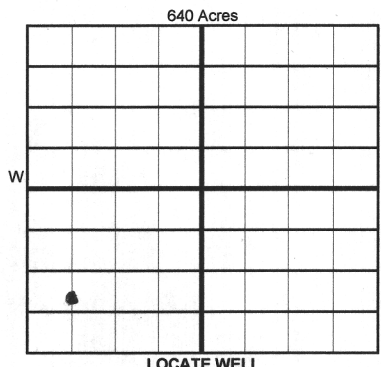

COMPLETION TYPE

<input type="checkbox"/> SINGLE ZONE	
<input type="checkbox"/> MULTIPLE ZONE	
Application Date	
<input checked="" type="checkbox"/> COMMINGLED	70582
Application Date	
LOCATION EXCEPTION ORDER NO.	
INCREASED DENSITY ORDER NO.	

CASING & CEMENT (Form 1002C must be attached)

TYPE	SIZE	WEIGHT	GRADE	FEET	PSI	SAX	TOP OF CMT
Conductor							
Surface	10-3/4	40.5	K-55	568		300	SURF
Intermediate							
Production	7	20	K-55	4497		600	900
Liner	tubing 2 7/8	6.5	J 55	3956			

PACKER @ \_\_\_\_\_ BRAND & TYPE \_\_\_\_\_ PLUG @ \_\_\_\_\_ TYPE \_\_\_\_\_ PLUG @ 4440 TYPE PBTD TOTAL DEPTH 4493  
PACKER @ \_\_\_\_\_ BRAND & TYPE \_\_\_\_\_ PLUG @ \_\_\_\_\_ TYPE \_\_\_\_\_ PLUG @ 4102 TYPE CIBP

COMPLETION & TEST DATA BY PRODUCING FORMATION

FORMATION	CHIMNEY HILL	VIOLA	BROMIDE	MCLISH
SPACING & SPACING ORDER NUMBER	UNIT	UNIT	UNIT	UNIT
CLASS: Oil, Gas, Dry, Inj, Disp, Comm Disp, Svc	OIL	OIL	DRY	DRY
PERFORATED INTERVALS	3640	3882	4118	4251
	3651	4050	4216	4400
ACID/VOLUME	NA	NA 233 BBLs 20% HCL		
FRACTURE TREATMENT (Fluids/Prop Amounts)		96,000 lbs 16/30 sand, 3082 BBLs water, 3306 BBLs Frac Fluid		
		SEE REMARKS 41,000 lbs RS Avg 26 BPM + 2482 PSI		

☐ Oil Allowable (165:10-13-3) ☐ Minimum Gas Allowable (165:10-17-7) Gas Purchaser/Measurer \_\_\_\_\_ 1st Sales Date \_\_\_\_\_

INITIAL TEST DATA

INITIAL TEST DATE	9/29/2017
OIL-BBL/DAY	11
OIL-GRAVITY (API)	38
GAS-MCF/DAY	0
GAS-OIL RATIO CU FT/BBL	NA
WATER-BBL/DAY	3860
PUMPING OR FLOWING	PUMPING
INITIAL SHUT-IN PRESSURE	NA
CHOKE SIZE	NA
FLOW TUBING PRESSURE	NA

AS SUBMITTED

A record of the formations drilled through, and pertinent remarks are presented on the reverse. I declare that I have knowledge of the contents of this report and am authorized by my organization to make this report, which was prepared by me or under my supervision and direction, with the data and facts stated herein to be true, correct, and complete to the best of my knowledge and belief.

3 Joyce A. Williams  
SIGNATURE  
9 GREENWAY PLAZA, SUITE 1300 HOUSTON TX 77046  
ADDRESS CITY STATE ZIP  
JOYCE A WILLIAMS  
NAME (PRINT OR TYPE)  
11/3/2017 713-548-1070  
DATE PHONE NUMBER  
jwilliams@sheridanproduction.com  
EMAIL ADDRESS

PLEASE TYPE OR USE BLACK INK ONLY

FORMATION RECORD

Give formation names and tops, if available, or descriptions and thickness of formations drilled through. Show intervals cored or drillstem tested.

LEASE NAME FITTS WEST UNIT (FWU)

WELL NO. 29-20

NAMES OF FORMATIONS	TOP
CHIMNEY HILL	3428
VIOLA	3786
BROMIDE	4114
MCLISH	4302

FOR COMMISSION USE ONLY	
ITD on file <input type="checkbox"/> YES <input type="checkbox"/> NO	
APPROVED _____	DISAPPROVED _____
2) Reject Codes	
_____	
_____	
_____	
_____	

Were open hole logs run?	_____ yes <input checked="" type="checkbox"/> no
Date Last log was run	_____
Was CO <sub>2</sub> encountered?	_____ yes <input checked="" type="checkbox"/> no at what depths? _____
Was H <sub>2</sub> S encountered?	_____ yes <input checked="" type="checkbox"/> no at what depths? _____
Were unusual drilling circumstances encountered?	_____ yes <input checked="" type="checkbox"/> no
If yes, briefly explain below:	

Other remarks:	THE VIOLA PERFS WERE ADDED IN OCTOBER, 2012 AND MISTAKENLY DIDN'T GET REPORTED.
	CIBP w/10' CMT BAIL DUMPED ON TOP, CURRENTLY SET TO ISOLATE BROMIDE & MCLISH PERFS.
	FRAC INFO FOR VIOLA FORMATION - PERFS 3882-4050'; FRAC W/96M# 16/30 sd, 233 BBL 20% HCl, 3082 BBL wtr,
	3306 BBL FRAC FLUID, 41M # RS, AVG 26 BPM & 2482 PSI, FG 0.869
	<del>CORRELATION LOG RUN &amp; ATTACHED.</del>

640 Acres

If more than three drainholes are proposed, attach a separate sheet indicating the necessary information.

Direction must be stated in degrees azimuth. Please note, the horizontal drainhole and its end point must be located within the boundaries of the lease or spacing unit.

Directional surveys are required for all drainholes and directional wells.

640 Acres

BOTTOM HOLE LOCATION FOR DIRECTIONAL HOLE

SEC	TWP	RGE	COUNTY
Spot Location		Feet From 1/4 Sec Lines	
1/4	1/4	1/4	1/4
Measured Total Depth		True Vertical Depth	
		BHL From Lease, Unit, or Property Line:	

BOTTOM HOLE LOCATION FOR HORIZONTAL HOLE: (LATERALS)

LATERAL #1

SEC	TWP	RGE	COUNTY
Spot Location		Feet From 1/4 Sec Lines	
1/4	1/4	1/4	1/4
Depth of Deviation		Radius of Turn	Direction
		Total Length	
Measured Total Depth		True Vertical Depth	
		End Pt Location From Lease, Unit or Property Line:	

LATERAL #2

SEC	TWP	RGE	COUNTY
Spot Location		Feet From 1/4 Sec Lines	
1/4	1/4	1/4	1/4
Depth of Deviation		Radius of Turn	Direction
		Total Length	
Measured Total Depth		True Vertical Depth	
		End Pt Location From Lease, Unit or Property Line:	

LATERAL #3

SEC	TWP	RGE	COUNTY
Spot Location		Feet From 1/4 Sec Lines	
1/4	1/4	1/4	1/4
Depth of Deviation		Radius of Turn	Direction
		Total Length	
Measured Total Depth		True Vertical Depth	
		End Pt Location From Lease, Unit or Property Line:	