

Oklahoma Corporation Commission  
Oil & Gas Conservation Division  
Post Office Box 52000  
Oklahoma City, Oklahoma 73152-2000  
Rule 165: 10-3-25

Form 1002A

API No.: 35133245480001

**Completion Report**

Spud Date: November 25, 2005

OTC Prod. Unit No.: 133-117777

Drilling Finished Date: December 07, 2005

**Amended**

1st Prod Date: March 18, 2006

Amend Reason: TEST CROMWELL

Completion Date: February 03, 2006

Recomplete Date: November 05, 2017

**Drill Type: STRAIGHT HOLE**

Well Name: INAKY 1

Purchaser/Measurer:

Location: SEMINOLE 28 9N 8E  
C NW SE SE  
990 FSL 990 FEL of 1/4 SEC  
Derrick Elevation: 0 Ground Elevation: 859

First Sales Date:

Operator: B B R OIL CORPORATION 2902

10 W MAIN ST STE 212  
ARDMORE, OK 73401-6515

Completion Type		Location Exception		Increased Density	
X	Single Zone	Order No		Order No	
	Multiple Zone	There are no Location Exception records to display.		There are no Increased Density records to display.	
	Commingled				

Casing and Cement							
Type	Size	Weight	Grade	Feet	PSI	SAX	Top of CMT
SURFACE	8 5/8	20	K-55	290	500	200	SURFACE
PRODUCTION	5 1/2	15.5	K-55	4380	1500	225	3100

Liner								
Type	Size	Weight	Grade	Length	PSI	SAX	Top Depth	Bottom Depth
There are no Liner records to display.								

**Total Depth: 4390**

Packer		Plug	
Depth	Brand & Type	Depth	Plug Type
There are no Packer records to display.		3550	RBP

Initial Test Data
-------------------

Test Date	Formation	Oil BBL/Day	Oil-Gravity (API)	Gas MCF/Day	Gas-Oil Ratio Cu FT/BBL	Water BBL/Day	Pumpin or Flowing	Initial Shut-In Pressure	Choke Size	Flow Tubing Pressure
Feb 03, 2006	WILCOX	3				3	PUMPING	240		
Jul 26, 2006	HUNTON	6				30	PUMPING	350		
Oct 04, 2017	CROMWELL			72		20	PUMPING	400	8/64	

#### Completion and Test Data by Producing Formation

Formation Name: WILCOX

Code: 202WLCX

Class: DRY

##### Spacing Orders

Order No	Unit Size
291226	40

##### Perforated Intervals

From	To
4333	4341

##### Acid Volumes

500 GALLONS 10%

##### Fracture Treatments

There are no Fracture Treatments records to display.

Formation Name: HUNTON

Code: 269HNTN

Class: DRY

##### Spacing Orders

Order No	Unit Size
291226	40

##### Perforated Intervals

From	To
4140	4156

##### Acid Volumes

400 GALLONS 7 1/2%

##### Fracture Treatments

There are no Fracture Treatments records to display.

Formation Name: CROMWELL

Code: 402CMWL

Class: GAS

##### Spacing Orders

Order No	Unit Size
511154	160

##### Perforated Intervals

From	To
3453	3457

##### Acid Volumes

1,000 GALLONS 15%

##### Fracture Treatments

There are no Fracture Treatments records to display.

Formation	Top
CROMWELL	3450

Were open hole logs run? Yes

Date last log run: December 06, 2005

Were unusual drilling circumstances encountered? Yes

Explanation: LOST CIRCULATION IN CROMWELL 3,460'

#### Other Remarks

There are no Other Remarks.

Status: Accepted

# RECEIVED

Form 1002A  
Rev. 2009

NOV 27 2017

OKLAHOMA CORPORATION COMMISSION

API NO. **133 24548**  
OTC PROD. UNIT NO. **13311777**

PLEASE TYPE OR USE BLACK INK ONLY

NOTE:

Attach copy of original 1002A  
if recompletion or reentry.

OKLAHOMA CORPORATION COMMISSION  
Oil & Gas Conservation Division  
Post Office Box 52000  
Oklahoma City, Oklahoma 73152-2000  
Rule 165:10-3-25

☐ ORIGINAL  
☒ AMENDED (Reason)

Test Cromwell

COMPLETION REPORT

TYPE OF DRILLING OPERATION  
☒ STRAIGHT HOLE ☐ DIRECTIONAL HOLE ☐ HORIZONTAL HOLE  
☐ SERVICE WELL

If directional or horizontal, see reverse for bottom hole location.

COUNTY **Seminole** SEC **28** TWP **9N** RGE **8E**  
LEASE NAME **Inaky** WELL NO. **1**  
C 1/4 NW 1/4 SE 1/4 SE 1/4 FSL OF 1/4 SEC **990FS** FWL OF 1/4 SEC **990FE**  
ELEVATION **859** Ground Latitude (if known)

SPUD DATE **11-25-05**  
DRLG FINISHED DATE **12-7-05**  
DATE OF WELL COMPLETION **2-3-06**  
1st PROD DATE **3-18-06**  
RECOMP DATE **11-5-17**  
Longitude (if known)

OPERATOR NAME **BBR Oil Corporation**

OTC/OCC OPERATOR NO. **02902-0**

ADDRESS **10 W Main, Ste 212**

CITY **Ardmore**

STATE **OK**

ZIP **73401**

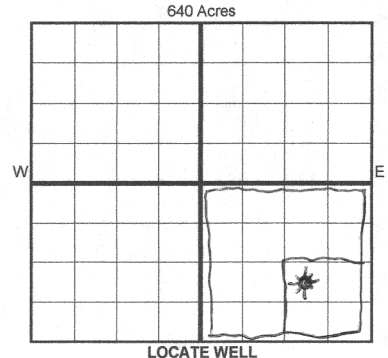

LOCATE WELL

COMPLETION TYPE

☒ SINGLE ZONE  
☐ MULTIPLE ZONE  
Application Date  
☐ COMMINGLED  
Application Date  
LOCATION  
EXCEPTION ORDER  
INCREASED DENSITY  
ORDER NO.

CASING & CEMENT (Form 1002C must be attached)

TYPE	SIZE	WEIGHT	GRADE	FEET	PSI	SAX	TOP OF CMT
CONDUCTOR							
SURFACE	8-5/8	20#	K55	290	500	200	surf
INTERMEDIATE							
PRODUCTION	5-1/2	15.5	K55	4380	1500	225	3100 CBL
LINER							
					TOTAL DEPTH	4390	

PACKER @ \_\_\_\_\_ BRAND & TYPE \_\_\_\_\_

PLUG @ **3550**

TYPE **RBP**

PLUG @ \_\_\_\_\_

TYPE \_\_\_\_\_

PACKER @ \_\_\_\_\_ BRAND & TYPE \_\_\_\_\_

PLUG @ \_\_\_\_\_

TYPE \_\_\_\_\_

PLUG @ \_\_\_\_\_

TYPE \_\_\_\_\_

COMPLETION & TEST DATA BY PRODUCING FORMATION

**202WLCX, 269HNTN, 402CMWL**

FORMATION	Wilcox	Hunton	Cromwell	No Frac
SPACING & SPACING ORDER NUMBER	291226 (40)	291226 (40)	511154 (160)	
CLASS: Oil, Gas, Dry, Inj, Disp, Comm Disp, Svc	<i>oil Dry under Plug</i>	<i>oil Dry under Plug</i>	gas	
PERFORATED INTERVALS	4333-41	4140-44 4150-56	3453-57	
ACID/VOLUME	500g 10%	400g 7-1/2%	1000g 15%	
FRACTURE TREATMENT (Fluids/Prop Amounts)				

☐ Min Gas Allowable (165:10-17-7)  
OR  
☐ Oil Allowable (165:10-13-3)

Gas Purchaser/Measurer  
First Sales Date

INITIAL TEST DATA

INITIAL TEST DATE	2-3-06	7-26-06	10-4-17
OIL-BBL/DAY	3 BOPD	6 BOPD	0
OIL-GRAVITY (API)			
GAS-MCF/DAY	TSTM	TSTM	72MCFPD
GAS-OIL RATIO CU FT/BBL			
WATER-BBL/DAY	3 BWPD	30 BWPD	20 BWPD
PUMPING OR FLOWING	P	P	P
INITIAL SHUT-IN PRESSURE	240	350	400
CHOKE SIZE			8/64"
FLOW TUBING PRESSURE			NA

**AS SUBMITTED**

A record of the formations drilled through, and pertinent remarks are presented on the reverse. I declare that I have knowledge of the contents of this report and am authorized by my organization to make this report, which was prepared by me or under my supervision and direction, with the data and facts stated herein to be true, correct, and complete to the best of my knowledge and belief.

*Michael J. Biddick*

Michael J. Biddick

11-21-17

SIGNATURE

NAME (PRINT OR TYPE)

DATE

PHONE NUMBER

10 W Main, Ste 212

Ardmore, OK 73401

fractall@sbcglobal.net

ADDRESS

CITY

STATE

ZIP

EMAIL ADDRESS

PLEASE TYPE OR USE BLACK INK ONLY  
FORMATION RECORD

Give formation names and tops, if available, or descriptions and thickness of formations drilled through. Show intervals cored or drillstem tested.

LEASE NAME \_\_\_\_\_ WELL NO. \_\_\_\_\_

NAMES OF FORMATIONS	TOP
Cromwell	3450

FOR COMMISSION USE ONLY	
ITD on file <input type="checkbox"/> YES <input type="checkbox"/> NO	
APPROVED _____	DISAPPROVED _____
2) Reject Codes	
_____	
_____	
_____	
_____	

Were open hole logs run?	<input checked="" type="checkbox"/> yes <input type="checkbox"/> no
Date Last log was run	12-6-05
Was CO <sub>2</sub> encountered?	<input type="checkbox"/> yes <input checked="" type="checkbox"/> no at what depths? _____
Was H <sub>2</sub> S encountered?	<input type="checkbox"/> yes <input checked="" type="checkbox"/> no at what depths? _____
Were unusual drilling circumstances encountered?	<input checked="" type="checkbox"/> yes <input type="checkbox"/> no
If yes, briefly explain below	

Other remarks: Lost circulation in Cromwell 3460

\_\_\_\_\_

\_\_\_\_\_

\_\_\_\_\_

\_\_\_\_\_

\_\_\_\_\_

640 Acres

If more than three drainholes are proposed, attach a separate sheet indicating the necessary information.

Direction must be stated in degrees azimuth. Please note, the horizontal drainhole and its end point must be located within the boundaries of the lease or spacing unit.

Directional surveys are required for all drainholes and directional wells.

640 Acres

BOTTOM HOLE LOCATION FOR DIRECTIONAL HOLE

SEC	TWP	RGE	COUNTY
Spot Location	1/4	1/4	1/4
Measured Total Depth	True Vertical Depth		BHL From Lease, Unit, or Property Line:
Feet From 1/4 Sec Lines	FSL	FWL	

BOTTOM HOLE LOCATION FOR HORIZONTAL HOLE: (LATERALS)

LATERAL #1

SEC	TWP	RGE	COUNTY
Spot Location	1/4	1/4	1/4
Depth of Deviation	Radius of Turn		Direction
Measured Total Depth	True Vertical Depth		BHL From Lease, Unit, or Property Line:
Feet From 1/4 Sec Lines	FSL	FWL	Total Length

LATERAL #2

SEC	TWP	RGE	COUNTY
Spot Location	1/4	1/4	1/4
Depth of Deviation	Radius of Turn		Direction
Measured Total Depth	True Vertical Depth		BHL From Lease, Unit, or Property Line:
Feet From 1/4 Sec Lines	FSL	FWL	Total Length

LATERAL #3

SEC	TWP	RGE	COUNTY
Spot Location	1/4	1/4	1/4
Depth of Deviation	Radius of Turn		Direction
Measured Total Depth	True Vertical Depth		BHL From Lease, Unit, or Property Line:
Feet From 1/4 Sec Lines	FSL	FWL	Total Length

11/5/17

RECEIVED

Form 1002A  
Rev. 2009

NOV 27 2017

OKLAHOMA CORPORATION COMMISSION 1016EZ

API NO. 133 24548  
OTC PROD. UNIT NO. 13311777

PLEASE TYPE OR USE BLACK INK ONLY

NOTE:

Attach copy of original 1002A if recompletion or reentry.

OKLAHOMA CORPORATION COMMISSION  
Oil & Gas Conservation Division  
Post Office Box 52000  
Oklahoma City, Oklahoma 73152-2000  
Rule 165-10-3-25

COMPLETION REPORT

☐ ORIGINAL  
☒ AMENDED (Reason)

Test Cromwell

TYPE OF DRILLING OPERATION

☒ STRAIGHT HOLE ☐ DIRECTIONAL HOLE ☐ HORIZONTAL HOLE  
☐ SERVICE WELL

If directional or horizontal, see reverse for bottom hole location.

COUNTY **Seminole** SEC **28** TWP **9N** RGE **8E**  
LEASE NAME **Inaky** WELL NO. **1**  
C 1/4 NW 1/4 SE 1/4 SE 1/4 FSL OF 1/4 SEC **990FS** FWL OF 1/4 SEC **990FE**  
ELEVATION Derrick FL **859** Ground **859** Latitude (if known) Longitude (if known)

SPUD DATE **11-25-05**  
DRLG FINISHED DATE **12-7-05**  
DATE OF WELL COMPLETION **2-3-06**  
1st PROD DATE **3-18-06**  
RECOMP DATE **11-5-17**

OPERATOR NAME **BBR Oil Corporation**

OTC/OCC OPERATOR NO. **02902-0**

ADDRESS **10 W Main, Ste 212**

CITY **Ardmore**

STATE **OK**

ZIP **73401**

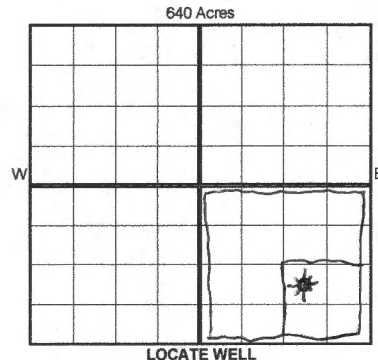

COMPLETION TYPE

☒ SINGLE ZONE

☐ MULTIPLE ZONE

Application Date

COMINGLED

Application Date

LOCATION

EXCEPTION ORDER

INCREASED DENSITY

ORDER NO.

CASING & CEMENT (Form 1002C must be attached)

TYPE	SIZE	WEIGHT	GRADE	FEET	PSI	SAX	TOP OF CMT
CONDUCTOR							
SURFACE	8-5/8	20#	K55	290	500	200	surf
INTERMEDIATE							
PRODUCTION	5-1/2	15.5	K55	4380	1500	225	3100 CBL
LINER							

PACKER @ BRAND & TYPE

PLUG @ **3550** TYPE **RBP**

PLUG @ TYPE

TOTAL DEPTH **4390**

PACKER @ BRAND & TYPE

PLUG @ TYPE

PLUG @ TYPE

COMPLETION & TEST DATA BY PRODUCING FORMATION **202WVTEX 263MNIN 402CM WL**

FORMATION	Willcox	Hunton	Cromwell	No Frac
SPACING & SPACING ORDER NUMBER	291226 (40)	291226 (40)	511154 (160)	
CLASS: Oil, Gas, Dry, Inj, Disp, Comm Disp, Svc	oil Dry under plug	oil Dry under plug	gas	
PERFORATED INTERVALS	4333-41	4140-44 4150-56	3453-57	
ACID/VOLUME	500g 10%	400g 7-1/2%	1000g 15%	
FRACTURE TREATMENT (Fluids/Prop Amounts)				

Min Gas Allowable (165-10-17-7)

OR  
Oil Allowable (165-10-13-3)

Gas Purchaser/Measurer

First Sales Date

INITIAL TEST DATA

INITIAL TEST DATE	2-3-06	7-26-06	10-4-17
OIL-BBL/DAY	3 BOPD	6 BOPD	0
OIL-GRAVITY (API)			
GAS-MCF/DAY	TSTM	TSTM	72MCFPD
GAS-OIL RATIO CU FT/BBL			
WATER-BBL/DAY	3 BWPD	30 BWPD	20 BWPD
PUMPING OR FLOWING	P	P	P
INITIAL SHUT-IN PRESSURE	240	350	400
CHOKE SIZE			8/64"
FLOW TUBING PRESSURE			NA

AS SUBMITTED

A record of the formations drilled through, and pertinent remarks are presented on the reverse. I declare that I have knowledge of the contents of this report and am authorized by my organization to make this report, which was prepared by me or under my supervision and direction, with the data and facts stated herein to be true, correct, and complete to the best of my knowledge and belief.

Michael J. Biddick

SIGNATURE

Michael J. Biddick

NAME (PRINT OR TYPE)

11-21-17

DATE

PHONE NUMBER

10 W Main, Ste 212

ADDRESS

Ardmore, OK 73401

CITY

STATE

ZIP

fractall@sbcglobal.net

EMAIL ADDRESS

SCANNED

E2

DR