

Oklahoma Corporation Commission
Oil & Gas Conservation Division
Post Office Box 52000
Oklahoma City, Oklahoma 73152-2000
Rule 165: 10-3-25

Form 1002A

API No.: 35051353400001

Completion Report

Spud Date: August 01, 1956

OTC Prod. Unit No.:

Drilling Finished Date: August 13, 1956

Amended

1st Prod Date: August 14, 1956

Amend Reason: TEMPORARILY ABANDONED

Completion Date: August 15, 1956

Recomplete Date: November 27, 2017

Drill Type: STRAIGHT HOLE

Well Name: LAFLIN 7A

Purchaser/Measurer:

Location: GRADY 7 5N 8W
C NW SW SW
990 FSL 330 FWL of 1/4 SEC
Derrick Elevation: 1364 Ground Elevation: 1358

First Sales Date:

Operator: CROWN ENERGY COMPANY 19779

1117 NW 24TH ST
OKLAHOMA CITY, OK 73106-5615

Completion Type		Location Exception		Increased Density	
X	Single Zone	Order No		Order No	
	Multiple Zone	There are no Location Exception records to display.		There are no Increased Density records to display.	
	Commingled				

Casing and Cement							
Type	Size	Weight	Grade	Feet	PSI	SAX	Top of CMT
SURFACE	10 3/4	32.75		300		200	
PRODUCTION	5 1/2	14		3324		400	

Liner								
Type	Size	Weight	Grade	Length	PSI	SAX	Top Depth	Bottom Depth
There are no Liner records to display.								

Total Depth: 4400

Packer		Plug	
Depth	Brand & Type	Depth	Plug Type
There are no Packer records to display.		There are no Plug records to display.	

Initial Test Data										
Test Date	Formation	Oil BBL/Day	Oil-Gravity (API)	Gas MCF/Day	Gas-Oil Ratio Cu FT/BBL	Water BBL/Day	Pumpin or Flowing	Initial Shut-In Pressure	Choke Size	Flow Tubing Pressure
There are no Initial Data records to display.										

Completion and Test Data by Producing Formation			
Formation Name: FORTUNA		Code: 451FRTN	Class: TA
Spacing Orders		Perforated Intervals	
Order No	Unit Size	From	To
There are no Spacing Order records to display.		2030	2114
Acid Volumes		Fracture Treatments	
N/A		N/A	

Formation	Top
FORTUNA	2274
OLSON NOBLE	3003

Were open hole logs run? No
Date last log run:

Were unusual drilling circumstances encountered? No
Explanation:

Other Remarks
There are no Other Remarks.

FOR COMMISSION USE ONLY	
Status: Accepted	1138293

051-35340-01

RECEIVED

Form 1002A
Rev. 2009

NOV 20 2017

OKLAHOMA CORPORATION
COMMISSIONAPI NO. 35015435340
OTC PROD. UNIT NO. 19779PLEASE TYPE OR USE BLACK INK ONLY
NOTE:Attach copy of original 1002A
if recompletion or reentry.OKLAHOMA CORPORATION COMMISSION
Oil & Gas Conservation Division
Post Office Box 52000
Oklahoma City, Oklahoma 73152-2000
Rule 165:10-3-25☐ ORIGINAL
☒ AMENDED (Reason)

Temporarily Abandoned

COMPLETION REPORT

TYPE OF DRILLING OPERATION

☒ STRAIGHT HOLE ☐ DIRECTIONAL HOLE ☐ HORIZONTAL HOLE
☐ SERVICE WELL

If directional or horizontal, see reverse for bottom hole location.

COUNTY	Grady	SEC	7	TWP	5N	RGE	8W
LEASE NAME	Lafin 7A →			WELL NO.	7A		
1/4 NW 1/4 SW 1/4 SW 1/4		FSL OF 1/4 SEC	990	FWL OF 1/4 SEC		330	
ELEVATION Derrick FL	1364	Ground	1358	Latitude (if known)		Longitude (if known)	
OPERATOR NAME	Crown Energy Co			OTC/OCC OPERATOR NO.	19779		
ADDRESS	1117 NW 24Th St.						
CITY	Oklahoma City	STATE	OK	ZIP	73106		

SPUD DATE	8/1/56
DRLG FINISHED DATE	8/13/56
DATE OF WELL COMPLETION	8/15/56
1st PROD DATE	8/14/56
RECOMP DATE	11-27-2017

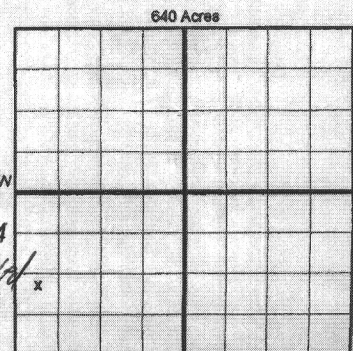

COMPLETION TYPE

<input checked="" type="checkbox"/> SINGLE ZONE
<input type="checkbox"/> MULTIPLE ZONE
Application Date
<input type="checkbox"/> COMMINGLED
Application Date
LOCATION
EXCEPTION ORDER
INCREASED DENSITY
ORDER NO.

CASING & CEMENT (Form 1002C must be attached)

TYPE	SIZE	WEIGHT	GRADE	FEET	PSI	SAX	TOP OF CMT
CONDUCTOR							
SURFACE	10 3/4	32.75		300		200	
INTERMEDIATE							
PRODUCTION	5 1/2	14		3324		400	
LINER							
						TOTAL DEPTH	4,400

PACKER @ BRAND & TYPE PLUG @ TYPE PLUG @ TYPE
 PACKER @ BRAND & TYPE PLUG @ TYPE PLUG @ TYPE

COMPLETION & TEST DATA BY PRODUCING FORMATION 451 FRTN

FORMATION	Fortuna
SPACING & SPACING ORDER NUMBER	
CLASS: Oil, Gas, Dry, Inj, Disp, Comm Disp, Svc	Oil TA
PERFORATED INTERVALS	2030-2114
ACID/VOLUME	N/A
FRACTURE TREATMENT (Fluids/Prop Amounts)	N/A

RECEIVED

NOV 20 2017

OKLAHOMA CORPORATION COMMISSION
DUNCAN OFFICE

Min Gas Allowable (165:10-17-7)

Gas Purchaser/Messurer

☐ OR

First Sales Date

INITIAL TEST DATA Oil Allowable (165:10-13-3)

INITIAL TEST DATE	8/28/1956
OIL-BBL/DAY	40
OIL-GRAVITY (API)	35
GAS-MCF/DAY	0
GAS-OIL RATIO CU FT/BBL	0
WATER-BBL/DAY	0
PUMPING OR FLOWING	Flowing
INITIAL SHUT-IN PRESSURE	
CHOKE SIZE	
FLOW TUBING PRESSURE	

AS SUBMITTED

A record of the formations drilled through, and pertinent remarks are presented on the reverse. I declare that I have knowledge of the contents of this report and am authorized by my organization to make this report, which was prepared by me or under my supervision and direction, with the data and facts stated herein to be true, correct, and complete to the best of my knowledge and belief.

SIGNATURE	Grace Gilland	DATE	11/15/2017	PHONE NUMBER	405-526-0111
1117 NW 24Th St.	Oklahoma City	OK	73106	gracegilland@crownc.com	
ADDRESS	CITY	STATE	ZIP	EMAIL ADDRESS	

PLEASE TYPE OR USE BLACK INK ONLY
FORMATION RECORD

Give formation names and tops, if available, or descriptions and thickness of formations drilled through. Show intervals cored or drillstem tested.

LEASE NAME _____ WELL NO. _____

NAMES OF FORMATIONS	TOP
Fortuna	2,274
Olsen Noble	3,003

FOR COMMISSION USE ONLY

ITD on file ☐ YES ☐ NO

APPROVED _____ DISAPPROVED _____

2) Reject Codes _____

Were open hole logs run? _____ yes _____ no

Date Last log was run _____

Was CO₂ encountered? _____ yes _____ no at what depths? _____

Was H₂S encountered? _____ yes _____ no at what depths? _____

Were unusual drilling circumstances encountered? _____ yes _____ no
If yes, briefly explain below _____

Other remarks: _____

640 Acres

If more than three drainholes are proposed, attach a separate sheet indicating the necessary information.

Direction must be stated in degrees azimuth.
Please note, the horizontal drainhole and its end point must be located within the boundaries of the lease or spacing unit.

Directional surveys are required for all drainholes and directional wells.

640 Acres

BOTTOM HOLE LOCATION FOR DIRECTIONAL HOLE

SEC	TWP	RGE	COUNTY
Spot Location			
1/4	1/4	1/4	1/4
Measured Total Depth		True Vertical Depth	Feet From 1/4 Sec Lines FSL FWL
BHL From Lease, Unit, or Property Line:			

BOTTOM HOLE LOCATION FOR HORIZONTAL HOLE: (LATERALS)

LATERAL #1

SEC	TWP	RGE	COUNTY
Spot Location			
1/4	1/4	1/4	1/4
Depth of Deviation		Radius of Turn	Direction
Measured Total Depth		True Vertical Depth	Total Length
BHL From Lease, Unit, or Property Line:			

LATERAL #2

SEC	TWP	RGE	COUNTY
Spot Location			
1/4	1/4	1/4	1/4
Depth of Deviation		Radius of Turn	Direction
Measured Total Depth		True Vertical Depth	Total Length
BHL From Lease, Unit, or Property Line:			

LATERAL #3

SEC	TWP	RGE	COUNTY
Spot Location			
1/4	1/4	1/4	1/4
Depth of Deviation		Radius of Turn	Direction
Measured Total Depth		True Vertical Depth	Total Length
BHL From Lease, Unit, or Property Line:			