

Oklahoma Corporation Commission  
Oil & Gas Conservation Division  
Post Office Box 52000  
Oklahoma City, Oklahoma 73152-2000  
Rule 165: 10-3-25

Form 1002A

API No.: 35037072740002

**Completion Report**

Spud Date: September 19, 1951

OTC Prod. Unit No.:

Drilling Finished Date: September 25, 1951

**Amended**

1st Prod Date: October 02, 1951

Amend Reason: RECOMPLETION - ADD CASING

Completion Date: October 01, 1951

Recomplete Date: October 20, 2017

**Drill Type: STRAIGHT HOLE**

**SERVICE WELL**

Well Name: PIERPONT 2

Purchaser/Measurer:

Location: CREEK 16 16N 8E  
C NE SW NW  
990 FSL 990 FWL of 1/4 SEC  
Derrick Elevation: 859 Ground Elevation: 854

First Sales Date:

Operator: ALTMAN ENERGY INC 11199

15 W 6TH ST STE 2301  
TULSA, OK 74119-5408

Completion Type		Location Exception		Increased Density	
X	Single Zone	Order No		Order No	
	Multiple Zone	There are no Location Exception records to display.		There are no Increased Density records to display.	
	Commingled				

Casing and Cement							
Type	Size	Weight	Grade	Feet	PSI	SAX	Top of CMT
SURFACE	10 3/4			91		80	SURFACE
INTERMEDIATE	7	20		2824		100	
PRODUCTION	4 1/2	9.5		3618		75	

Liner								
Type	Size	Weight	Grade	Length	PSI	SAX	Top Depth	Bottom Depth
LINER	5 1/2	14		0	0	0	SURFACE	2674
LINER	2 7/8			0	0	260	SURFACE	3517

**Total Depth: 3606**

Packer	
Depth	Brand & Type
3511	INVERTED PC-1
3519	WEATHERFORD DOUBLE ELEMENT

Plug	
Depth	Plug Type
There are no Plug records to display.	

Initial Test Data										
Test Date	Formation	Oil BBL/Day	Oil-Gravity (API)	Gas MCF/Day	Gas-Oil Ratio Cu FT/BBL	Water BBL/Day	Pumpin or Flowing	Initial Shut-In Pressure	Choke Size	Flow Tubing Pressure
There are no Initial Data records to display.										

Completion and Test Data by Producing Formation									
Formation Name: MISENER				Code: 319MSNR			Class: INJ		
Spacing Orders				Perforated Intervals					
Order No		Unit Size		From			To		
There are no Spacing Order records to display.				3532			3540		
Acid Volumes				Fracture Treatments					
There are no Acid Volume records to display.				There are no Fracture Treatments records to display.					

Formation	Top
NOT APPLICABLE	0

Were open hole logs run? No  
Date last log run:

Were unusual drilling circumstances encountered? No  
Explanation:

Other Remarks
RAN 5 1/2" 14TH CASING ON 7" X 5 1/2" ARROW H PACKER NO CEMENT - AUGUST 30, 1989, LANDED @ 2,664'. RAN 2 7/8" TUBING AS CASING OCTOBER 17, 2017 ON 2 7/8" X 4 1/2" DOUBLE ELEMENT CASING PACKER @ 3,519' CEMENTED WITH 260 SACKS REGULAR. RAN 2 1/16" IJ TUBING ON 2 7/8" PACKER SET AT 3,511'. MIT WITNESSED BY OCC EDDIE SULLIVAN NOVEMBER 3, 2017. ORDER NUMBER 33757

FOR COMMISSION USE ONLY
<div>Status: Accepted</div> <div>1138260</div>

API NO. 037-01274  
OTC PROD. UNIT NO. 11199

PLEASE TYPE OR USE BLACK INK ONLY

NOTE:

Attach copy of original 1002A  
if recompletion or reentry.

OKLAHOMA CORPORATION COMMISSION

Oil & Gas Conservation Division  
Post Office Box 52000

Oklahoma City, Oklahoma 73152-2000

Rule 165-10-3-25

COMPLETION REPORT

RECEIVED

NOV 27 2017

Form 1002A  
Rev. 2009

OKLAHOMA CORPORATION  
COMMISSION

640 Acres

☐ ORIGINAL  
☒ AMENDED (Reason)

Recompletion-ADD CASING

TYPE OF DRILLING OPERATION

☒ STRAIGHT HOLE ☐ DIRECTIONAL HOLE ☐ HORIZONTAL HOLE  
☒ SERVICE WELL

If directional or horizontal, see reverse for bottom hole location.

COUNTY	CREEK	SEC	16	TWN	16N	RGE	8E
LEASE NAME	Pierpont			WELL NO.	2		
C 1/4	NE 1/4	SW 1/4	NW 1/4	FSL OF 1/4 SEC	990	FWL OF 1/4 SEC	990
ELEVATION	Derrick FL 859' Ground 854'		Latitude (if known)				
OPERATOR NAME	ALTMAN Energy Inc			OTC/OCC OPERATOR NO.	11199		
ADDRESS	15 W 6th ST. Ste 2301						
CITY	TULSA			STATE	OK		ZIP 74119

SPUD DATE 9-19-1951  
DRLG FINISHED DATE 9-25-1951  
DATE OF WELL COMPLETION 10-1-1951  
1st PROD DATE 10-2-1951  
RECOMP DATE 10/29/2017  
Longitude (if known)

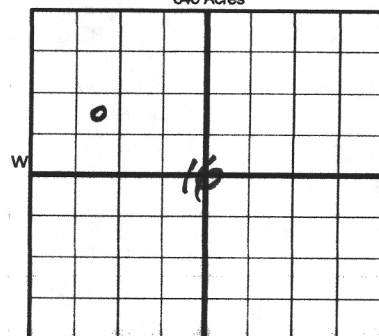

LOCATE WELL

COMPLETION TYPE

<input checked="" type="checkbox"/> SINGLE ZONE
<input type="checkbox"/> MULTIPLE ZONE
Application Date
COMMINGLED
Application Date
LOCATION
EXCEPTION ORDER
INCREASED DENSITY
ORDER NO.

CASING & CEMENT (Form 1002C must be attached)

TYPE	SIZE	WEIGHT	GRADE	FEET	PSI	SAX	TOP OF CMT
CONDUCTOR							
SURFACE	10 3/4			91		80	Surface
INTERMEDIATE	7 1/2	20		2824		100	
PRODUCTION	4 1/2	9.5		3618		75	
LINER	5 1/2	14		2674-Surface			PACKER
							TOTAL DEPTH 3606

PACKER @ 3519 BRAND & TYPE

PACKER @ 3511 BRAND & TYPE

COMPLETION & TEST DATA BY PRODUCING FORMATION

FORMATION	MISNER
SPACING & SPACING ORDER NUMBER	
CLASS: Oil, Gas, Dry, Inj, Disp, Comm Disp, Svc	INS
PERFORATED INTERVALS	3532-3540
ACID/VOLUME	
FRACTURE TREATMENT (Fluids/Prop Amounts)	

Min Gas Allowable (165-10-17-7)

OR

Oil Allowable (165-10-13-3)

Gas Purchaser/Measurer

First Sales Date

INITIAL TEST DATA

INITIAL TEST DATE	
OIL-BBL/DAY	
OIL-GRAVITY (API)	
GAS-MCF/DAY	
GAS-OIL RATIO CU FT/BBL	
WATER-BBL/DAY	
PUMPING OR FLOWING	
INITIAL SHUT-IN PRESSURE	
CHOKE SIZE	
FLOW TUBING PRESSURE	

AS SUBMITTED

A record of the formations drilled through, and pertinent remarks are presented on the reverse. I declare that I have knowledge of the contents of this report and am authorized by my organization to make this report, which was prepared by me or under my supervision and direction, with the data and facts stated herein to be true, correct, and complete to the best of my knowledge and belief.

SIGNATURE: [Signature] NAME (PRINT OR TYPE): RONNY ALTMAN  
ADDRESS: 15 W. 6th ST. Ste 2301 CITY: TULSA STATE: OK ZIP: 74119  
DATE: 11/21/2017 PHONE NUMBER: [blank]  
EMAIL ADDRESS: altmanenergy@gmail.com

## FORMATION RECORD

LEASE NAME

Pierpont

WELL NO. \_\_\_\_\_

Z

NAMES OF FORMATIONS	TOP
<i>Not Applicable -</i>	

FOR COMMISSION USE ONLY	
ITD on file	<input type="checkbox"/> YES <input type="checkbox"/> NO
APPROVED	DISAPPROVED
2) Reject Codes	

Were open hole logs run? ☐ yes ☐ no

Date Last log was run \_\_\_\_\_

Was CO<sub>2</sub> encountered? ☐ yes ☐ no at what depths? \_\_\_\_\_

Was H<sub>2</sub>S encountered? ☐ yes ☐ no at what depths? \_\_\_\_\_

Were unusual drilling circumstances encountered? ☐ yes ☐ no

If yes, briefly explain below \_\_\_\_\_

NOTE: Ran 5 1/2" 14# CASING ON 7" x 5 1/2" ARROW H Packer  
No Cement, 8/30/1989, LANDED @ 2664'  
Ran 2 7/8" tubing AS CASING 10/17/2017, ON 2 7/8" x  
4 1/2" double element CASING PACKER @ 3519' cemented  
N 260 SK Reg. Ran 2 1/16" IS tubing on 2 7/8" packer  
Set at 3511'. M.I.T. witnessed by OCC Eddie Sullivan  
11/3/2017.

640 Acres

640 Acres

645 Notes

SEC	TWP	RGE	COUNTY
Spot Location			
1/4	1/4	1/4	1/4
Measured Total Depth	True Vertical Depth	Feet From 1/4 Sec Lines	
		FSL	FWL
BHL From Lease, Unit, or Property Line:			

**LATERAL #1**

SEC	TWP	RGE	COUNTY			
Spot Location				Feet From 1/4 Sec Lines	FSL	FWL
1/4	1/4	1/4	1/4			
Depth of Deviation		Radius of Turn	Direction	Total Length		
Measured Total Depth		True Vertical Depth	BHL From Lease, Unit, or Property Line:			

**LATERAL #2**

SEC	TWP	RGE	COUNTY			
Spot Location				Feet From 1/4 Sec Lines	FSL	FWL
1/4	1/4	1/4	1/4			
Depth of Deviation		Radius of Turn	Direction	Total Length		
Measured Total Depth		True Vertical Depth	BHL From Lease, Unit, or Property Line:			

**LATERAL #3**

SEC	TWP	RGE	COUNTY
Spot Location			
1/4	1/4	1/4	1/4
Depth of Deviation		Radius of Turn	Direction
Measured Total Depth		True Vertical Depth	BHL From Lease, Unit, or Property Line: