

Oklahoma Corporation Commission
Oil & Gas Conservation Division
Post Office Box 52000
Oklahoma City, Oklahoma 73152-2000
Rule 165: 10-3-25

Form 1002A

API No.: 35119244060001

Completion Report

Spud Date: May 15, 2016

OTC Prod. Unit No.: 26379

Drilling Finished Date: May 20, 2016

Amended

1st Prod Date: October 26, 2016

Amend Reason: RECOMPLETION / COMMINGLE

Completion Date: October 25, 2016

Recomplete Date: November 02, 2017

Drill Type: STRAIGHT HOLE

Min Gas Allowable: Yes

Well Name: HALEY 2A

Purchaser/Measurer:

Location: PAYNE 15 18N 4E
NW SW NW SE
1793 FSL 97 FWL of 1/4 SEC
Derrick Elevation: 0 Ground Elevation: 0

First Sales Date:

Operator: FHA OPERATING LLC 23127
PO BOX 1030
808 S EUCHEE VALLEY
CUSHING, OK 74023-1030

Completion Type		Location Exception		Increased Density	
	Single Zone	Order No		Order No	
	Multiple Zone	653475		There are no Increased Density records to display.	
X	Commingled				

Casing and Cement							
Type	Size	Weight	Grade	Feet	PSI	SAX	Top of CMT
SURFACE	9 5/8		API	188		100	SURFACE
PRODUCTION	7	26	API	3780		140	950

Liner								
Type	Size	Weight	Grade	Length	PSI	SAX	Top Depth	Bottom Depth
There are no Liner records to display.								

Total Depth: 3780

Packer	
Depth	Brand & Type
There are no Packer records to display.	

Plug	
Depth	Plug Type
There are no Plug records to display.	

Initial Test Data

Test Date	Formation	Oil BBL/Day	Oil-Gravity (API)	Gas MCF/Day	Gas-Oil Ratio Cu FT/BBL	Water BBL/Day	Pumpin or Flowing	Initial Shut-In Pressure	Choke Size	Flow Tubing Pressure
Nov 17, 2017	SKINNER UPPER & LOWER	2.2	37	10	4545	20	PUMPING	800		

Completion and Test Data by Producing Formation

Formation Name: SKINNER UPPER

Code: 404SKNRU

Class: OIL

Spacing Orders

Order No	Unit Size
550914	40

Perforated Intervals

From	To
3492	3495

Acid Volumes

600 GALLONS 10% HCL

Fracture Treatments

280 CWT 20-40 SAND

Formation Name: SKINNER LOWER

Code: 404SKNRL

Class: OIL

Spacing Orders

Order No	Unit Size
53604	40

Perforated Intervals

From	To
3527	3532

Acid Volumes

ACIDIZED WITH UPPER SKINNER

Fracture Treatments

F'RACD WITH UPPER SKINNER

Formation Name: SKINNER UPPER & LOWER

Code:

Class: OIL

Formation	Top
SKINNER UPPER	3492
SKINNER LOWER	3527
RED FORK	3562

Were open hole logs run? Yes

Date last log run: November 02, 2017

Were unusual drilling circumstances encountered? No

Explanation:

Other Remarks

There are no Other Remarks.

FOR COMMISSION USE ONLY

1138262

Status: Accepted

119-24406-01

RECEIVED

Form 1002A
Rev. 2009

API NO. 35-119-24006
OTC PROD. UNIT NO. 26379

PLEASE TYPE OR USE BLACK INK ONLY
NOTE:
Attach copy of original 1002A if recompletion or reentry.

OKLAHOMA CORPORATION COMMISSION
Oil & Gas Conservation Division
Post Office Box 52000
Oklahoma City, Oklahoma 73152-2000
Rule 165:10-3-25

NOV 27 2017

OKLAHOMA CORPORATION COMMISSION

☐ ORIGINAL
☒ AMENDED (Reason)

Recompletion/Commingle

COMPLETION REPORT

TYPE OF DRILLING OPERATION
☒ STRAIGHT HOLE ☐ DIRECTIONAL HOLE ☐ HORIZONTAL HOLE
☐ SERVICE WELL
If directional or horizontal, see reverse for bottom hole location.

SPUD DATE 5/15/16
DRLG FINISHED DATE 5/20/16
DATE OF WELL COMPLETION 10/25/16
1st PROD DATE 10/26/16
RECOMP DATE 11/2/17

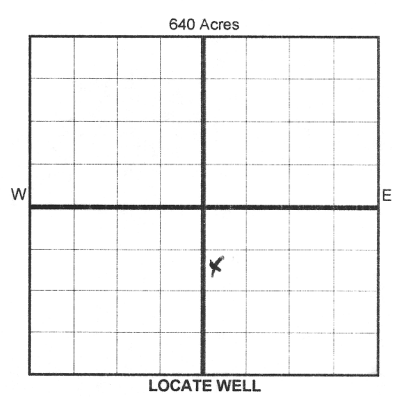

COUNTY Payne SEC 15 TWP 18N RGE 4E
LEASE NAME Haley WELL NO. 2A
SW 1/4 NW 1/4 SE 1/4 1/4 FSL OF 1/4 SEC 1793 FWL OF 1/4 SEC 97
ELEVATION Ground Derrick FL Latitude (if known) Longitude (if known)
OPERATOR NAME FHA Operating, LLC OTC/OCC OPERATOR NO. 23127
ADDRESS PO Box 1030
CITY Cushing STATE OK ZIP 74023

COMPLETION TYPE

☐ SINGLE ZONE
☐ MULTIPLE ZONE
☒ COMMINGLED
LOCATION EXCEPTION ORDER INCREASED DENSITY ORDER NO. 653475 F.O.

CASING & CEMENT (Form 1002C must be attached)

TYPE	SIZE	WEIGHT	GRADE	FEET	PSI	SAX	TOP OF CMT
CONDUCTOR							
SURFACE	9 5/8		API	188		100	Surface
INTERMEDIATE							
PRODUCTION	7"	26	API	3780		140	950
LINER							
				TOTAL DEPTH	3780		

PACKER @ _____ BRAND & TYPE _____ PLUG @ _____ TYPE _____ PLUG @ _____ TYPE _____
PACKER @ _____ BRAND & TYPE _____ PLUG @ _____ TYPE _____ PLUG @ _____ TYPE _____

COMPLETION & TEST DATA BY PRODUCING FORMATION

FORMATION	SPACING & SPACING ORDER NUMBER	CLASS: Oil, Gas, Dry, Inj, Disp, Comm Disp, Svc	PERFORATED INTERVALS	ACID/VOLUME	FRACTURE TREATMENT (Fluids/Prop Amounts)
Skinner Upper	27504 53604 550914 (40)	Oil	3492-3495 3527-3532	600 gal 10% HCL	280 cu ft 20-40 Sand
Skinner Lower	53604 (40)				
Reported to Frac Focus					

☒ Min Gas Allowable (165:10-17-7)
OR
☐ Oil Allowable (165:10-13-3)

Gas Purchaser/Measurer _____
First Sales Date _____

INITIAL TEST DATA

INITIAL TEST DATE	11/17/17
OIL-BBL/DAY	2.2
OIL-GRAVITY (API)	37
GAS-MCF/DAY	10
GAS-OIL RATIO CU FT/BBL	4.55 4545
WATER-BBL/DAY	20
PUMPING OR FLOWING	Pumping
INITIAL SHUT-IN PRESSURE	800
CHOKE SIZE	No
FLOW TUBING PRESSURE	

AS SUBMITTED

A record of the formations drilled through, and pertinent remarks are presented on the reverse. I declare that I have knowledge of the contents of this report and am authorized by my organization to make this report which was prepared by me or under my supervision and direction, with the data and facts stated herein to be true, correct, and complete to the best of my knowledge and belief.

SIGNATURE: Rick Ahrensberg
NAME (PRINT OR TYPE): Rick Ahrensberg
DATE: 11/6/17
PHONE NUMBER: 9182258694
ADDRESS: _____ CITY: _____ STATE: _____ ZIP: _____ EMAIL ADDRESS: _____

Give formation names and tops, if available, or descriptions and thickness of formations drilled through. Show intervals cored or drillstem tested.

LEASE NAME	WELL NO.
------------	----------

NAMES OF FORMATIONS	TOP
skinner Upper	3492
skinner Lower	3527
Reelfoot	3562

FOR COMMISSION USE ONLY	
ITD on file	<input type="checkbox"/> YES <input type="checkbox"/> NO
APPROVED	DISAPPROVED
<div>2) Reject Codes</div> <div> <div></div> <div></div> <div></div> <div></div> <div></div> </div>	

Were open hole logs run? X yes no

Date Last log was run 11/2/17

Was CO₂ encountered? yes X no at what depths?

Was H₂S encountered? yes X no at what depths?

Were unusual drilling circumstances encountered? yes X no

If yes, briefly explain below

Other remarks:

640 Acres

A 4x4 grid representing 640 acres. The grid is divided into four 2x2 quadrants by a thick black cross. Each quadrant contains four 1x1 squares, for a total of 16 squares. The text '640 Acres' is centered at the top of the grid.

If more than three drainholes are proposed, attach a separate sheet indicating the necessary information.

Direction must be stated in degrees azimuth.
Please note, the horizontal drainhole and its end point must be located within the boundaries of the lease or spacing unit.

Directional surveys are required for all drainholes and directional wells.

BOTTOM HOLE LOCATION FOR DIRECTIONAL HOLE

SEC	TWP	RGE	COUNTY
Spot Location			
1/4	1/4	1/4	1/4
Measured Total Depth		True Vertical Depth	Feet From 1/4 Sec Lines FSL FWL
BHL From Lease, Unit, or Property Line:			

BOTTOM HOLE LOCATION FOR HORIZONTAL HOLE: (LATERALS)

LATERAL #1

SEC	TWP	RGE	COUNTY			
Spot Location				Feet From 1/4 Sec Lines	FSL	FWL
1/4	1/4	1/4	1/4			
Depth of Deviation		Radius of Turn	Direction	Total Length		
Measured Total Depth		True Vertical Depth	BHL From Lease, Unit, or Property Line:			

LATERAL #2

SEC	TWP	RGE	COUNTY			
Spot Location				Feet From 1/4 Sec Lines	FSL	FWL
1/4	1/4	1/4	1/4			
Depth of Deviation	Radius of Turn		Direction	Total Length		
Measured Total Depth		True Vertical Depth	BHL From Lease, Unit, or Property Line:			

LATERAL #3

LATERAL #3						
SEC	TWP	RGE	COUNTY			
Spot Location						
1/4	1/4	1/4	1/4	Feet From 1/4 Sec Lines	FSL	FWL
Depth of Deviation		Radius of Turn		Direction	Total Length	
Measured Total Depth		True Vertical Depth		BHL From Lease, Unit, or Property Line:		