

Oklahoma Corporation Commission  
Oil & Gas Conservation Division  
Post Office Box 52000  
Oklahoma City, Oklahoma 73152-2000  
Rule 165: 10-3-25

Form 1002A

API No.: 35069201760001

**Completion Report**

Spud Date: June 08, 2015

OTC Prod. Unit No.: 069-223733

Drilling Finished Date: July 19, 2015

1st Prod Date: July 06, 2018

Completion Date: July 06, 2018

**Amended**

Amend Reason: SHOW COMPLETION

**Drill Type: HORIZONTAL HOLE**

Well Name: LILA 2-18H17

Purchaser/Measurer:

Location: JOHNSTON 18 4S 4E  
SE SE NE NE  
1090 FNL 125 FEL of 1/4 SEC  
Derrick Elevation: 0 Ground Elevation: 782

First Sales Date:

Operator: XTO ENERGY INC 21003

810 HOUSTON ST  
FORT WORTH, TX 76102-6203

Completion Type	
X	Single Zone
	Multiple Zone
	Commingled

Location Exception
Order No
681901

Increased Density
Order No
643605

Casing and Cement							
Type	Size	Weight	Grade	Feet	PSI	SAX	Top of CMT
CONDUCTOR	20	84.75	J-55	97			SURFACE
SURFACE	9 5/8	36	J-55	1995		510	SURFACE
PRODUCTION	5 1/2	20	P-110	16150		1805	8740

Liner								
Type	Size	Weight	Grade	Length	PSI	SAX	Top Depth	Bottom Depth
There are no Liner records to display.								

**Total Depth: 16155**

Packer	
Depth	Brand & Type
There are no Packer records to display.	

Plug	
Depth	Plug Type
There are no Plug records to display.	

Initial Test Data
-------------------

Test Date	Formation	Oil BBL/Day	Oil-Gravity (API)	Gas MCF/Day	Gas-Oil Ratio Cu FT/BBL	Water BBL/Day	Pumpin or Flowing	Initial Shut-In Pressure	Choke Size	Flow Tubing Pressure
Jul 31, 2018	WOODFORD	714	50	2862	4008	637	FLOWING	1910	26/64	1625

<b>Completion and Test Data by Producing Formation</b>	
Formation Name: WOODFORD	Code: 319WDFD
Class: OIL	

Spacing Orders	
Order No	Unit Size
556997	640

Perforated Intervals	
From	To
11150	15962

Acid Volumes	
18,000 GALLONS HCL	

Fracture Treatments	
271,758 BTW, 862,082 POUNDS 100 MESH, 7,055,000 POUNDS 40/70	

Formation	Top
WOODFORD	11082

Were open hole logs run? No

Date last log run:

Were unusual drilling circumstances encountered? No

Explanation:

<b>Other Remarks</b>
IRREGULAR SECTION. OCC - THIS DOCUMENT IS ACCEPTED BASED ON THE DATA SUBMITTED THE ONLY PERMISSION ON LOCATION EXCEPTION IS AN EMERGENCY ORDER AND WILL EXPIRE IN NOVEMBER. THE OPERATOR IS REQUIRED TO HAVE AT ANOTHER ORDER IN PLACE BY THE TIME THE EMERGENCY ORDER EXPIRES OR THE WELL MUST BE SHUT IN TILL ISSUE RESOLVED.

<b>Lateral Holes</b>
Sec: 17 TWP: 4S RGE: 4E County: JOHNSTON  SE SE NE NE  1271 FNL 44 FEL of 1/4 SEC  Depth of Deviation: 10200 Radius of Turn: 840 Direction: 91 Total Length: 5364  Measured Total Depth: 16155 True Vertical Depth: 10583 End Pt. Location From Release, Unit or Property Line: 44

<b>FOR COMMISSION USE ONLY</b>	
Status: Accepted	1140505

# RECEIVED

AUG 06 2018

Form 1002A  
Rev. 2009

API NO. 069-20176  
OTC PROD  
UNIT NO. 069-223753

PLEASE TYPE OR USE BLACK INK ONLY  
NOTE:

Attach copy of original 1002A  
if recompletion or reentry.

☐ ORIGINAL  
☒ AMENDED (Reason)

Show Completion

OKLAHOMA CORPORATION COMMISSION  
Oil & Gas Conservation Division  
Post Office Box 52000  
Oklahoma City, Oklahoma 73152-2000  
Rule 165:10-3-25

## COMPLETION REPORT

### TYPE OF DRILLING OPERATION

☐ STRAIGHT HOLE ☐ DIRECTIONAL HOLE ☒ HORIZONTAL HOLE  
☐ SERVICE WELL

If directional or horizontal, see reverse for bottom hole location.

COUNTY	Johnston	SEC	18	TWP	4S	RGE	4E
LEASE NAME	Lila			WELL NO.	2-18H17		
SE 1/4	SE 1/4	NE 1/4	NE 1/4	(FNU) OF 1/4 SEC	1090'	(FNU) OF 1/4 SEC	125'
ELEVATIO N Derrick	Ground	782'	Latitude (if known)	34.213281°N		Longitude (if known)	96.916080°W
OPERATOR NAME	XTO Energy Inc.			OTC/OCC OPERATOR NO.	21003		
ADDRESS	210 Park Avenue, Suite 2350						
CITY	Oklahoma City	STATE	Oklahoma	ZIP	73102		

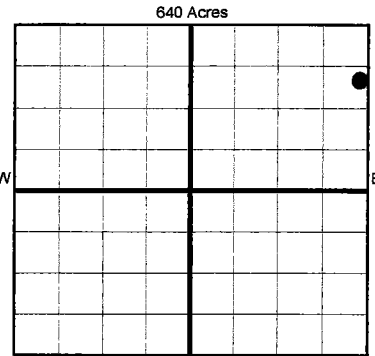

LOCATE WELL

### COMPLETION TYPE

<input checked="" type="checkbox"/> SINGLE ZONE
<input type="checkbox"/> MULTIPLE ZONE
Application Date
COMINGLED
Application Date
LOCATION
EXCEPTION ORDER
INCREASED DENSITY
ORDER NO.

### CASING & CEMENT (Form 1002C must be attached)

TYPE	SIZE	WEIGHT	GRADE	FEET	PSI	SAX	TOP OF CMT
CONDUCTOR	20"	84.75	J-55	97			Surface
SURFACE	9 5/8"	36	J-55	1995		510	Surface
INTERMEDIATE							
PRODUCTION	5 1/2"	20	P-110	16,150		1805	8740
LINER							
						TOTAL DEPTH	16,155'

PACKER @ \_\_\_\_\_ BRAND & TYPE \_\_\_\_\_ PLUG @ \_\_\_\_\_ TYPE \_\_\_\_\_ PLUG @ \_\_\_\_\_ TYPE \_\_\_\_\_  
PACKER @ \_\_\_\_\_ BRAND & TYPE \_\_\_\_\_ PLUG @ \_\_\_\_\_ TYPE \_\_\_\_\_ PLUG @ \_\_\_\_\_ TYPE \_\_\_\_\_

### COMPLETION & TEST DATA BY PRODUCING FORMATION

FORMATION	WOODFORD
SPACING & SPACING ORDER NUMBER	640:556997
CLASS: Oil, Gas, Dry, Inj, Disp, Comm Disp, Svc	Oil
PERFORATED INTERVALS	11150-15962'
ACID/VOLUME	18,000 gals HCL
FRACTURE TREATMENT (Fluids/Prop Amounts)	271,758 BTW 862,082# 100 Mesh 7,055,000# 40/70

*Reported to FracFocus*

Min Gas Allowable (165:10-17-7)

Gas Purchaser/Measurer  
First Sales Date

### INITIAL TEST DATA

Oil Allowable (165:10-13-3)

INITIAL TEST DATE	7/31/2018
OIL-BBL/DAY	714
OIL-GRAVITY ( API)	50
GAS-MCF/DAY	2862
GAS-OIL RATIO CU FT/BBL	4008
WATER-BBL/DAY	637
PUMPING OR FLOWING	Flowing
INITIAL SHUT-IN PRESSURE	1910
CHOKE SIZE	26/64"
FLOW TUBING PRESSURE	1625

**AS SUBMITTED**

A record of the formations drilled through, and pertinent remarks are presented on the reverse. I declare that I have knowledge of the contents of this report and am authorized by my organization to make this report, which was prepared by me or under my supervision and direction, with the data and facts stated herein to be true, correct, and complete to the best of my knowledge and belief.

SIGNATURE	Debbie Waggoner	DATE	8/3/2018	PHONE NUMBER	405-319-3243
ADDRESS	210 Park Avenue, Suite 2350	CITY	Oklahoma City	STATE	Ok
		ZIP	73102	EMAIL ADDRESS	debbie_waggoner@xtoenergy.com

Give formation names and tops, if available, or descriptions and thickness of formations drilled through. Show intervals cored or drillstem tested.

NAMES OF FORMATIONS	TOP
WOODFORD	11,082

FOR COMMISSION USE ONLY	
ITD on file	<input type="checkbox"/> YES <input type="checkbox"/> NO
APPROVED	DISAPPROVED
	2) Reject Codes <hr/> <hr/> <hr/> <hr/> <hr/>

Were open hole logs run?           yes      X   no

Date Last log was run      \_\_\_\_\_

Was CO<sub>2</sub> encountered?           yes      X   no    at what depths? \_\_\_\_\_

Was H<sub>2</sub>S encountered?           yes      X   no    at what depths? \_\_\_\_\_

Were unusual drilling circumstances encountered?           yes      X   no

If yes, briefly explain below

Other remarks: Irregular Section

640 Acres

**If more than three drainholes are proposed, attach a separate sheet indicating the necessary information.**

Direction must be stated in degrees azimuth.  
Please note, the horizontal drainhole and its end  
point must be located within the boundaries of the  
lease or spacing unit.

**Directional surveys are required for all drainholes and directional wells.**

640 Acres

SEC	TWP	RGE	COUNTY Johnston			
Spot Location			Feet From 1/4 Sec Lines		FNL	FEL
1/4	1/4	1/4	1/4			
Measured Total Depth		True Vertical Depth		BHL From Lease, Unit, or Property Line:		

LATERAL #1									
SEC 17	TWP	4S	RGE	4E	COUNTY	Johnston			
Spot Location						Feet From 1/4 Sec Lines	FNL 1271	FEL 44	
SE 1/4	SE 1/4	NE 1/4	NE 1/4	NE 1/4					
Depth of Deviation 10,200			Radius of Turn 840.3		Direction 91.9°	Total Length 5,364			
Measured Total Depth 16,155'			True Vertical Depth 10,583		BHL From Lease, Unit, or Property Line: 1271 FNL & 44' FEL				

ORIGINAL #						
SEC	TWP	RGE	COUNTY			
Spot Location				Feet From 1/4 Sec Lines	FSL	FWL
1/4	1/4	1/4	1/4			
Depth of Deviation		Radius of Turn	Direction	Total Length		
Measured Total Depth		True Vertical Depth	BHL From Lease, Unit, or Property Line:			

LATERAL #3						
SEC	TWP	RGE	COUNTY			
Spot Location				Feet From 1/4 Sec Lines	FSL	FWL
1/4	1/4	1/4	1/4			
Depth of Deviation		Radius of Turn	Direction	Total Length		
Measured Total Depth		True Vertical Depth	BHL From Lease, Unit, or Property Line:			