

Oklahoma Corporation Commission
Oil & Gas Conservation Division
Post Office Box 52000
Oklahoma City, Oklahoma 73152-2000
Rule 165: 10-3-25

Form 1002A

API No.: 35073259680000

Completion Report

Spud Date: April 13, 2018

OTC Prod. Unit No.: 073-223557

Drilling Finished Date: April 24, 2018

1st Prod Date: May 18, 2018

Completion Date: May 14, 2018

Drill Type: HORIZONTAL HOLE

Min Gas Allowable: Yes

Well Name: GM 12-17-7 3HC

Purchaser/Measurer: CHESAPEAKE OPERATING LLC

First Sales Date: 05/21/2018

Location: KINGFISHER 12 17N 7W
NE NW NW NE
240 FNL 2090 FEL of 1/4 SEC
Derrick Elevation: 1088 Ground Elevation: 1061

Operator: CHESAPEAKE OPERATING LLC 17441
PO BOX 18496
6100 N WESTERN AVE
OKLAHOMA CITY, OK 73154-0496

Completion Type		Location Exception		Increased Density	
X	Single Zone	Order No		Order No	
	Multiple Zone	679076		671101	
	Commingled	679167		671238	

Casing and Cement							
Type	Size	Weight	Grade	Feet	PSI	SAX	Top of CMT
SURFACE	13 3/8	48	H-40	374		340	SURFACE
INTERMEDIATE	9 5/8	36	J-55	1477		480	SURFACE
PRODUCTION	7	26	P-110EC	7187		340	3590

Liner								
Type	Size	Weight	Grade	Length	PSI	SAX	Top Depth	Bottom Depth
LINER	4 1/2	13.50	P-110EC	10591	0	1105	6868	17459

Total Depth: 17459

Packer	
Depth	Brand & Type
There are no Packer records to display.	

Plug	
Depth	Plug Type
There are no Plug records to display.	

Initial Test Data

Test Date	Formation	Oil BBL/Day	Oil-Gravity (API)	Gas MCF/Day	Gas-Oil Ratio Cu FT/BBL	Water BBL/Day	Pumpin or Flowing	Initial Shut-In Pressure	Choke Size	Flow Tubing Pressure
Jul 03, 2018	OSWEGO	330	43	283	858	457	PUMPING			102

Completion and Test Data by Producing Formation			
Formation Name: OSWEGO		Code: 404OSWG	
		Class: OIL	

Spacing Orders	
Order No	Unit Size
634514	640
666142	640
679329	MULTIUNIT

Perforated Intervals	
From	To
7147	17293

Acid Volumes
607,750 GALLONS ACID

Fracture Treatments
99,400 BARRELS FLUIDS, 150 POUNDS PROPPANT

Formation	Top
OSWEGO	6950

Were open hole logs run? No

Date last log run:

Were unusual drilling circumstances encountered? No

Explanation:

Other Remarks
EXCEPTION TO THE RULE ORDER NUMBERS 679168, 679169, 679746, AND 679751

Lateral Holes
Sec: 36 TWP: 18N RGE: 7W County: KINGFISHER NW NE NE NE 280 FNL 353 FEL of 1/4 SEC Depth of Deviation: 5840 Radius of Turn: 741 Direction: 2 Total Length: 10509 Measured Total Depth: 17459 True Vertical Depth: 6581 End Pt. Location From Release, Unit or Property Line: 280

FOR COMMISSION USE ONLY	
Status: Accepted	1140437

API
NO. 073-25968
OTC PROD.
UNIT NO. 073-223557

PLEASE TYPE OR USE BLACK INK ONLY

NOTE:

Attach copy of original 1002A if recompletion or reentry.

OKLAHOMA CORPORATION COMMISSION

Oil & Gas Conservation Division

Post Office Box 52000

Oklahoma City, Oklahoma 73152-2000

Rule 165:10-3-25

Form 1002A

Rev. 2009

RECEIVED

JUL 20 2018

☒ ORIGINAL
☐ AMENDED
Reason Amended

TYPE OF DRILLING OPERATION

☐ STRAIGHT HOLE ☐ DIRECTIONAL HOLE ☒ HORIZONTAL HOLE
SERVICE WELL

If directional or horizontal, see reverse for bottom hole location.

COUNTY Kingfisher SEC 12 TWP 17N RGE 7W

LEASE NAME GM 12-17-7 WELL NO 3HC

SHL NE 1/4 NW 1/4 NW 1/4 NE 1/4 240 1/4 SEC 2,090

ELEVATION Derrick FI 1,088 Ground 1,061 Latitude (if Known)

OPERATOR NAME CHESAPEAKE OPERATING, L.L.C.

OTC/OCC OPERATOR NO. 17441

ADDRESS P.O. BOX 18496

CITY OKLAHOMA CITY

STATE OK

ZIP 73154

COMPLETION REPORT

SPUD DATE 4/13/2018

DRLG FINISHED DATE 4/24/2018

DATE OF WELL COMPLETION 5/14/2018

1ST PROD DATE 5/18/2018

RECOMP DATE

Longitude

(if Known)

OKLAHOMA CORPORATION COMMISSION

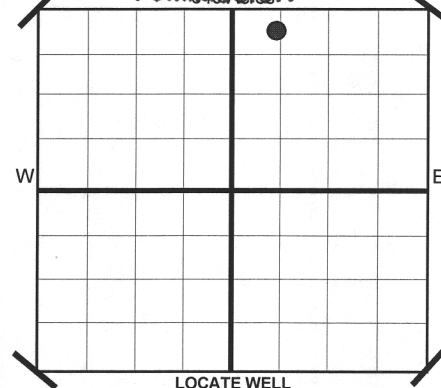

COMPLETION TYPE

☒ SINGLE ZONE
☐ MULTIPLE ZONE
Application Date
☐ COMINGLED
Application Date
LOCATION EXCEPTION ORDER NO. 679167 / 679076
INCREASED DENSITY ORDER NO. 671101 / 671238

CASING & CEMENT (Form 1002C must be attached)

TYPE	SIZE	WEIGHT	GRADE	FEET	PSI	SAX	TOP
CONDUCTOR							
SURFACE	13-3/8"	48#	H-40	374		340	Surface
INTERMEDIATE	9-5/8"	36#	J-55	1,477		480	Surface
PRODUCTION	7"	26#	P-110EC	7,187		340	3,590
LINER	4-1/2"	13.50#	P-110EC	6,868-17,459		1,105	6,868
						TOTAL DEPTH	17,459

PACKER @ BRAND & TYPE
PACKER @ BRAND & TYPE

PLUG @ TYPE
PLUG @ TYPE

COMPLETION & TEST DATA BY PRODUCING FORMATION

FORMATION	Oswego	Multinit						Reported to Fruc Focus
SPACING & SPACING ORDER NUMBER	640 634514 / 666142	679329 F.O.						
CLASS: Oil, Gas, Dry, Inj. Disp, Comm Disp, Svc	Oil							
PERFORATED INTERVALS	7,147 - 17,293							
ACID/VOLUME	607,750 gals acid 99,400 bbls fluids 150# proppant							
FRACTURE TREATMENT (Fluids/Prop Amounts)								

Minimum Gas Allowable (165:10-17-7)

Gas Purchaser/Measurer

Chesapeake Operating, L.L.C.

☒

OR

1st Sales Date

5/21/2018

INITIAL TEST DATA

Oil Allowable (165:10-13-3)

INITIAL TEST DATE	7/3/2018						
OIL-BBL/DAY	330						
OIL-GRAVITY (API)	43						
GAS-MCF/DAY	283						
GAS-OIL RATIO CU FT/BBL	858						
WATER-BBL/DAY	457						
PUMPING OR FLOWING	Pumping						
INITIAL SHUT-IN PRESSURE							
CHOKE SIZE							
FLOW TUBING PRESSURE	102						

AS SUBMITTED

A record of the formations drilled through, and pertinent remarks are presented on the reverse. I declare that I have knowledge of the contents of this report and am authorized by my organization to make this report, which was prepared by me or under my supervision and direction, with the data and facts stated herein to be true, correct, and complete to the best of my knowledge and belief.

Juanita Cooper SIGNATURE
P.O. BOX 18496 ADDRESS
OKLAHOMA CITY CITY
OK STATE
73154 ZIP
JUANITA COOPER - SR. REGULATORY ANALYST NAME (PRINT OR TYPE)
7/19/2018 DATE
405-848-8000 PHONE NUMBER
juanita.cooper@chk.com EMAIL ADDRESS

PLEASE TYPE OR USE BLACK INK ONLY
FORMATION RECORD

Give formation names and tops, if available, or descriptions and thickness of formations drilled through. Show intervals cored or drillstem tested.

LEASE NAME GM 12-17-7

WELL NO. 3HC

NAMES OF FORMATIONS	TOP
Oswego	6,950

FOR COMMISSION USE ONLY	
ITD on file <input type="checkbox"/> YES <input type="checkbox"/> NO	
APPROVED _____	DISAPPROVED _____
2) Reject Codes	

Were open hole logs run?	yes <input checked="" type="checkbox"/> no <input type="checkbox"/>
Date Last log was run	N/A
Was CO ₂ encountered?	yes <input checked="" type="checkbox"/> no <input type="checkbox"/> at what depths?
Was H ₂ S encountered?	yes <input checked="" type="checkbox"/> no <input type="checkbox"/> at what depths?
Were unusual drilling circumstances encountered?	yes <input type="checkbox"/> no <input checked="" type="checkbox"/>
If yes, briefly explain.	

Other remarks: Exception to the Rule Orders 679168, 679169, 679751, and 679746

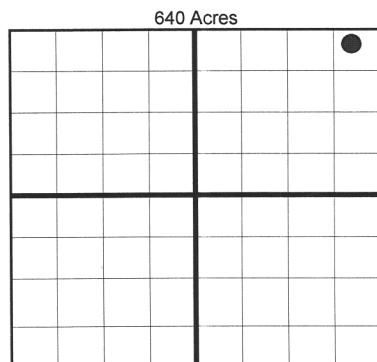

BOTTOM HOLE LOCATION FOR DIRECTIONAL HOLE

SEC	TWP	RGE	COUNTY			
Spot Location				Feet From 1/4 Sec Lines	FSL	FWL
1/4	1/4	1/4	1/4			
Measured Total Depth		True Vertical Depth		BHL From Lease, Unit, or Property Line:		

BOTTOM HOLE LOCATION FOR HORIZONTAL HOLE: (LATERALS)
LATERAL #1

SEC	TWP	RGE	COUNTY			
36	18N	7W	Kingfisher			
Spot Location				Feet From 1/4 Sec Lines	FNL	FEL
NW 1/4	NE 1/4	NE 1/4	NE 1/4	280	353	
Depth of Deviation		Radius of Turn		Total Length		
5,840		741		10,509		
Measured Total Depth		True Vertical Depth		BHL From Lease, Unit, or Property Line:		
17,459		6,581		280		

If more than three drainholes are proposed, attach a separate sheet indicating the necessary information.

Direction must be stated in degrees azimuth.
Please note, the horizontal drainhole and its end point must be located within the boundaries of the lease or spacing unit.

Directional surveys are required for all drainholes and directional wells.
640 Acres

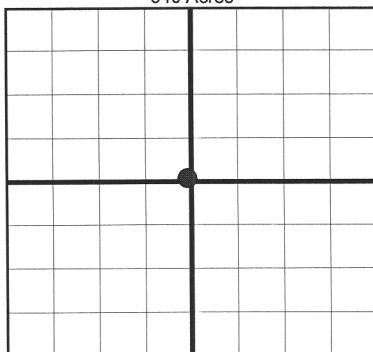

LATERAL #2

SEC	TWP	RGE	COUNTY			
Spot Location				Feet From 1/4 Sec Lines	FSL	FWL
1/4	1/4	1/4	1/4			
Depth of Deviation		Radius of Turn		Total Length		
Measured Total Depth		True Vertical Depth		BHL From Lease, Unit, or Property Line:		

LATERAL #3

SEC	TWP	RGE	COUNTY			
Spot Location				Feet From 1/4 Sec Lines	FSL	FWL
1/4	1/4	1/4	1/4			
Depth of Deviation		Radius of Turn		Total Length		
Measured Total Depth		True Vertical Depth		BHL From Lease, Unit, or Property Line:		