

Oklahoma Corporation Commission
Oil & Gas Conservation Division
Post Office Box 52000
Oklahoma City, Oklahoma 73152-2000
Rule 165: 10-3-25

Form 1002A

API No.: 35039225280000

Completion Report

Spud Date: March 06, 2018

OTC Prod. Unit No.: 039-223808

Drilling Finished Date: May 02, 2018

1st Prod Date: June 13, 2018

Completion Date: June 12, 2018

Drill Type: HORIZONTAL HOLE

Well Name: IZABELLA 1H-04

Purchaser/Measurer: ANCOVA ENERGY
MARKETING

First Sales Date: 06/13/2018

Location: CUSTER 4 15N 14W
NE NW NE NE
278 FNL 750 FEL of 1/4 SEC
Latitude: 35.8116208 Longitude: -98.687543433
Derrick Elevation: 0 Ground Elevation: 1612

Operator: MEP OPERATING LLC 24146

333 CLAY ST STE 2800
HOUSTON, TX 77002-4168

Completion Type		Location Exception		Increased Density	
X	Single Zone	Order No		Order No	
	Multiple Zone	667325		There are no Increased Density records to display.	
	Commingled				

Casing and Cement							
Type	Size	Weight	Grade	Feet	PSI	SAX	Top of CMT
CONDUCTOR	20			75		6	SURFACE
SURFACE	13 3/8	54.5	J-55	1475		935	SURFACE
INTERMEDIATE	9 5/8	40	HCP-110	9845	4500	635	
PRODUCTION	5 1/2	23	P-110	16855	3500	1415	5760

Liner								
Type	Size	Weight	Grade	Length	PSI	SAX	Top Depth	Bottom Depth
There are no Liner records to display.								

Total Depth: 16855

Packer	
Depth	Brand & Type
There are no Packer records to display.	

Plug	
Depth	Plug Type
There are no Plug records to display.	

Initial Test Data

Test Date	Formation	Oil BBL/Day	Oil-Gravity (API)	Gas MCF/Day	Gas-Oil Ratio Cu FT/BBL	Water BBL/Day	Pumpin or Flowing	Initial Shut-In Pressure	Choke Size	Flow Tubing Pressure
Jun 18, 2018	MISSISSIPPIAN (LESS CHESTER)	4	51	7633	1908250	78	FLOWING	5500	24/64	4100

Completion and Test Data by Producing Formation									
Formation Name: MISSISSIPPIAN (LESS CHESTER)				Code: 359MSNLC			Class: GAS		
Spacing Orders				Perforated Intervals					
Order No		Unit Size		From			To		
666591		640		12109			16679		
Acid Volumes				Fracture Treatments					
96 BARRELS				250,772 BW, 2,759,360 POUNDS 100 MESH, 6,135,360 POUNDS 40/70 SAND					

Formation	Top
MERAMEC	12000

Were open hole logs run? No

Date last log run:

Were unusual drilling circumstances encountered? No

Explanation:

Other Remarks
OCC - THIS DOCUMENT IS ACCEPTED BASED ON THE DATA SUBMITTED THE FINAL LOCATION EXCEPTION HAS NOT BEEN SUBMITTED.

Lateral Holes
Sec: 4 TWP: 15N RGE: 0W County: CUSTER SW SE SE SE 197 FSL 2183 FWL of 1/4 SEC Depth of Deviation: 11498 Radius of Turn: 898 Direction: 181 Total Length: 4459 Measured Total Depth: 16855 True Vertical Depth: 12245 End Pt. Location From Release, Unit or Property Line: 197

FOR COMMISSION USE ONLY
<div>Status: Accepted</div> <div>1140449</div>

API NO. 039-22528
OTC PROD. UNIT NO. 039-223808

PLEASE TYPE OR USE BLACK INK ONLY
NOTE:

Attach copy of original 1002A
if recompletion or reentry.

OKLAHOMA CORPORATION COMMISSION
Oil & Gas Conservation Division
Post Office Box 52000
Oklahoma City, Oklahoma 73152-2000
Rule 165:10-3-25

RECEIVED

JUL 24 2018

OKLAHOMA CORPORATION
COMMISSION

Form 1002A
Rev. 2009

☒ ORIGINAL
☐ AMENDED (Reason)

TYPE OF DRILLING OPERATION

☐ STRAIGHT HOLE ☐ DIRECTIONAL HOLE ☒ HORIZONTAL HOLE
☐ SERVICE WELL

If directional or horizontal, see reverse for bottom hole location.

COUNTY	CUSTER	SEC	4	TWP	15N	RGE	04W
LEASE NAME	IZABELLA			WELL NO.	1H-04		
NE 1/4 NW 1/4 NE 1/4 NE 1/4	FNA 278			1st PROD DATE	6/13/18		
ELEVATION N Derrick	Ground	1612	Latitude (if known)	35.8116208	Longitude (if known)	-98.68754343	
OPERATOR NAME	MEP OPERATING LLC			OTC/OCC OPERATOR NO.	24146		
ADDRESS	333 CLAY STREET, SUITE 2800						
CITY	HOUSTON		STATE	TX	ZIP	77002	

COMPLETION TYPE

<input checked="" type="checkbox"/> SINGLE ZONE
<input type="checkbox"/> MULTIPLE ZONE
Application Date
<input type="checkbox"/> COMMINGLED
Application Date
LOCATION
EXCEPTION ORDER
INCREASED DENSITY
ORDER NO.

CASING & CEMENT (Form 1002C must be attached)

TYPE	SIZE	WEIGHT	GRADE	FEET	PSI	SAX	TOP OF CMT
CONDUCTOR	20			75		6.5 YD	SURFACE
SURFACE	13-3/8	54.5	J-55	1,475		935	SURFACE
INTERMEDIATE	9-5/8	40	HCP-110	9,845	4500	635	
PRODUCTION	5-1/2	23	P-110	16,855	3500	1,415	5760
LINER							

PACKER @ _____ BRAND & TYPE _____ PLUG @ _____ TYPE _____ PLUG @ _____ TYPE _____
PACKER @ _____ BRAND & TYPE _____ PLUG @ _____ TYPE _____ PLUG @ _____ TYPE _____

TOTAL DEPTH 16,855

COMPLETION & TEST DATA BY PRODUCING FORMATION

FORMATION	(Meramec) Mississippi (Less Chester)
SPACING & SPACING ORDER NUMBER	666591 (640 ac)
CLASS: Oil, Gas, Dry, Inj, Disp, Comm Disp, Svc	Gas
PERFORATED INTERVALS	16,679-12,109 OA
ACID/VOLUME	96 Bbl
FRACTURE TREATMENT (Fluids/Prop Amounts)	250,772 BW 2,759,360# 100 Mesh 6,135,360# 40/70 Sd

Min Gas Allowable (165:10-17-7)

Gas Purchaser/Measurer
First Sales Date

Incova Energy Marketing
6/13/2018

INITIAL TEST DATA

INITIAL TEST DATE	6/18/2018
OIL-BBL/DAY	4
OIL-GRAVITY (API)	51
GAS-MCF/DAY	7633
GAS-OIL RATIO CU FT/BBL	1,900,000 1,908,250
WATER-BBL/DAY	78
PUMPING OR FLOWING	Flowing
INITIAL SHUT-IN PRESSURE	5,500
CHOKE SIZE	24/64
FLOW TUBING PRESSURE	4,100

AS SUBMITTED

A record of the formations drilled through, and pertinent remarks are presented on the reverse. I declare that I have knowledge of the contents of this report and am authorized by my organization to make this report, which was prepared by me or under my supervision and direction, with the data and facts stated herein to be true, correct, and complete to the best of my knowledge and belief.

Wayne Smith, Agent
7/24/2018 (405)842-7888
7011 N. Robinson Ave Oklahoma City OK 73116
wayne.smith@tresmanagement.com

PLEASE TYPE OR USE BLACK INK ONLY
FORMATION RECORD

Give formation names and tops, if available, or descriptions and thickness of formations drilled through. Show intervals cored or drillstem tested.

NAMES OF FORMATIONS	TOP
Meramec	12,000

LEASE NAME IZABELLA WELL NO. 1H-04

FOR COMMISSION USE ONLY	
ITD on file <input type="checkbox"/> YES <input type="checkbox"/> NO	
APPROVED _____	DISAPPROVED _____
2) Reject Codes	

Were open hole logs run?	_____ yes <input checked="" type="checkbox"/> no
Date Last log was run	_____
Was CO ₂ encountered?	_____ yes <input checked="" type="checkbox"/> no at what depths? _____
Was H ₂ S encountered?	_____ yes <input checked="" type="checkbox"/> no at what depths? _____
Were unusual drilling circumstances encountered?	_____ yes <input checked="" type="checkbox"/> no
If yes, briefly explain below	

Other remarks:

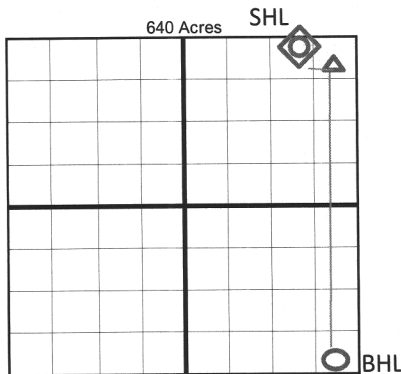

If more than three drainholes are proposed, attach a separate sheet indicating the necessary information.

Direction must be stated in degrees azimuth.
Please note, the horizontal drainhole and its end point must be located within the boundaries of the lease or spacing unit.

Directional surveys are required for all drainholes and directional wells.

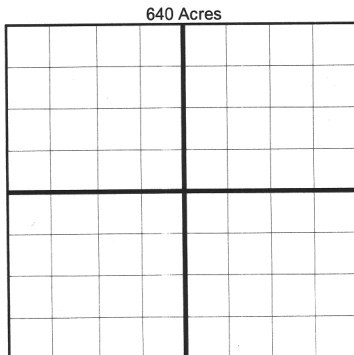

BOTTOM HOLE LOCATION FOR DIRECTIONAL HOLE

SEC	TWP	RGE	COUNTY
Spot Location	1/4	1/4	1/4
Measured Total Depth	True Vertical Depth	BHL From Lease, Unit, or Property Line:	

BOTTOM HOLE LOCATION FOR HORIZONTAL HOLE: (LATERALS)

LATERAL #1				CUSTER			
SEC	TWP	RGE	COUNTY	SEC	TWP	RGE	COUNTY
4	15N	14W					
Spot Location	SW 1/4	SE 1/4	SE 1/4	Feet From 1/4 Sec Lines	FSL	197	FWL
Depth of Deviation	11,498	Radius of Turn	898	Direction	181	Total Length	4,459
Measured Total Depth	16,855	True Vertical Depth	12,245	BHL From Lease, Unit, or Property Line: 197			

LATERAL #2			
SEC	TWP	RGE	COUNTY
Spot Location	1/4	1/4	1/4
Depth of Deviation	Radius of Turn	Direction	Total Length
Measured Total Depth	True Vertical Depth	BHL From Lease, Unit, or Property Line:	

LATERAL #3			
SEC	TWP	RGE	COUNTY
Spot Location	1/4	1/4	1/4
Depth of Deviation	Radius of Turn	Direction	Total Length
Measured Total Depth	True Vertical Depth	BHL From Lease, Unit, or Property Line:	

API NO. 039-22528
OTC PROD. UNIT NO. 039-223808

PLEASE TYPE OR USE BLACK INK ONLY
NOTE:

Attach copy of original 1002A
if recompletion or reentry.

☒ ORIGINAL
☐ AMENDED (Reason)

Att: 223808 I

OKLAHOMA CORPORATION COMMISSION
Oil & Gas Conservation Division
Post Office Box 52000
Oklahoma City, Oklahoma 73152-2000
Rule 165:10-3-25

RECEIVED

JUL 24 2018

OKLAHOMA CORPORATION
COMMISSION

Form 1002A
Rev. 2009

1016EZ

TYPE OF DRILLING OPERATION

☐ STRAIGHT HOLE ☐ DIRECTIONAL HOLE ☒ HORIZONTAL HOLE
☐ SERVICE WELL

If directional or horizontal, see reverse for bottom hole location.

COUNTY	CUSTER	SEC	4	TWP	15N	RGE	4W
LEASE NAME	IZABELLA			WELL NO.	1H-04		
NE 1/4 NW 1/4 NE 1/4 NE 1/4	EOL OF 278 -2330			EOL OF 1890 -750	1st PROD DATE 6/13/18		
ELEVATION N Derrick	Ground	1612	Latitude (if known)	35.8116208	Longitude (if known)	-98.687543433	
OPERATOR NAME	MEP OPERATING LLC			OTC/OCC OPERATOR NO.	24146		
ADDRESS	333 CLAY STREET, SUITE 2800						
CITY	HOUSTON		STATE	TX	ZIP	77002	

SPUD DATE	3/6/18
DRLG FINISHED DATE	5/2/18
DATE OF WELL COMPLETION	6/12/18
1st PROD DATE	6/13/18
RECOMP DATE	

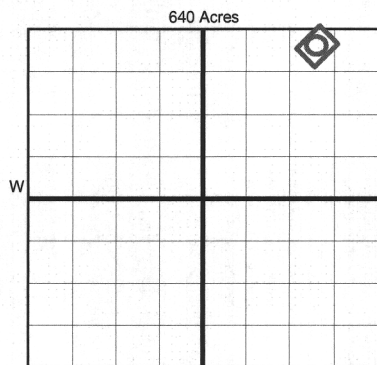

LOCATE WELL

COMPLETION TYPE

<input checked="" type="checkbox"/> SINGLE ZONE
<input type="checkbox"/> MULTIPLE ZONE
Application Date
COMINGLED
Application Date
LOCATION
EXCEPTION ORDER
INCREASED DENSITY
ORDER NO.

CASING & CEMENT (Form 1002C must be attached)

TYPE	SIZE	WEIGHT	GRADE	FEET	PSI	SAX	TOP OF CMT
CONDUCTOR	20			75		6.5 YD	SURFACE
SURFACE	13-3/8	54.5	J-55	1,475		935	SURFACE
INTERMEDIATE	9-5/8	40	HCP-110	9,845	4500	635	
PRODUCTION	5-1/2	23	P-110	16,855	3500	1,415	5760
LINER							
				TOTAL DEPTH	16,855		

PACKER @ _____ BRAND & TYPE _____ PLUG @ _____ TYPE _____ PLUG @ _____ TYPE _____
PACKER @ _____ BRAND & TYPE _____ PLUG @ _____ TYPE _____ PLUG @ _____ TYPE _____

COMPLETION & TEST DATA BY PRODUCING FORMATION

FORMATION	(Meramec) Mississippi (Less Chester)
SPACING & SPACING ORDER NUMBER	666591 (640 ac)
CLASS: Oil, Gas, Dry, Inj, Disp, Comm Disp, Svc	Gas
PERFORATED INTERVALS	16,679-12,109 OA
ACID/VOLUME	96 Bbl
FRACTURE TREATMENT (Fluids/Prop Amounts)	250,772 BW 2,759,360# 100 Mesh 6,135,360# 40/70 Sd

Monitor
Report to E&P Focus

Min Gas Allowable (165:10-17-7) Gas Purchaser/Measurer Incova Energy Marketing
OR First Sales Date 6/13/2018
Oil Allowable (165:10-13-3)

INITIAL TEST DATA

INITIAL TEST DATE	6/18/2018
OIL-BBL/DAY	4
OIL-GRAVITY (API)	51
GAS-MCF/DAY	7633
GAS-OIL RATIO CU FT/BBL	1,900,000 1,908,250
WATER-BBL/DAY	78
PUMPING OR FLOWING	Flowing
INITIAL SHUT-IN PRESSURE	5,500
CHOKE SIZE	24/64
FLOW TUBING PRESSURE	4,100

AS SUBMITTED

A record of the formations drilled through, and pertinent remarks are presented on the reverse. I declare that I have knowledge of the contents of this report and am authorized by my organization to make this report, which was prepared by me or under my supervision and direction, with the data and facts stated herein to be true, correct, and complete to the best of my knowledge and belief.

Wayne Smith, Agent 7/24/2018 (405)842-7888
SIGNATURE NAME (PRINT OR TYPE) DATE PHONE NUMBER
7011 N. Robinson Ave Oklahoma City OK 73116 wayne.smith@tresmanagement.com
ADDRESS CITY STATE ZIP EMAIL ADDRESS

SCANNED